

INTERIM REVIEW ONLY
 Document incomplete; not intended for permit, bidding or construction.
 Engineer: **RAMIRO M. GARCIA**
 P.E. Serial No.: 81951
 Date: 7/6/2016

Texas Department of Transportation
 ©2016 by Texas Department of Transportation; all rights reserved

JURISDICTIONAL WETLANDS AND WATERS OF THE U. S.
US 181: HARBOR BRIDGE
PROJECT LIMITS

CSJ: 0101-06-095 County: Nueces State: Texas
 Application By:
 Texas Department of Transportation
 Sheet: 1 of 7 USACE Project No:
 Date: 07/2016

HNTB HNTB Corporation
 The HNTB Companies
 Engineers Architects Planners
 TBPE FIRM REGISTRATION NO.: 420



US 181 Harbor Bridge

CSJ 0101-06-095



LOCATOR DIAGRAM

Figure 3.

Red Alternative Alignment

Key to Features

- Red Alternative
- Landuse Types**
- Cemetery
- Community /G overment
- Park
- Utility
- Upland C onfined PlacementA rea



0 800 1,600
Feet
1 inch = 1,600 feet

RED ALTERNATIVE

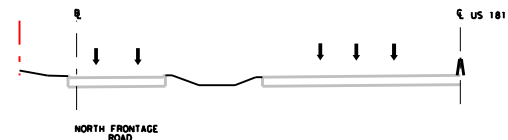
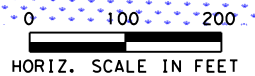
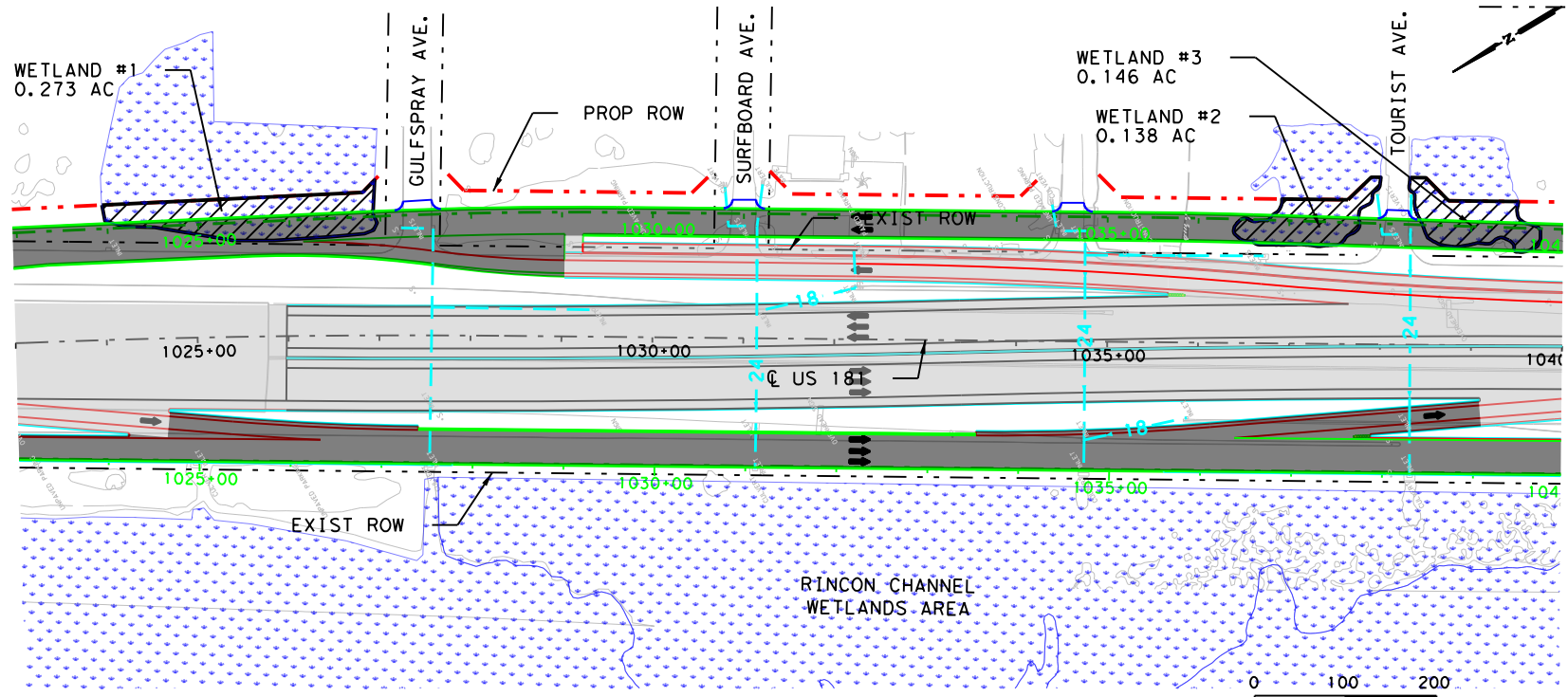

INTERIM REVIEW ONLY
 Document incomplete; not intended for permit, bidding or construction.
 Engineer: RAMIRO M. GARCIA
 P.E. Serial No.: 81951
 Date: 7/6/2016

Texas Department of Transportation
 ©2016 by Texas Department of Transportation; all rights reserved

**JURISDICTIONAL WETLANDS AND WATERS OF THE U.S.
 US 181: HARBOR BRIDGE
 WETLANDS #1, #2, & #3**

CSJ: 0101-06-095 County: Nueces State: Texas
 Application By:
 Texas Department of Transportation
 Sheet: 2 of 7 USACE Project No:
 Date: 07/2016

HNTB Corporation
 The HNTB Companies
 Engineers Architects Planners
 TBPE FIRM REGISTRATION NO.: 420

LEGEND

---	CL US 181	[Blue dotted pattern]	WETLANDS
---	EXIST ROW	[Hatched pattern]	IMPACTED AREA
---	PROP ROW	[Cross-hatched pattern]	AVOIDED AREA
---	BULKHEAD LINE	---	TEMPORARY COFFERDAM LIMITS
---	EXISTING DRAINAGE	---	---
---	MITIGATION SITE	---	---
[Blue fill]	WATER	---	---

LABEL	PERMANENT FILL (AC)	FILL CY
#1	0.273 AC	705 CY
#2	0.138 AC	401 CY
#3	0.146 AC	386 CY

7/6/2016 10:16:10 US181HB-S-EV-EX-H000.dgn

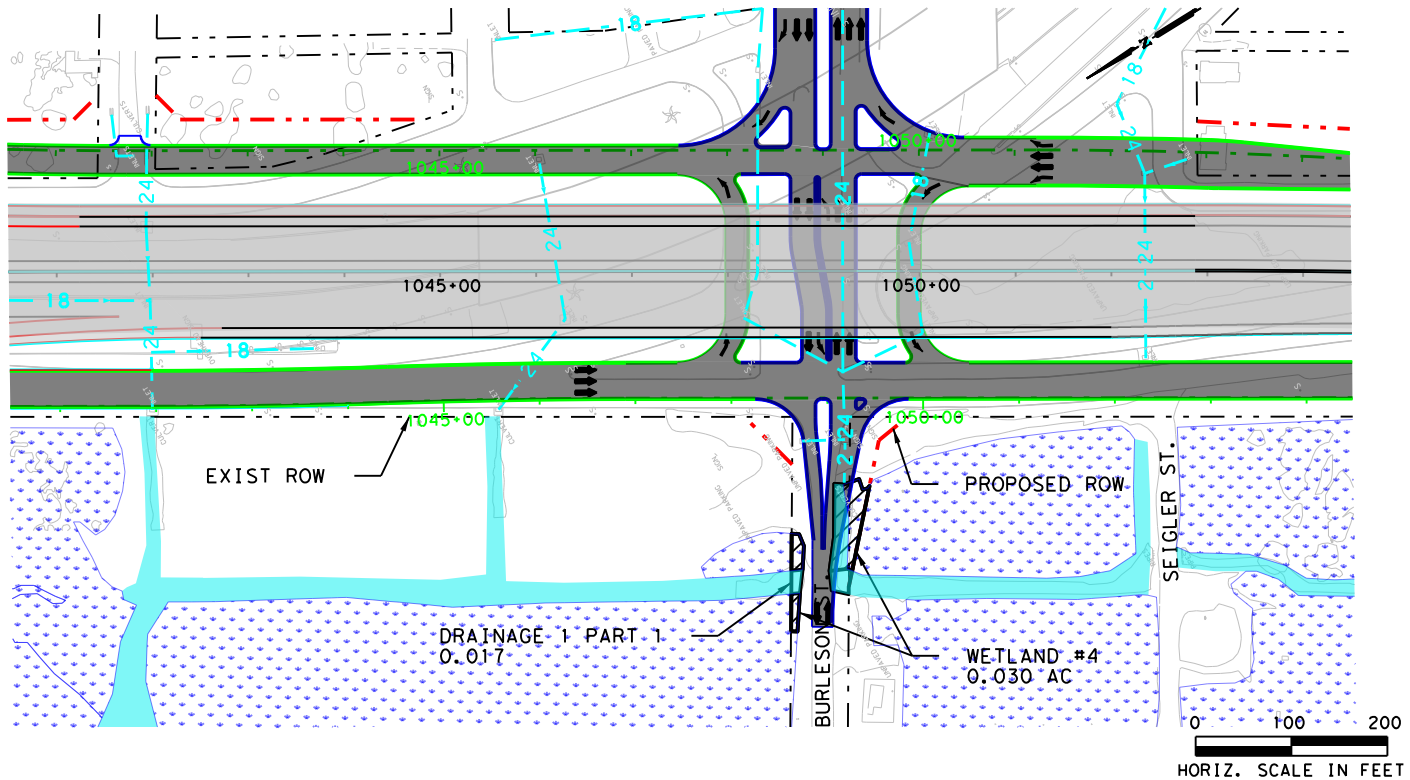

INTERIM REVIEW ONLY
 Document incomplete: not intended for
 permit, bidding or construction.
 Engineer: RAMIRO M. GARCIA
 P.E. Serial No.: 81951
 Date: 7/6/2016

Texas Department of Transportation
 ©2016 by Texas Department of Transportation;
 all rights reserved

**JURISDICTIONAL WETLANDS
 AND WATERS OF THE U.S.
 US 181: HARBOR BRIDGE
 WETLAND #4 &
 DRAINAGE 1 PART 1**

CSJ: 0101-06-095 County: Nueces State: Texas
 Application By:
 Texas Department of Transportation
 Sheet: 3 of 7 USACE Project No:
 Date: 07/2016

HNTB HNTB Corporation
 The HNTB Companies
 Engineers Architects Planners
 TBPB FIRM REGISTRATION NO.: 420

LEGEND

--- C US 181	WETLANDS
- - - EXIST ROW	IMPACTED AREA
- · - · PROP ROW	AVOIDED AREA
--- BULKHEAD LINE	TEMPORARY COFFERDAM LIMITS
--- EXISTING DRAINAGE	
--- MITIGATION SITE	
WATER	

LABEL	PERMANENT FILL (AC)	FILL CY
DRAINAGE 1 PART 1	0.017 AC	38 CY
#4	0.030 AC	127 CY

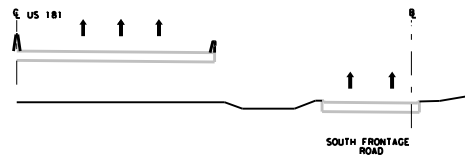
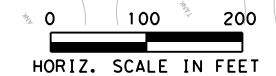
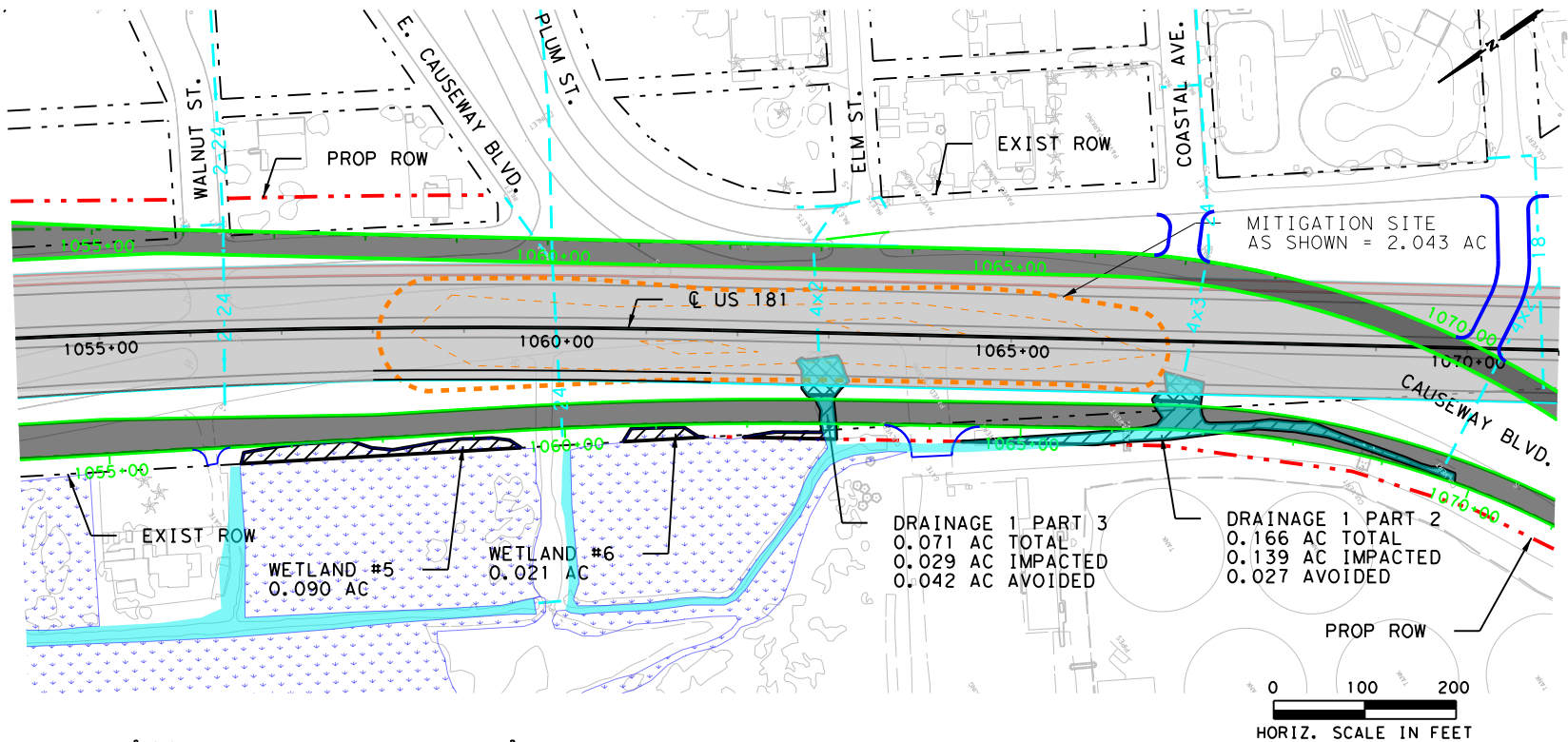

INTERIM REVIEW ONLY
 Document incomplete: not intended for permit, bidding or construction.
 Engineer: RAMIRO M. GARCIA
 P.E. Serial No.: 81951
 Date: 7/6/2016

LEGEND

---	CL US 181	[Blue Dotted Pattern]	WETLANDS
- - -	EXIST ROW	[Hatched Pattern]	IMPACTED AREA
- · - · -	PROP ROW	[Cross-hatched Pattern]	AVOIDED AREA
---	BULKHEAD LINE	- - -	TEMPORARY COFFERDAM LIMITS
---	EXISTING DRAINAGE		
---	MITIGATION SITE		
[Blue Area]	WATER		

LABEL	PERMANENT FILL (AC)	FILL CY
#5	0.090 AC	146 CY
#6	0.021 AC	35 CY
DRAINAGE 1 PART 3	0.029 AC	27 CY
DRAINAGE 1 PART 2	0.139 AC	246 CY

Texas Department of Transportation
 ©2016 by Texas Department of Transportation; all rights reserved

**JURISDICTIONAL WETLANDS AND WATERS OF THE U.S.
 US 181: HARBOR BRIDGE
 WETLANDS #5, #6 &
 DRAINAGE 1 PARTS 2 & 3**

CSJ: 0101-06-095 County: Nueces State: Texas
 Application By:
 Texas Department of Transportation
 Sheet: 4 of 7 USACE Project No:
 Date: 07/2016

HNTB HNTB Corporation
 The HNTB Companies
 Engineers Architects Planners
 TBP# FIRM REGISTRATION NO.: 420

7/6/2016
 US181HB-S-EV-EXH000.dgn

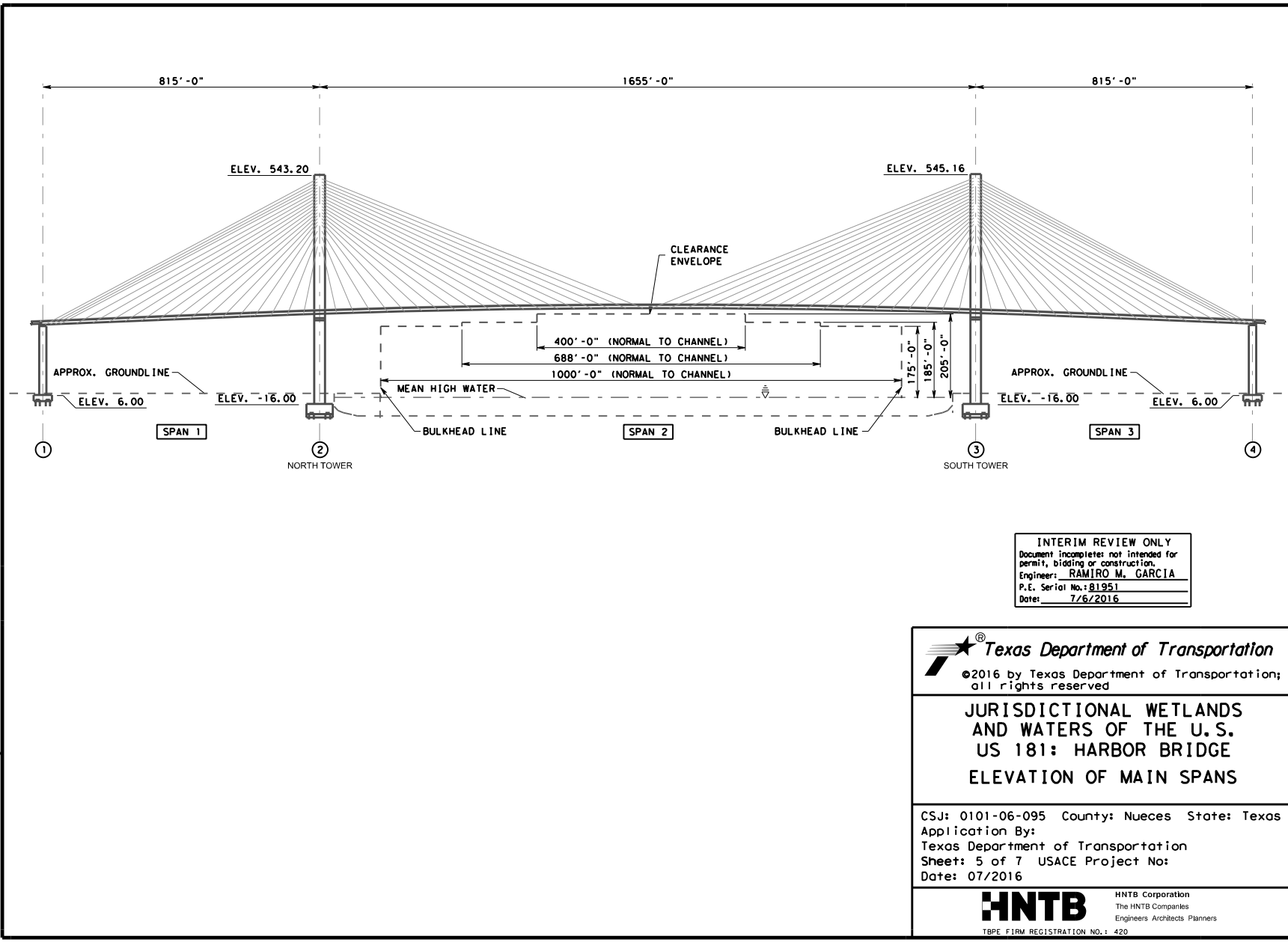

INTERIM REVIEW ONLY
 Document incomplete; not intended for permit, bidding or construction.
 Engineer: RAMIRO M. GARCIA
 P.E. Serial No.: 81951
 Date: 7/6/2016

Texas Department of Transportation
 ©2016 by Texas Department of Transportation; all rights reserved

**JURISDICTIONAL WETLANDS AND WATERS OF THE U.S.
 US 181: HARBOR BRIDGE
 ELEVATION OF MAIN SPANS**

CSJ: 0101-06-095 County: Nueces State: Texas
 Application By:
 Texas Department of Transportation
 Sheet: 5 of 7 USACE Project No:
 Date: 07/2016

HNTB
 HNTB Corporation
 The HNTB Companies
 Engineers Architects Planners
 TBPE FIRM REGISTRATION NO.: 420

7/6/2016
 US181HB-S-EV-EX-000.dgn

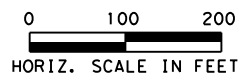
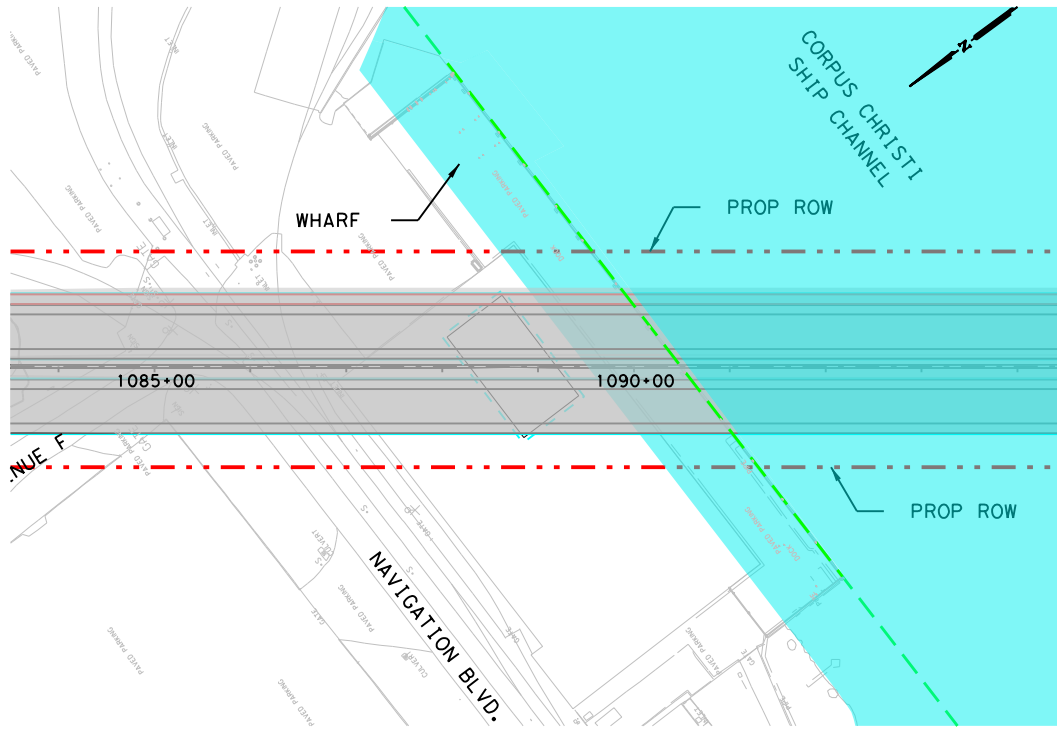

INTERIM REVIEW ONLY
 Document incomplete: not intended for permit, bidding or construction.
 Engineer: RAMIRO M. GARCIA
 P.E. Serial No.: 81951
 Date: 7/6/2016

Texas Department of Transportation
 ©2016 by Texas Department of Transportation; all rights reserved

**JURISDICTIONAL WETLANDS AND WATERS OF THE U.S.
 US 181: HARBOR BRIDGE
 NORTH TOWER DETAIL**

CSJ: 0101-06-095 County: Nueces State: Texas
 Application By:
 Texas Department of Transportation
 Sheet: 6 of 7 USACE Project No:
 Date: 07/2016

HNTB
 HNTB Corporation
 The HNTB Companies
 Engineers Architects Planners
 TPBE FIRM REGISTRATION NO.: 420

LEGEND

--- C US 181	WETLANDS
- - - EXIST ROW	IMPACTED AREA
- . - . PROP ROW	AVOIDED AREA
--- BULKHEAD LINE	TEMPORARY COFFERDAM LIMITS
--- EXISTING DRAINAGE	
--- MITIGATION SITE	
WATER	

AREA LABEL	TEMPORARY IMPACTED (AC)	PERMANENT FILL (AC)	FILL CY

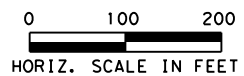
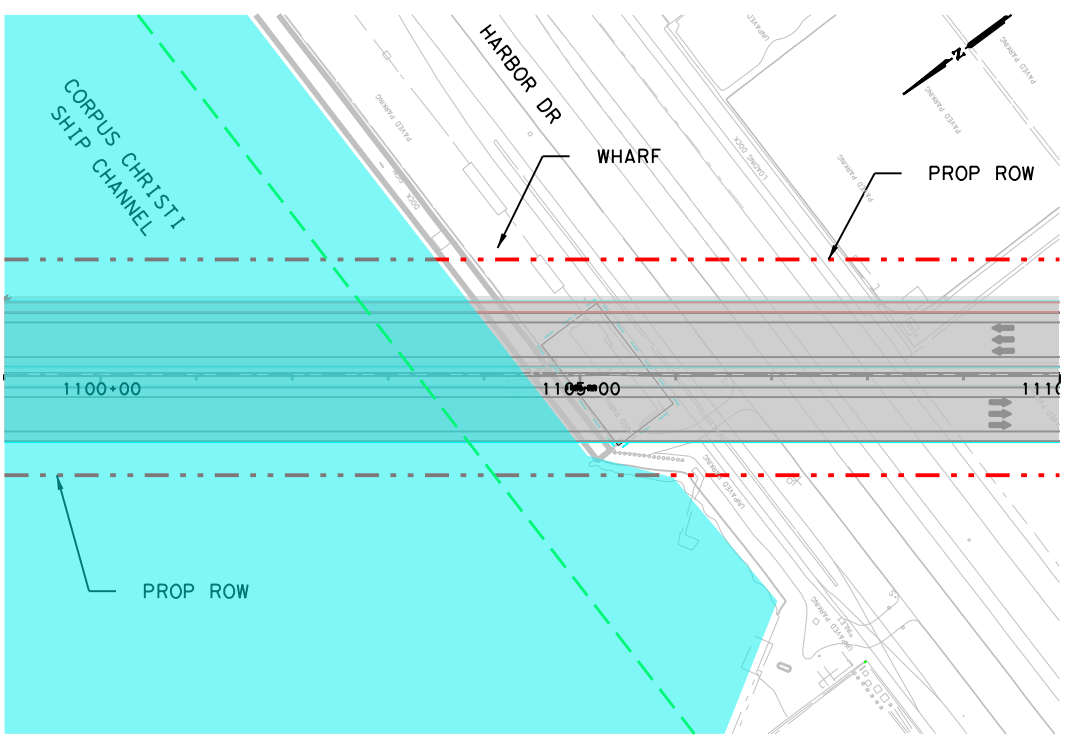

INTERIM REVIEW ONLY
 Document incomplete: not intended for
 permit, bidding or construction.
 Engineer: RAMIRO M. GARCIA
 P.E. Serial No.: 81951
 Date: 7/6/2016

Texas Department of Transportation
 ©2016 by Texas Department of Transportation;
 all rights reserved

**JURISDICTIONAL WETLANDS
 AND WATERS OF THE U.S.
 US 181: HARBOR BRIDGE
 SOUTH TOWER DETAILS**

CSJ: 0101-06-095 County: Nueces State: Texas
 Application By:
 Texas Department of Transportation
 Sheet: 7 of 7 USACE Project No:
 Date: 07/2016

HNTB HNTB Corporation
 The HNTB Companies
 Engineers Architects Planners
 TBPE FIRM REGISTRATION NO.: 420

LEGEND

--- C US 181	WETLANDS
- - - EXIST ROW	IMPACTED AREA
- . - . PROP ROW	AVOIDED AREA
- - - BULKHEAD LINE	TEMPORARY COFFERDAM LIMITS
- - - EXISTING DRAINAGE	
- . - . MITIGATION SITE	
WATER	

AREA LABEL	TEMPORARY IMPACTED (AC)	PERMANENT FILL (AC)	FILL CY

7/6/2016 11:10:11 US181HBB-S-EV-EXH000.dgn