

Areas Previously Dredged

Proposed Dredge Areas

N
Project SWG-2006-01921
BLOOMINGTON, TX Quad
Sheet 1 of 9

0 1,000 2,000 3,000 4,000 5,000 Feet

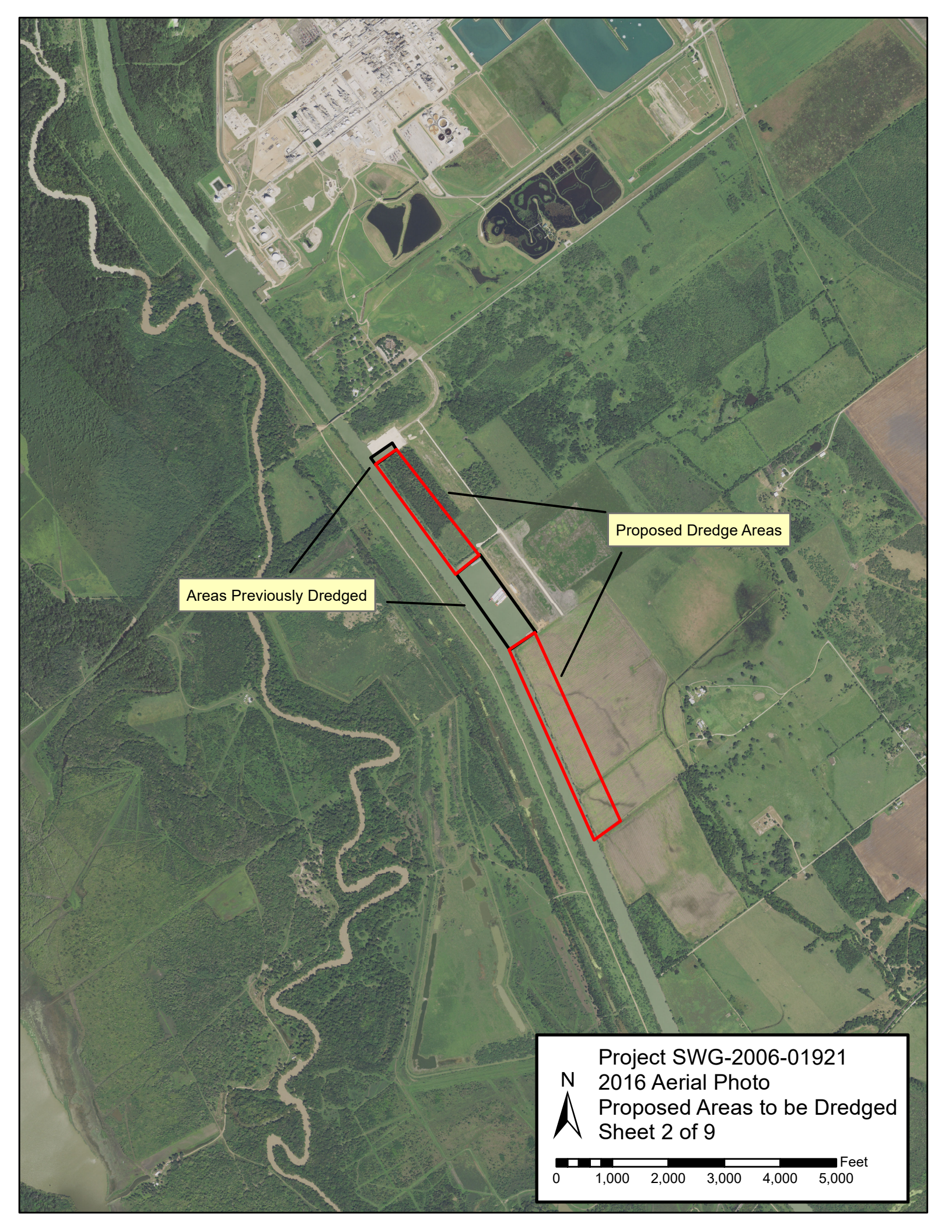

Areas Previously Dredged

Proposed Dredge Areas



Project SWG-2006-01921
2016 Aerial Photo
Proposed Areas to be Dredged
Sheet 2 of 9

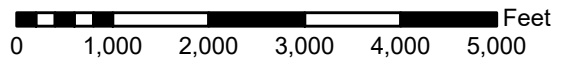



FM HIGHWAY 1432

PORT OF VICTORIA TURNING BASIN

ROW

ROW

LEVEE

VICTORIA BARGE CANAL

INVISTA

OLD BLOOMINGTON RD

CANAL RD

CANAL RD (ALSO KNOWN AS DUPONT RD)

C.O.E. PLACEMENT AREA 11

EX DOCK (PHASE I)

PROPOSED STAGING AREA

PROPOSED DOCK (PHASE II)

PROPOSED BARGE CANAL WIDENING

ORIGINAL ~1850 ACRES OWNED BY VCND

EXISTING DUVALL FLEETING AREA

ADDITIONAL ~100 ACRES ACQUIRED BY VCND

ADDITIONAL ~400 ACRES ACQUIRED BY VCND

ADDITIONAL ~50 ACRES ACQUIRED BY VCND

PROPOSED FLEETING AREA EXTENSION/ BARGE CANAL WIDENING

~2510'

~3700'

CIVILCORP, LLC
FIRM REGISTRATION NUMBER: 10283



NAME: Bennie L. Galvan PE
DATE: 4/2/2018

CivilCorp
ENGINEERS • SURVEYORS

4611 AIRLINE ROAD, SUITE 300, VICTORIA, TEXAS 77904
TEL: (361)570-7500 FAX: (361)570-7501
TBPE REGISTRATION #F-10283 TBPLS REGISTRATION #100576-00

BARGE CANAL WIDENING

UPDATED DRAWINGS FOR PERMIT
RENEWAL SWG-2006-01921

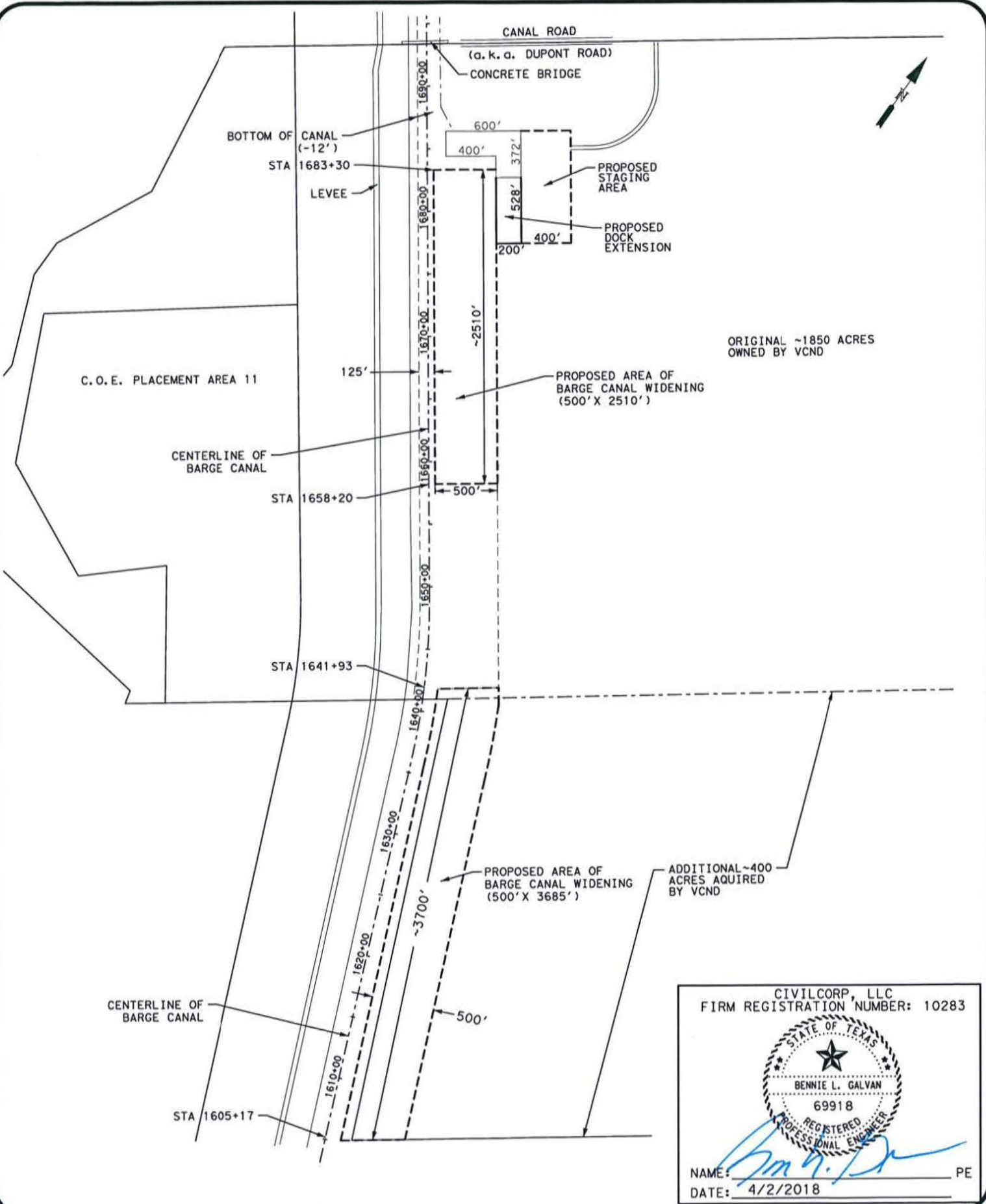

ORIGINAL ~1850 ACRES OWNED BY VCND

ADDITIONAL ~400 ACRES ACQUIRED BY VCND

CIVILCORP, LLC
 FIRM REGISTRATION NUMBER: 10283

NAME: *Bennie L. Galvan* PE
 DATE: 4/2/2018

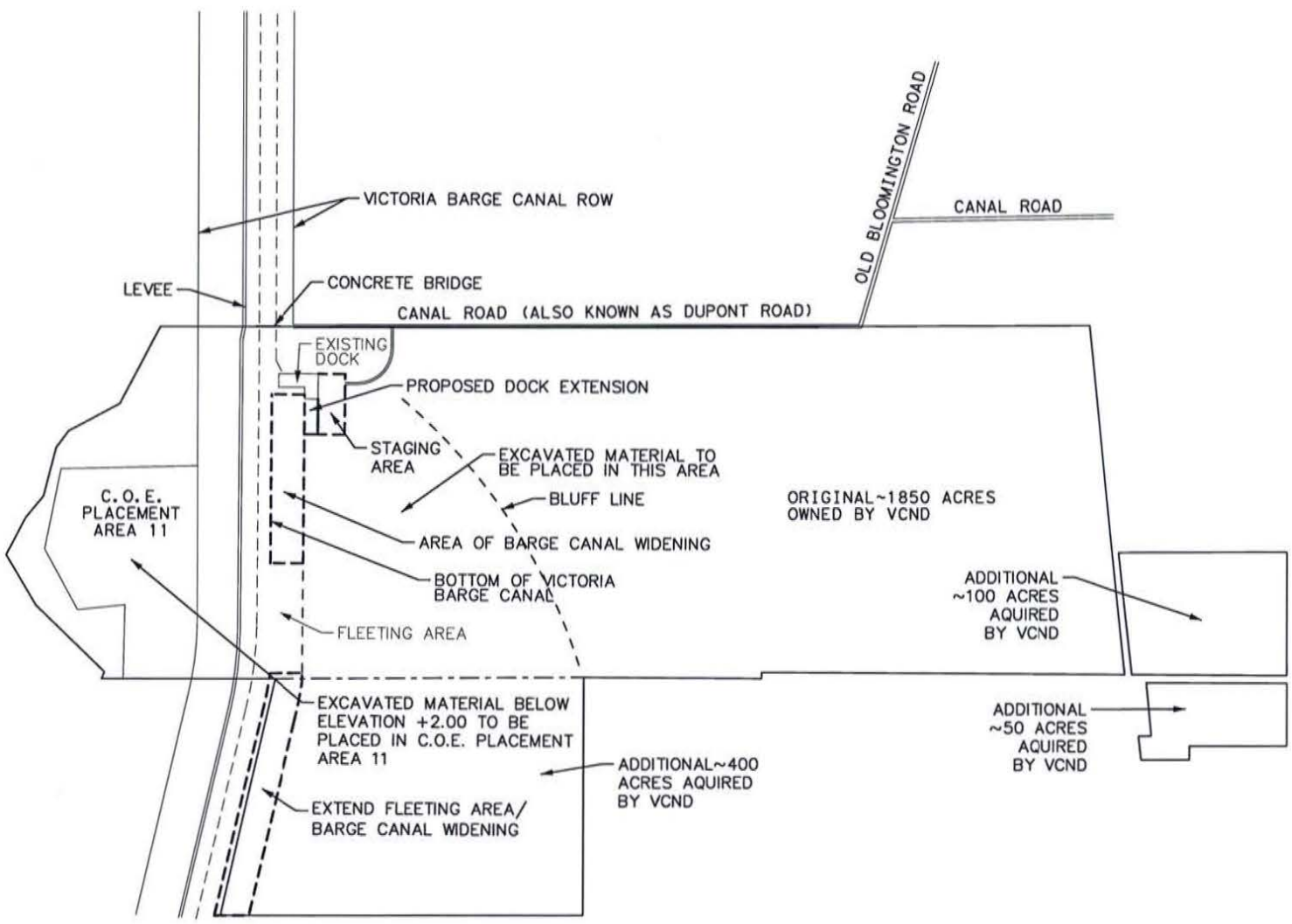

CIVILCORP, LLC
 FIRM REGISTRATION NUMBER: 10283

NAME: Bennie L. Galvan PE
 DATE: 4/2/2018

CivilCorp
 ENGINEERS • SURVEYORS
 4611 AIRLINE ROAD, SUITE 300, VICTORIA, TEXAS 77904
 TEL: (361) 570-7500 FAX: (361) 570-7501
 TBPE REGISTRATION #F-10283 TBPLS REGISTRATION #100576-00

PLACEMENT AREA LOCATION
 UPDATED DRAWINGS FOR PERMIT
 RENEWAL SWG-2006-01921

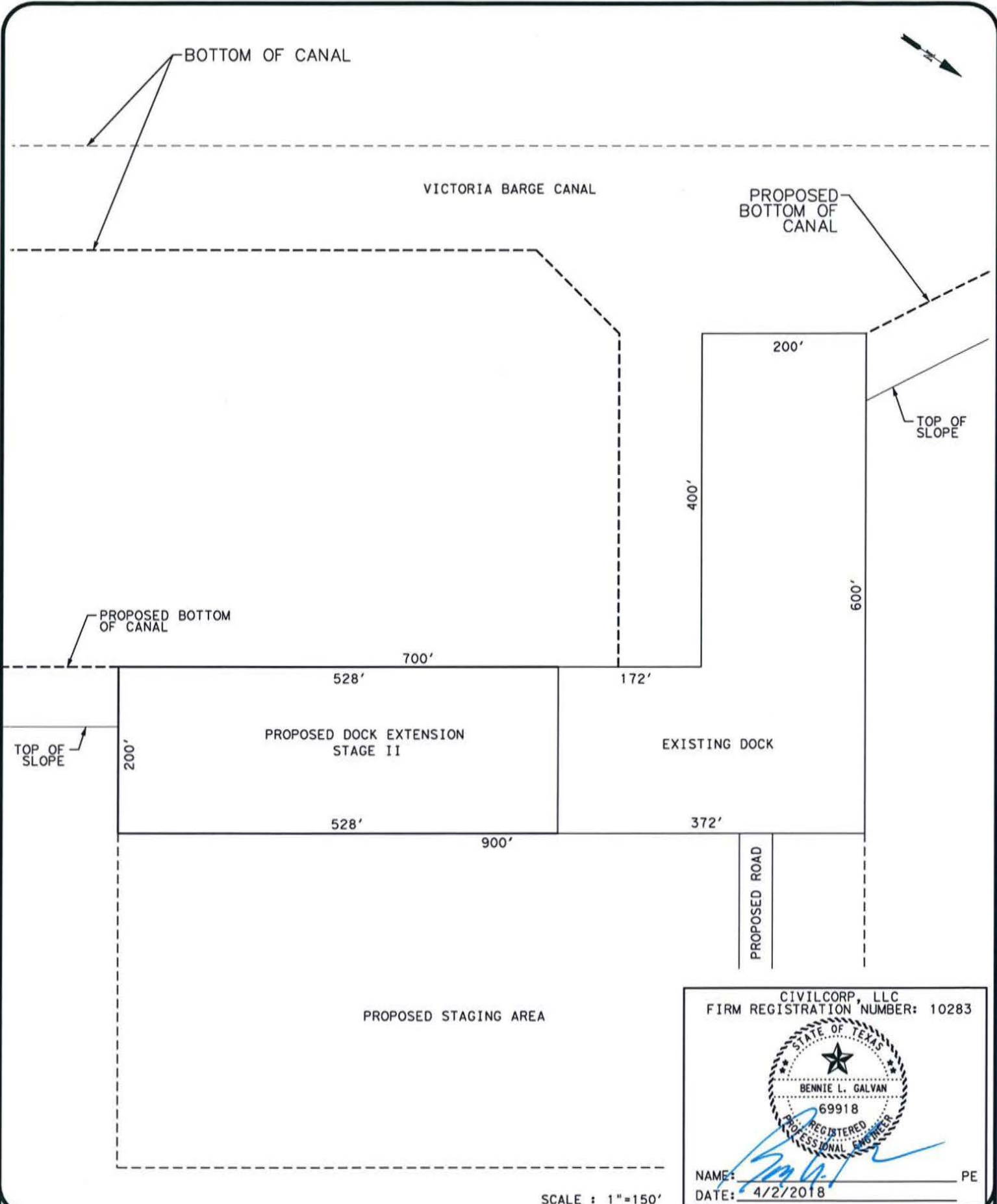

CIVILCORP, LLC
 FIRM REGISTRATION NUMBER: 10283

NAME: [Signature] PE
 DATE: 4/2/2018

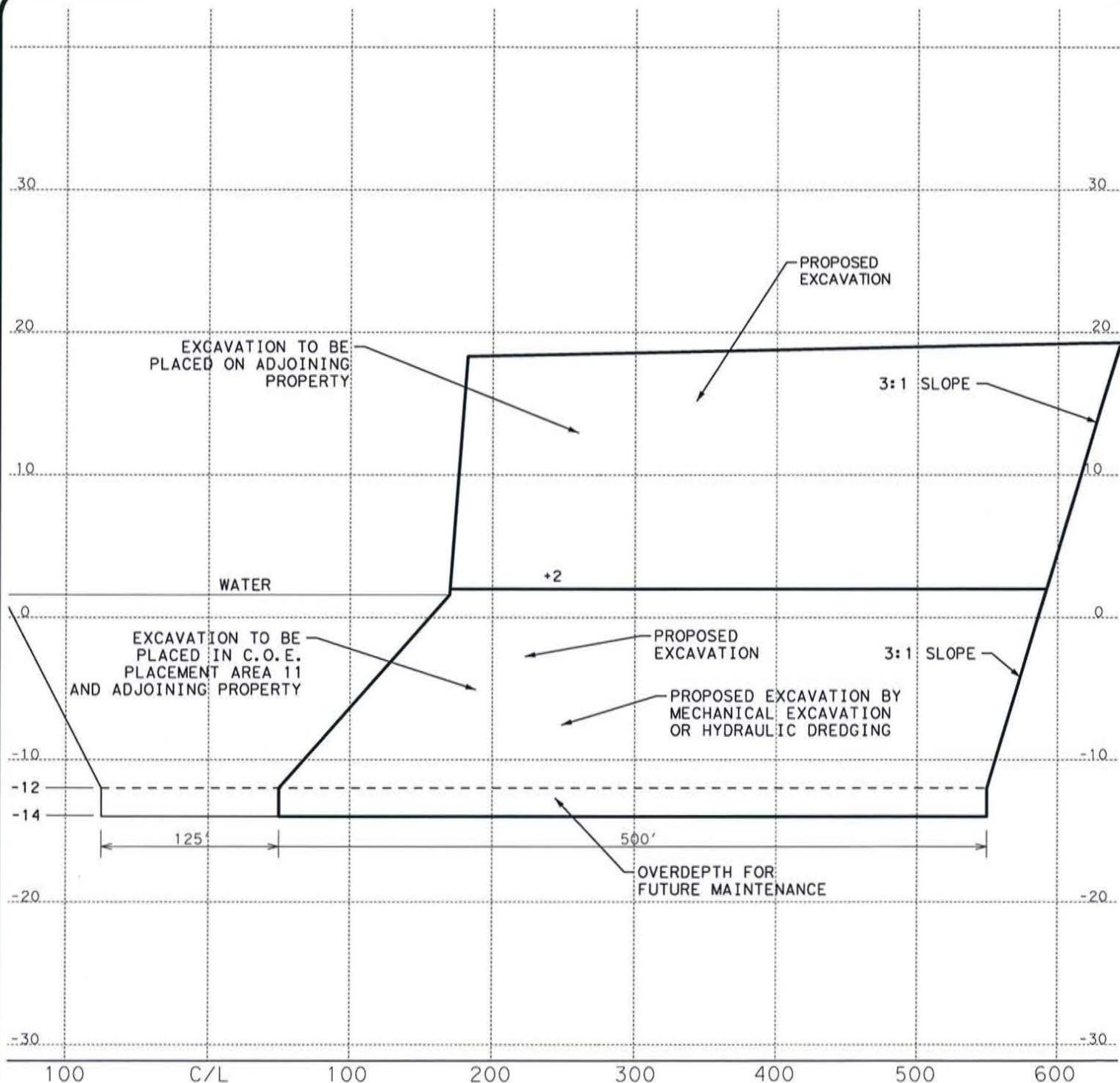

STA 1663+30

CIVILCORP, LLC
 FIRM REGISTRATION NUMBER: 10283

NAME: *Bennie L. Galvan* PE
 DATE: 4/2/2018

Civil Corp
 ENGINEERS • SURVEYORS
 4611 AIRLINE ROAD, SUITE 300, VICTORIA, TEXAS 77904
 TEL: (361) 570-7500 FAX: (361) 570-7501
 TBPE REGISTRATION #F-10283 TBPLS REGISTRATION #100576-00

TYPICAL X-SEC VICTORIA BARGE
 CANAL STA. 1625+00 & 1663+30

UPDATED DRAWINGS FOR PERMIT
 RENEWAL SWG-2006-01921

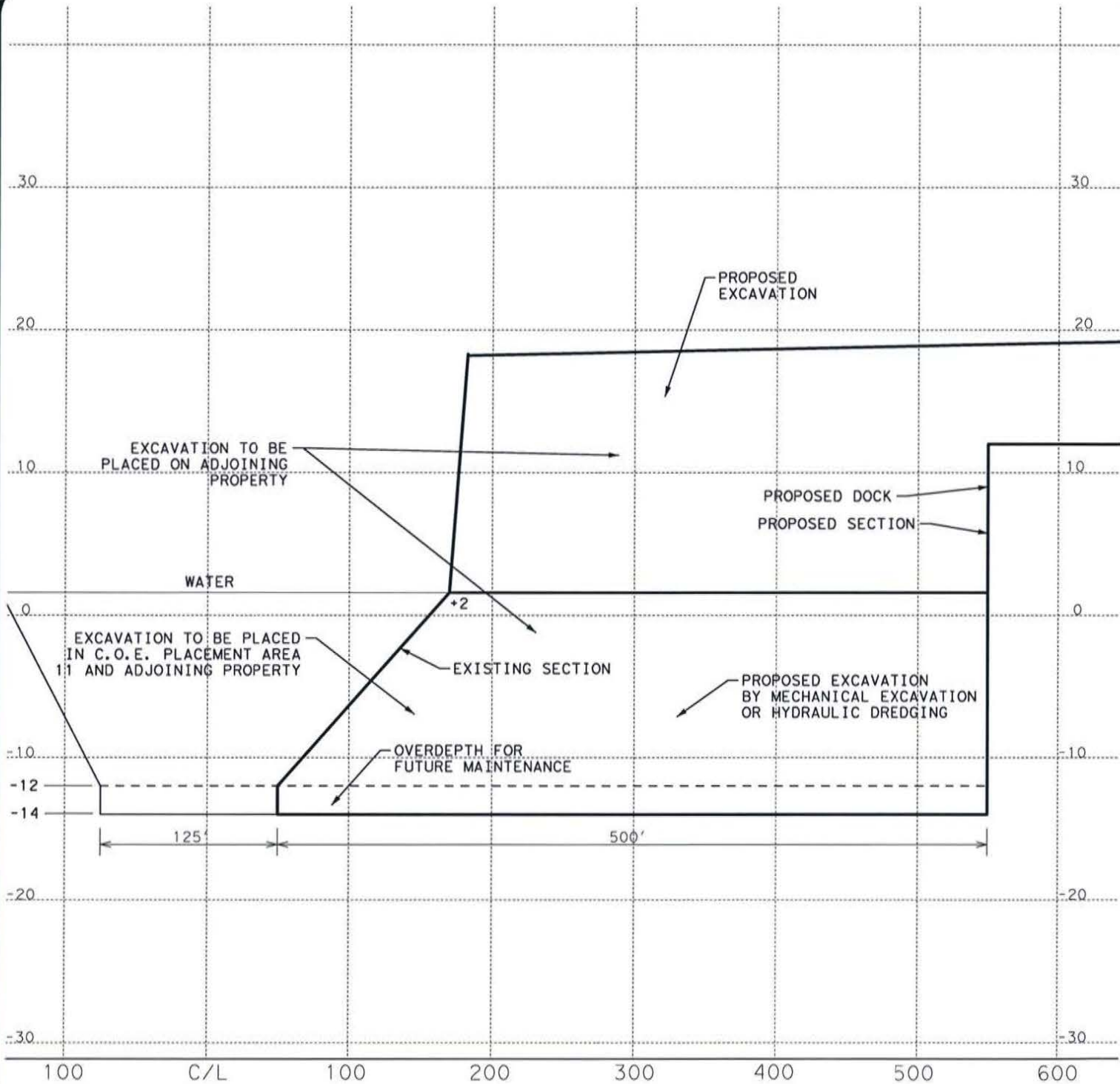

STA 1680+00

CIVILCORP, LLC
 FIRM REGISTRATION NUMBER: 10283

NAME: *Bennie L. Galvan* PE
 DATE: 4/3/2018

CivilCorp
 ENGINEERS • SURVEYORS
 4611 AIRLINE ROAD, SUITE 300, VICTORIA, TEXAS 77904
 TEL: (361) 570-7500 FAX: (361) 570-7501
 TBPE REGISTRATION #F-10283 TBPLS REGISTRATION #100576-00

TYPICAL X-SEC VICTORIA
 BARGE CANAL STA. 1680+00
 UPDATED DRAWINGS FOR PERMIT
 RENEWAL SWG-2006-01921

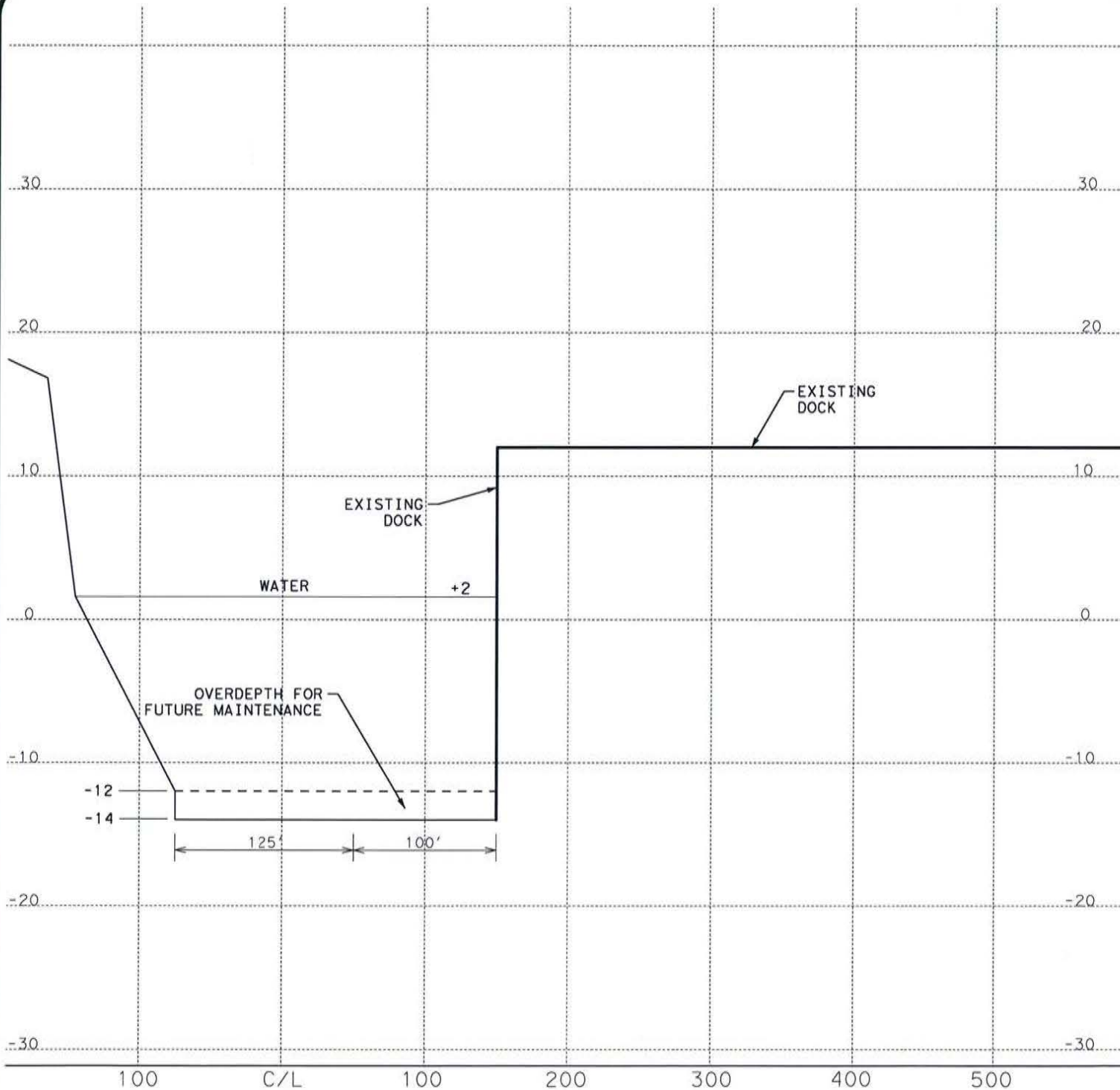

STA 1685+00

CIVILCORP, LLC
 FIRM REGISTRATION NUMBER: 10283

NAME: Bennie L. Galvan PE
 DATE: 4/2/2018

CivilCorp
 ENGINEERS • SURVEYORS
 4611 AIRLINE ROAD, SUITE 300, VICTORIA, TEXAS 77904
 TEL: (361) 570-7500 FAX: (361) 570-7501
 TBPE REGISTRATION #F-10283 TBPLS REGISTRATION #100576-00

TYPICAL X-SEC VICTORIA
 BARGE CANAL STA. 1685+00
 UPDATED DRAWINGS FOR PERMIT
 RENEWAL SWG-2006-01921