

3/26/2018 - P:\Y-2016\2016.0631\DWG\COE\REV 4\160631_C1_SEG11233_REV4.DWG

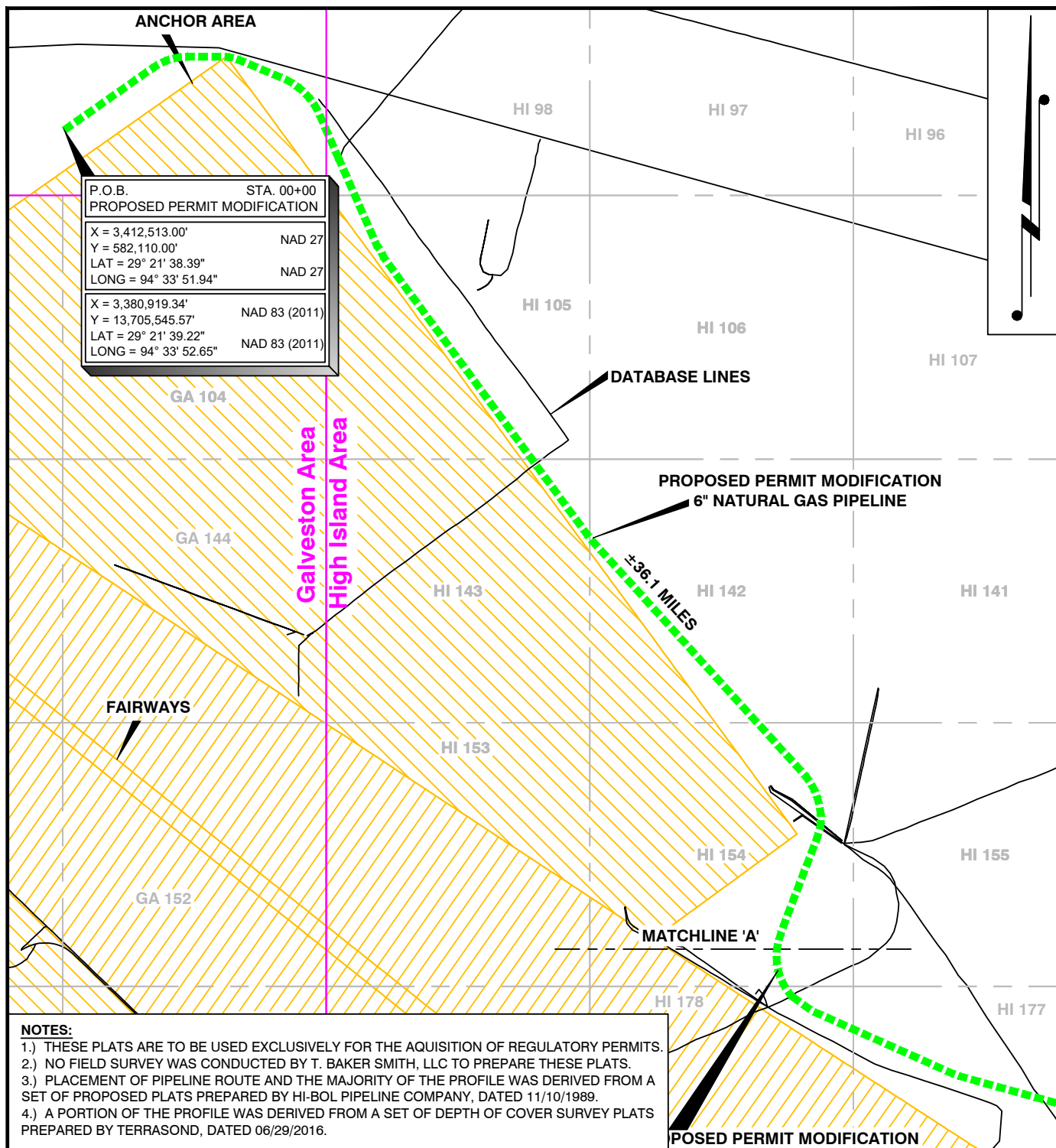

P.O.B.	STA. 00+00
PROPOSED PERMIT MODIFICATION	
X = 3,412,513.00'	NAD 27
Y = 582,110.00'	NAD 27
LAT = 29° 21' 38.39"	NAD 27
LONG = 94° 33' 51.94"	NAD 27
X = 3,380,919.34'	NAD 83 (2011)
Y = 13,705,545.57'	NAD 83 (2011)
LAT = 29° 21' 39.22"	NAD 83 (2011)
LONG = 94° 33' 52.65"	NAD 83 (2011)

NOTES:

- 1.) THESE PLATS ARE TO BE USED EXCLUSIVELY FOR THE ACQUISITION OF REGULATORY PERMITS.
- 2.) NO FIELD SURVEY WAS CONDUCTED BY T. BAKER SMITH, LLC TO PREPARE THESE PLATS.
- 3.) PLACEMENT OF PIPELINE ROUTE AND THE MAJORITY OF THE PROFILE WAS DERIVED FROM A SET OF PROPOSED PLATS PREPARED BY HI-BOL PIPELINE COMPANY, DATED 11/10/1989.
- 4.) A PORTION OF THE PROFILE WAS DERIVED FROM A SET OF DEPTH OF COVER SURVEY PLATS PREPARED BY TERRASOND, DATED 06/29/2016.

DRAWN BY: RRB APPROVED BY: JUL

DATE: 09/14/2016 JOB NO: 2016.0631

DRAWING NAME: 160631_C2_SEG11233_REV4.DWG

SHEET NO: 2 OF 6

PROJECTION: TEXAS SOUTH CENTRAL
GEO. DATUM: NAD27 | VERT. DATUM: NAVD88
GRID UNITS: US SURVEY FEET

SCALE: 1" = 1 MILE

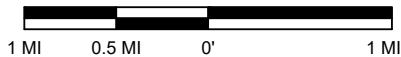

AREA MAP

HI BOL PIPELINE COMPANY
PROPOSED PERMIT MODIFICATION
HIGH ISLAND AREA
OFFSHORE TEXAS
GULF OF MEXICO



REV. NO: 4 REV. DATE: 03/26/2018 REV. BY: RLV

REVISION DESCRIPTION:
REVISED TAGS.

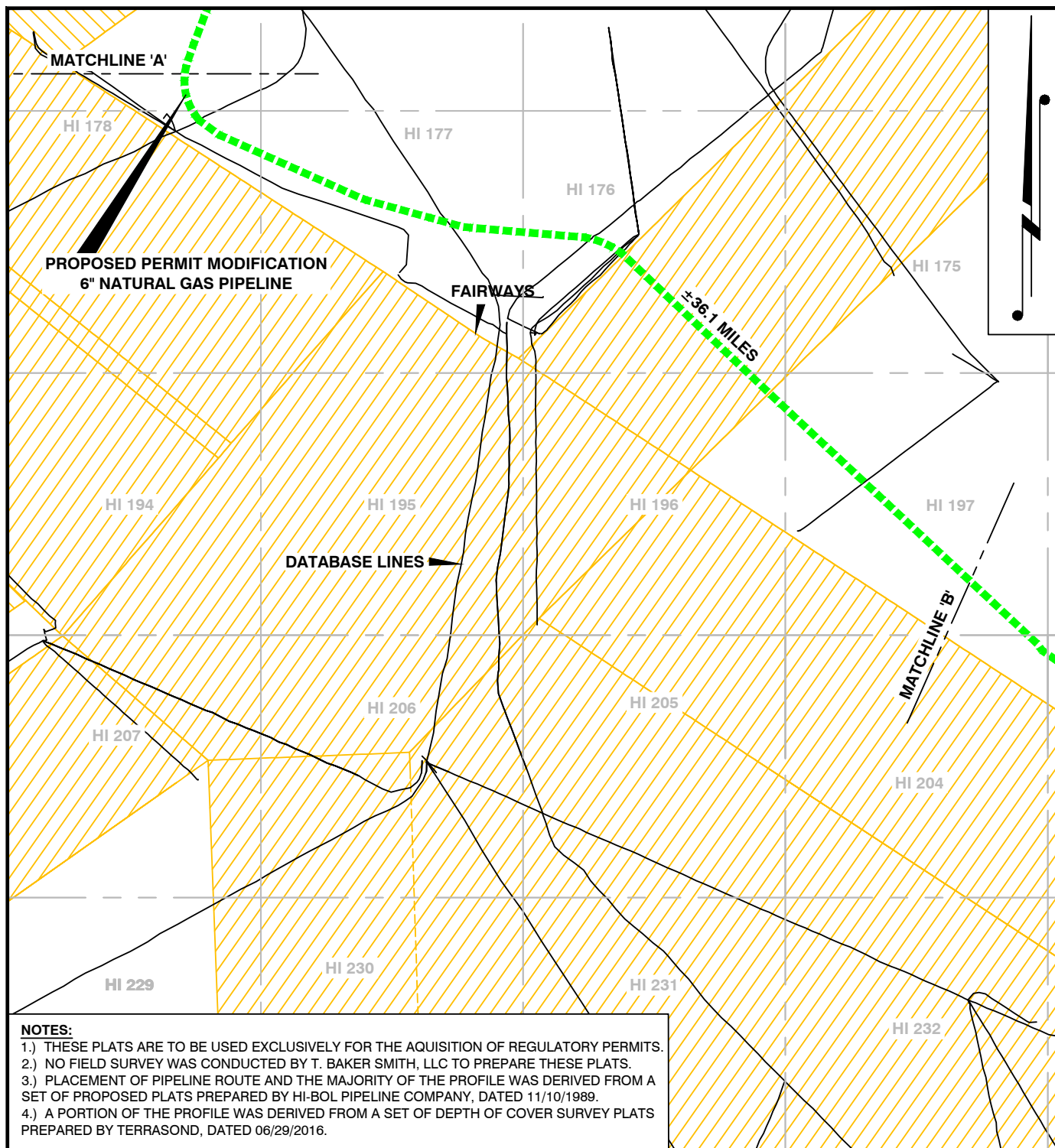

NOTES:

- 1.) THESE PLATS ARE TO BE USED EXCLUSIVELY FOR THE ACQUISITION OF REGULATORY PERMITS.
- 2.) NO FIELD SURVEY WAS CONDUCTED BY T. BAKER SMITH, LLC TO PREPARE THESE PLATS.
- 3.) PLACEMENT OF PIPELINE ROUTE AND THE MAJORITY OF THE PROFILE WAS DERIVED FROM A SET OF PROPOSED PLATS PREPARED BY HI-BOL PIPELINE COMPANY, DATED 11/10/1989.
- 4.) A PORTION OF THE PROFILE WAS DERIVED FROM A SET OF DEPTH OF COVER SURVEY PLATS PREPARED BY TERRASOND, DATED 06/29/2016.

DRAWN BY: RRB APPROVED BY: JUL

DATE: 09/14/2016 JOB NO: 2016.0631

DRAWING NAME: 160631_C2_SEG11233_REV4.DWG

SHEET NO: 3 OF 6

PROJECTION: TEXAS SOUTH CENTRAL
GEO. DATUM: NAD27 | VERT. DATUM: NAVD88
GRID UNITS: US SURVEY FEET

SCALE: 1" = 1 MILE

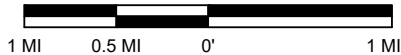

AREA MAP

**HI BOL PIPELINE COMPANY
PROPOSED PERMIT MODIFICATION
HIGH ISLAND AREA
OFFSHORE TEXAS
GULF OF MEXICO**



T. BAKER SMITH
SOLUTIONS START HERE
107 Global Circle, Lafayette, LA 70503
(337) 735-2000 - tbsmith.com

REV. NO: 4 REV. DATE: 03/26/2018 REV. BY: RLV

REVISION DESCRIPTION:
REVISED TAGS.

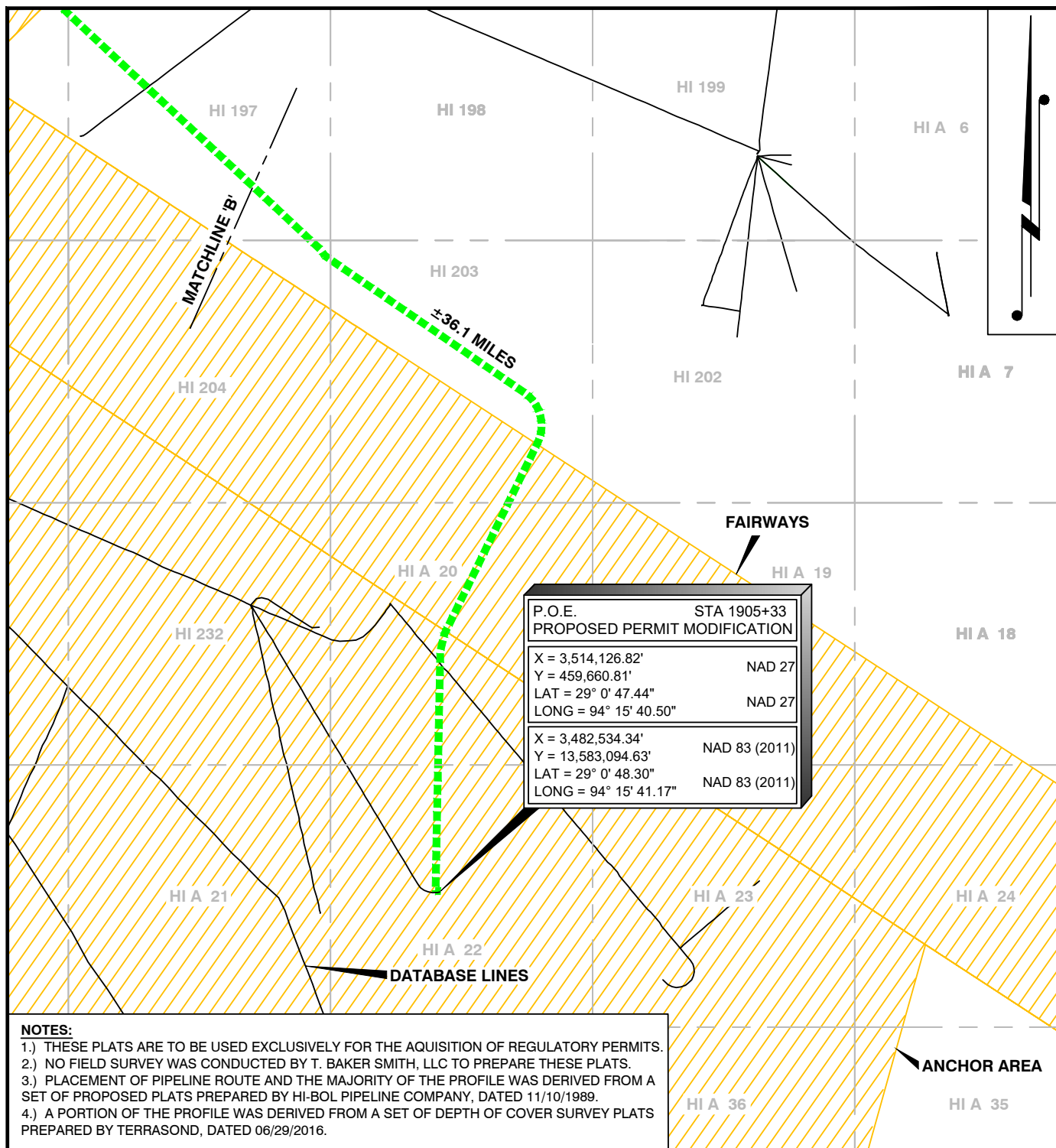

NOTES:

- 1.) THESE PLATS ARE TO BE USED EXCLUSIVELY FOR THE ACQUISITION OF REGULATORY PERMITS.
- 2.) NO FIELD SURVEY WAS CONDUCTED BY T. BAKER SMITH, LLC TO PREPARE THESE PLATS.
- 3.) PLACEMENT OF PIPELINE ROUTE AND THE MAJORITY OF THE PROFILE WAS DERIVED FROM A SET OF PROPOSED PLATS PREPARED BY HI-BOL PIPELINE COMPANY, DATED 11/10/1989.
- 4.) A PORTION OF THE PROFILE WAS DERIVED FROM A SET OF DEPTH OF COVER SURVEY PLATS PREPARED BY TERRASOND, DATED 06/29/2016.

DRAWN BY: RRB APPROVED BY: JUL

DATE: 09/14/2016 JOB NO: 2016.0631

DRAWING NAME: 160631_C2_SEG11233_REV4.DWG

SHEET NO: 4 OF 6

PROJECTION: TEXAS SOUTH CENTRAL
GEO. DATUM: NAD27 | VERT. DATUM: NAVD88
GRID UNITS: US SURVEY FEET

SCALE: 1" = 1 MILE

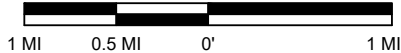

AREA MAP

HI BOL PIPELINE COMPANY
PROPOSED PERMIT MODIFICATION
HIGH ISLAND AREA
OFFSHORE TEXAS
GULF OF MEXICO



REV. NO: 4 REV. DATE: 03/26/2018 REV. BY: RLV

REVISION DESCRIPTION:
REVISED TAGS.

LEGEND:

- = NATURAL BOTTOM
- - - = TOP OF PIPE (HI-BOL)
- = TOP OF PIPE (TERRASOND)

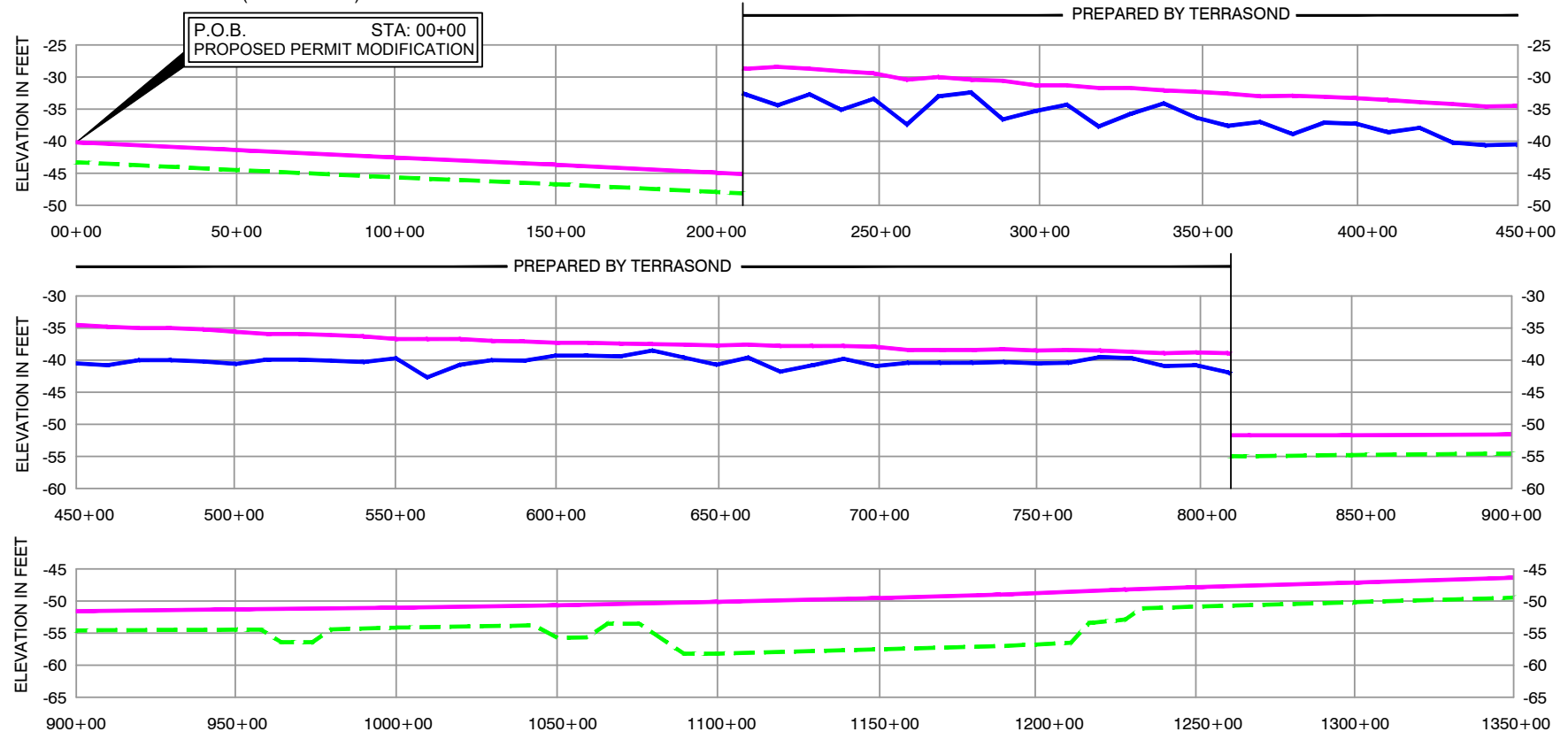

NOTES:

- 1.) THESE PLATS ARE TO BE USED EXCLUSIVELY FOR THE ACQUISITION OF REGULATORY PERMITS.
- 2.) NO FIELD SURVEY WAS CONDUCTED BY T. BAKER SMITH, LLC TO PREPARE THESE PLATS.
- 3.) PLACEMENT OF PIPELINE ROUTE AND THE MAJORITY OF THE PROFILE WAS DERIVED FROM A SET OF PROPOSED PLATS PREPARED BY HI-BOL PIPELINE COMPANY, DATED 11/10/1989.
- 4.) A PORTION OF THE PROFILE WAS DERIVED FROM A SET OF DEPTH OF COVER SURVEY PLATS PREPARED BY TERRASOND, DATED 06/29/2016.

SEG 11233 - PROFILE VIEW

HORIZONTAL SCALE: 1" = 5,000'

VERTICAL SCALE: 1" = 50'

SCALE IN FEET

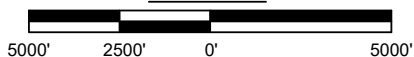

T. BAKER SMITH
SOLUTIONS START HERE
107 Global Circle, Lafayette, LA 70503
(337) 735-2800 - tbsmith.com

REV. NO: 4 REV. DATE: 03/26/2018 REV. BY: RLV

DRAWN BY: RRB APPROVED BY: JLL

DATE: 09/14/2016 JOB NO: 2016.0631

DRAWING NAME: 160631_C3_SEG11233_REV4.DWG

SHEET NO: 5 OF 6

PROJECTION: TEXAS SOUTH CENTRAL
GEO. DATUM: NAD27 | VERT. DATUM: NAVD88
GRID UNITS: US SURVEY FEET

REVISION DESCRIPTION:
REVISED TAGS.

PROFILE

HI BOL PIPELINE COMPANY
PROPOSED PERMIT MODIFICATION
HIGH ISLAND AREA
OFFSHORE TEXAS
GULF OF MEXICO

— = NATURAL BOTTOM
- - - = TOP OF PIPE (HI-BOL)

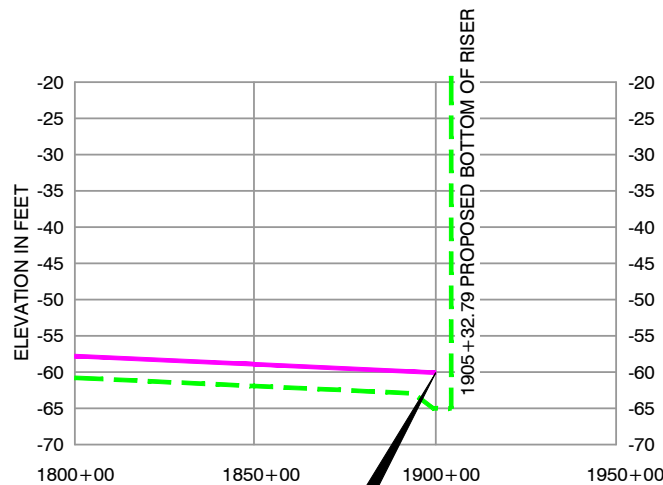
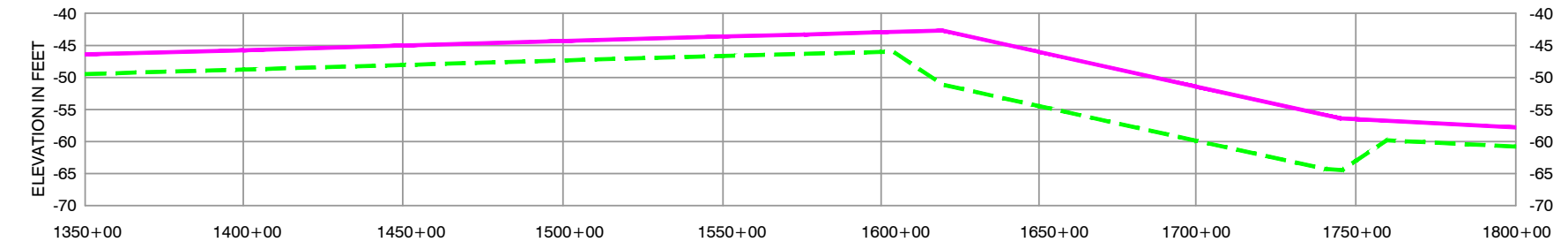

P.O.E. STA: 1905+33
PROPOSED PERMIT MODIFICATION

SEG 11233 - PROFILE VIEW

HORIZONTAL SCALE: 1" = 5,000'

VERTICAL SCALE: 1" = 50'

NOTES:

- 1.) THESE PLATS ARE TO BE USED EXCLUSIVELY FOR THE ACQUISITION OF REGULATORY PERMITS.
- 2.) NO FIELD SURVEY WAS CONDUCTED BY T. BAKER SMITH, LLC TO PREPARE THESE PLATS.
- 3.) PLACEMENT OF PIPELINE ROUTE AND THE MAJORITY OF THE PROFILE WAS DERIVED FROM A SET OF PROPOSED PLATS PREPARED BY HI-BOL PIPELINE COMPANY, DATED 11/10/1989.
- 4.) A PORTION OF THE PROFILE WAS DERIVED FROM A SET OF DEPTH OF COVER SURVEY PLATS PREPARED BY TERRASO, DATED 06/29/2016.

SCALE IN FEET

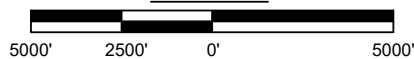

REV. NO: 4 REV. DATE: 03/26/2018 REV. BY: RLV

DRAWN BY: RRB APPROVED BY: JLL

DATE: 09/14/2016 JOB NO: 2016.0631

DRAWING NAME: 160631_C3_SEG11233_REV4.DWG

SHEET NO: 6 OF 6

PROJECTION: TEXAS SOUTH CENTRAL
GEO. DATUM: NAD27 | VERT. DATUM: NAVD88
GRID UNITS: US SURVEY FEET

REVISION DESCRIPTION:
REVISED TAGS.

PROFILE

HI BOL PIPELINE COMPANY
PROPOSED PERMIT MODIFICATION
HIGH ISLAND AREA
OFFSHORE TEXAS
GULF OF MEXICO