

SWG-2018-00137
Fort Bend County
Page 1 of 13



Sources: Esri, HERE, DeLorme, USGS, Intermap, increment P Corp., NRCAN, Esri Japan, METI, Esri China (Hong Kong), Esri (Thailand), TomTom, MapmyIndia, © OpenStreetMap contributors, and the GIS User Community

SITE VICINITY MAP

Project #: 10161N-IP
 For: Fort Bend County Engineering Department
 Location: Proposed Lake Olympia Prky.
Fort Bend County, Texas

REVISIONS

BERG ♦ OLIVER ASSOCIATES, INC.

ENVIRONMENTAL SCIENCE & LAND USE CONSULTANTS
 14701 ST. MARY'S LANE, SUITE 400
 HOUSTON, TEXAS 77079 PHONE (281)589-0898 <http://www.bergoliver.com>



SWG-2018-00137
 Fort Bend County
 Page 2 of 13



Sources: Esri, HERE, DeLorme, USGS, Intermap, increment P Corp., NRCAN, Esri Japan, METI, Esri China (Hong Kong), Esri (Thailand), TomTom, MapmyIndia, © OpenStreetMap contributors, and the GIS User Community

SITE LOCATION MAP

Project #: 10161N-IP
 For: Fort Bend County Engineering Department
 Location: Proposed Lake Olympia Prky.
Fort Bend County, Texas

REVISIONS

BERG•OLIVER ASSOCIATES, INC.
 ENVIRONMENTAL SCIENCE & LAND USE CONSULTANTS
 14701 ST. MARY'S LANE, SUITE 400
 HOUSTON, TEXAS 77079 PHONE (281)589-0898 <http://www.bergoliver.com>



SWG-2018-00137
 Fort Bend County
 Page 3 of 13

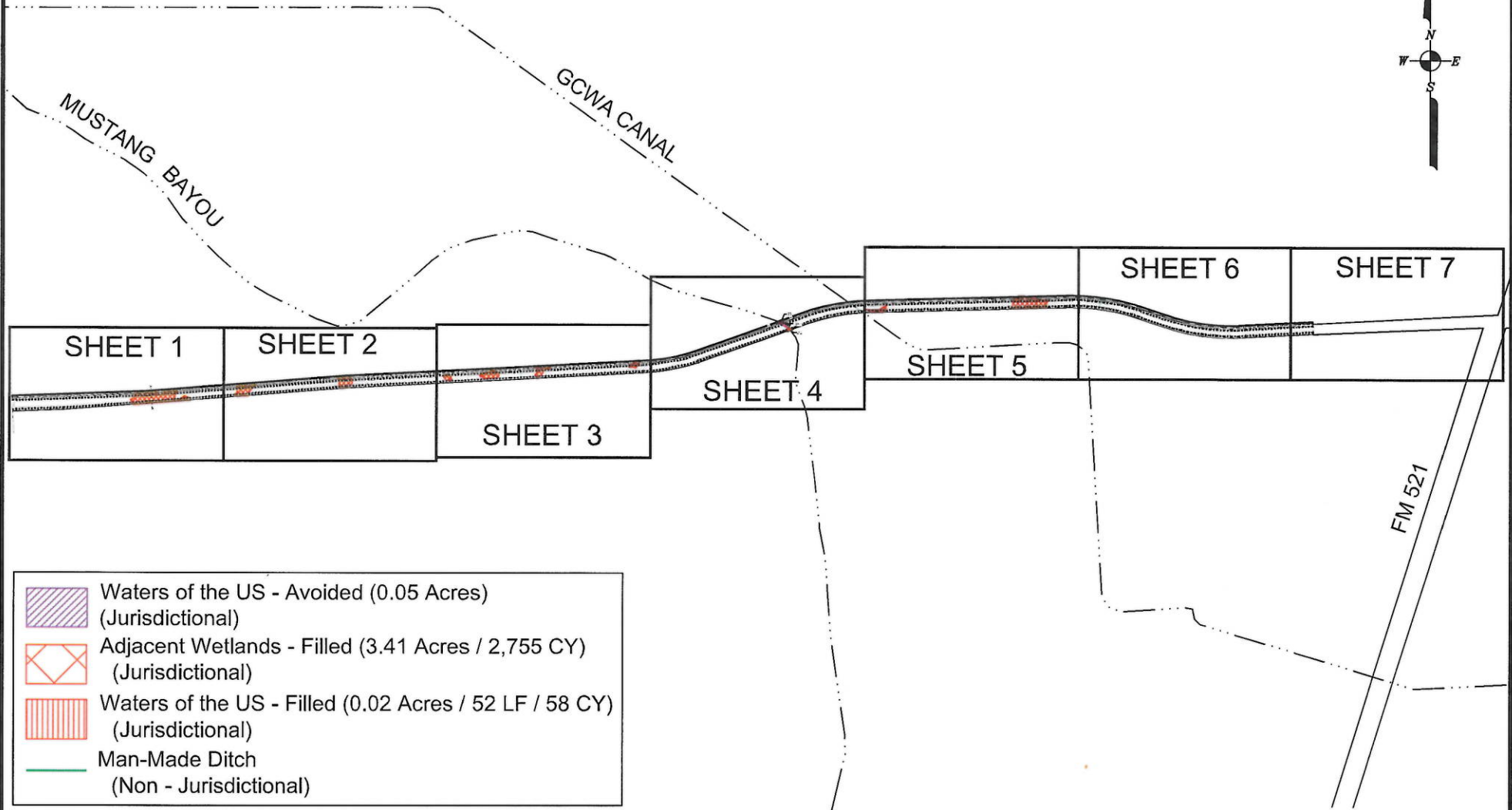

PROPOSED LAKE OLYMPIA PARKWAY
 OVERVIEW

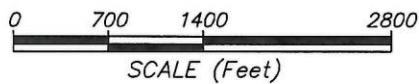

PROJECT #: 10161N-IP
 FOR: Fort Bend County Engineering Department
 LOCATION: Proposed Lake Olympia Prky.
 Fort Bend County, Texas

REVISIONS:
Jan. 25, 2018 by MDB
Feb. 12, 2018 by MDB

BERG OLIVER ASSOCIATES, INC.
 ENVIRONMENTAL SCIENCE &
 LAND USE CONSULTANTS
 14701 ST. MARY'S LANE, SUITE 400 HOUSTON, TX 77079
 PHONE (281) 589-0898 <http://www.bergoliver.com>



SWG-2018-00137
 Fort Bend County
 Page 4 of 13

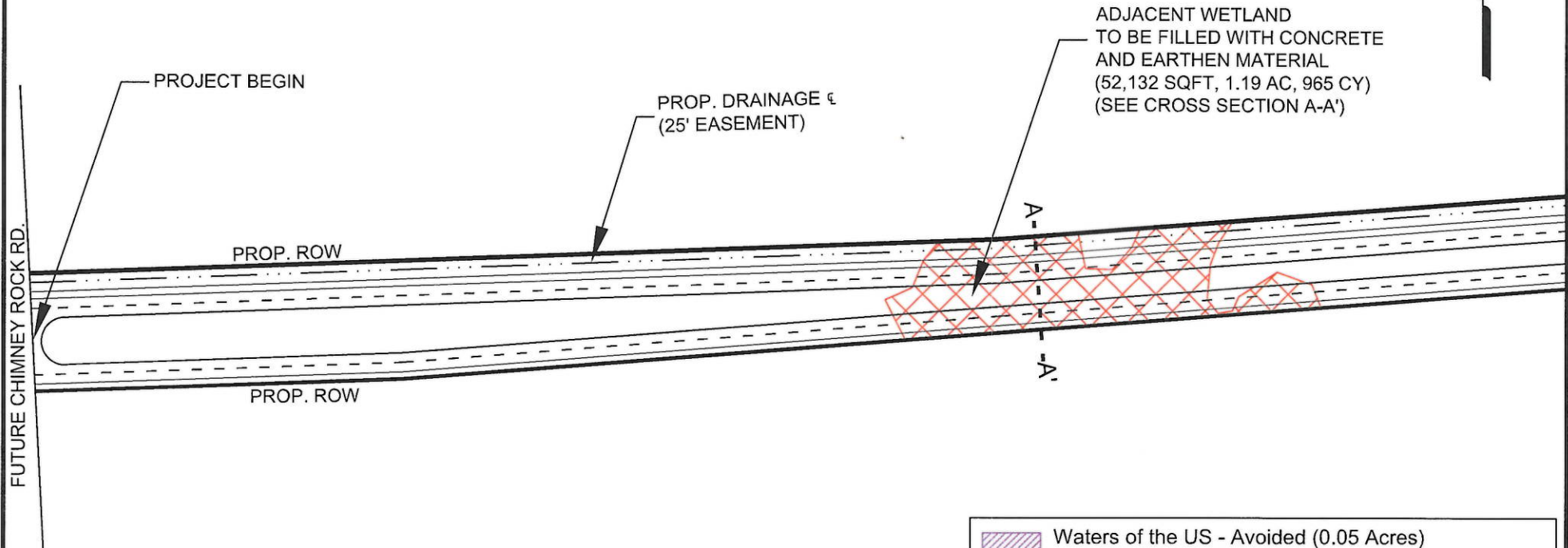

- Waters of the US - Avoided (0.05 Acres) (Jurisdictional)
- Adjacent Wetlands - Filled (3.41 Acres / 2,755 CY) (Jurisdictional)
- Waters of the US - Filled (0.02 Acres / 52 LF / 58 CY) (Jurisdictional)
- Man-Made Ditch (Non - Jurisdictional)

PROPOSED LAKE OLYMPIA PARKWAY
 SHEET 1 OF 7

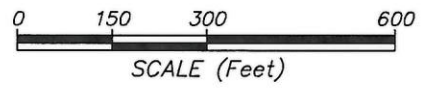

PROJECT #: 10161N-IP
 FOR: Fort Bend County Engineering Department
 LOCATION: Proposed Lake Olympia Prky.
Fort Bend County, Texas

REVISIONS:
Feb. 12, 2018 by MDB

BERG-OLIVER ASSOCIATES, INC.
 ENVIRONMENTAL SCIENCE &
 LAND USE CONSULTANTS
 14701 ST. MARY'S LANE, SUITE 400 HOUSTON, TX 77079
 PHONE (281) 589-0898 <http://www.bergoliver.com>



SWG-2018-00137
 Fort Bend County
 Page 5 of 13

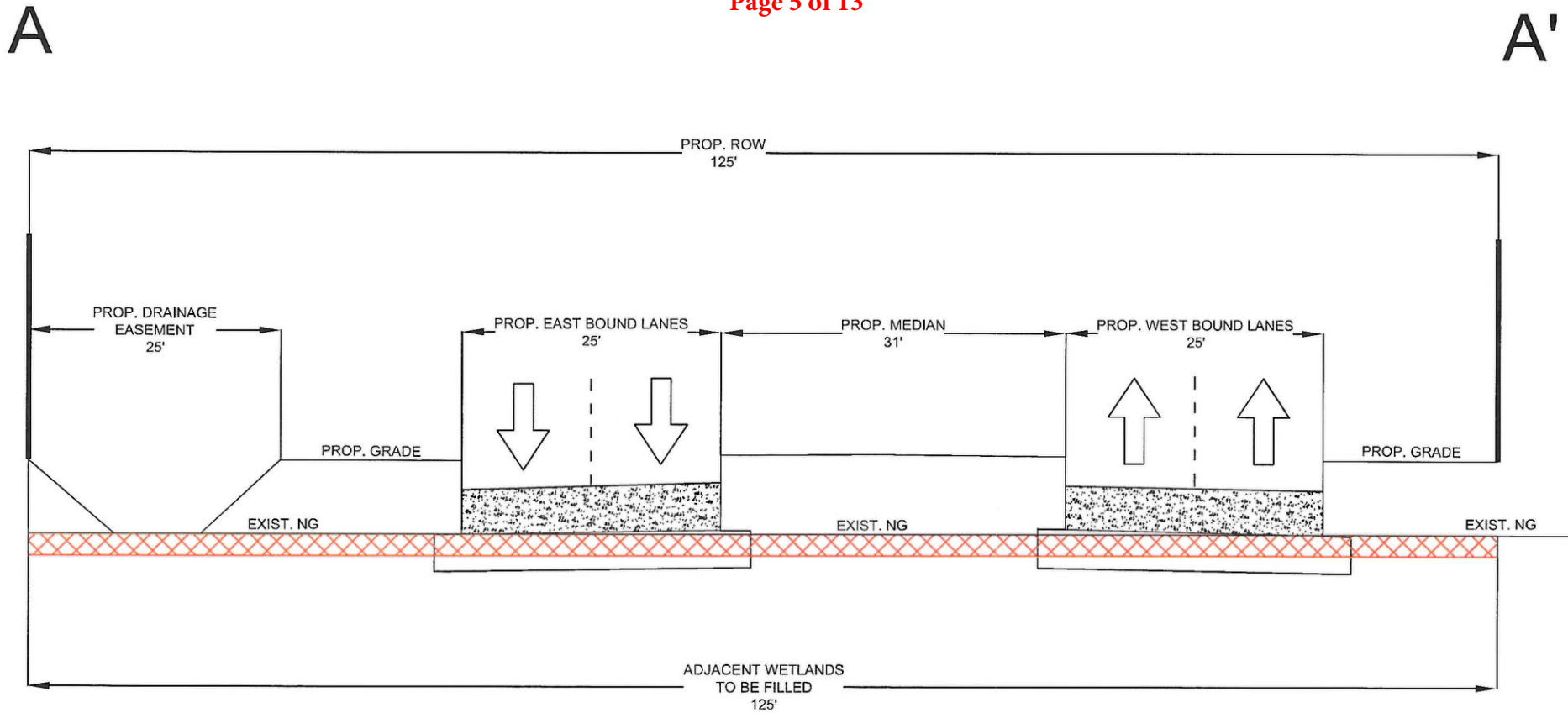

**PROPOSED LAKE OLYMPIA PARKWAY
 TYPICAL CROSS SECTION A-A'**

PROJECT #: 10161N-IP
 FOR: Fort Bend County Engineering Department
 LOCATION: Proposed Lake Olympia Prky.
Fort Bend County, Texas

REVISIONS:
Feb. 12, 2018 by MDB

BERG • OLIVER ASSOCIATES, INC.
 ENVIRONMENTAL SCIENCE &
 LAND USE CONSULTANTS
 14701 ST. MARY'S LANE, SUITE 400 HOUSTON, TX 77079
 PHONE (281) 589-0898 <http://www.bergoliver.com>



SWG-2018-00137
Fort Bend County
Page 6 of 13

-  Waters of the US - Avoided (0.05 Acres)
(Jurisdictional)
-  Adjacent Wetlands - Filled (3.41 Acres / 2,755 CY)
(Jurisdictional)
-  Waters of the US - Filled (0.02 Acres / 52 LF / 58 CY)
(Jurisdictional)
-  Man-Made Ditch
(Non - Jurisdictional)

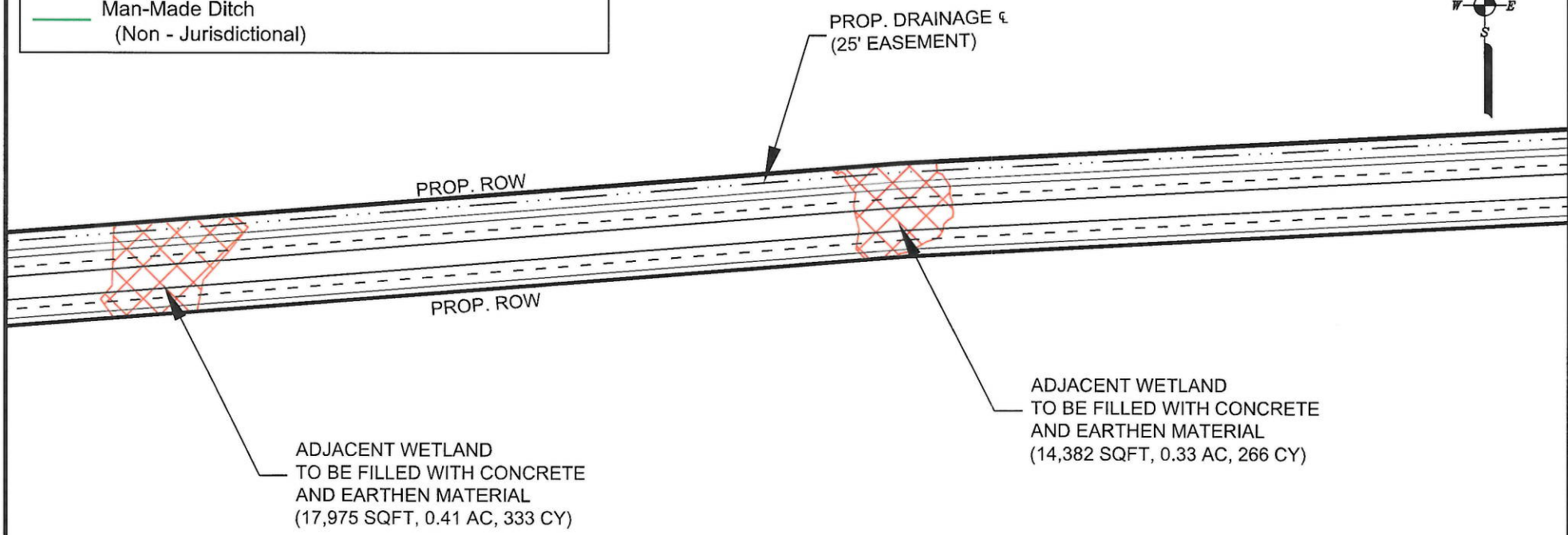
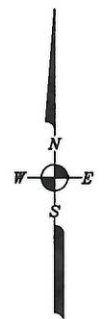

PROPOSED LAKE OLYMPIA PARKWAY
SHEET 2 OF 7

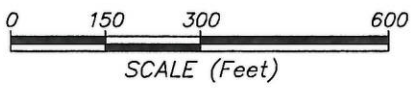

PROJECT #: 10161N-IP
 FOR: Fort Bend County Engineering Department
 LOCATION: Proposed Lake Olympia Prky.
Fort Bend County, Texas

REVISIONS:
Jan. 25, 2018 by MDB
Feb. 12, 2018 by MDB

BERG•OLIVER ASSOCIATES, INC.
 ENVIRONMENTAL SCIENCE &
 LAND USE CONSULTANTS
 14701 ST. MARY'S LANE, SUITE 400 HOUSTON, TX 77079
 PHONE (281) 569-0898 <http://www.bergoliver.com>



SWG-2018-00137
Fort Bend County
Page 7 of 13

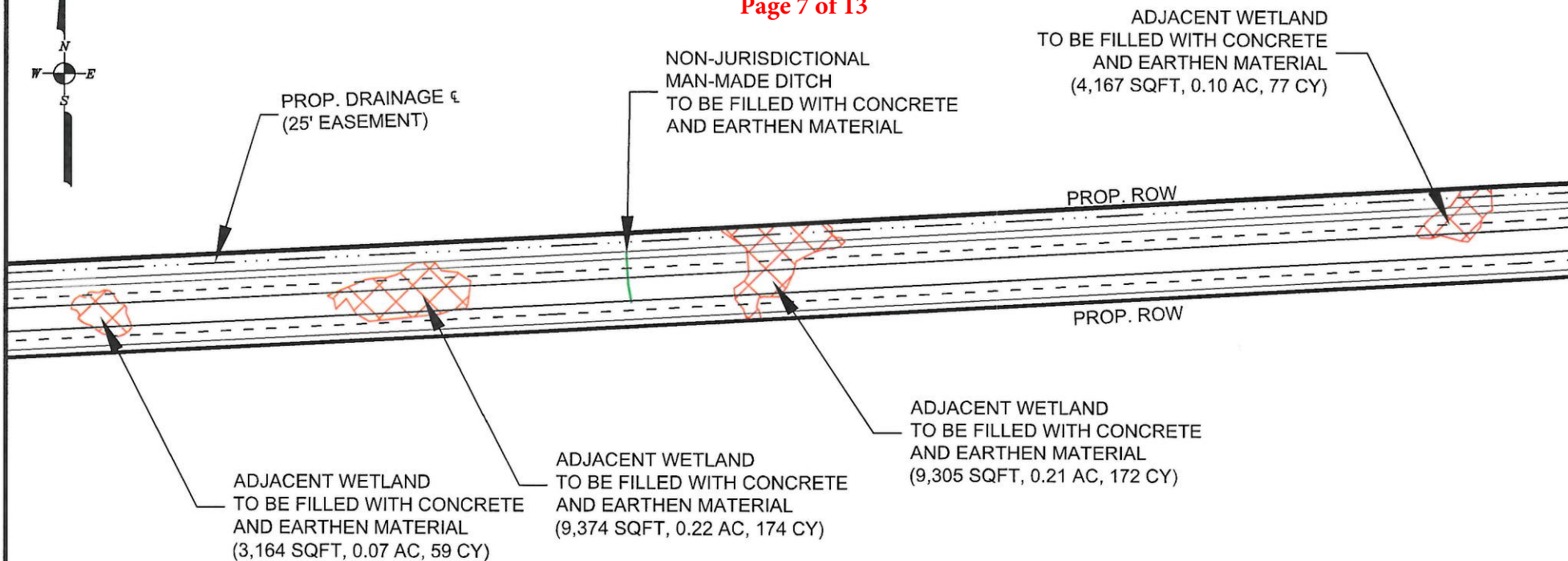
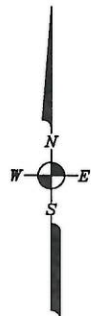

	Waters of the US - Avoided (0.05 Acres) (Jurisdictional)
	Adjacent Wetlands - Filled (3.41 Acres / 2,755 CY) (Jurisdictional)
	Waters of the US - Filled (0.02 Acres / 52 LF / 58 CY) (Jurisdictional)
	Man-Made Ditch (Non - Jurisdictional)

PROPOSED LAKE OLYMPIA PARKWAY
SHEET 3 OF 7

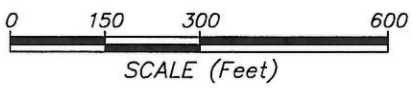

PROJECT #: 10161N-IP
 FOR: Fort Bend County Engineering Department
 LOCATION: Proposed Lake Olympia Prky.
Fort Bend County, Texas

REVISIONS:
Jan. 25, 2018 by MDB
Feb. 12, 2018 by MDB

BERG • OLIVER ASSOCIATES, INC.
 ENVIRONMENTAL SCIENCE &
 LAND USE CONSULTANTS
 14701 ST. MARY'S LANE, SUITE 400 HOUSTON, TX 77079
 PHONE (281) 589-0898 <http://www.bergoliver.com>



SWG-2018-00137
Fort Bend County
Page 8 of 13

NON-JURISDICTIONAL
 GCWA CANAL
 TO BE SPANNED

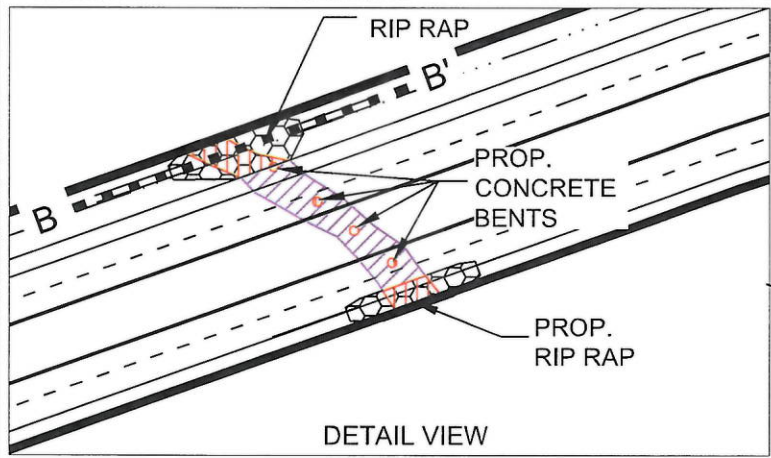

MUSTANG BAYOU

PROP. CROSSING
 WATERS OF THE US
 TO BE FILLED WITH RIP RAP
 AND CONCRETE BENTS
 (1,035 SQFT, 0.02 AC, 58 CY, 52 LF)
 (SEE DETAIL VIEW AND CROSS
 SECTION B-B')

PROP. DRAINAGE €
 (25' EASEMENT)

PROP. ROW

PROP. ROW

-  Waters of the US - Avoided (0.05 Acres)
(Jurisdictional)
-  Adjacent Wetlands - Filled (3.41 Acres / 2,755 CY)
(Jurisdictional)
-  Waters of the US - Filled (0.02 Acres / 52 LF / 58 CY)
(Jurisdictional)
-  Man-Made Ditch
(Non - Jurisdictional)

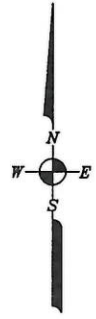

PROPOSED LAKE OLYMPIA PARKWAY
SHEET 4 OF 7

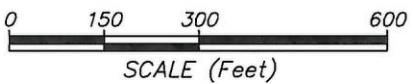

PROJECT #: 10161N-IP
 FOR: Fort Bend County Engineering Department
 LOCATION: Proposed Lake Olympia Prky.
Fort Bend County, Texas

REVISIONS:
Jan. 25, 2018 by MDB
Feb. 12, 2018 by MDB

BERG & OLIVER ASSOCIATES, INC.
 ENVIRONMENTAL SCIENCE &
 LAND USE CONSULTANTS
 14701 ST. MARY'S LANE, SUITE 400 HOUSTON, TX 77079
 PHONE (281) 589-0898 <http://www.bergoliver.com>



B

B'

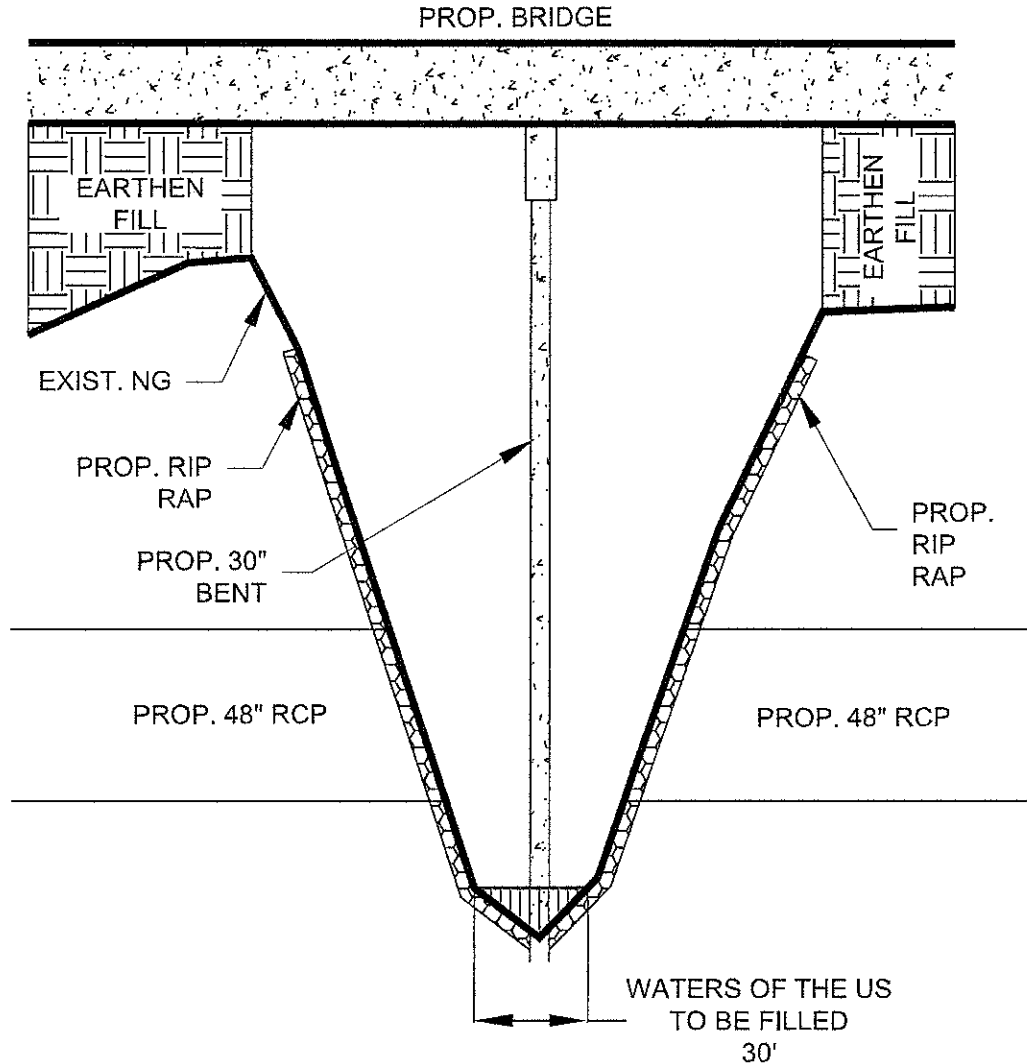

**PROPOSED LAKE OLYMPIA PARKWAY
 TYPICAL CROSS SECTION B-B'**

NOT TO SCALE

PROJECT #: 10161N-IP
 FOR: Fort Bend County Engineering Department
 LOCATION: Proposed Lake Olympia Prky.
Fort Bend County, Texas

REVISIONS:
Feb. 12, 2018 by MDE

BERG • OLIVER ASSOCIATES, INC.
 ENVIRONMENTAL SCIENCE &
 LAND USE CONSULTANTS
 14701 ST. MARY'S LANE, SUITE 400 HOUSTON, TX 77079
 PHONE (281) 689-0898 <http://www.bergoliver.com>



SWG-2018-00137
Fort Bend County
Page 10 of 13



ADJACENT WETLAND
 TO BE FILLED WITH CONCRETE
 AND EARTHEN MATERIAL
 (5,561 SQFT, 0.13 AC, 103 CY)

PROP. DRAINAGE E
 (25' EASEMENT)

ADJACENT WETLAND
 TO BE FILLED WITH CONCRETE
 AND EARTHEN MATERIAL
 (32,706 SQFT, 0.75 AC, 606 CY)

PROP. ROW

PROP. ROW

-  Waters of the US - Avoided (0.05 Acres)
(Jurisdictional)
-  Adjacent Wetlands - Filled (3.41 Acres / 2,755 CY)
(Jurisdictional)
-  Waters of the US - Filled (0.02 Acres / 52 LF / 58 CY)
(Jurisdictional)
-  Man-Made Ditch
(Non - Jurisdictional)

PROPOSED LAKE OLYMPIA PARKWAY
SHEET 5 OF 7

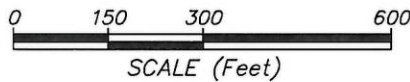

PROJECT #: 10161N-IP
 FOR: Fort Bend County Engineering Department
 LOCATION: Proposed Lake Olympia Prky.
Fort Bend County, Texas

REVISIONS:
Jan. 25, 2018 by MDB
Feb. 12, 2018 by MDB

BERG•OLIVER ASSOCIATES, INC.
 ENVIRONMENTAL SCIENCE &
 LAND USE CONSULTANTS
 14701 ST. MARY'S LANE, SUITE 400 HOUSTON, TX 77079
 PHONE (281) 589-0898 <http://www.bergoliver.com>





SWG-2018-00137
 Fort Bend County
 Page 11 of 13

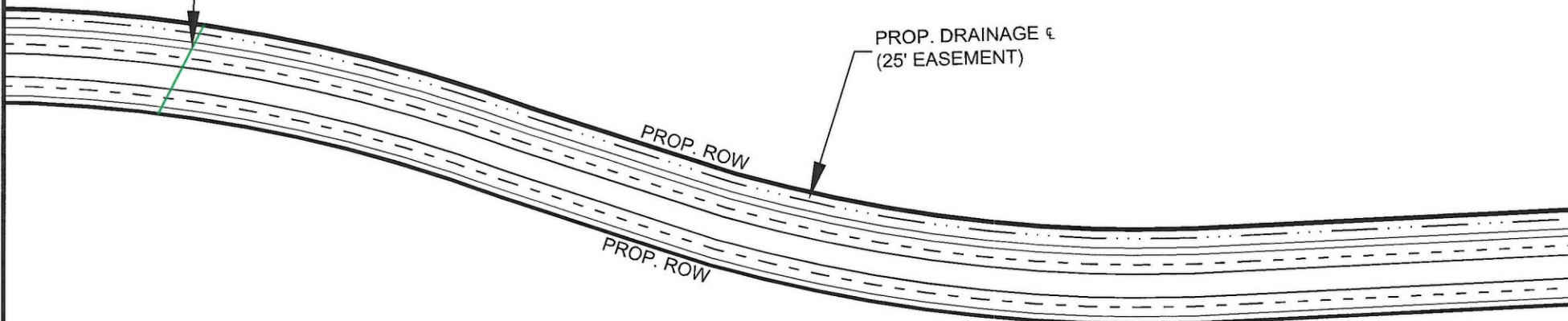

NON-JURISDICTIONAL
 MAN-MADE DITCH
 TO BE FILLED WITH CONCRETE
 AND EARTHEN MATERIAL

PROP. DRAINAGE ϵ
 (25' EASEMENT)



	Waters of the US - Avoided (0.05 Acres) (Jurisdictional)
	Adjacent Wetlands - Filled (3.41 Acres / 2,755 CY) (Jurisdictional)
	Waters of the US - Filled (0.02 Acres / 52 LF / 58 CY) (Jurisdictional)
	Man-Made Ditch (Non - Jurisdictional)

PROPOSED LAKE OLYMPIA PARKWAY
SHEET 6 OF 7

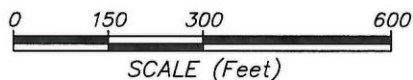

PROJECT #: 10161N-IP
 FOR: Fort Bend County Engineering Department
 LOCATION: Proposed Lake Olympia Prky.
Fort Bend County, Texas

REVISIONS:
Jan. 25, 2018 by MDB
Feb. 12, 2018 by MDB

BERG OLIVER ASSOCIATES, INC.
 ENVIRONMENTAL SCIENCE &
 LAND USE CONSULTANTS
 14701 ST. MARY'S LANE, SUITE 400 HOUSTON, TX 77079
 PHONE (281) 589-0898 <http://www.bergoliver.com>



SWG-2018-00137
Fort Bend County
Page 12 of 13

-  Waters of the US - Avoided (0.05 Acres)
(Jurisdictional)
-  Adjacent Wetlands - Filled (3.41 Acres / 2,755 CY)
(Jurisdictional)
-  Waters of the US - Filled (0.02 Acres / 52 LF / 58 CY)
(Jurisdictional)
-  Man-Made Ditch
(Non - Jurisdictional)

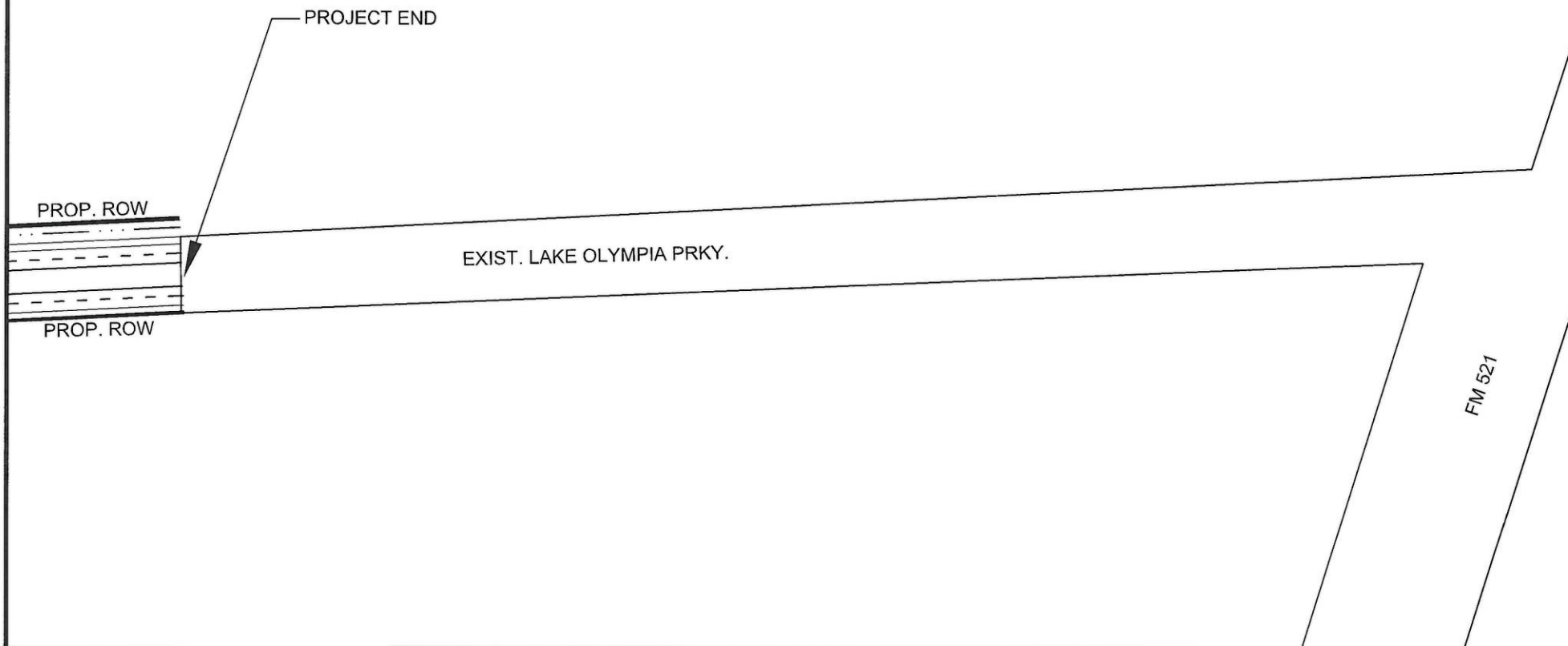
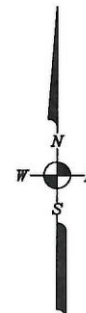

PROPOSED LAKE OLYMPIA PARKWAY
SHEET 7 OF 7

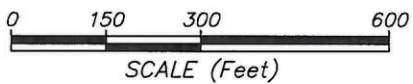

PROJECT #: 10161N-IP
 FOR: Fort Bend County Engineering Department
 LOCATION: Proposed Lake Olympia Prky.
Fort Bend County, Texas

REVISIONS:
Jan. 25, 2018 by MDB
Feb. 12, 2018 by MDB

BERG-OLIVER ASSOCIATES, INC.
 ENVIRONMENTAL SCIENCE &
 LAND USE CONSULTANTS
 14701 ST. MARY'S LANE, SUITE 400 HOUSTON, TX 77079
 PHONE (281) 589-0898 <http://www.bergoliver.com>



NOTE: Potential wetland and jurisdictional water areas depicted have been classified as "isolated" or "adjacent" based upon Berg-Oliver Associates, Inc.'s assessment of the jurisdictional designation of these potential wetland and water areas. The actual designations should be verified by the Corps of Engineers - the final authority on jurisdictional status.

NOTE: Approximate location of the 100-year floodplain as depicted was derived from digitized 2014 Federal Insurance Rate Maps (FIRM). The proper authorities, prior to any land planning or engineering activities, should verify the exact location of the 100-year floodplain.

SWG-2018-00137
Fort Bend County
Page 13 of 13

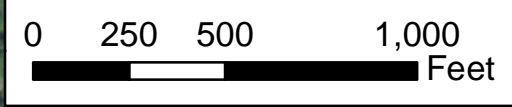
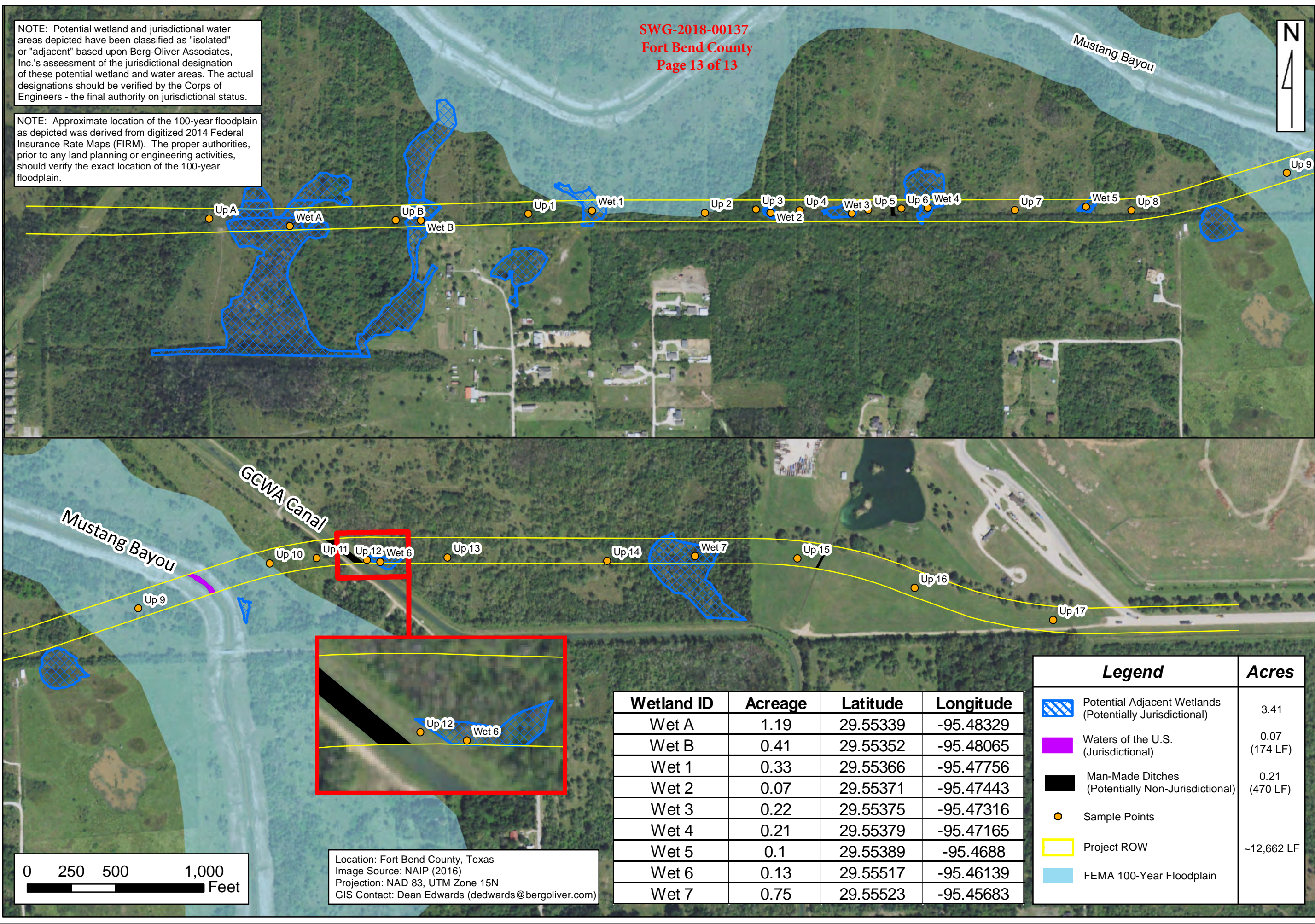

Location: Fort Bend County, Texas
Image Source: NAIP (2016)
Projection: NAD 83, UTM Zone 15N
GIS Contact: Dean Edwards (dedwards@bergoliver.com)

Wetland ID	Acreage	Latitude	Longitude
Wet A	1.19	29.55339	-95.48329
Wet B	0.41	29.55352	-95.48065
Wet 1	0.33	29.55366	-95.47756
Wet 2	0.07	29.55371	-95.47443
Wet 3	0.22	29.55375	-95.47316
Wet 4	0.21	29.55379	-95.47165
Wet 5	0.1	29.55389	-95.4688
Wet 6	0.13	29.55517	-95.46139
Wet 7	0.75	29.55523	-95.45683

Legend		Acres
	Potential Adjacent Wetlands (Potentially Jurisdictional)	3.41
	Waters of the U.S. (Jurisdictional)	0.07 (174 LF)
	Man-Made Ditches (Potentially Non-Jurisdictional)	0.21 (470 LF)
	Sample Points	
	Project ROW	~12,662 LF
	FEMA 100-Year Floodplain	

WETLAND DETERMINATION AND CLASSIFICATION
SITE LOCATION MAP



BERG ♦ OLIVER ASSOCIATES, INC.
ENVIRONMENTAL SCIENCE & LAND USE CONSULTANTS
14701 ST. MARY'S LANE, SUITE 400
HOUSTON, TEXAS 77079 PHONE (281)569-0898 <http://www.bergoliver.com>

REVISIONS
5/4/16 by DBE
2/12/18 by DBE

Project #: 10161N-WD
For: Fort Bend County Engineering Department
Location: Between Proposed Chimney Rock Rd & FM 521
Fort Bend County, Texas