

10/20/2023 7:34 AM

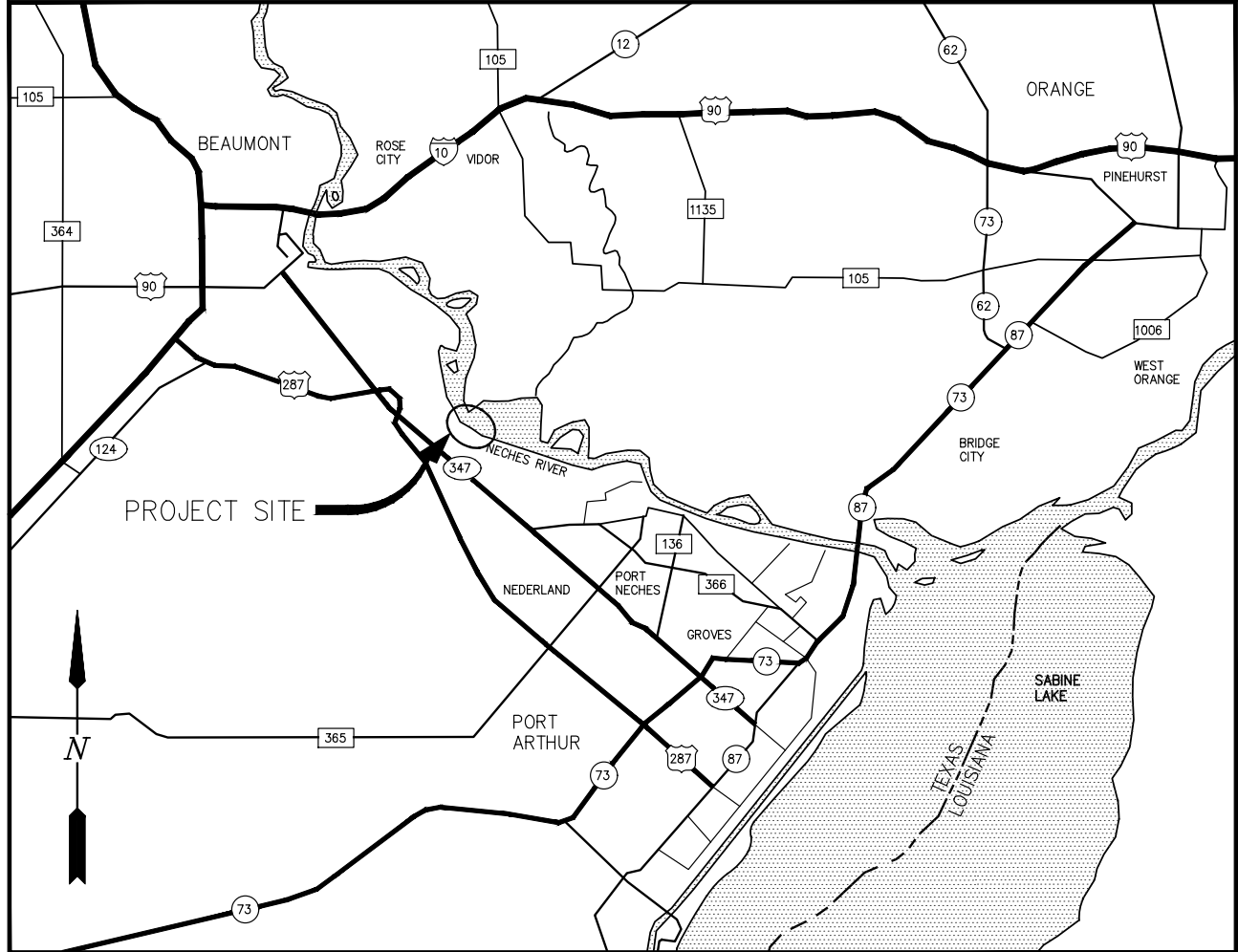

GENERAL NOTES

1. STRUCTURES SHALL ALSO BE MARKED/LIGHTED IN ACCORDANCE WITH U.S. COAST GUARD REGULATIONS.
2. ALL ELEVATIONS REFER TO M.L.L.W. UNLESS NOTED OTHERWISE.
3. MEAN HIGH WATER (MHW) = (+) 0.93' MLLW.

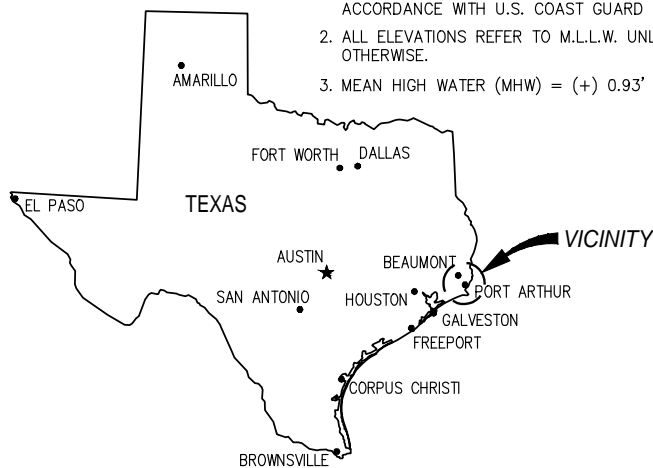

LAT: 30°01'11"N
LONG: 94°01'30"W

AREA MAP

CHRIS O'BRIEN P.E.
TX PE #108174

PRELIMINARY - FOR PERMITTING PURPOSES ONLY, NOT FOR CONSTRUCTION

REV
A



LANIER & ASSOCIATES
CONSULTING ENGINEERS, INC.

LA: EF-1120 TX: F-2981
VF-185 LSF-10194817

NEW ORLEANS • BEAUMONT • CORPUS CHRISTI • HOUSTON • MANDEVILLE

JEFFERSON TERMINAL SOUTH, LLC
BEAUMONT TEXAS

JTS DOCK REPLACEMENT PROJECT
PROPOSED DOCK REPLACEMENT
VICINITY MAP

DATE JUNE '23
DESIGN CLO
DRAWN JWB
CHECK DLC
JOB NO 12303-1
SHEET No.

1 OF 18

J:\120005\12303-1 JTS NEW SHIP BARGE DOCK\DRAWINGS\PERMIT\REAL ESTATE PERMIT\12303-1-P1.DWG

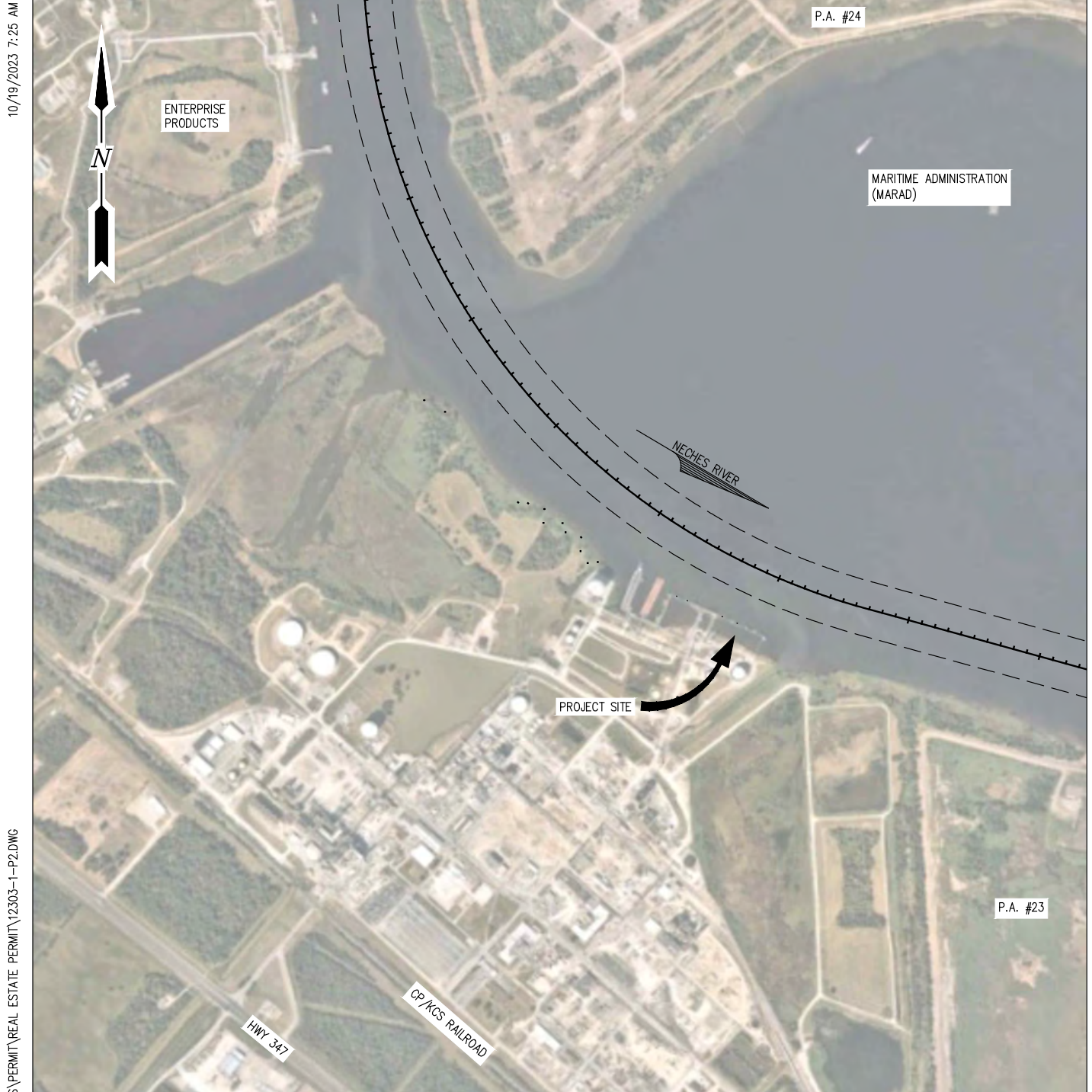

LOCATION MAP

SCALE: 1" = 1000'

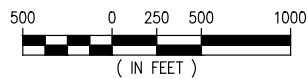

CHRIS O'BRIEN P.E.
TX PE #108174

PRELIMINARY - FOR PERMITTING PURPOSES ONLY, NOT FOR CONSTRUCTION

REV
A



**LANIER & ASSOCIATES
CONSULTING ENGINEERS, INC.**

LA: EF-1120 TX: F-2981
VF-185 LSF-10194817

NEW ORLEANS • BEAUMONT • CORPUS CHRISTI • HOUSTON • MANDEVILLE

JEFFERSON TERMINAL SOUTH, LLC
BEAUMONT TEXAS

**JTS DOCK REPLACEMENT PROJECT
PROPOSED DOCK REPLACEMENT
LOCATION MAP**

DATE JUNE '23
DESIGN CLO
DRAWN JWB
CHECK DLC
JOB NO 12303-1
SHEET No.
2 OF 18

10/20/2023 7:34 AM

J:\120005\12303-1 JTS NEW SHIP BARGE DOCK\DRAWINGS\PERMIT\REAL ESTATE PERMIT\12303-1-P3.DWG

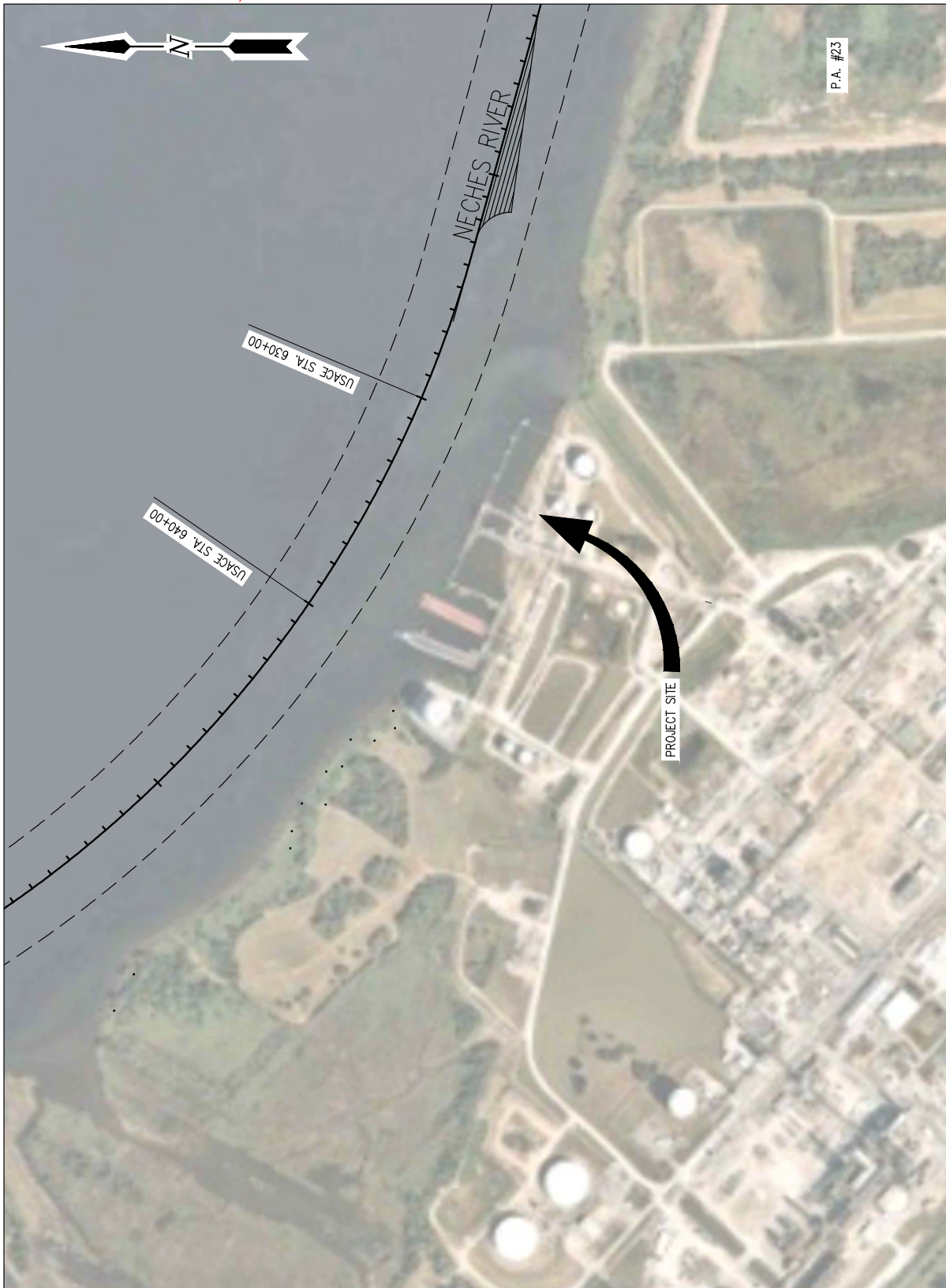

P.A. #23

ENLARGED LOCATION MAP

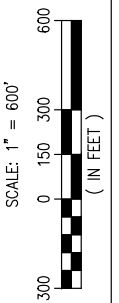

CHRIS O'BRIEN P.E.
TX PE #108174

PRELIMINARY - FOR PERMITTING PURPOSES ONLY, NOT FOR CONSTRUCTION

REV
A



LANIER & ASSOCIATES
CONSULTING ENGINEERS, INC.

LA: EF-1120 TX: F-2981
VF-185 LSF-10194817

NEW ORLEANS • BEAUMONT • CORPUS CHRISTI • HOUSTON • MANDEVILLE

JEFFERSON TERMINAL SOUTH, LLC
BEAUMONT TEXAS

JTS DOCK REPLACEMENT PROJECT
PROPOSED DOCK REPLACEMENT
ENLARGED LOCATION MAP

DATE JUNE '23
DESIGN CLO
DRAWN JWB
CHECK DLC
JOB NO 12303-1
SHEET No.
3 OF 18

10/20/2023 7:33 AM

J:\120005\12303-1 JTS NEW SHIP BARGE DOCK\DRAWINGS\PERMIT\REAL ESTATE PERMIT\12303-1-P4.DWG

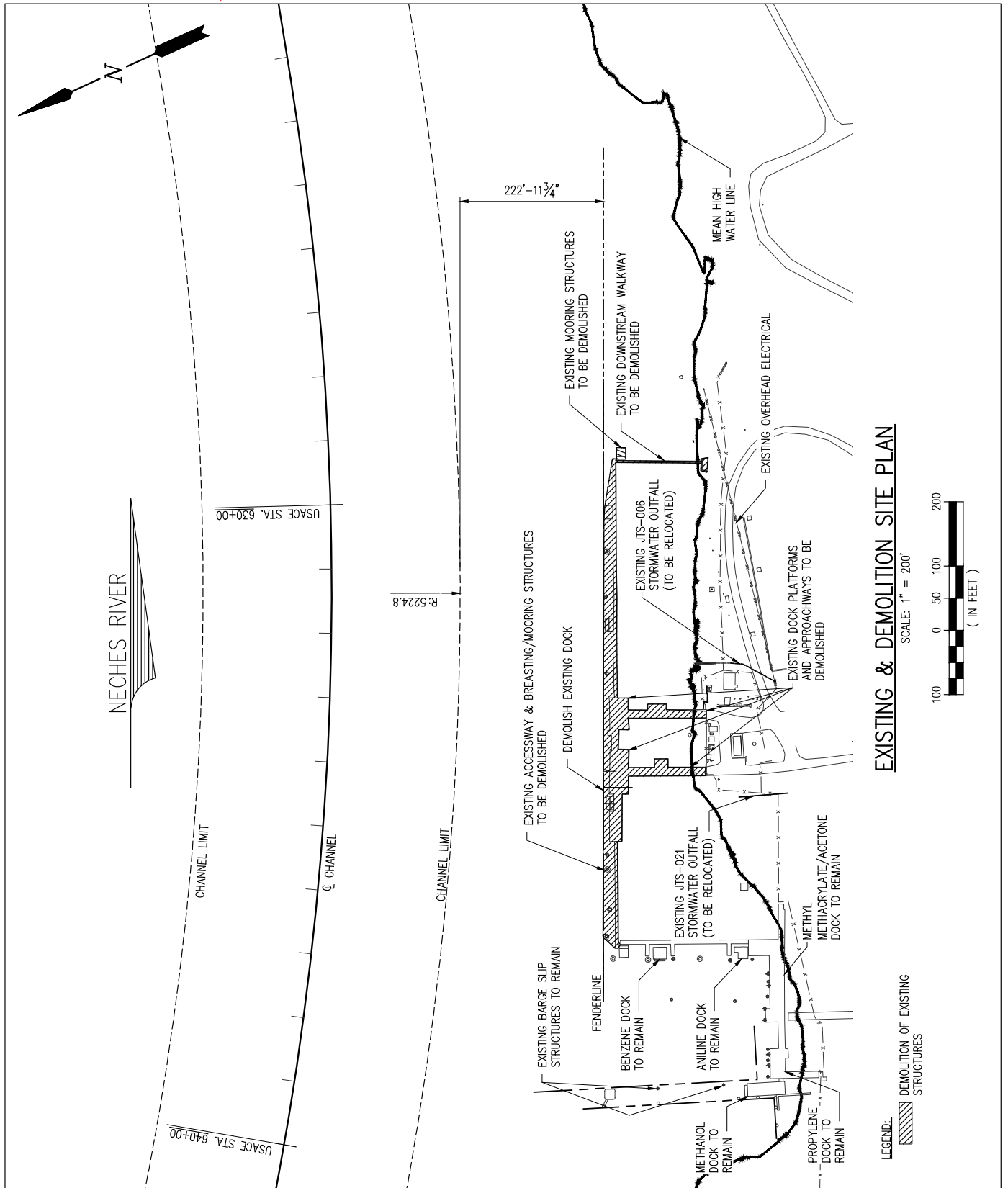

EXISTING & DEMOLITION SITE PLAN

SCALE: 1" = 200'

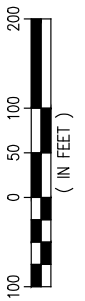

LEGEND:
DEMOLITION OF EXISTING STRUCTURES

CHRIS O'BRIEN P.E.
TX PE #108174

PRELIMINARY - FOR PERMITTING PURPOSES ONLY, NOT FOR CONSTRUCTION

REV
A



LANIER & ASSOCIATES
CONSULTING ENGINEERS, INC.

LA: EF-1120 TX: F-2981
VF-185 LSF-10194817

NEW ORLEANS • BEAUMONT • CORPUS CHRISTI • HOUSTON • MANDEVILLE

JEFFERSON TERMINAL SOUTH, LLC
BEAUMONT TEXAS

JTS DOCK REPLACEMENT PROJECT
PROPOSED DOCK REPLACEMENT
EXISTING AND DEMOLITION SITE PLAN

DATE: JUNE '23
DESIGN: CLO
DRAWN: JWB
CHECK: DLC
JOB NO: 12303-1
SHEET No.
4 OF 18

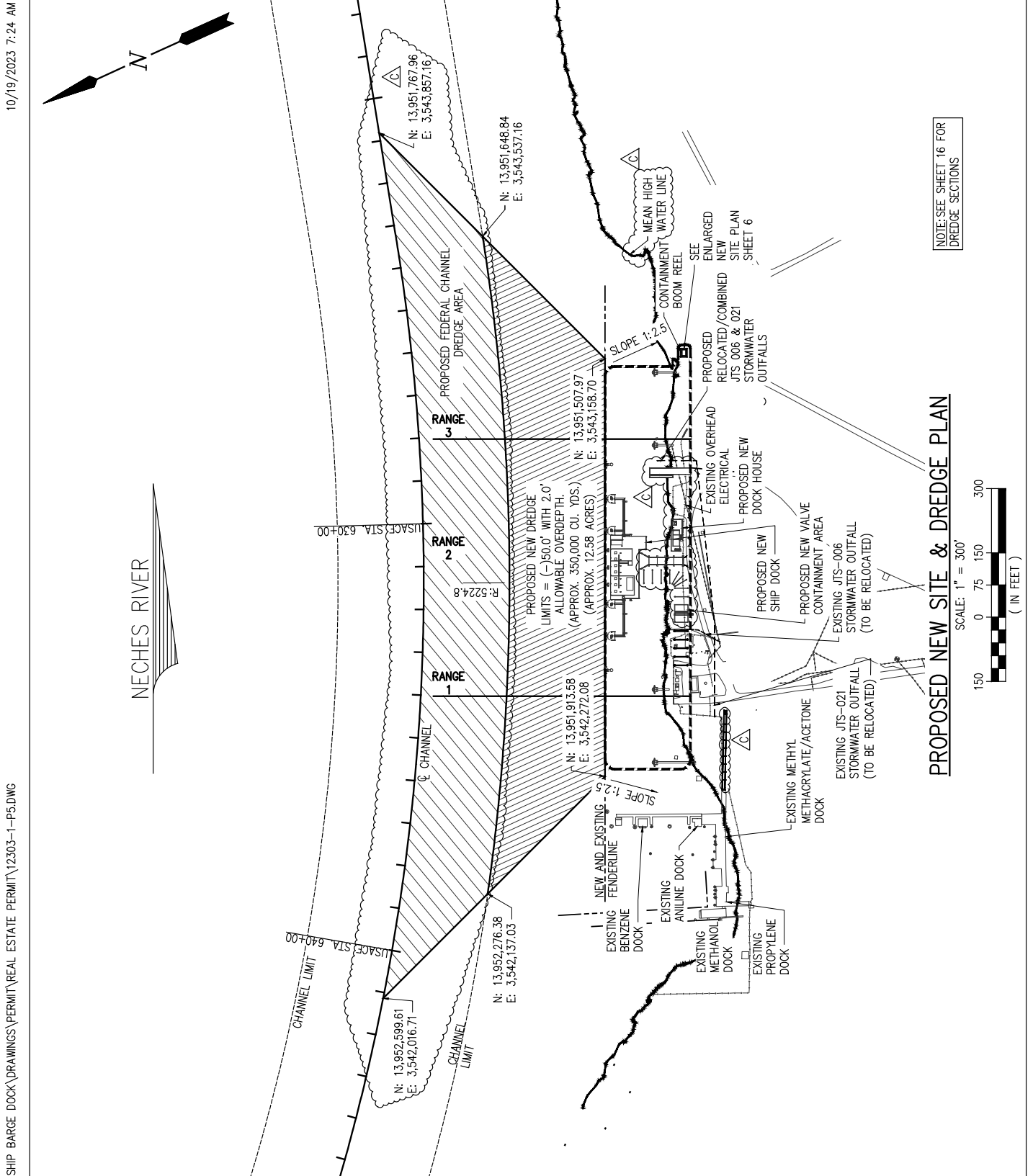

NOTE: SEE SHEET 16 FOR DREDGE SECTIONS

PROPOSED NEW SITE & DREDGE PLAN

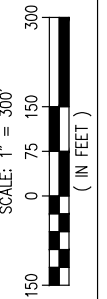

CHRIS O'BRIEN P.E.
TX PE #108174

PRELIMINARY - FOR PERMITTING PURPOSES ONLY, NOT FOR CONSTRUCTION

REV
C



LANIER & ASSOCIATES
CONSULTING ENGINEERS, INC.

LA: EF-1120 TX: F-2981
VF-185 LSF-10194817

NEW ORLEANS • BEAUMONT • CORPUS CHRISTI • HOUSTON • MANDEVILLE

JEFFERSON TERMINAL SOUTH, LLC
BEAUMONT TEXAS

JTS DOCK REPLACEMENT PROJECT
PROPOSED DOCK REPLACEMENT
PROPOSED NEW SITE PLAN & DREDGE PLAN

DATE OCT '23
DESIGN CLO
DRAWN JWB
CHECK DLC
JOB NO 12303-1
SHEET No.
5 OF 18

J:\120005\12303-1 JTS NEW SHIP BARGE DOCK\DRAWINGS\PERMIT\REAL ESTATE PERMIT\12303-1-P5.DWG

10/19/2023 7:24 AM

6 OF 18

10/20/2023 7:32 AM

J:\120005\12303-1 JTS NEW SHIP BARGE DOCK\DRAWINGS\PERMIT\REAL ESTATE PERMIT\12303-1-P7.DWG

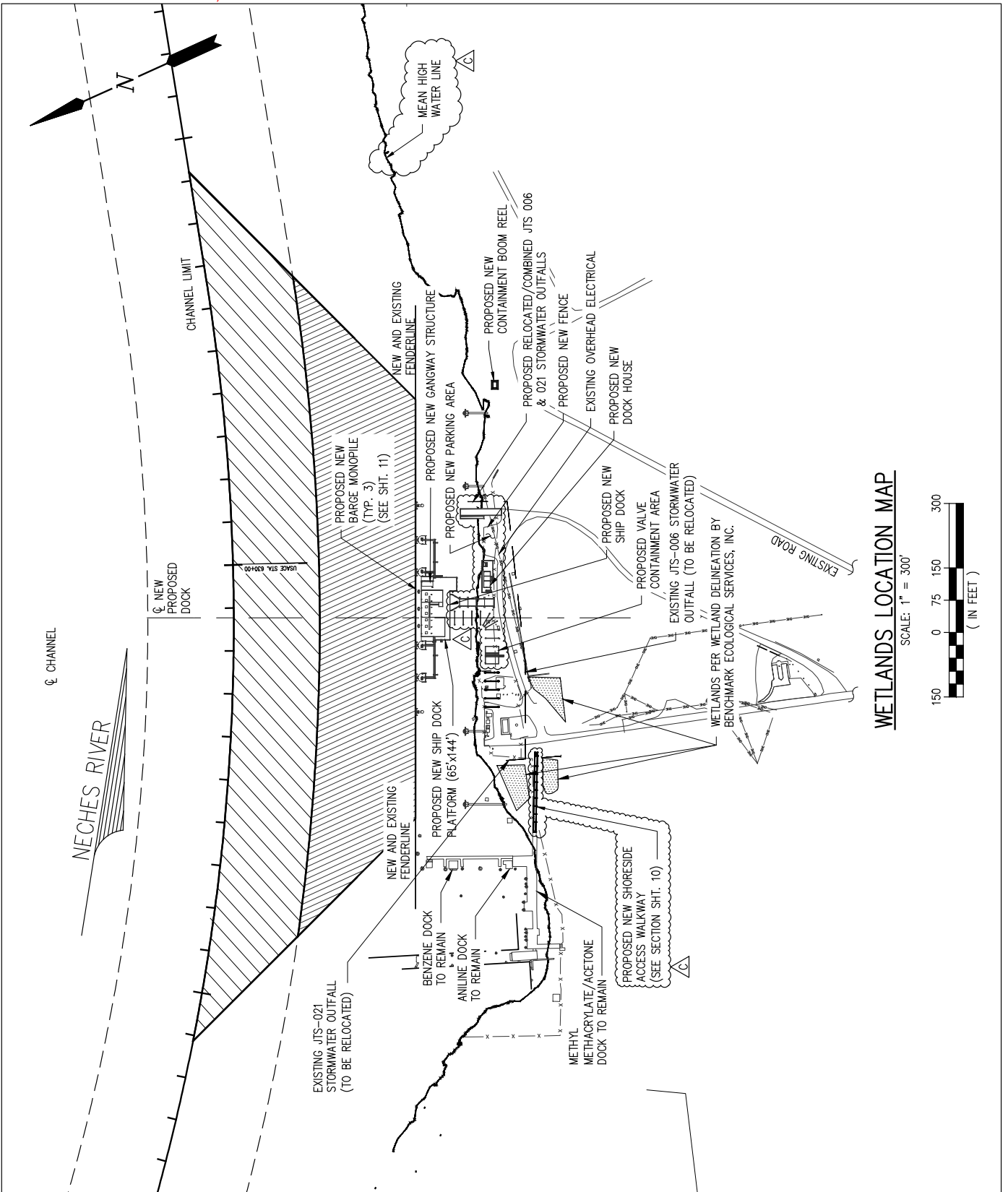

WETLANDS LOCATION MAP

SCALE: 1" = 300'

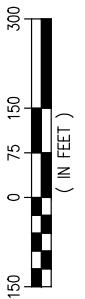

CHRIS O'BRIEN P.E.
TX PE #108174

PRELIMINARY - FOR PERMITTING PURPOSES ONLY, NOT FOR CONSTRUCTION

REV
C



LANIER & ASSOCIATES
CONSULTING ENGINEERS, INC.

LA: EF-1120 TX: F-2981
VF-185 LSF-10194817

NEW ORLEANS • BEAUMONT • CORPUS CHRISTI • HOUSTON • MANDEVILLE

JEFFERSON TERMINAL SOUTH, LLC
BEAUMONT TEXAS

JTS DOCK REPLACEMENT PROJECT
PROPOSED DOCK REPLACEMENT
WETLANDS LOCATION MAP

DATE AUG '23
DESIGN CLO
DRAWN JWB
CHECK DLC
JOB NO 12303-1
SHEET No.
7 OF 18

J:\12000S\12303-1 JTS NEW SHIP BARGE DOCK\DRAWINGS\PERMIT\REAL ESTATE PERMIT\12303-1-P8.DWG

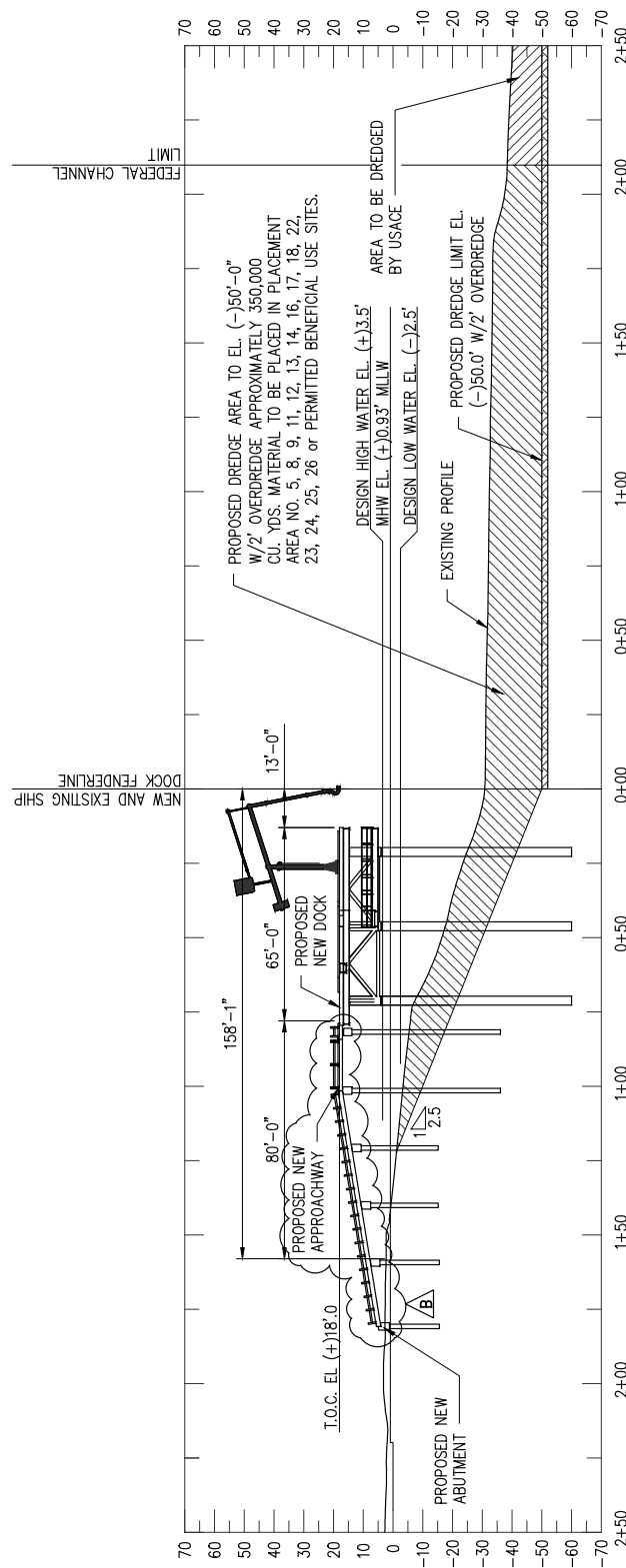

SECTION
SCALE: 1" = 60'-0"

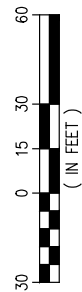
REV
B

NEW ORLEANS • BEAUMONT • CORPUS CHRISTI • HOUSTON • MANDEVILLE

JTS DOCK REPLACEMENT PROJECT
PROPOSED DOCK REPLACEMENT
PROPOSED NEW DOCK CROSS SECTION

DATE JUNE '23
 DESIGN CLO
 DRAWN JWB
 CHECK DLC
 JOB NO 12303-1
 SHEET No.
8 OF **18**

10/19/2023 7:22 AM

J:\120005\12303-1 JTS NEW SHIP BARGE DOCK\DRAWINGS\PERMIT\REAL ESTATE PERMIT\12303-1-P9.DWG

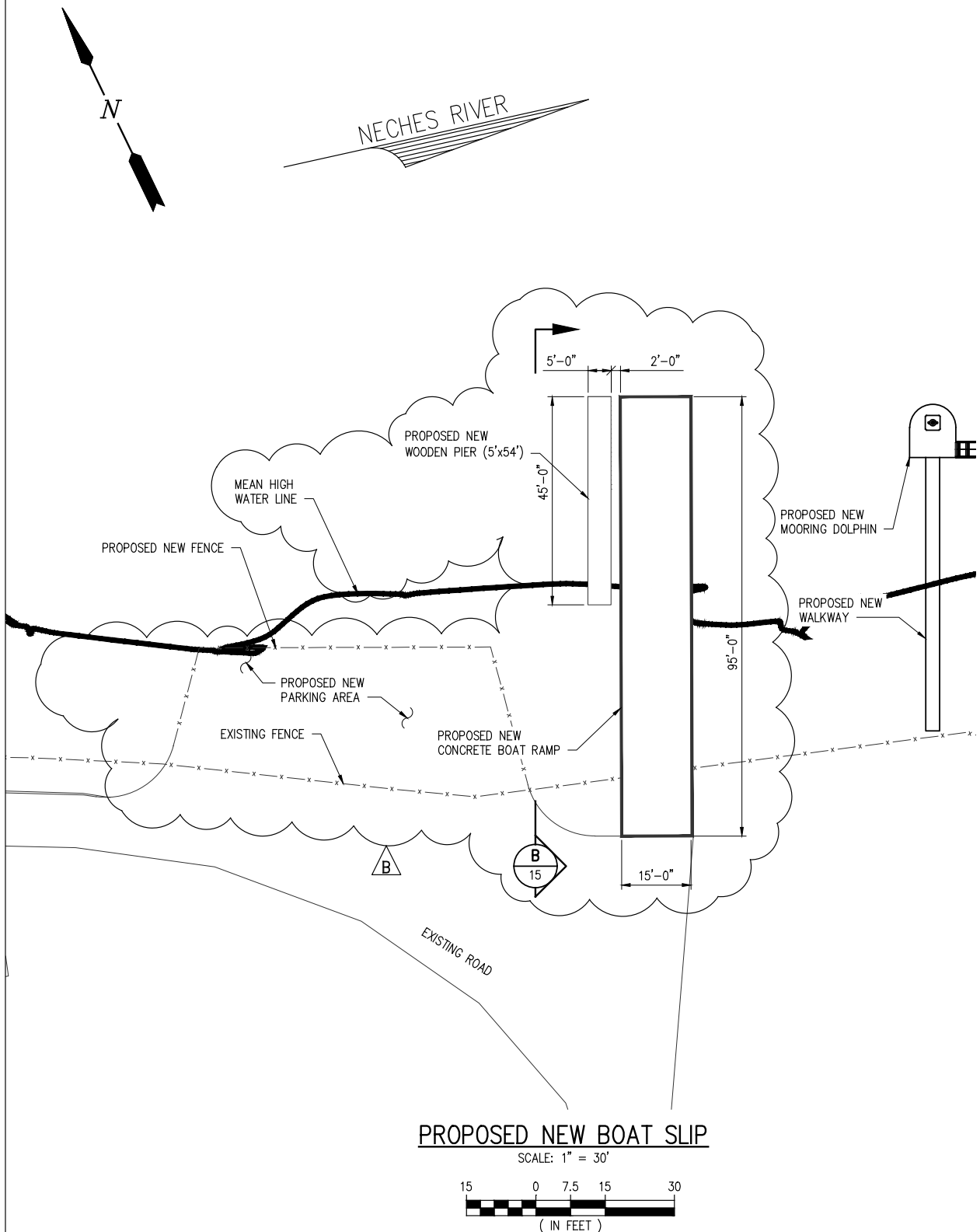

CHRIS O'BRIEN P.E.
TX PE #108174

PRELIMINARY - FOR PERMITTING PURPOSES ONLY, NOT FOR CONSTRUCTION

REV
B



LANIER & ASSOCIATES
CONSULTING ENGINEERS, INC.

LA: EF-1120 TX: F-2981
VF-185 LSF-10194817

NEW ORLEANS • BEAUMONT • CORPUS CHRISTI • HOUSTON • MANDEVILLE

JEFFERSON TERMINAL SOUTH, LLC
BEAUMONT TEXAS

JTS DOCK REPLACEMENT PROJECT
PROPOSED DOCK REPLACEMENT
ENLARGED PROPOSED NEW BOAT SLIP

DATE JUNE '23
DESIGN CLO
DRAWN JWB
CHECK DLC
JOB NO 12303-1
SHEET No.
9 OF 18

10/19/2023 7:22 AM

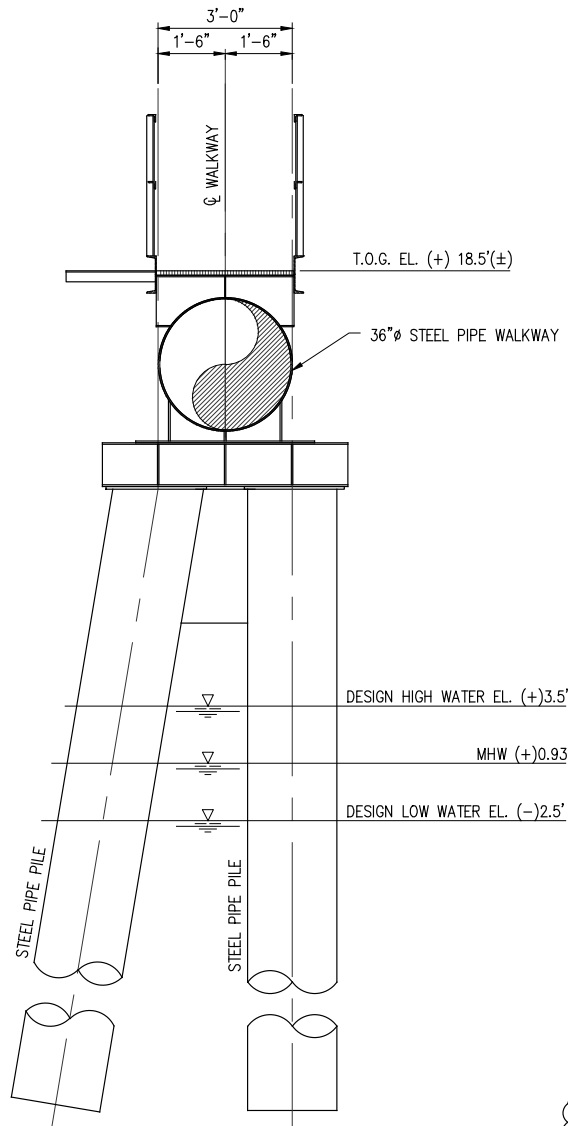

TYPICAL WALKWAY SUPPORT

SCALE: 1/4" = 1'-0"

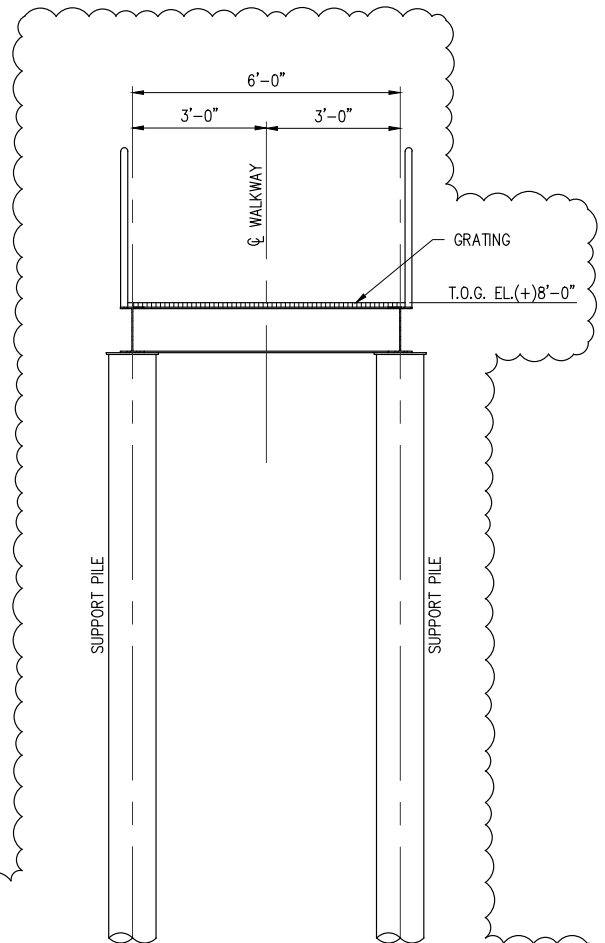

TYPICAL SHORESIDE ACCESS WALKWAY SECTION

SCALE: 1/4" = 1'-0"



B

CHRIS O'BRIEN P.E.
TX PE #108174

PRELIMINARY - FOR PERMITTING PURPOSES ONLY, NOT FOR CONSTRUCTION

REV
B



LANIER & ASSOCIATES
CONSULTING ENGINEERS, INC.

LA: EF-1120 TX: F-2981
VF-185 LSF-10194817

NEW ORLEANS • BEAUMONT • CORPUS CHRISTI • HOUSTON • MANDEVILLE

JEFFERSON TERMINAL SOUTH, LLC
BEAUMONT TEXAS

JTS DOCK REPLACEMENT PROJECT
PROPOSED DOCK REPLACEMENT
TYPICAL WALKWAY SECTIONS

DATE JUNE '23
DESIGN CLO
DRAWN JWB
CHECK DLC
JOB NO 12303-1
SHEET No.
10 OF 18

J:\120005\12303-1 JTS NEW SHIP BARGE DOCK\DRAWINGS\PERMIT\REAL ESTATE PERMIT\12303-1-P10.DWG

10/19/2023 7:20 AM

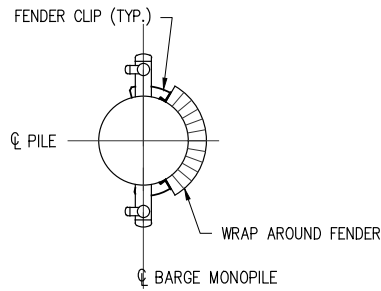

BARGE MONOPILE PLAN

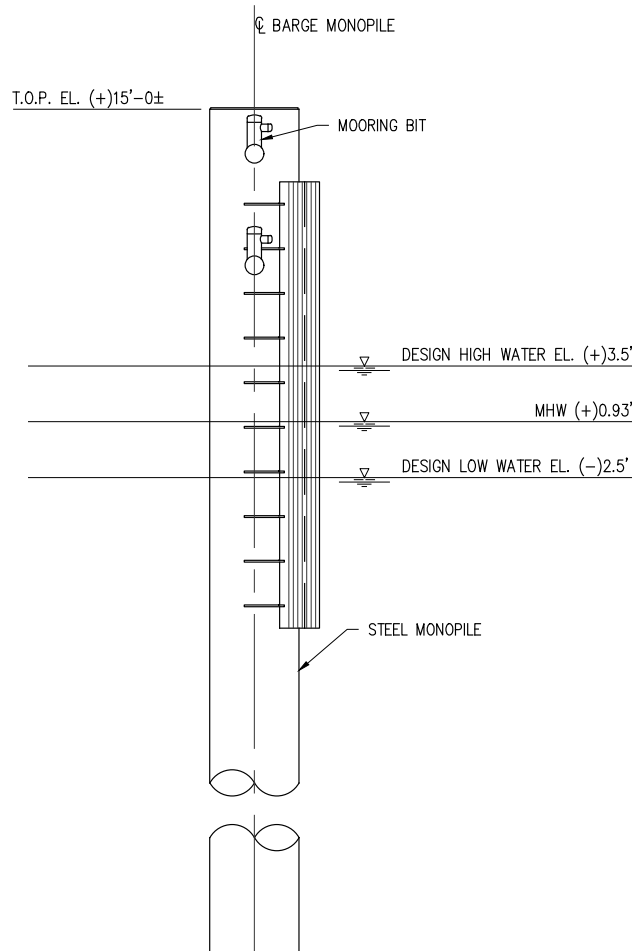
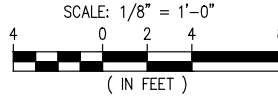

BARGE MONOPILE ELEVATION

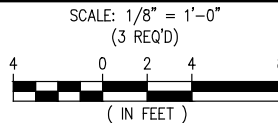

CHRIS O'BRIEN P.E.
TX PE #108174

PRELIMINARY - FOR PERMITTING PURPOSES ONLY, NOT FOR CONSTRUCTION

REV
A



LANIER & ASSOCIATES
CONSULTING ENGINEERS, INC.

LA: EF-1120 TX: F-2981
VF-185 LSF-10194817

NEW ORLEANS • BEAUMONT • CORPUS CHRISTI • HOUSTON • MANDEVILLE

JEFFERSON TERMINAL SOUTH, LLC
BEAUMONT TEXAS

JTS DOCK REPLACEMENT PROJECT
PROPOSED NEW SHIP DOCK
PROPOSED NEW BARGE MONOPILE

DATE JUNE '23
DESIGN CCO
DRAWN JWB
CHECK DLC
JOB NO 12303-1
SHEET No.
11 OF 18

J:\120005\12303-1 JTS NEW SHIP BARGE DOCK\DRAWINGS\PERMIT\REAL ESTATE PERMIT\12303-1-P11.DWG

10/19/2023 7:20 AM

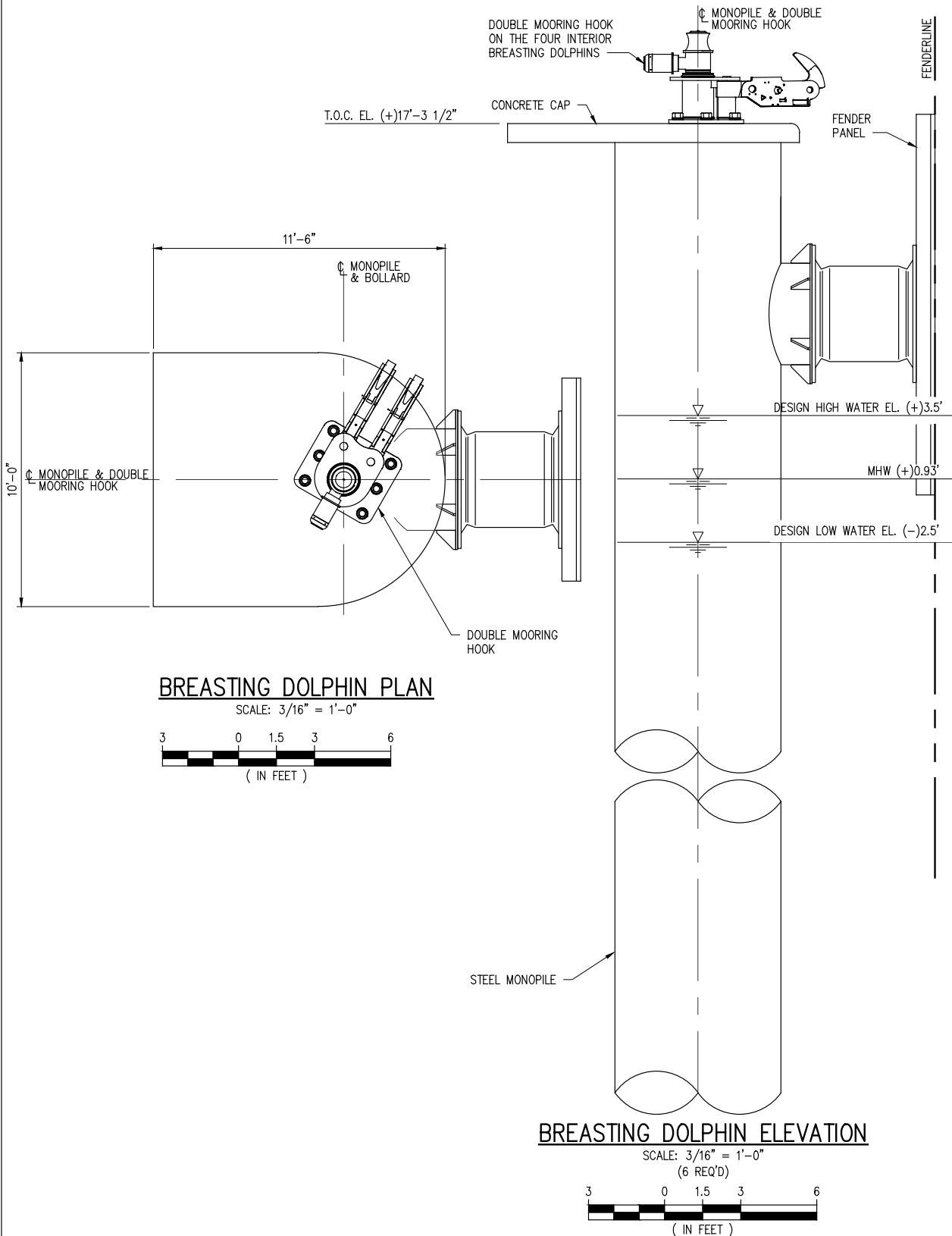

CHRIS O'BRIEN P.E.
TX PE #108174

PRELIMINARY - FOR PERMITTING PURPOSES ONLY, NOT FOR CONSTRUCTION

REV
A



LANIER & ASSOCIATES
CONSULTING ENGINEERS, INC.

LA: EF-1120 TX: F-2981
VF-185 LSF-10194817

NEW ORLEANS • BEAUMONT • CORPUS CHRISTI • HOUSTON • MANDEVILLE

JEFFERSON TERMINAL SOUTH, LLC
BEAUMONT TEXAS

JTS DOCK REPLACEMENT PROJECT
PROPOSED DOCK REPLACEMENT
PROPOSED NEW BREASTING DOLPHIN

DATE JUNE '23
DESIGN CLO
DRAWN JWB
CHECK DLC
JOB NO 12303-1
SHEET No.
12 OF 18

J:\120005\12303-1 JTS NEW SHIP BARGE DOCK\DRAWINGS\PERMIT\REAL ESTATE PERMIT\12303-1-P12.DWG

10/19/2023 7:20 AM

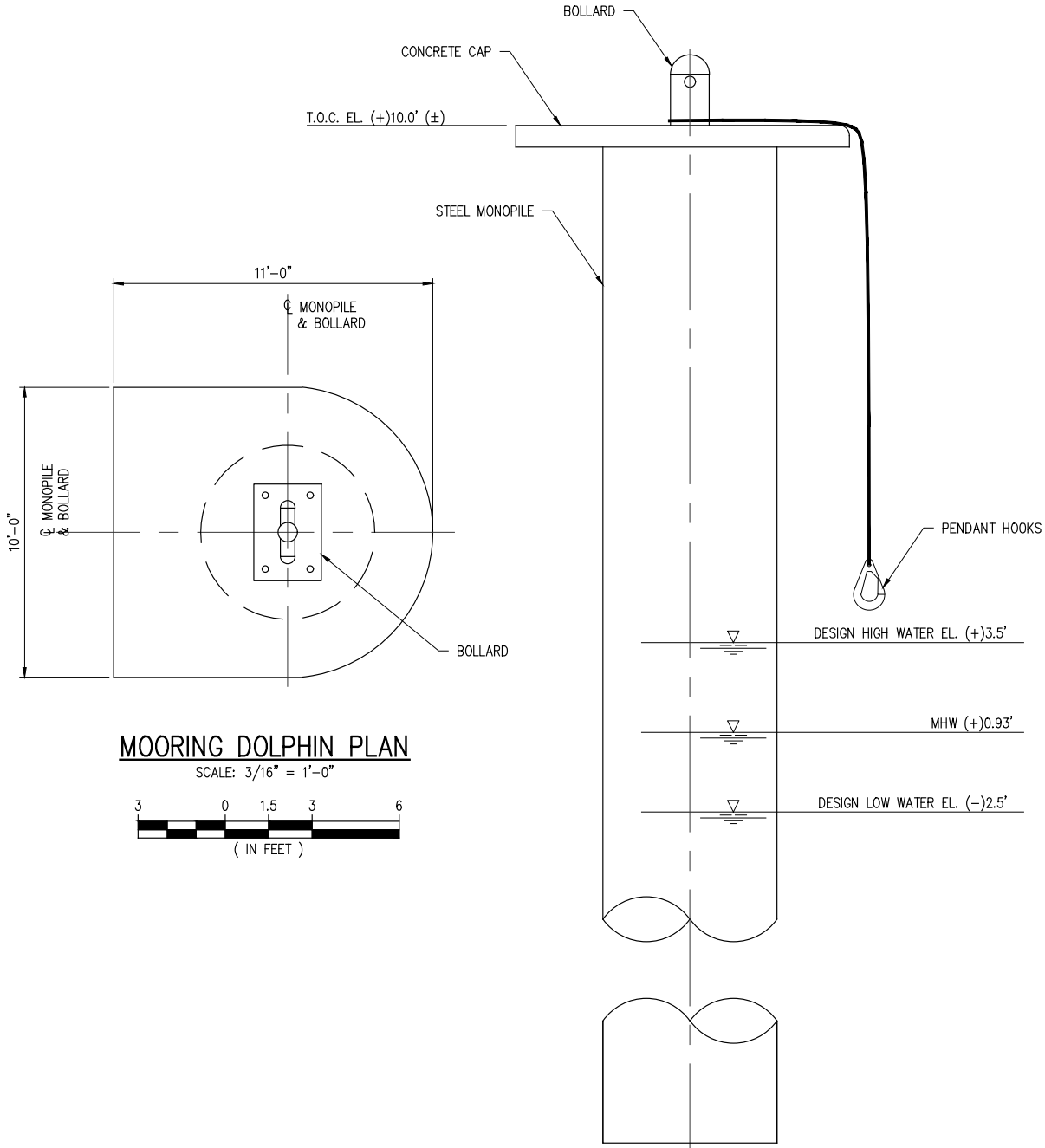

J:\120005\12303-1 JTS NEW SHIP BARGE DOCK\DRAWINGS\PERMIT\REAL ESTATE PERMIT\12303-1-P13.DWG

CHRIS O'BRIEN P.E.
TX PE #108174

PRELIMINARY - FOR PERMITTING PURPOSES ONLY, NOT FOR CONSTRUCTION

REV
A



**LANIER & ASSOCIATES
CONSULTING ENGINEERS, INC.**

LA: EF-1120 TX: F-2981
VF-185 LSF-10194817

NEW ORLEANS • BEAUMONT • CORPUS CHRISTI • HOUSTON • MANDEVILLE

JEFFERSON TERMINAL SOUTH, LLC
BEAUMONT TEXAS

JTS DOCK REPLACEMENT PROJECT
PROPOSED DOCK REPLACEMENT
PROPOSED NEW MOORING DOLPHIN

DATE JUNE '23
DESIGN CLO
DRAWN JWB
CHECK DLC
JOB NO 12303-1
SHEET No.
13 OF 18

10/19/2023 7:19 AM

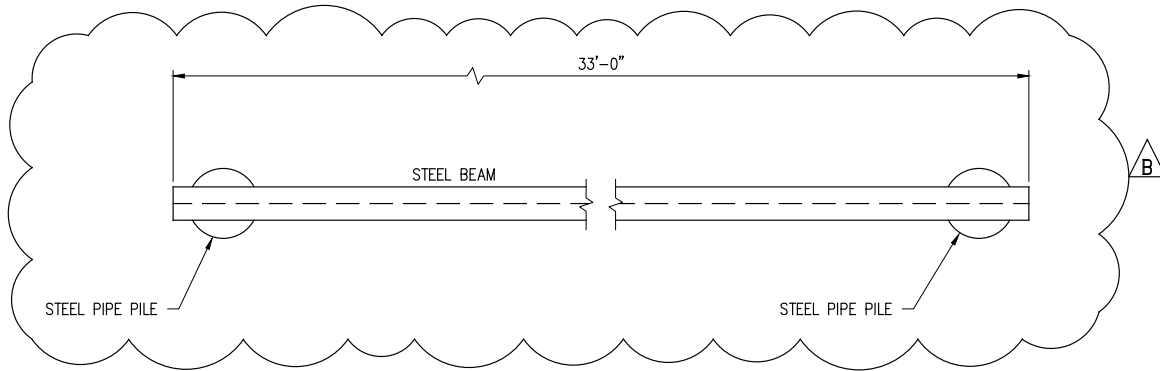

PIPE SUPPORT PLAN

SCALE: 3/16" = 1'-0"

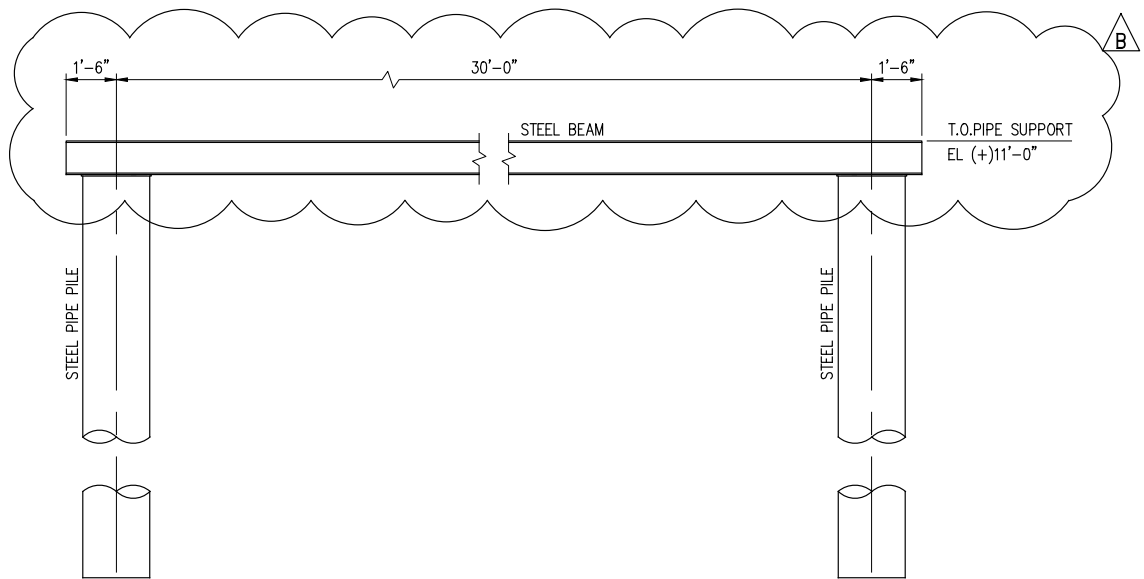
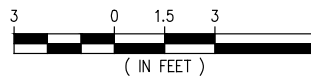

PIPE SUPPORT ELEVATION

SCALE: 3/16" = 1'-0"

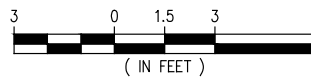

CHRIS O'BRIEN P.E.
TX PE #108174

PRELIMINARY - FOR PERMITTING PURPOSES ONLY, NOT FOR CONSTRUCTION

REV
B



**LANIER & ASSOCIATES
CONSULTING ENGINEERS, INC.**

LA: EF-1120 TX: F-2981
VF-185 LSF-10194817

NEW ORLEANS • BEAUMONT • CORPUS CHRISTI • HOUSTON • MANDEVILLE

JEFFERSON TERMINAL SOUTH, LLC
BEAUMONT TEXAS

**JTS DOCK REPLACEMENT PROJECT
PROPOSED DOCK REPLACEMENT
PROPOSED PIPE SUPPORT**

DATE JUNE '23
DESIGN CLO
DRAWN JWB
CHECK DLC
JOB NO 12303-1
SHEET No.
14 OF 18

J:\120005\12303-1 JTS NEW SHIP BARGE DOCK\DRAWINGS\PERMIT\REAL ESTATE PERMIT\12303-1-P14.DWG

10/19/2023 7:18 AM

J:\120005\12303-1 JTS NEW SHIP BARGE DOCK\DRAWINGS\PERMIT\REAL ESTATE PERMIT\12303-1-P15.DWG

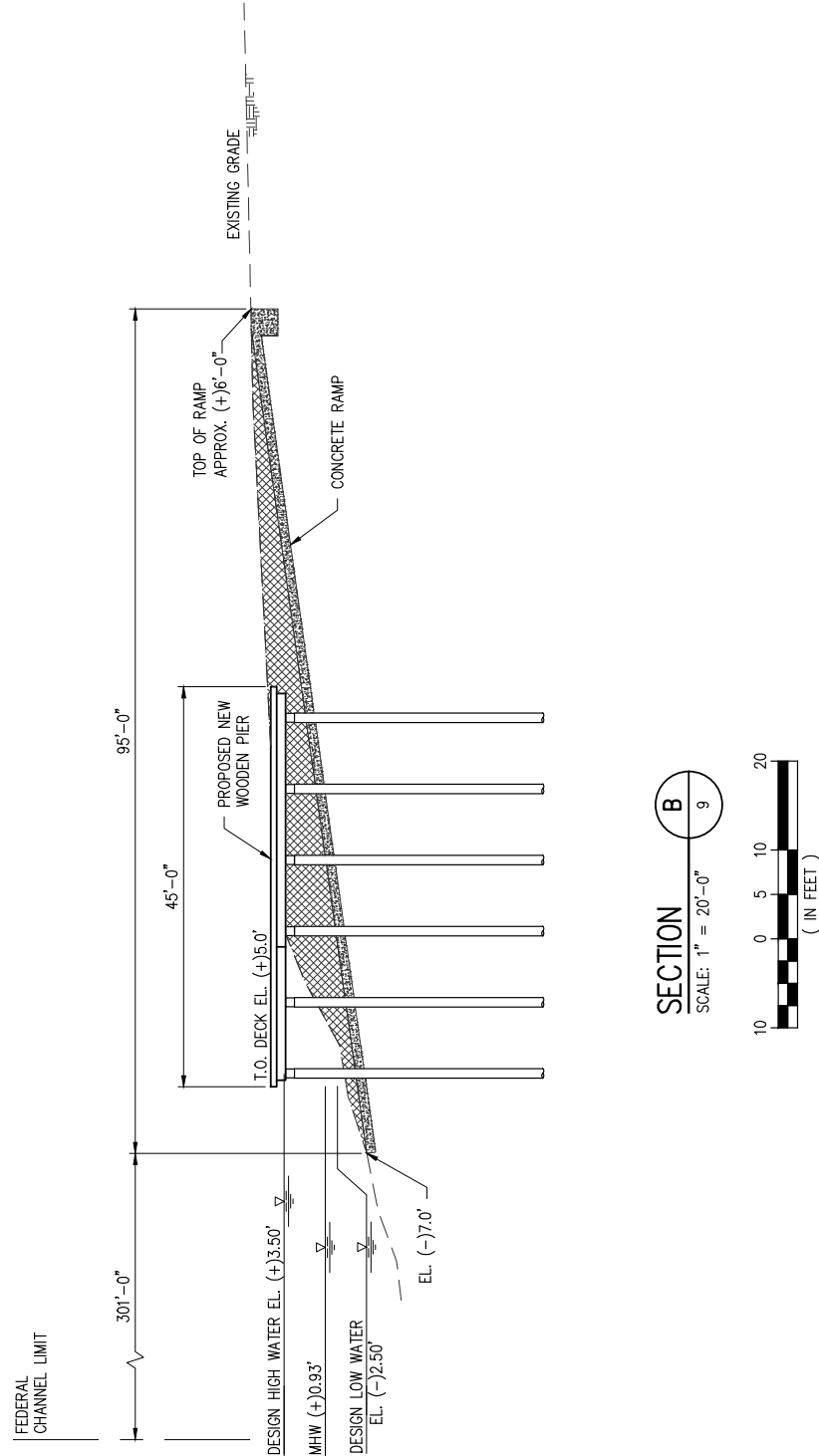

CHRIS O'BRIEN P.E.
TX PE #108174

PRELIMINARY - FOR PERMITTING PURPOSES ONLY, NOT FOR CONSTRUCTION

REV
A



LANIER & ASSOCIATES
CONSULTING ENGINEERS, INC.

LA: EF-1120 TX: F-2981
VF-185 LSF-10194817

NEW ORLEANS • BEAUMONT • CORPUS CHRISTI • HOUSTON • MANDEVILLE

JEFFERSON TERMINAL SOUTH, LLC
BEAUMONT TEXAS

JTS DOCK REPLACEMENT PROJECT
PROPOSED DOCK REPLACEMENT
PROPOSED NEW BOAT SLIP SECTION

DATE JUNE '23
DESIGN CLO
DRAWN JWB
CHECK DLC
JOB NO 12303-1
SHEET No.
15 OF 18

10/19/2023 7:17 AM

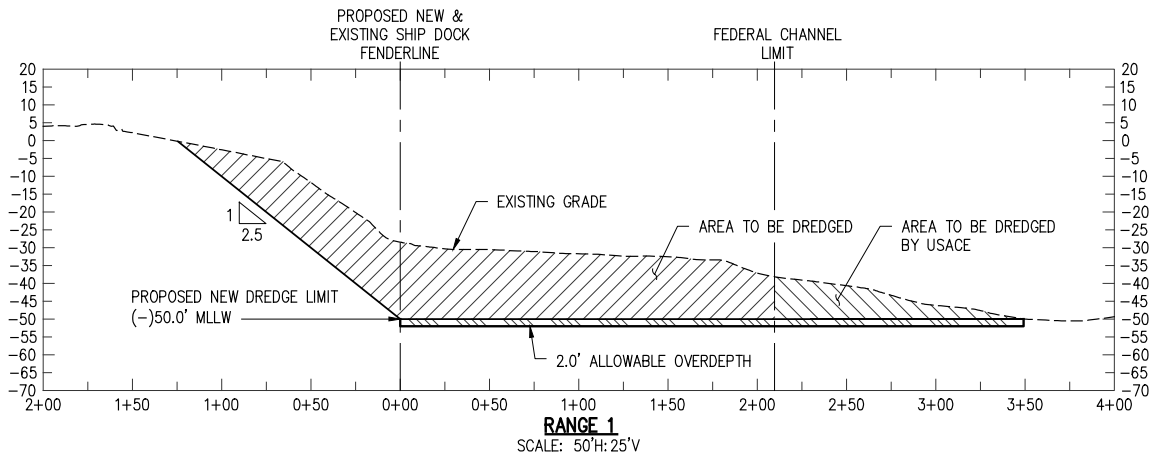
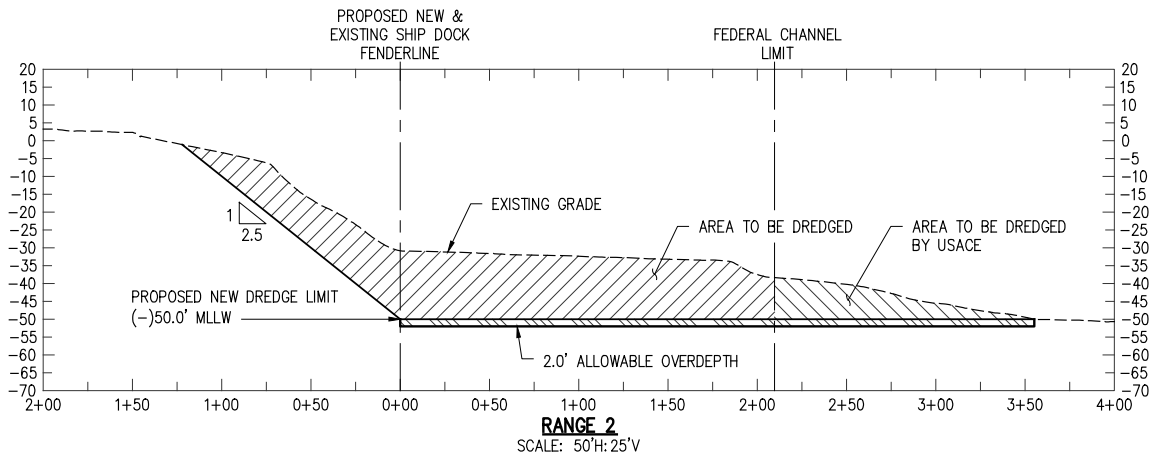
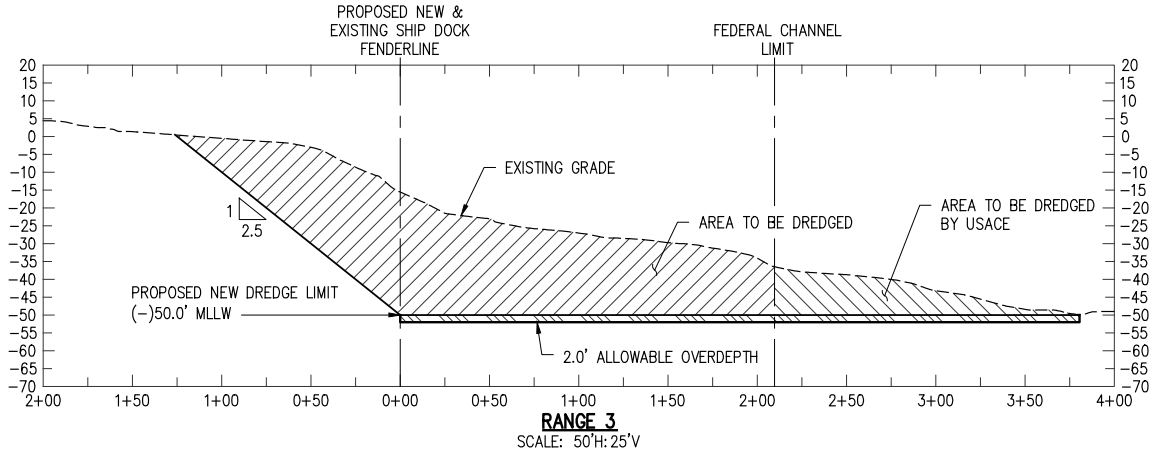

CHRIS O'BRIEN P.E.
TX PE #108174

PRELIMINARY - FOR PERMITTING PURPOSES ONLY, NOT FOR CONSTRUCTION

REV
A



LANIER & ASSOCIATES
CONSULTING ENGINEERS, INC.

LA: EF-1120 TX: F-2981
VF-185 LSF-10194817

NEW ORLEANS • BEAUMONT • CORPUS CHRISTI • HOUSTON • MANDEVILLE

JEFFERSON TERMINAL SOUTH, LLC
BEAUMONT TEXAS

JTS DOCK REPLACEMENT PROJECT
PROPOSED DOCK REPLACEMENT
DREDGE PAD CROSS SECTIONS

DATE: JUNE '23
DESIGN: CLO
DRAWN: JWB
CHECK: DLC
JOB NO: 12303-1
SHEET No.
16 OF 18

J:\120005\12303-1 JTS NEW SHIP BARGE DOCK\DRAWINGS\PERMIT\REAL ESTATE PERMIT\12303-1-P16.DWG

10/19/2023 7:16 AM

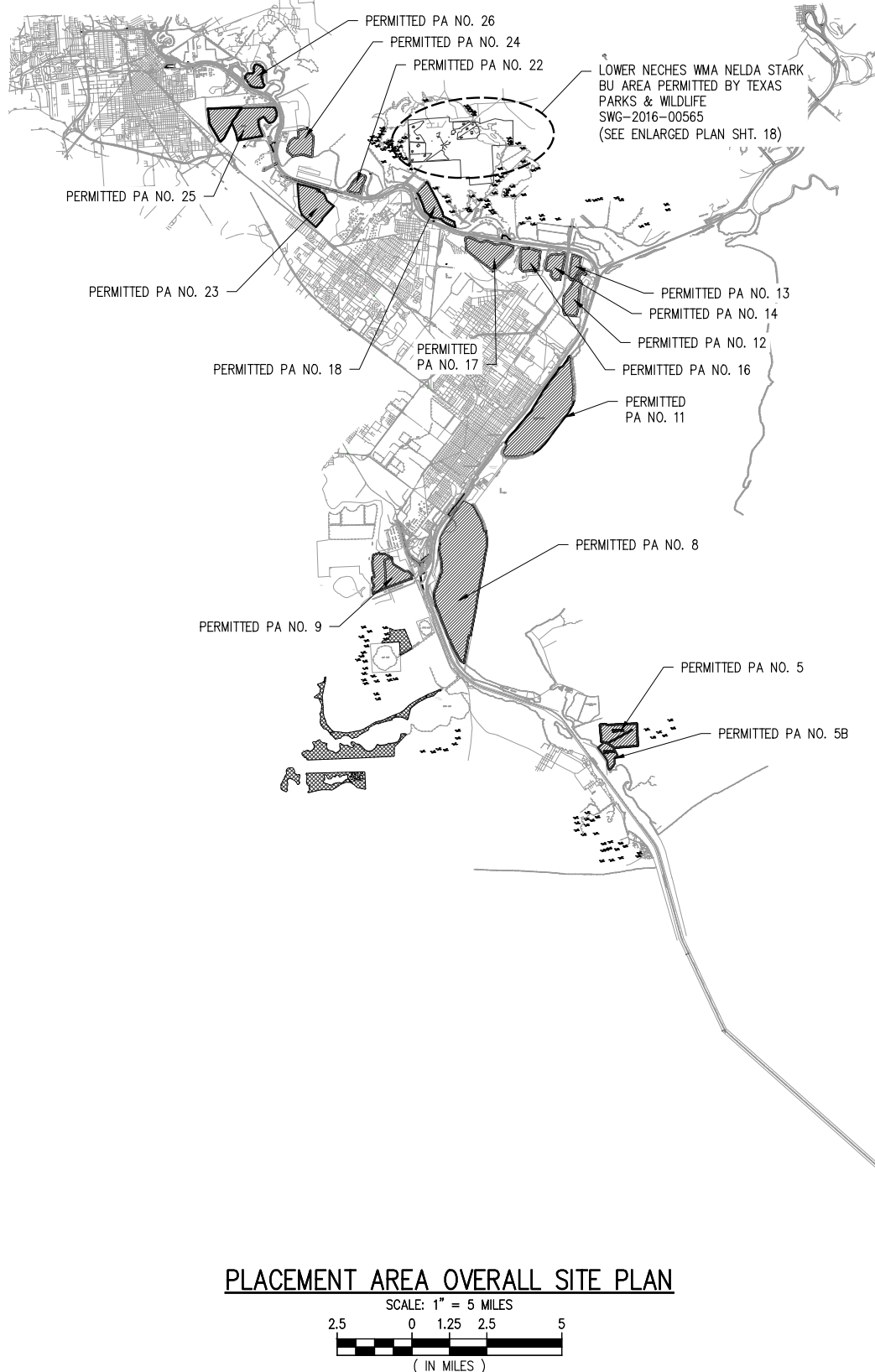

PLACEMENT AREA OVERALL SITE PLAN

SCALE: 1" = 5 MILES
2.5 0 1.25 2.5 5
(IN MILES)

CHRIS O'BRIEN P.E.
TX PE #108174

PRELIMINARY - FOR PERMITTING PURPOSES ONLY, NOT FOR CONSTRUCTION

REV
A



LANIER & ASSOCIATES
CONSULTING ENGINEERS, INC.

LA: EF-1120 TX: F-2981
VF-185 LSF-10194817

NEW ORLEANS • BEAUMONT • CORPUS CHRISTI • HOUSTON • MANDEVILLE

JEFFERSON TERMINAL SOUTH, LLC
BEAUMONT TEXAS

JTS DOCK REPLACEMENT PROJECT
PROPOSED DOCK REPLACEMENT
PROPOSED PLACEMENT AREAS

DATE JUNE '23
DESIGN CLO
DRAWN JWB
CHECK DLC
JOB NO 12303-1
SHEET No.
17 OF 18

J:\120005\12303-1 JTS NEW SHIP BARGE DOCK\DRAWINGS\PERMIT\REAL ESTATE PERMIT\12303-1-P17.DWG

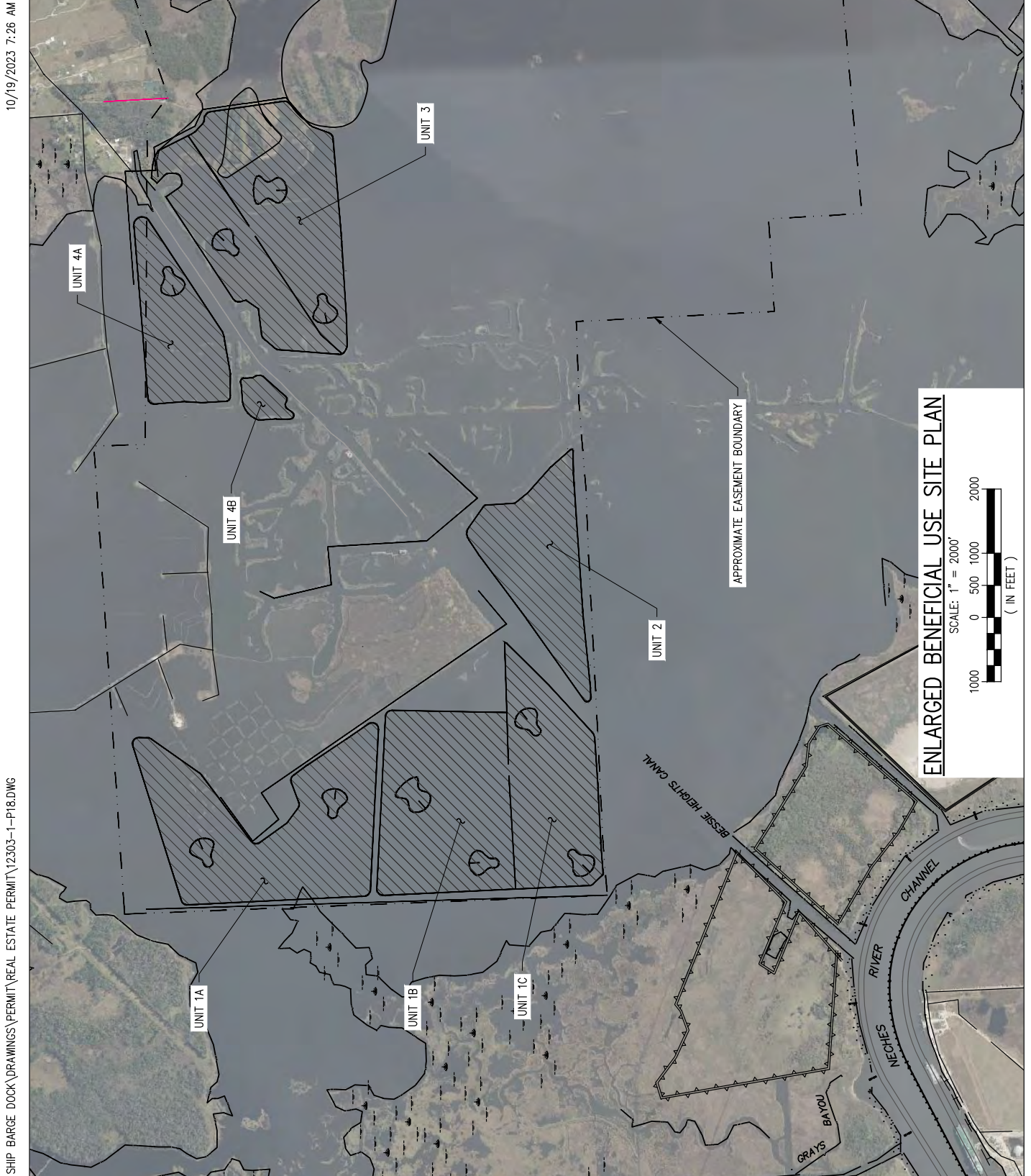

CHRIS O'BRIEN P.E.
TX PE #108174

PRELIMINARY - FOR PERMITTING PURPOSES ONLY, NOT FOR CONSTRUCTION

REV
A



LANIER & ASSOCIATES
CONSULTING ENGINEERS, INC.

LA: EF-1120 TX: F-2981
VF-185 LSF-10194817

NEW ORLEANS • BEAUMONT • CORPUS CHRISTI • HOUSTON • MANDEVILLE

JEFFERSON TERMINAL SOUTH, LLC
BEAUMONT TEXAS

JTS DOCK REPLACEMENT PROJECT
PROPOSED DOCK REPLACEMENT
ENLARGED BENEFICIAL USE SITE PLAN

DATE: JUNE '23
DESIGN: CLO
DRAWN: JWB
CHECK: DLC
JOB NO: 12303-1
SHEET No.
18 OF 18

J:\120005\12303-1 JTS NEW SHIP BARGE DOCK\DRAWINGS\PERMIT\REAL ESTATE PERMIT\12303-1-P18.DWG

10/19/2023 7:26 AM