

Legend

- ★ Subject Area Location
- County Boundary

Prepared by: 

**Johnson Beach
Development LLC**

**Figure 1.0
Vicinity
Galveston County, Texas**

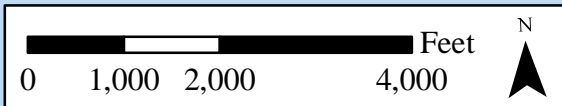
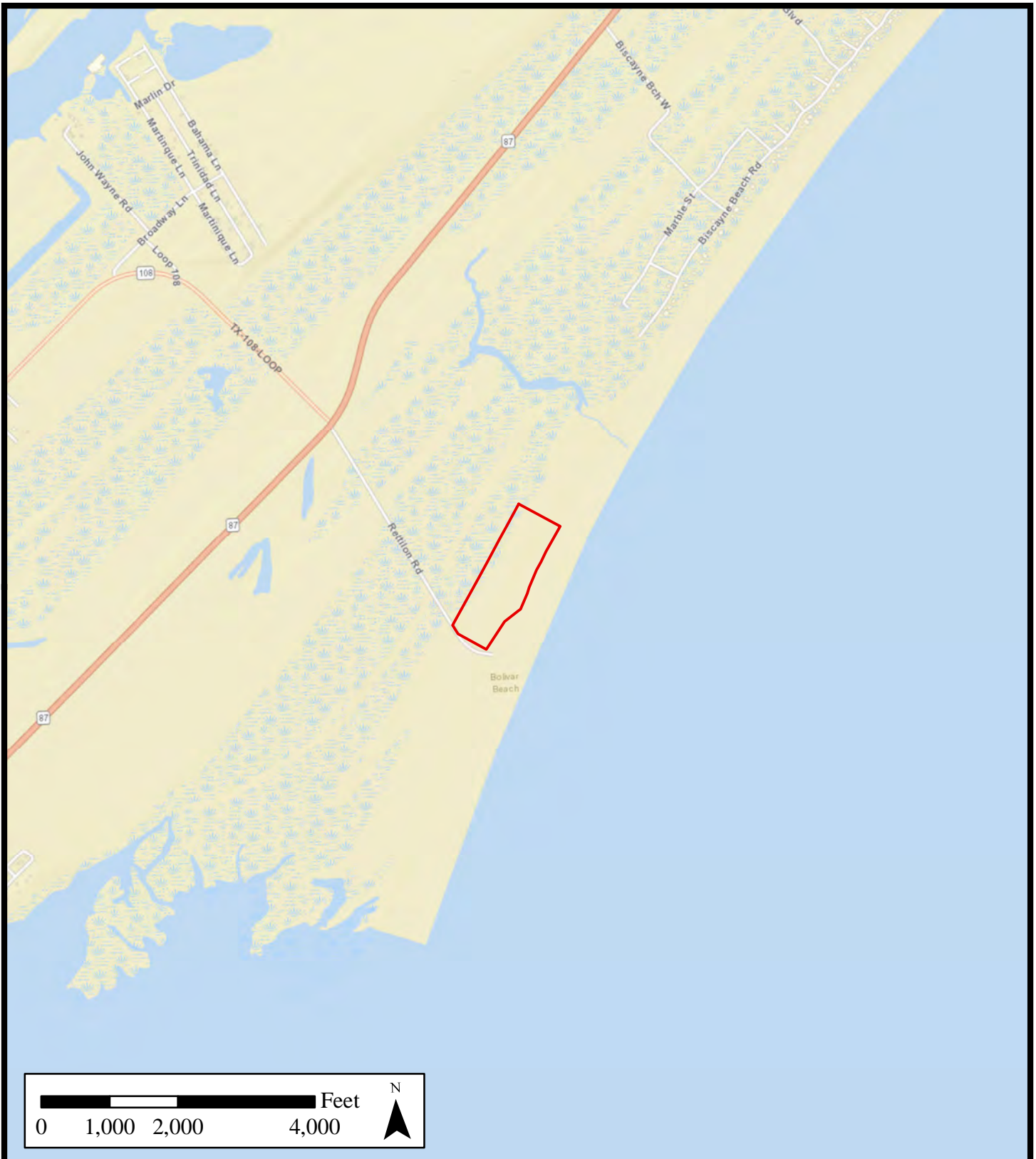

Legend

Subject Area

**Johnson Beach
Development LLC**

**Figure 2.0
Location**
Galveston County, Texas

Prepared by: 

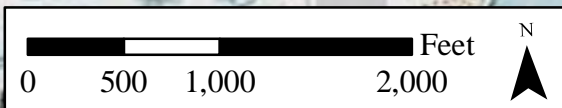

Legend

Subject Area

**Johnson Beach
Development LLC**

**Figure 3.0
Topographic**
Galveston County, Texas

Prepared by: 

Legend

- Survey Area - 32.76 acres
- Proposed Residential Property Boundary - 16.94 acres
- No Survey Conducted - 20.55 acres
- Open Water - 0.07 acres
- Wetlands - 6.12 acres

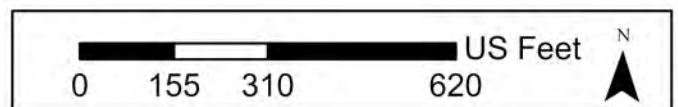
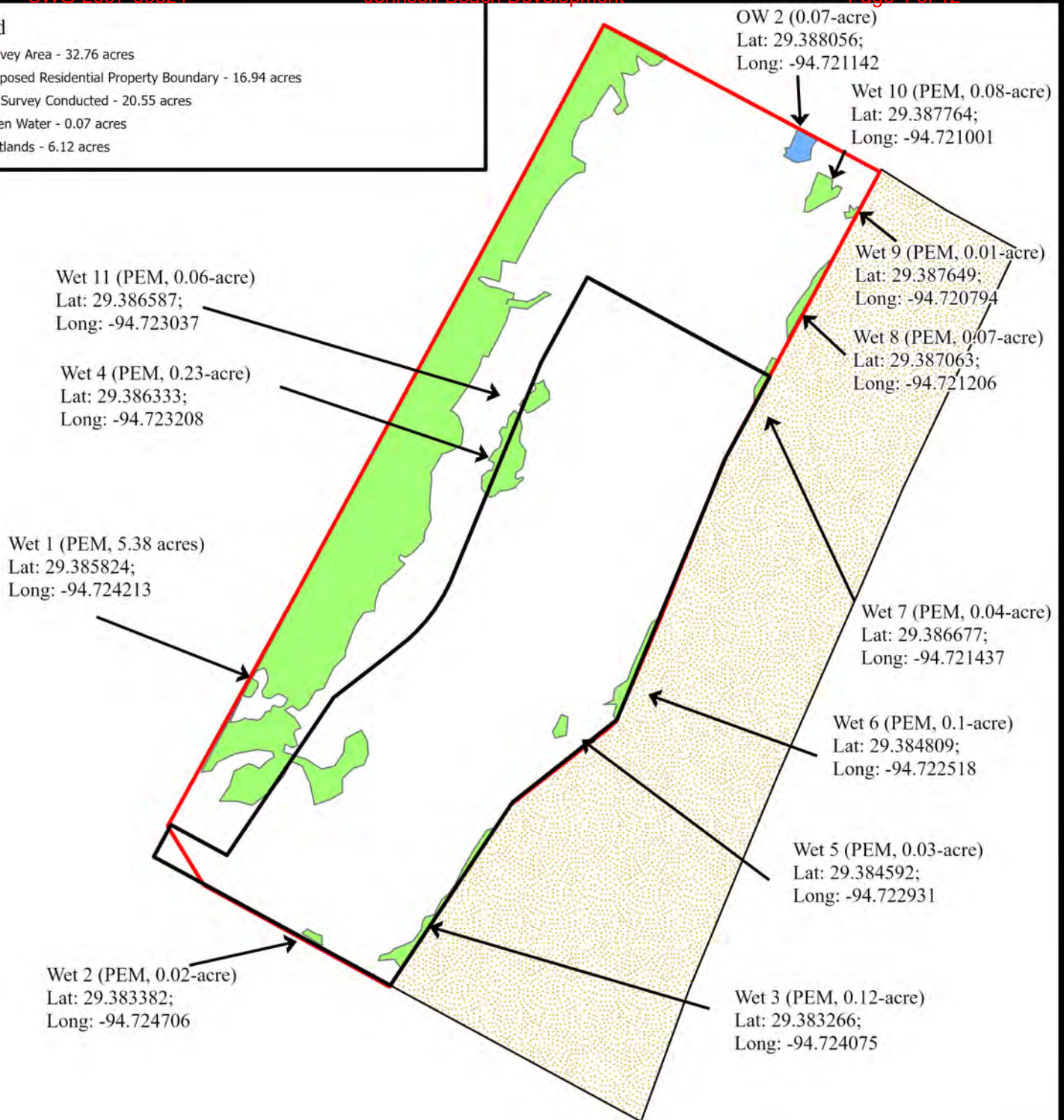

Prepared By:



OVERALL PLAN VIEW OF Johnson Beach Residential Development Project

Prepared For:

**Johnson Beach
Development, LLC**

Date Drawn: 10/28/2022

Project No: 3051

Permit Drawings

Drawn by: MTP

Legend

- Survey Area - 32.76 acres
- Proposed Residential Property Boundary - 16.94 acres
- No Survey Conducted - 20.55 acres
- Proposed Residential Lots
- Sanderling Drive - 3.01 acres
- 30-foot-wide Beach Access Easement - 0.26-acre
- 10-foot-wide Wooden Mat Beachfront Access - 0.09-acre
- Wetlands (Impacted) - 0.72-acre
- Previously Filled Wetland Crossing - 0.002-acre
- Open Water (Avoided) - 0.07-acre
- Wetlands (Avoided) - 5.39 acres

Wet 11
(0.05-acre impacted, 341 CY fill;
0.01-acre avoided)
Lat: 29.386587; Long: -94.723037

Wet 4
(0.8-acre impacted, 962 CY fill;
0.15-acre avoided)
Lat: 29.386333; Long: -94.723208

Wet 1
(0.24-acre impacted, 1,555 CY filled;
5.14 acres avoided)
Lat: 29.385824; Long: -94.724213

Wet 2
(0.02-acre impacted, 103 CY fill;
0.0 acre avoided)
Lat: 29.383382; Long: -94.724706

Wet 1
(95 sq.ft. impacted, 5 CY filled;
5.15 acres avoided)
Lat: 29.387722; Long: -94.722931

OW 2
(0.0 acre impacted;
0.07-acre avoided)
Lat: 29.388056; Long: -94.721142

Wet 10
(0.0 acre impacted;
0.08-acre avoided)
Lat: 29.387764; Long: -94.721001

Wet 9
(0.0 acre impacted;
0.01-acre avoided)
Lat: 29.387649; Long: -94.720794

Wet 8
(0.0 acre impacted;
0.07-acre avoided)
Lat: 29.387063; Long: -94.721206

Wet 7
(0.02-acre impacted, 141 CY;
0.01-acre avoided)
Lat: 29.386677; Long: -94.721437

Wet 6
(0.1-acre impacted, 619 CY fill;
0.0 acre avoided)
Lat: 29.384809; Long: -94.722518

Wet 5
(0.03-acre impacted, 165 CY fill;
0.0 acre avoided)
Lat: 29.384592; Long: -94.722931

Wet 3
(0.12-acre impacted, 793 CY;
0.0 acre avoided)
Lat: 29.383266; Long: -94.724075

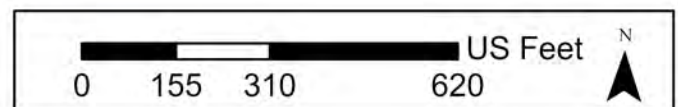

Prepared By:



Date Drawn: 10/28/2022

OVERALL PLAN VIEW OF Johnson Beach Residential Development Project

Prepared For:

**Johnson Beach
Development, LLC**

Project No: 3051

Permit Drawings

Drawn by: MTP

Legend

- Survey Area - 32.76 acres
- Proposed Residential Property Boundary - 16.94 acres
- No Survey Conducted - 20.55 acres
- Wetlands (Impacted) - 0.72-acre
- Previously Filled Wetland Crossing - 0.002-acre
- Open Water (Avoided) - 0.07-acre
- Wetlands (Avoided)- 5.39 acres

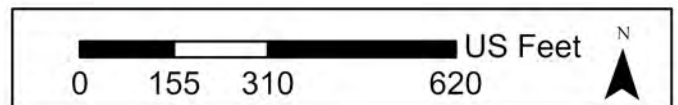

Prepared By:



Date Drawn: 10/28/2022

OVERALL PLAN VIEW OF Johnson Beach Residential Development Project

Prepared For:

**Johnson Beach
Development, LLC**

Project No: 3051

Permit Drawings

Drawn by: MTP

Legend

- Survey Area - 32.76 acres
- Proposed Residential Property Boundary - 16.94 acres
- No Survey Conducted - 20.55 acres
- Wetlands (Impacted) - 0.72-acre
- Previously Filled Wetland Crossing - 0.002-acre
- Open Water (Avoided) - 0.07-acre
- Wetlands (Avoided)- 5.39 acres

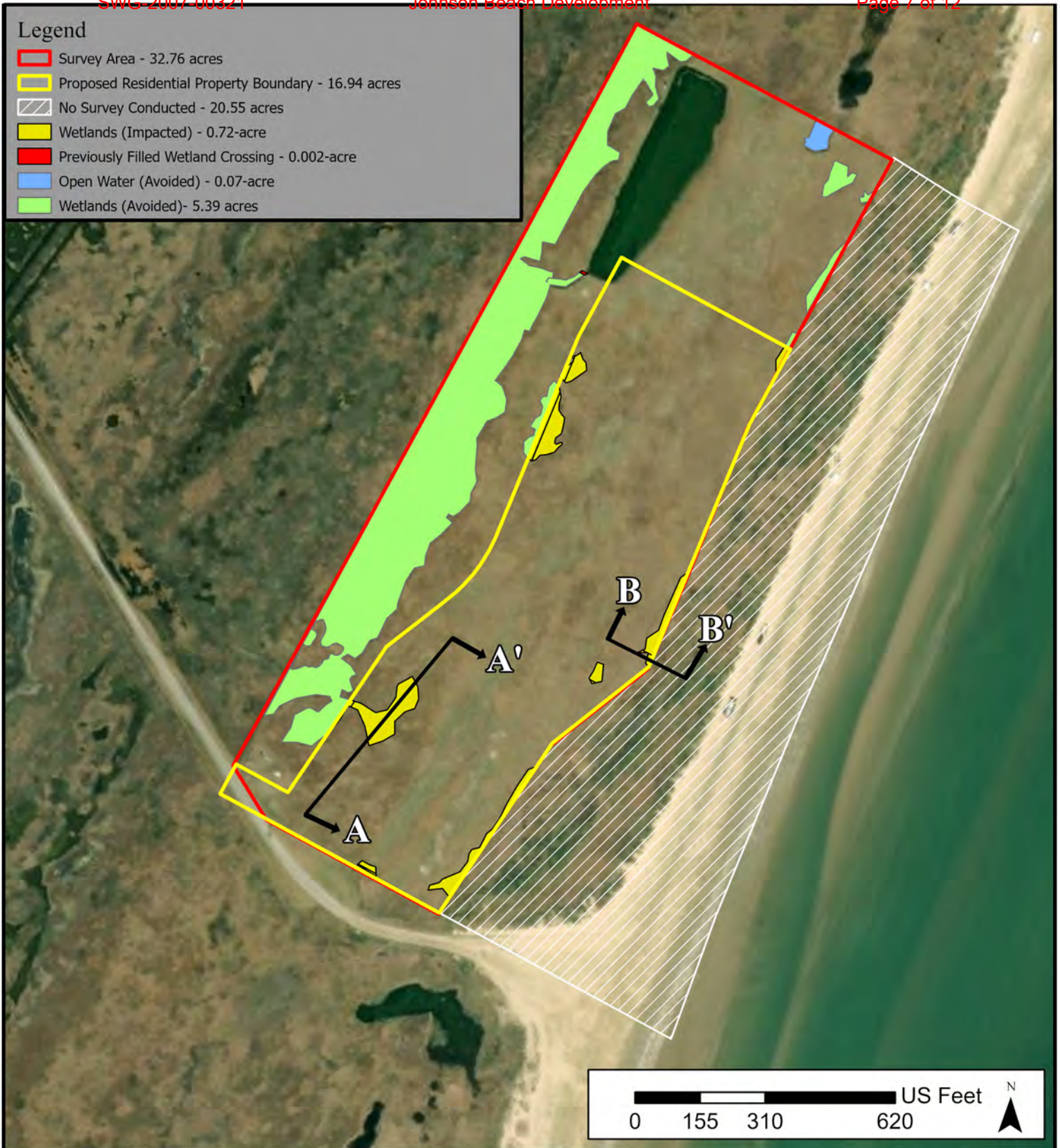

Prepared By:



Date Drawn: 10/28/2022

OVERALL PLAN VIEW OF Johnson Beach Residential Development Project

Prepared For:

**Johnson Beach
Development, LLC**

Project No: 3051

Permit Drawings

Drawn by: MTP



Typical Dirt Fill for Residential Lot

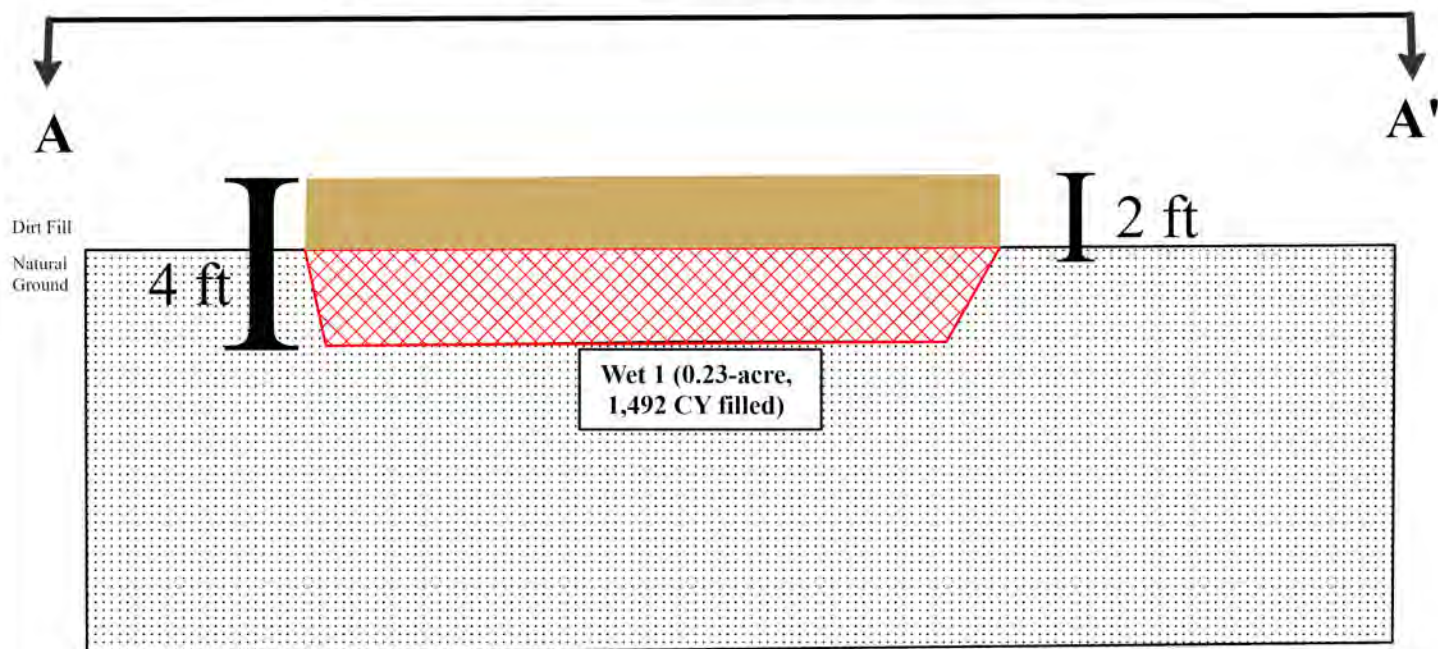

Legend

Existing Uplands

Total Impacted Vegetated Waters of the U.S. (0.24-acre / 1,555 CY fill)

Fill Dirt

ILLUSTRATION NOT TO SCALE

Prepared By:



OVERALL Profile VIEW OF A - A'

Johnson Beach Residential Development Project

Prepared For:

Johnson Beach Development, LLC

Date Drawn: 10/28/2022

Project No: 3051

Permit Drawings

Drawn by: MTP



30-foot-wide Beach Access Easement



10-foot-wide Wood Mat Crossover to Beachfront

Natural
Ground

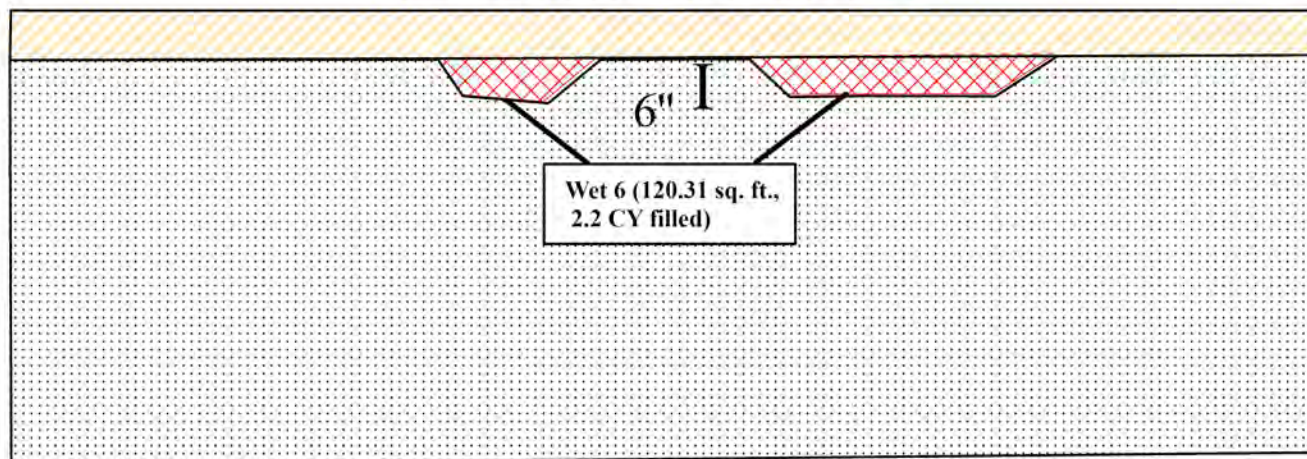

Legend



-  Existing Uplands
-  Total Impacted Vegetated Waters of the U.S. (120.31 sq. ft. / 2.2 CY Fill)

ILLUSTRATION NOT TO SCALE

Prepared By:



Date Drawn: 10/28/2022

OVERALL Profile VIEW OF B - B'

Johnson Beach Residential Development Project

Prepared For:

**Johnson Beach
Development, LLC**

Project No: 3051

Permit Drawings

Drawn by: MTP

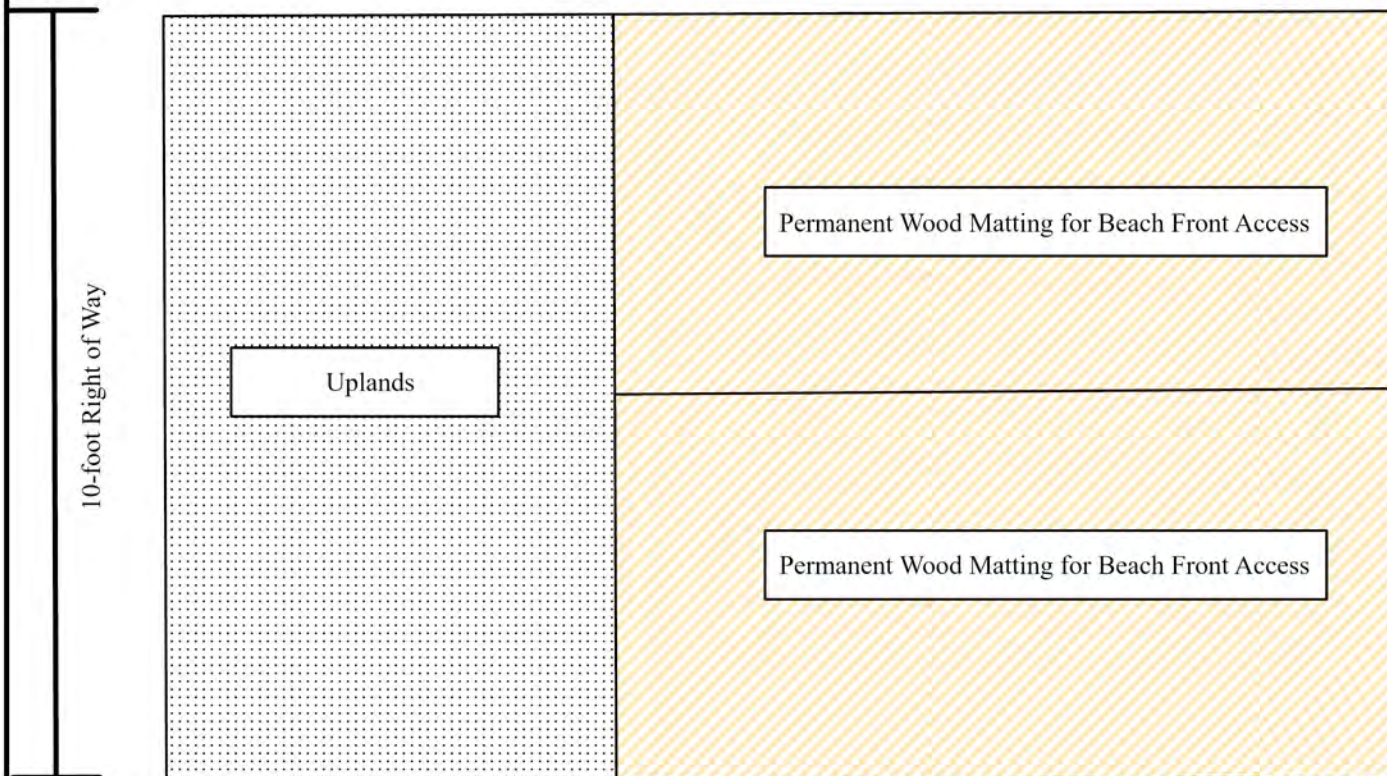
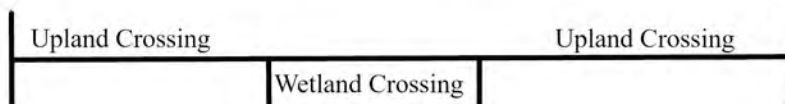

ILLUSTRATION NOT TO SCALE

Prepared By:



Date Drawn: 10/28/2022

OVERALL OVERHEAD PLAN VIEW

Johnson Beach Residential Development Project

Prepared For:

**Johnson Beach
Development, LLC**

Project No: 3051

Permit Drawings

Drawn by: MTP

PEM Wetland Pre-Construction View

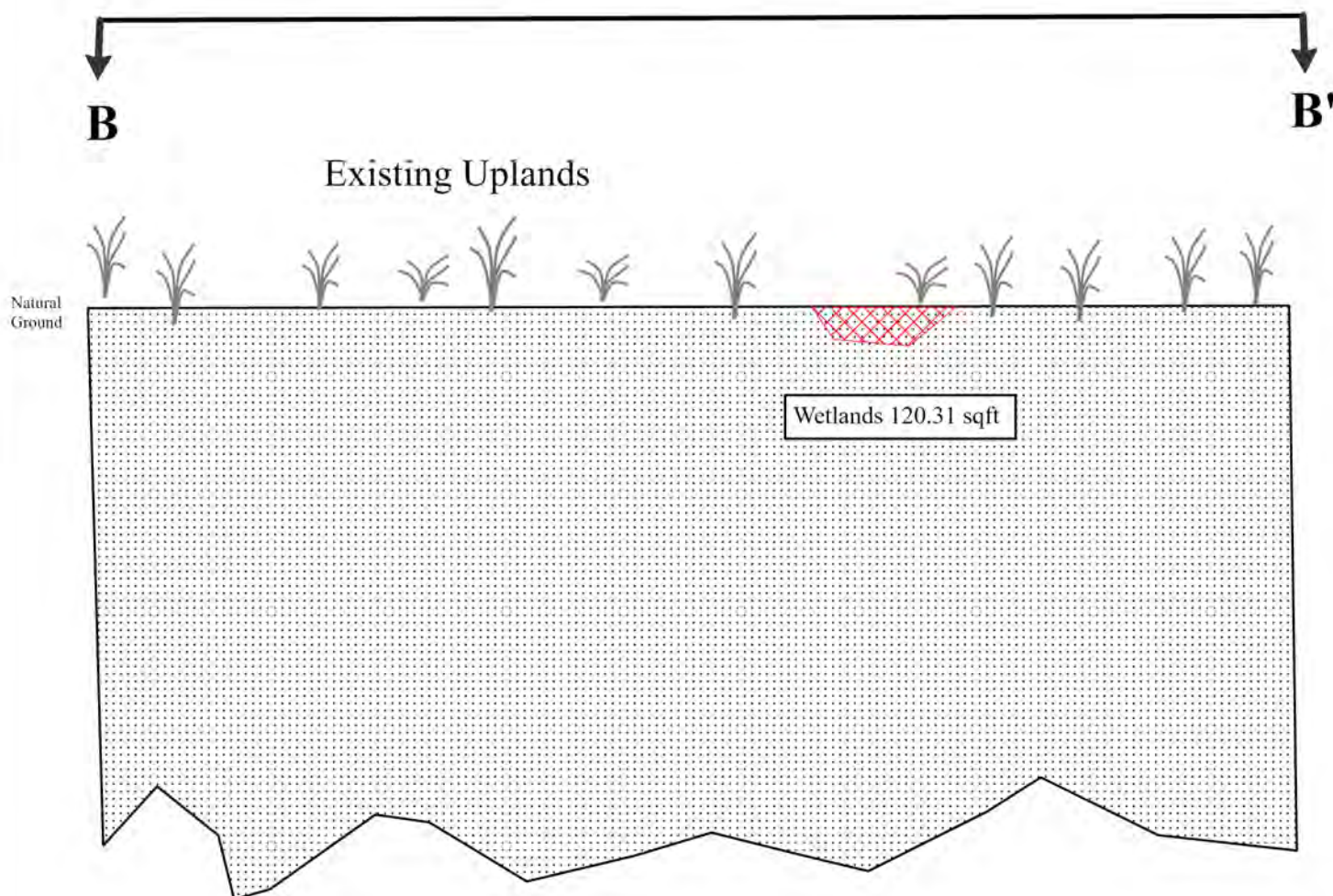

ILLUSTRATION NOT TO SCALE

Prepared By:



Date Drawn: 10/28/2022

PRE-CONSTRUCTION CROSS-SECTION VIEW

**Johnson Beach Residential
Development Project**

Prepared For:

**Johnson Beach
Development, LLC**

Project No: 3051

Permit Drawings

Drawn by: MTP

PEM Wetland Post-Construction View

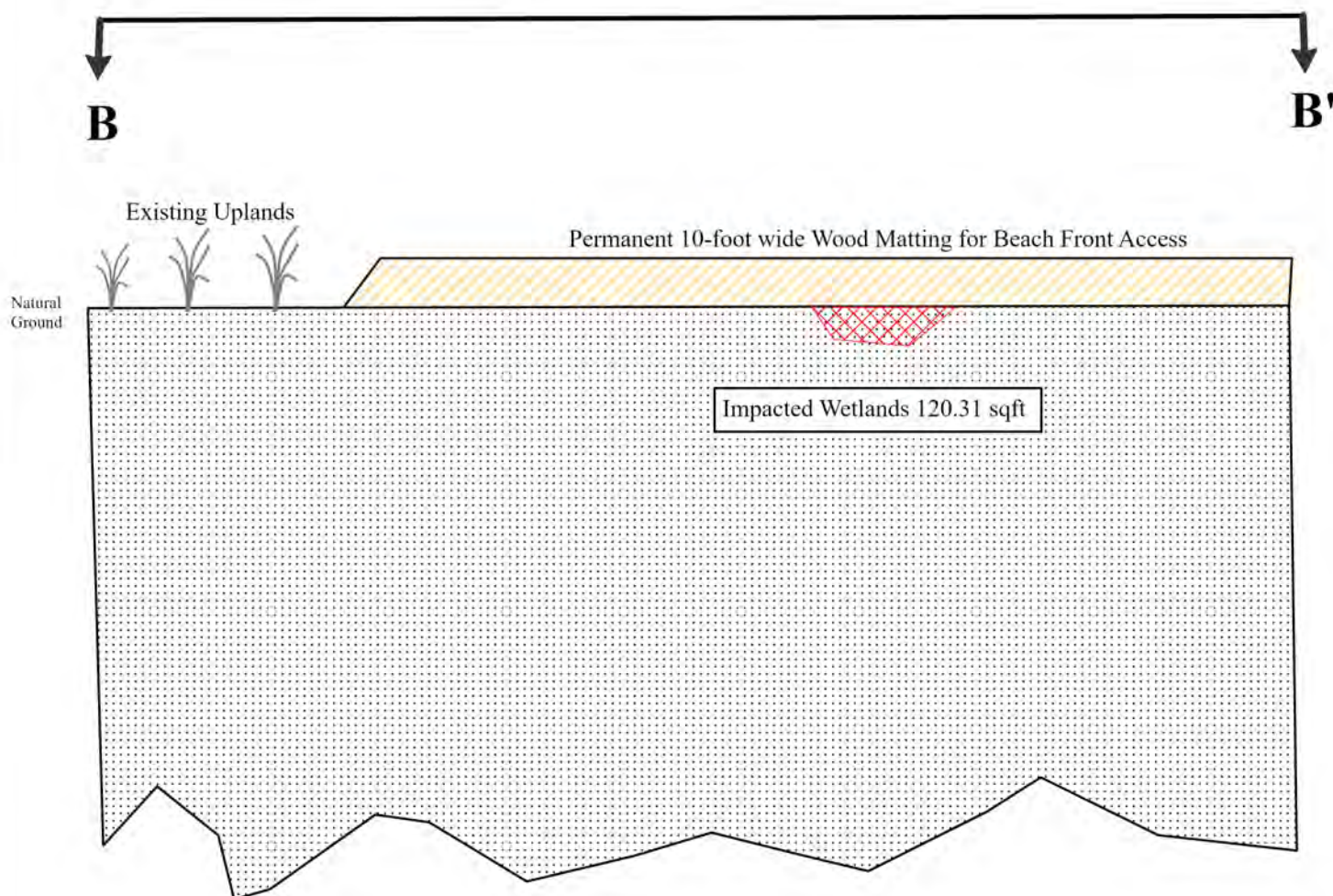

ILLUSTRATION NOT TO SCALE

Prepared By:



Date Drawn: 10/28/2022

POST-CONSTRUCTION CROSS-SECTION VIEW

**Johnson Beach Residential
Development Project**

Prepared For:

**Johnson Beach
Development, LLC**

Project No: 3051

Permit Drawings

Drawn by: MTP