

Exhibit 4: Rollover Recreational Area Gulf Side

Sheet 1 of 9

Galveston County, Texas

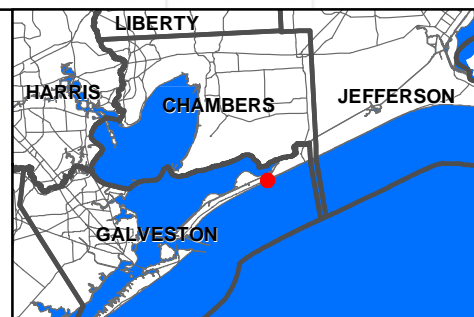
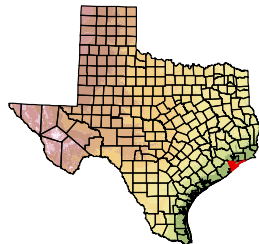
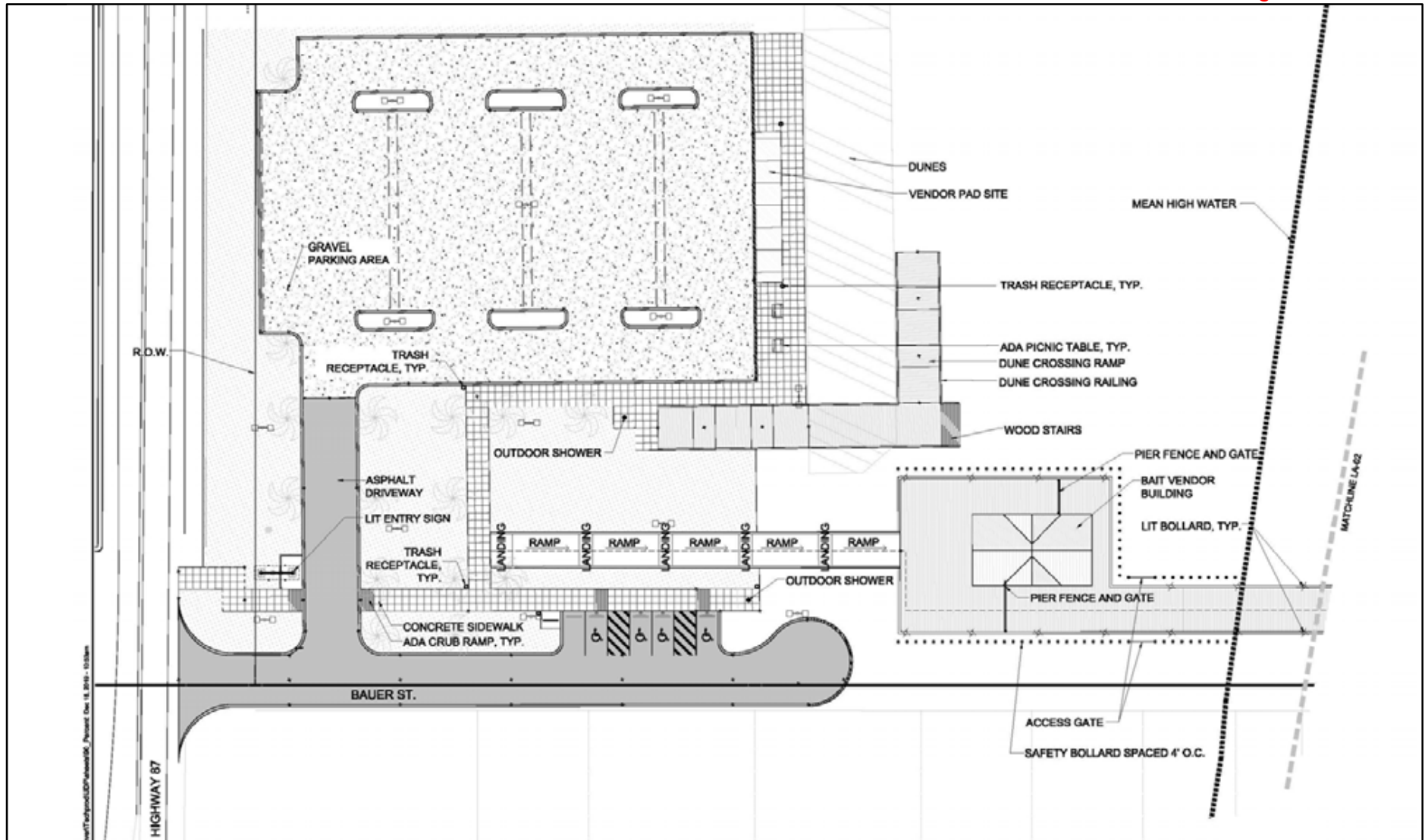

Exhibit 4: Rollover Recreational Area Gulf Side

Sheet 2 of 9

Galveston County, Texas

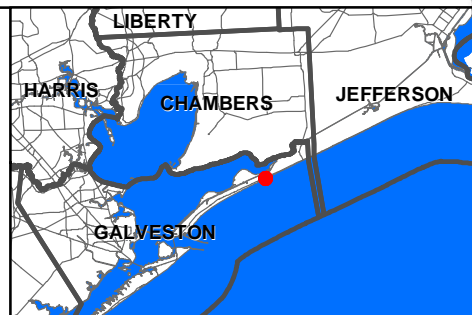
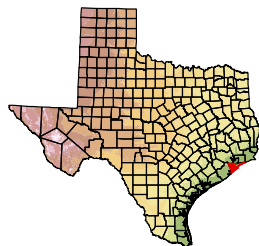
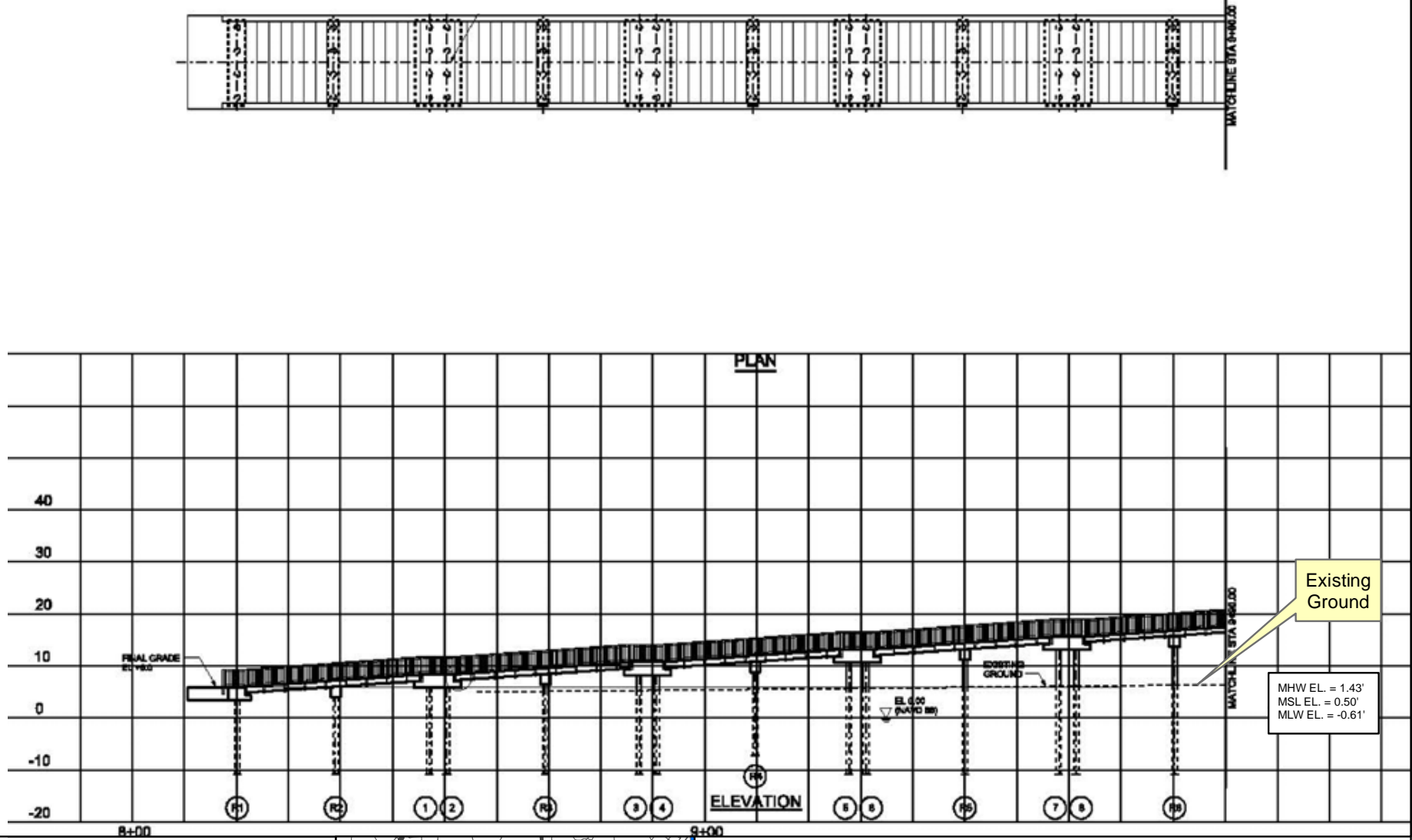

Exhibit 4: Rollover Recreational Area Gulf Side

Sheet 3 of 9

Galveston County, Texas

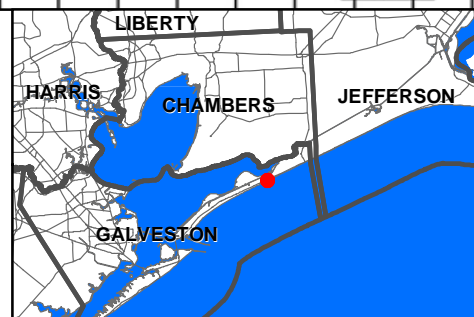
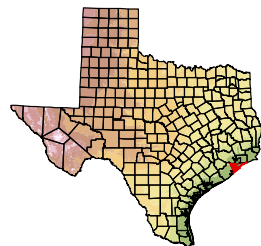
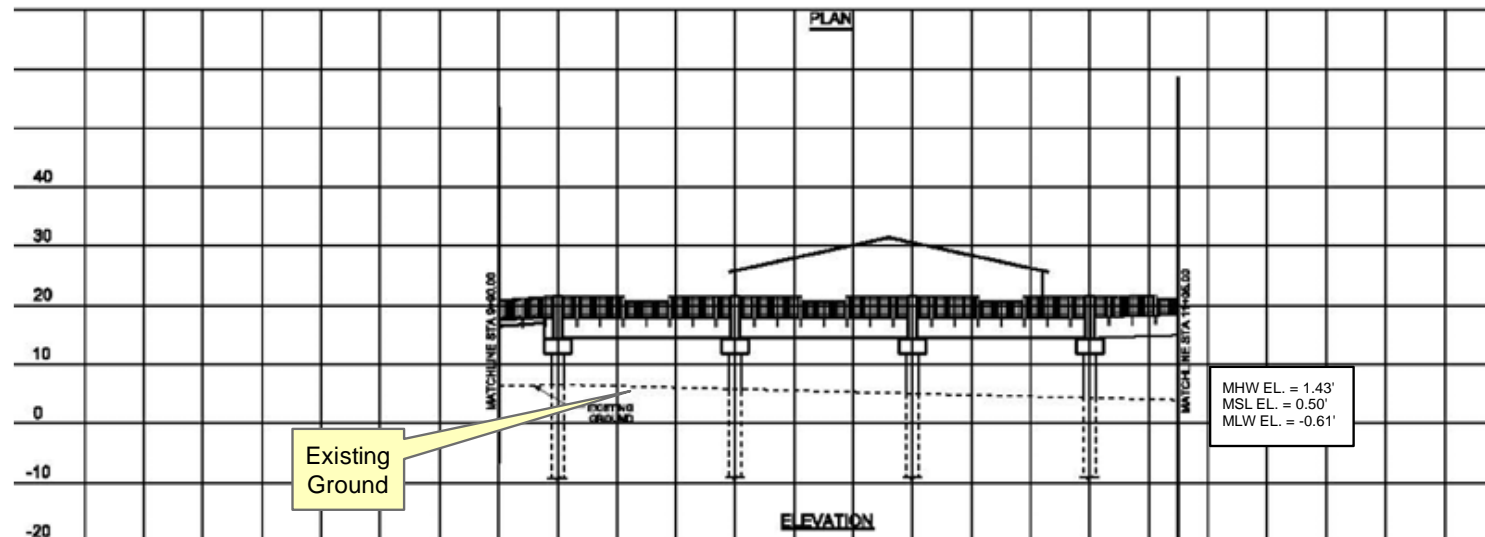
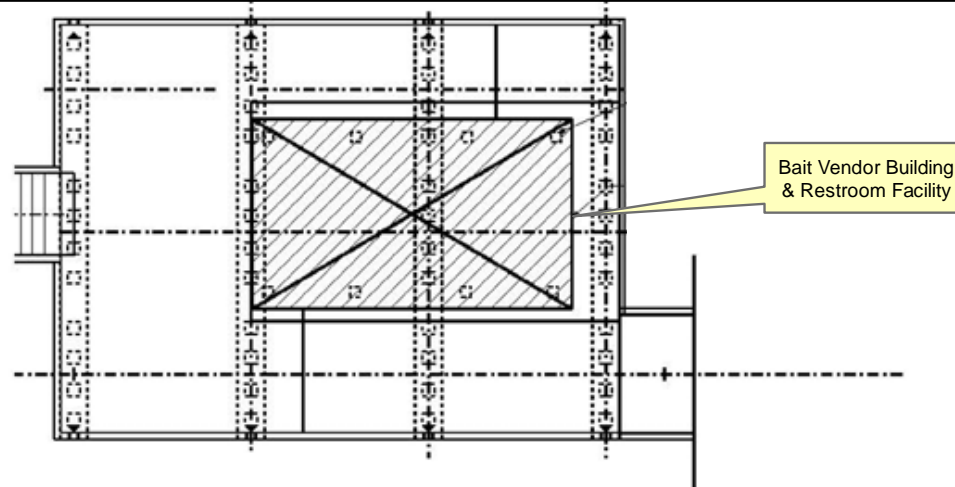
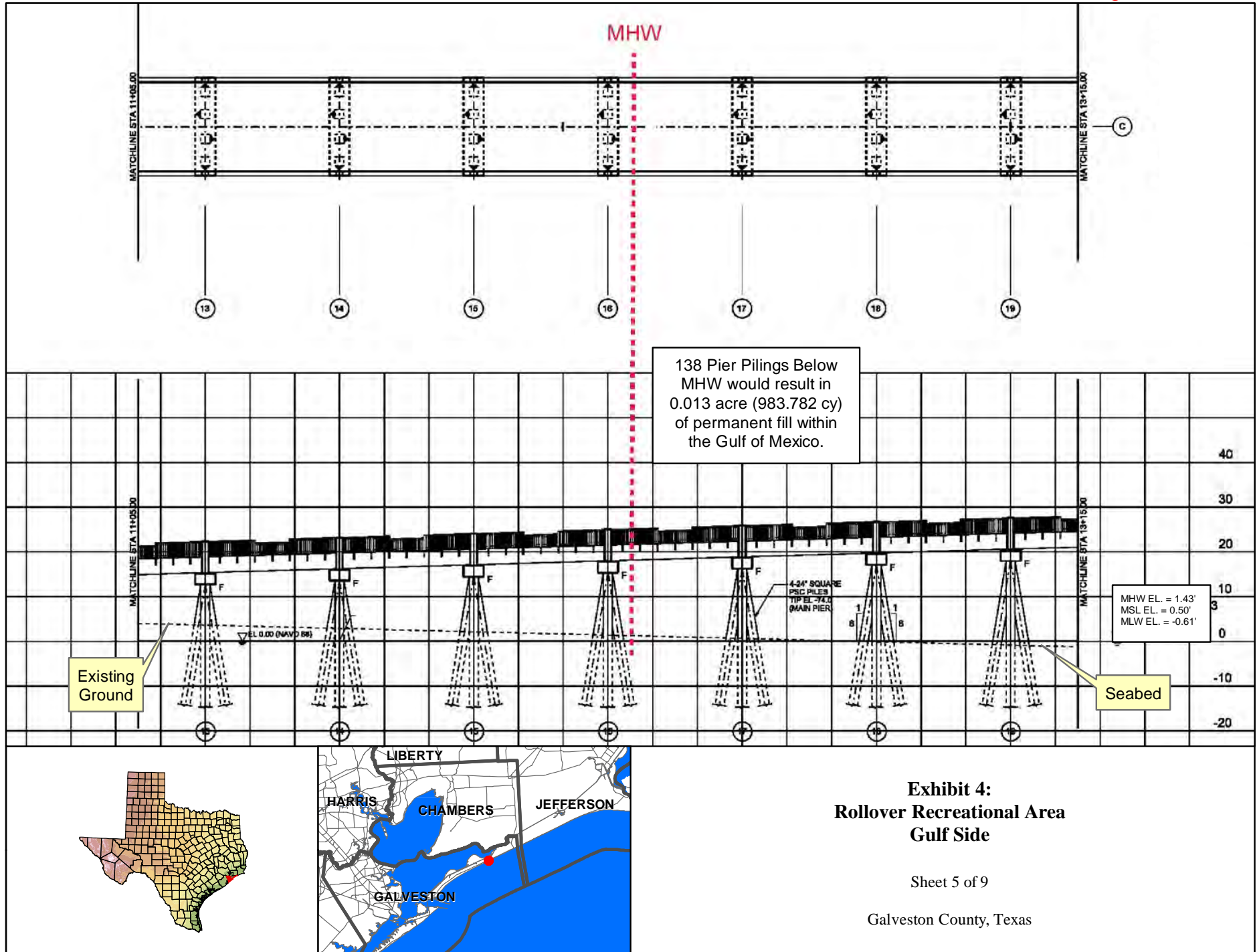
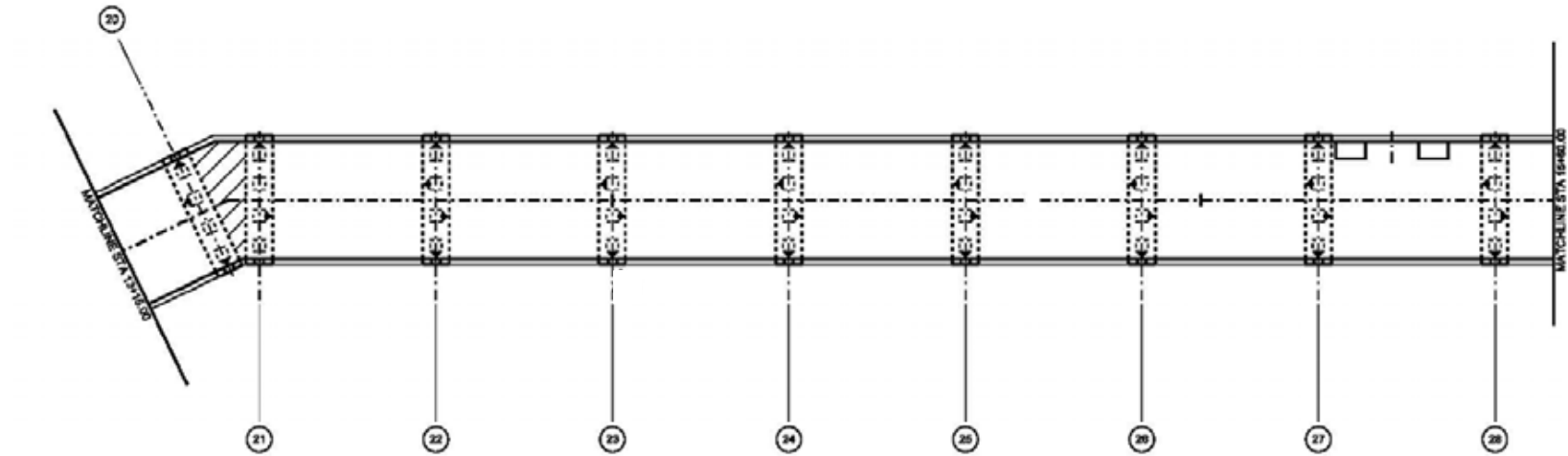

Exhibit 4: Rollover Recreational Area Gulf Side

Sheet 4 of 9

Galveston County, Texas





138 Pier Pilings Below MHW would result in 0.013 acre (983.782 cy) of permanent fill within the Gulf of Mexico.

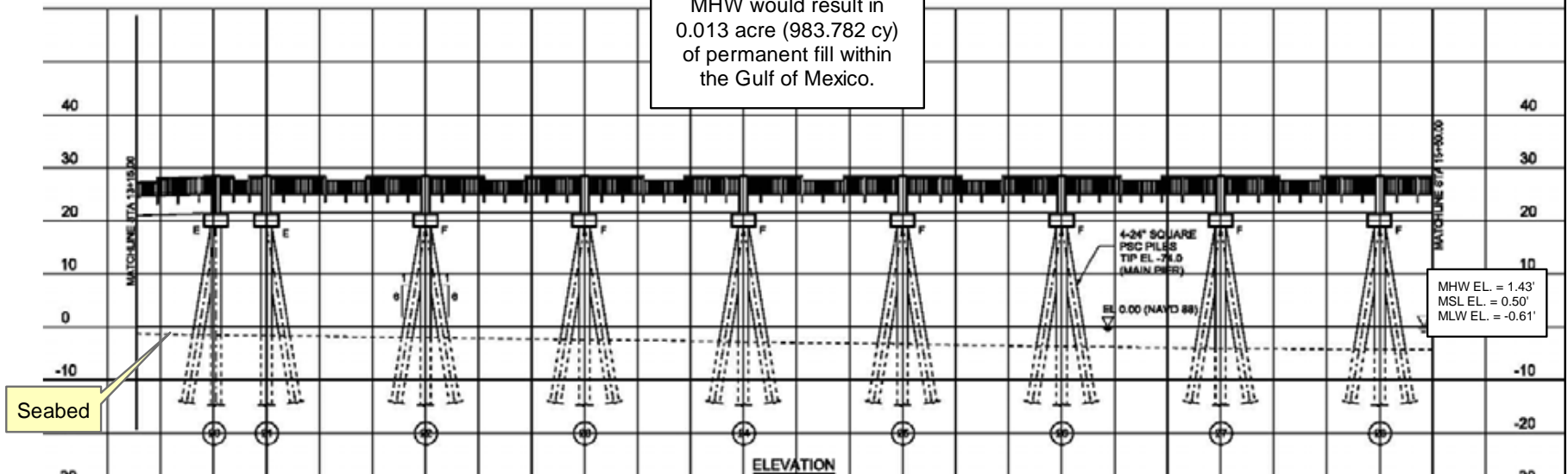

MHW EL. = 1.43'
MSL EL. = 0.50'
MLW EL. = -0.61'

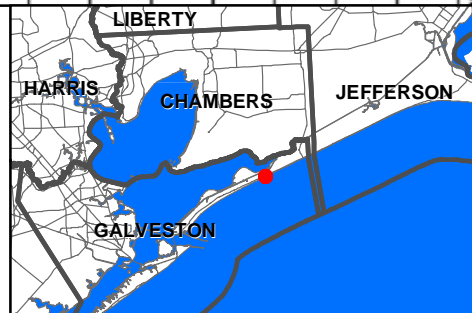
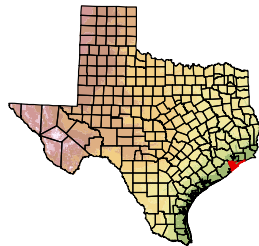
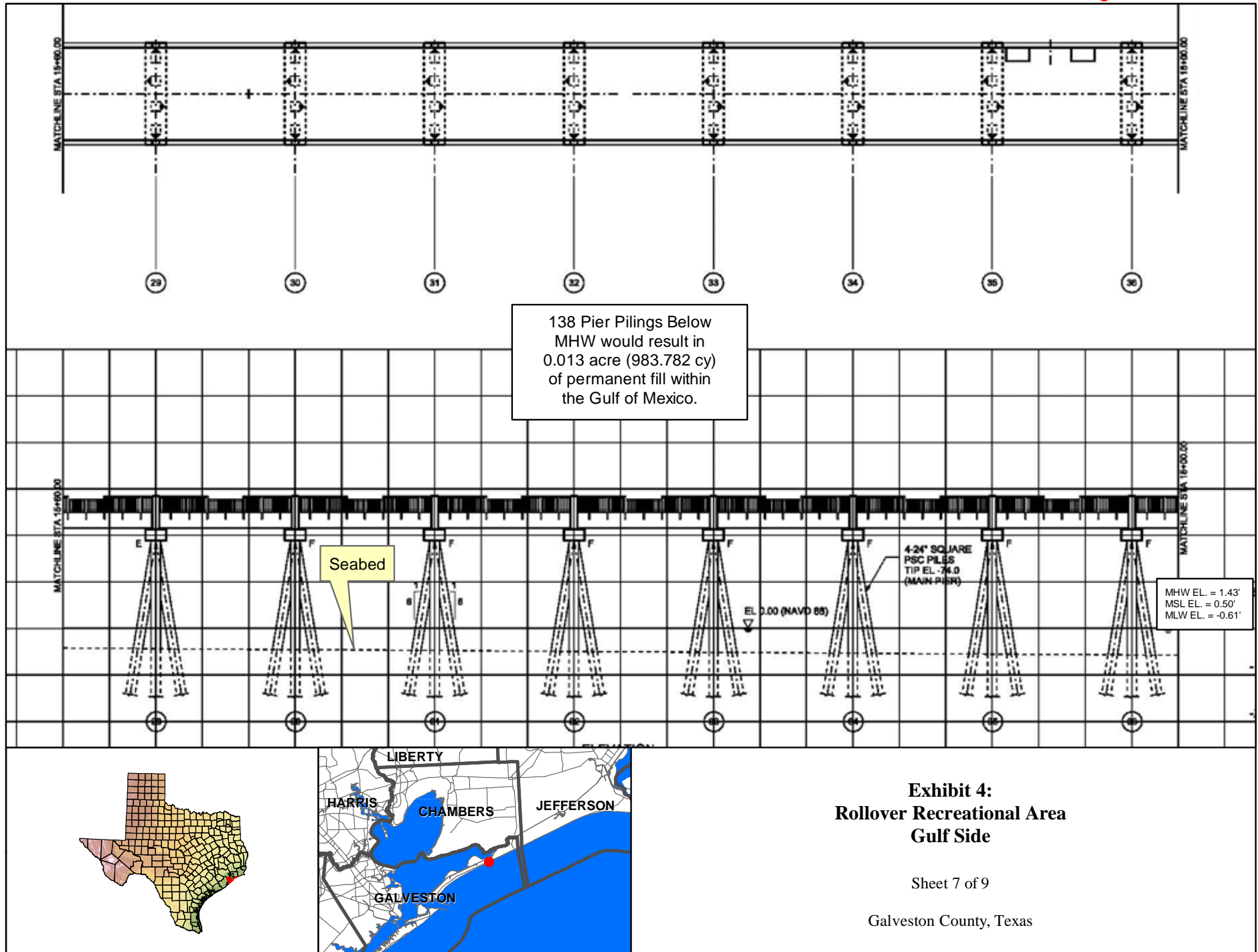
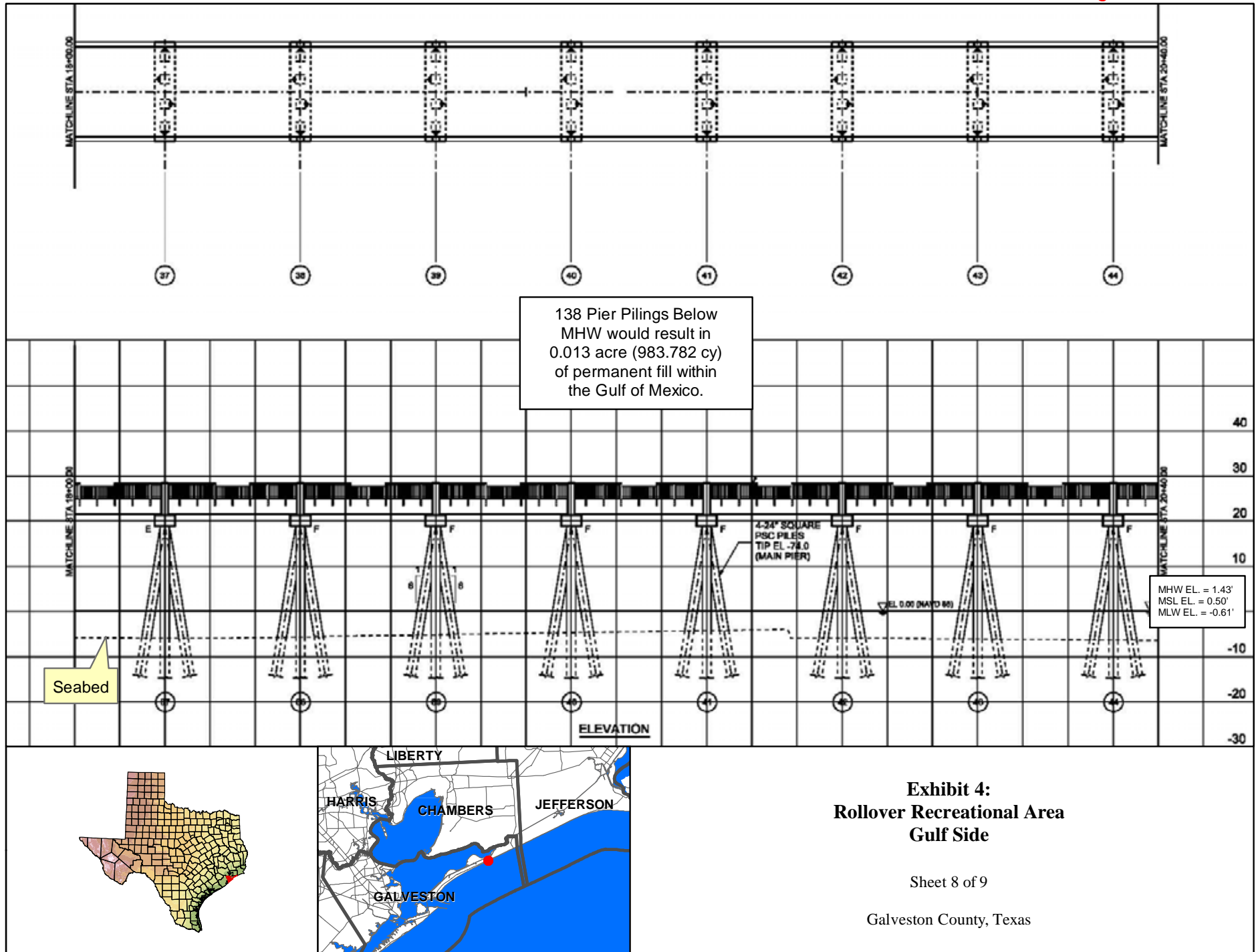

Exhibit 4: Rollover Recreational Area Gulf Side

Sheet 6 of 9

Galveston County, Texas

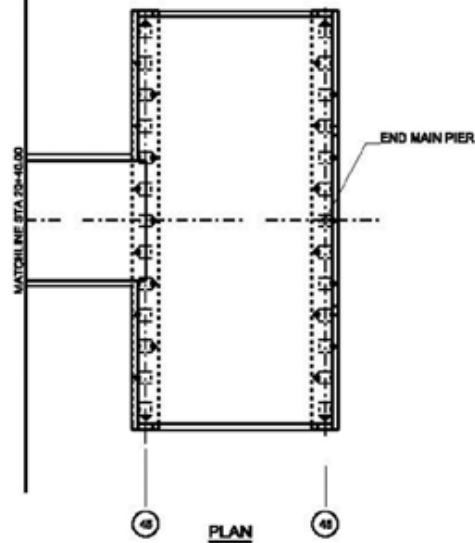



**Exhibit 4:
Rollover Recreational Area
Gulf Side**

Sheet 8 of 9

Galveston County, Texas



138 Pier Pilings Below
MHW would result in
0.013 acre (983.782 cy)
of permanent fill within
the Gulf of Mexico.

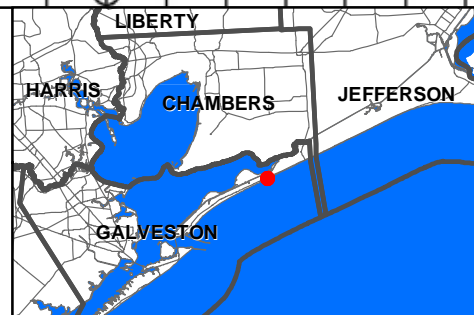
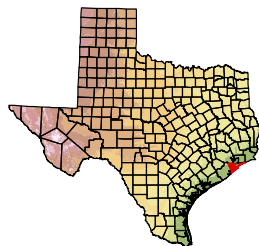
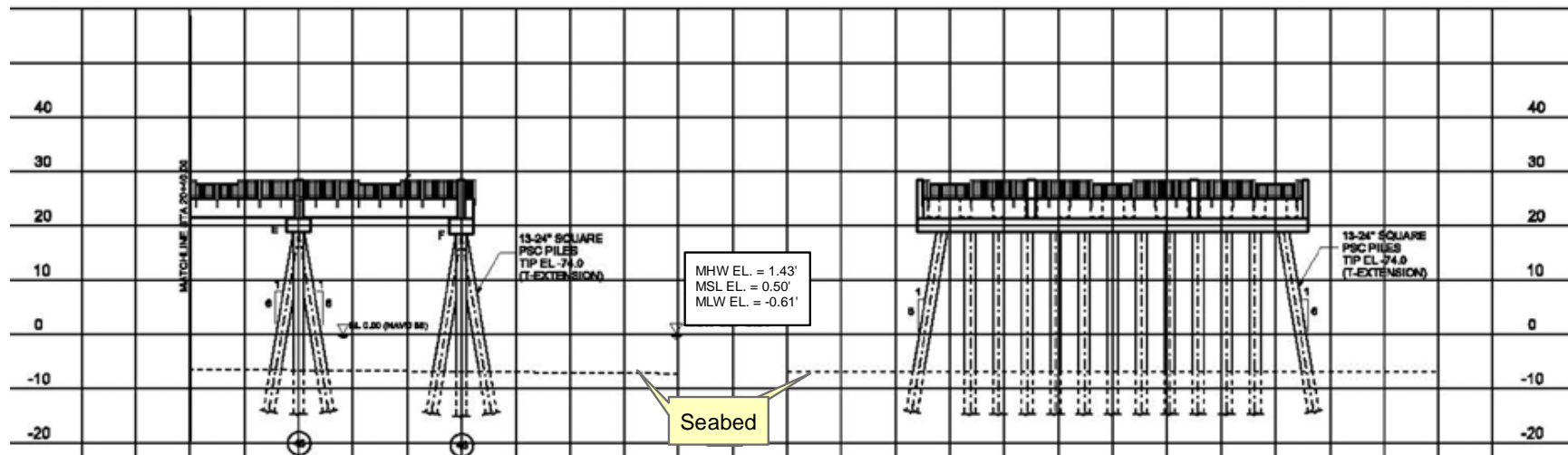

Exhibit 4: Rollover Recreational Area Gulf Side

Sheet 9 of 9

Galveston County, Texas