

Legend

- ★ Project Location
- County Boundary

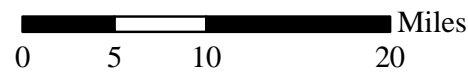

Prepared by:



**Fort Bend County
Mobility Projects
W. Sycamore and
Westenfeldt Road Projects**

**Figure 1.0
Vicinity**
Fort Bend County, Texas

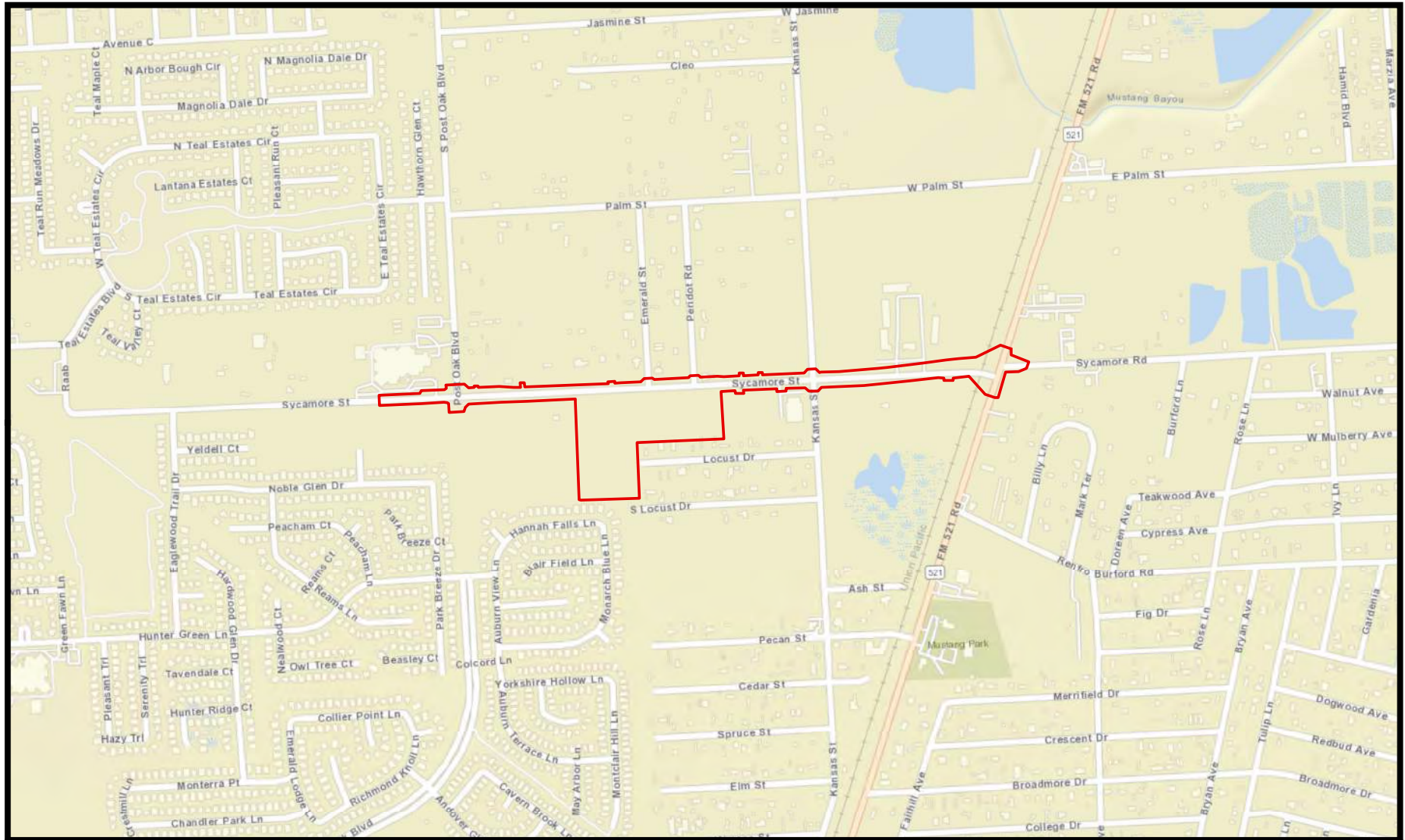

Legend
 Project Boundary

0 500 1,000 2,000 Feet

Prepared by: 



**Fort Bend County
 Mobility Projects
 W. Sycamore and
 Westenfeldt Road Projects**

**Figure 2.0
 Location**
 Fort Bend County, Texas

Page 1 of 14

OVERALL PLAN VIEW

LEGEND

-  West Sycamore Road Expansion Project – 24.94 Acres Tract
-  Total Vegetated Waters of the U.S. 4.14 acres
-  Total Non-Vegetated Waters of the U.S. 0.03 acres

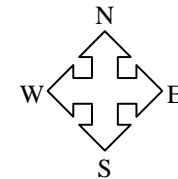
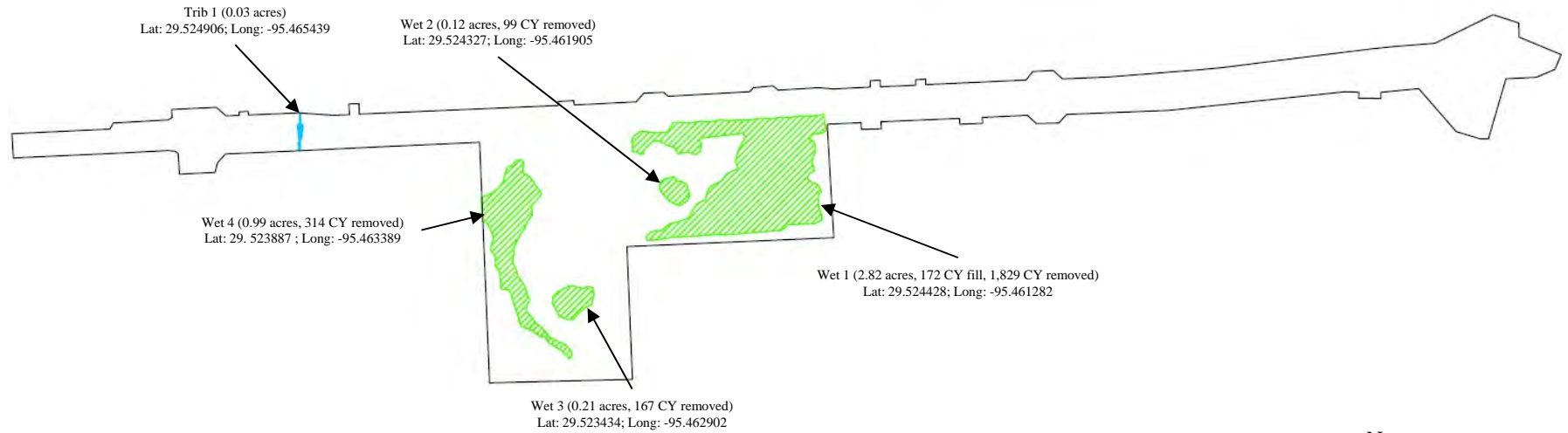

ILLUSTRATION NOT TO SCALE

Prepared by:



Date: 5/13/2022

OVERALL PLAN VIEW OF
Fort Bend County
West Sycamore Road Expansion

Prepared for:

Fort Bend County Engineering

Project No: 2346.02







Drawn By: JG

File: Permit Drawings

Page 2 of 14

OVERALL PLAN VIEW

LEGEND

-  West Sycamore Road Expansion Project – 24.94 Acres Tract
-  Impacted Waters of the U.S. 0.42 acres (172 CY fill)
-  Impacted Waters of the U.S. 3.05 acres (2409 CY removed)
-  Total Avoided Vegetated Waters of the U.S. 0.67 acres
-  Total Impacted Non-Vegetated Waters of the U.S. 0.03 acres
-  Typical Road

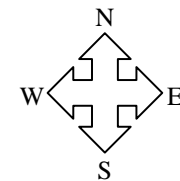
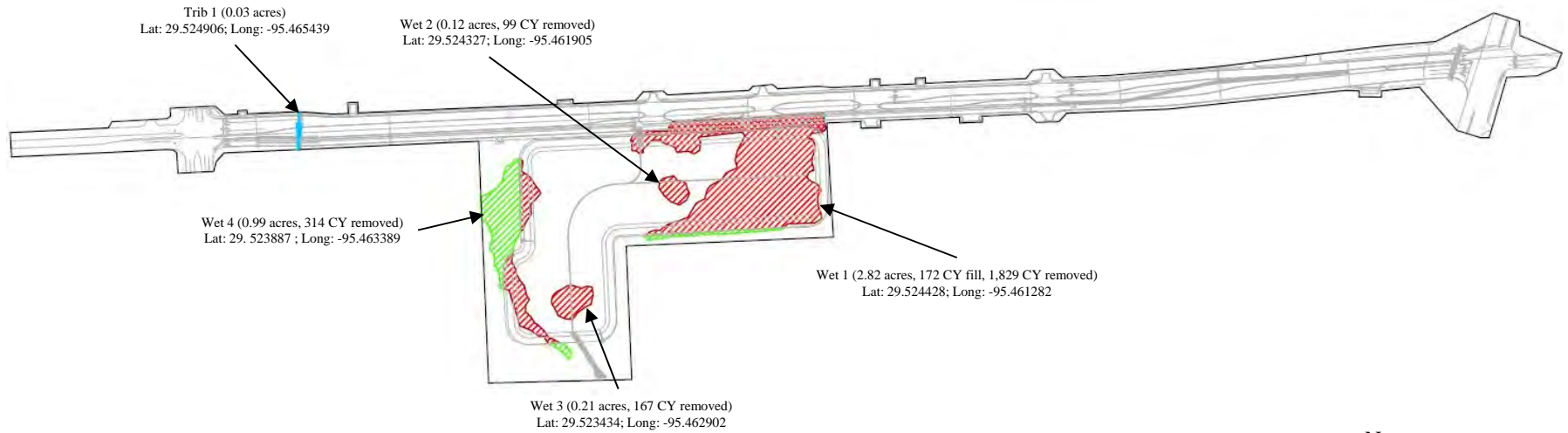







ILLUSTRATION NOT TO SCALE

<p>Prepared by:</p>  <p>Date: 5/13/2022</p>	<p>OVERALL PLAN VIEW OF</p> <p>Fort Bend County</p> <p>West Sycamore Road Expansion</p>	<p>Prepared for:</p> <p style="text-align: center;">Fort Bend County Engineering</p>		
		<p>Project No: 2346.02</p>	<p>Drawn By: JG</p>	<p>File: Permit Drawings</p>

Page 3 of 14

OVERALL PLAN VIEW

LEGEND

-  West Sycamore Road Expansion Project – 24.94 Acres Tract
-  Impacted Waters of the U.S. 0.42 acres (172 CY fill)
-  Impacted Waters of the U.S. 3.05 acres (2409 CY removed)
-  Total Avoided Vegetated Waters of the U.S. 0.67 acres
-  Total Impacted Non-Vegetated Waters of the U.S. 0.03 acres

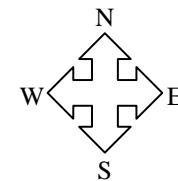
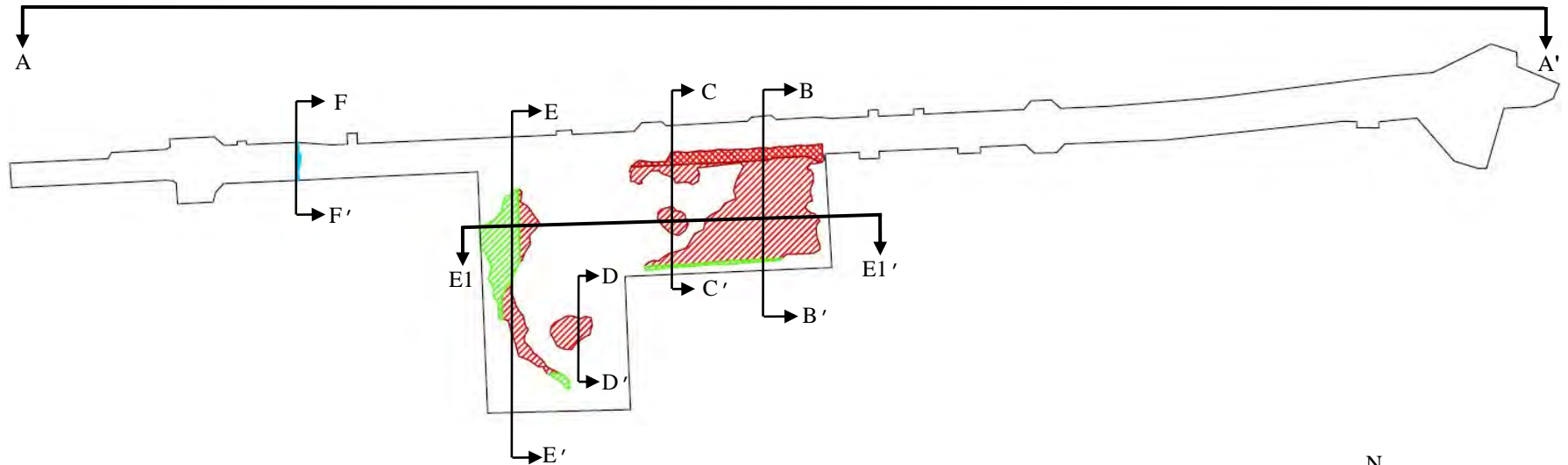

ILLUSTRATION NOT TO SCALE

Prepared by:



Date: 5/13/2022

OVERALL PLAN VIEW OF
Fort Bend County
West Sycamore Road Expansion

Prepared for:

Fort Bend County Engineering

Project No: 2346.02





Drawn By: JG

File: Permit Drawings

Page 4 of 14

OVERALL PLAN VIEW

LEGEND

-  West Sycamore Road Expansion Project – 24.94 Acres Tract
-  Impacted Waters of the U.S. 0.42 acres (172 CY fill)
-  Impacted Waters of the U.S. 3.05 acres (2409 CY removed)
-  Total Avoided Vegetated Waters of the U.S. 0.67 acres
-  Total Impacted Non-Vegetated Waters of the U.S. 0.03 acres

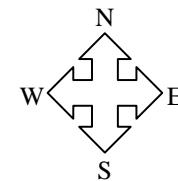
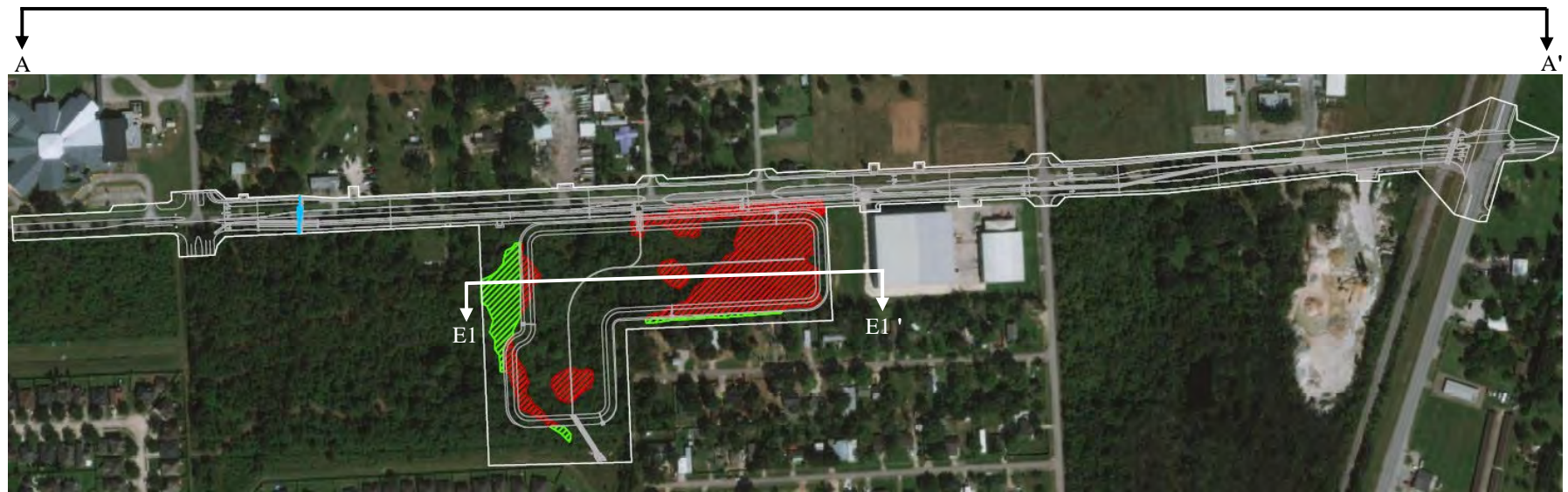

ILLUSTRATION NOT TO SCALE

Prepared by:



Date: 5/13/2022

OVERALL PLAN VIEW OF
Fort Bend County
West Sycamore Road Expansion

Prepared for:

Fort Bend County Engineering





Project No: 2346.02

Drawn By: JG

File: Permit Drawings

PROFILE VIEW A - A'

LEGEND

-  Project Boundary
-  Impacted Waters of the U.S. 0.42 acres (172 CY fill)
-  Impacted Waters of the U.S. 3.05 acres (2409 CY removed)
-  Total Impacted Non-Vegetated Waters of the U.S. 0.03 acres
-  Existing Uplands

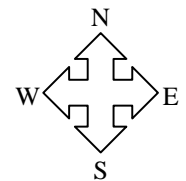
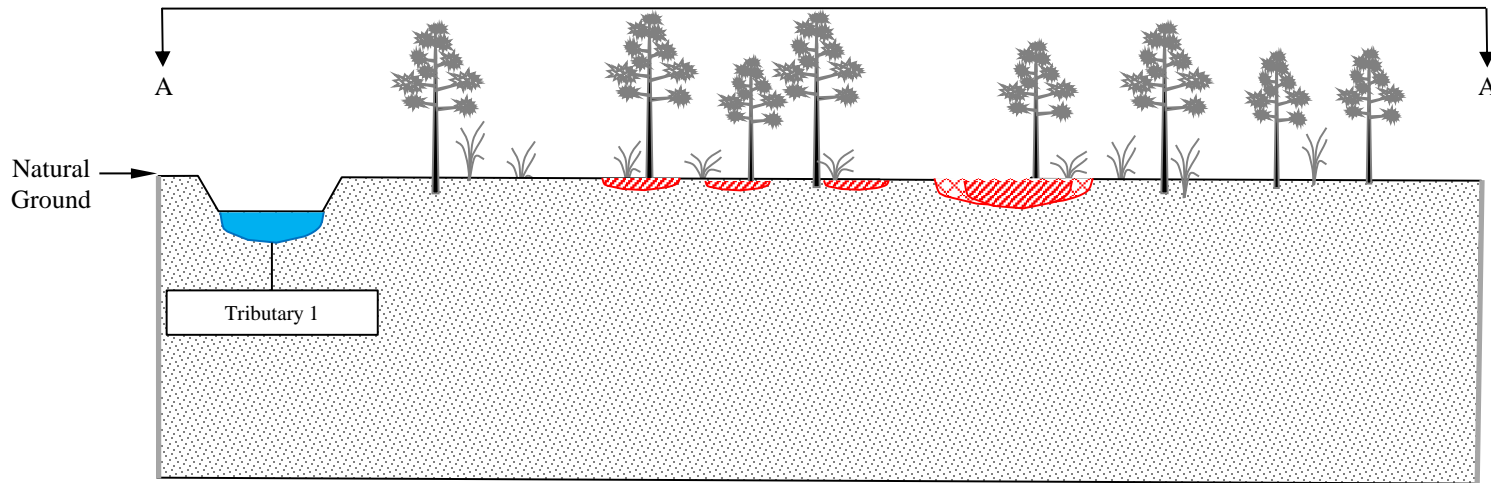

ILLUSTRATION NOT TO SCALE

Prepared by:



Date: 5/13/2022

OVERALL PROFILE VIEW OF A - A'
Fort Bend County
West Sycamore Road Expansion

Prepared for:

Fort Bend County Engineering

Project No: 2346.02

Drawn By: JG

File: Permit Drawings

Page 6 of 14

DETAIL KEY

- Survey Boundary
- Planned Retention Pond
- Pavement Limits

**DETAIL PLAN VIEW of
CROSS-SECTIONS B & C**

LEGEND

- Impacted Waters of the U.S. 0.42 acres (172 CY fill) (shown on page)
- Impacted Waters of the U.S. 2.45 acres (2,409 CY removed) (shown on page)
- Total Avoided Vegetated Waters of the U.S. 0.07 acres (shown on page)
- Proposed Road Features

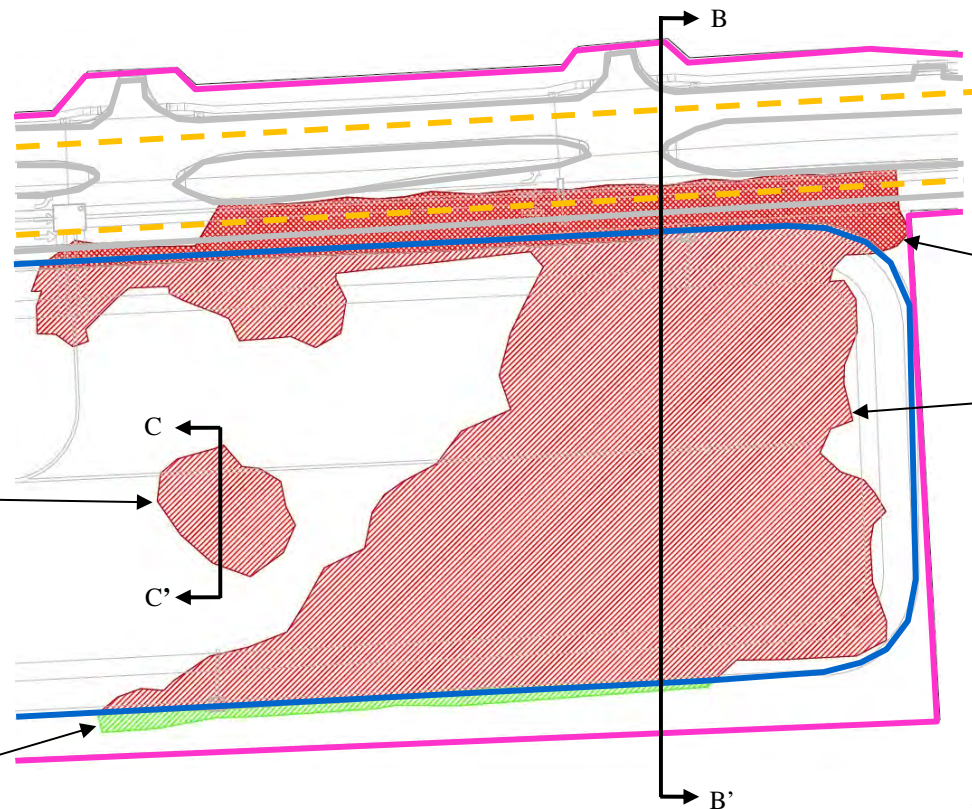

Wet 2 (0.12 acres, 99 CY removed)
Lat: 29.524327; Long: -95.461905
To be excavated for a retention pond

Wet 1 (0.42 acres, 172 CY fill)
Lat: 29.524848; Long: -95.461311
To be filled with clean earthen fill material and concrete

Wet 1 (2.33 acres, 1,829 CY removed)
Lat: 29.524381; Long: -95.461286
To be excavated for a retention pond

Wet 1 (0.07 acres)
Lat: 29.523962; Long: -95.461575
Avoided Waters of the U.S.

ILLUSTRATION NOT TO SCALE

Prepared by:



Date: 5/13/2022

OVERALL PLAN VIEW OF A-A' to C-C'
Fort Bend County
West Sycamore Road Expansion

Prepared for:

Fort Bend County Engineering

Project No: 2346.02

Drawn By: JG

File: Permit Drawings

Page 7 of 14

CROSS-SECTION VIEW B – B'

LEGEND	
	Project Boundary
	Total Impacted Waters of the U.S. 0.42 acres (172 CY fill) – Wet 1
	Total Impacted Waters of the U.S. 2.33 acres (1,829 CY removed) – Wet 1
	Total Avoided Vegetated Waters of the U.S. 0.07 acres – Wet 1
	Existing Uplands

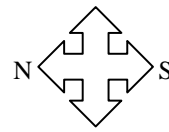
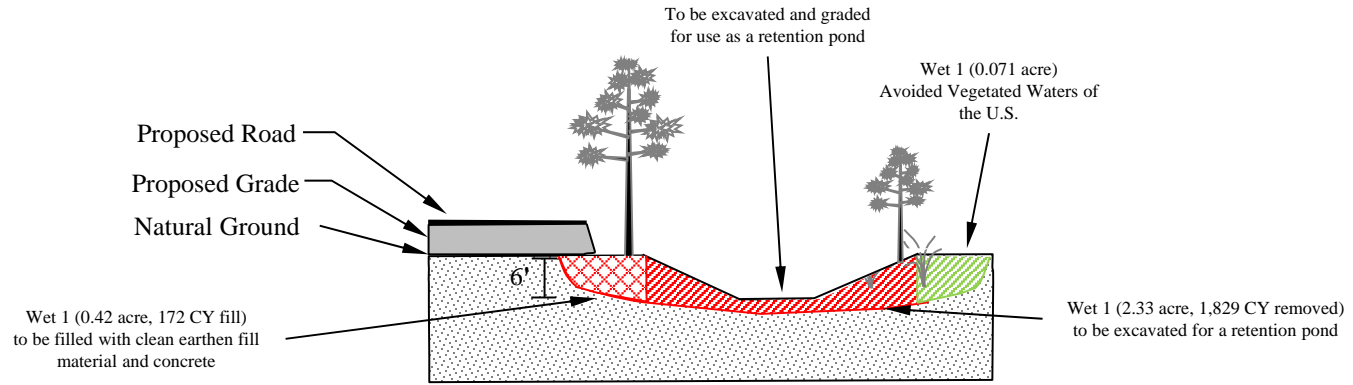
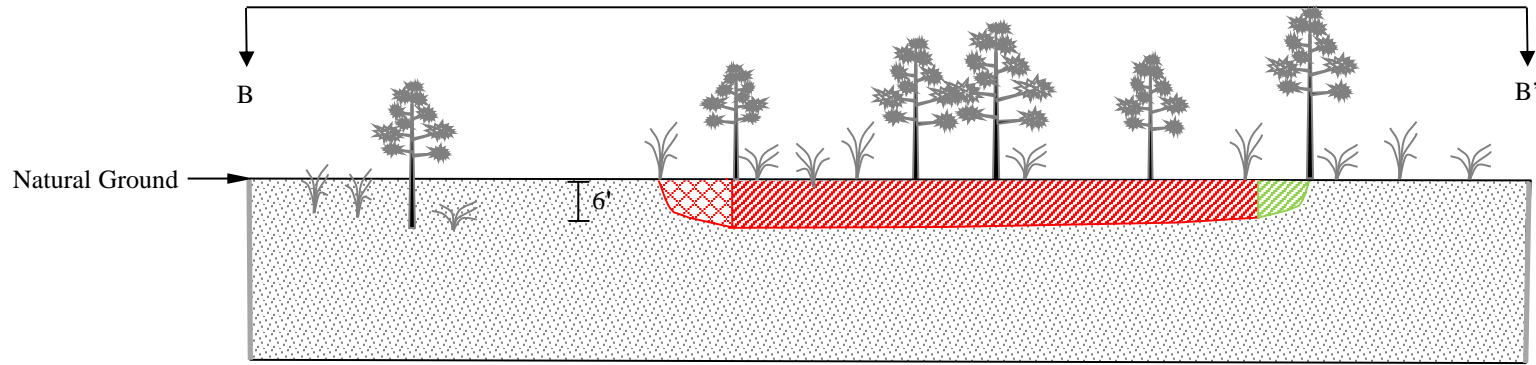





ILLUSTRATION NOT TO SCALE

Prepared by:  Date: 5/13/2022	CROSS-SECTION VIEW OF B - B' WET 1 Fort Bend County West Sycamore Road Expansion	Prepared for: Fort Bend County Engineering	
		Project No: 2346.02	Drawn By: JG

Page 8 of 14

CROSS-SECTION VIEW C - C'

LEGEND	
	Project Boundary
	Impacted Waters of the U.S. 0.12 acre (99 CY removed) - Wet 2
	Existing Uplands

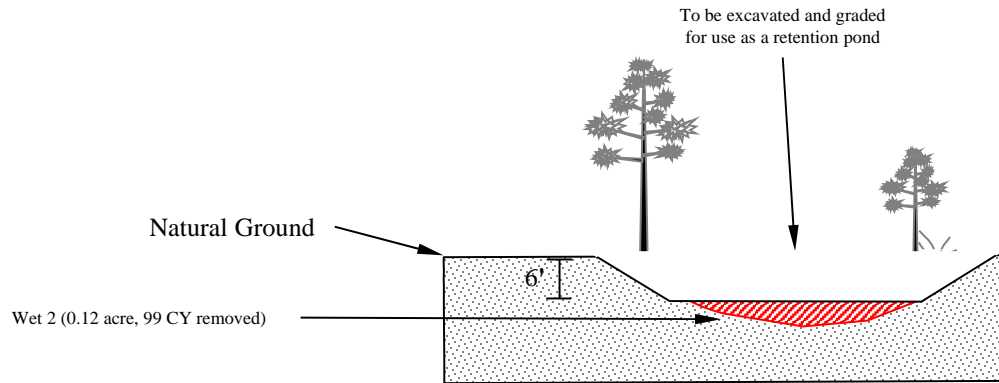
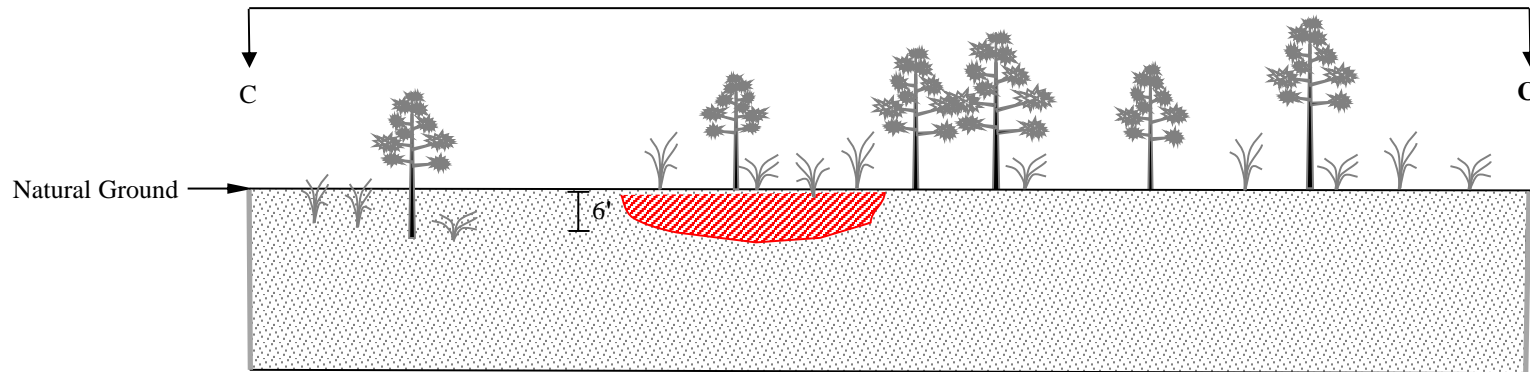



ILLUSTRATION NOT TO SCALE

Prepared by:  Date: 5/13/2022	CROSS-SECTION VIEW OF C - C' WET 2 Fort Bend County West Sycamore Road Expansion	Prepared for: Fort Bend County Engineering		
		Project No: 2346.02	Drawn By: JG	File: Permit Drawings

Page 9 of 14

DETAIL KEY

- Survey Boundary
- Planned Retention Pond
- Pavement Limits

DETAIL PLAN VIEW of CROSS-SECTIONS D & E

LEGEND

- Impacted Waters of the U.S. 0.60 acres (481 CY)
- Avoided Waters of the U.S. 0.60 acres
- Typical Road

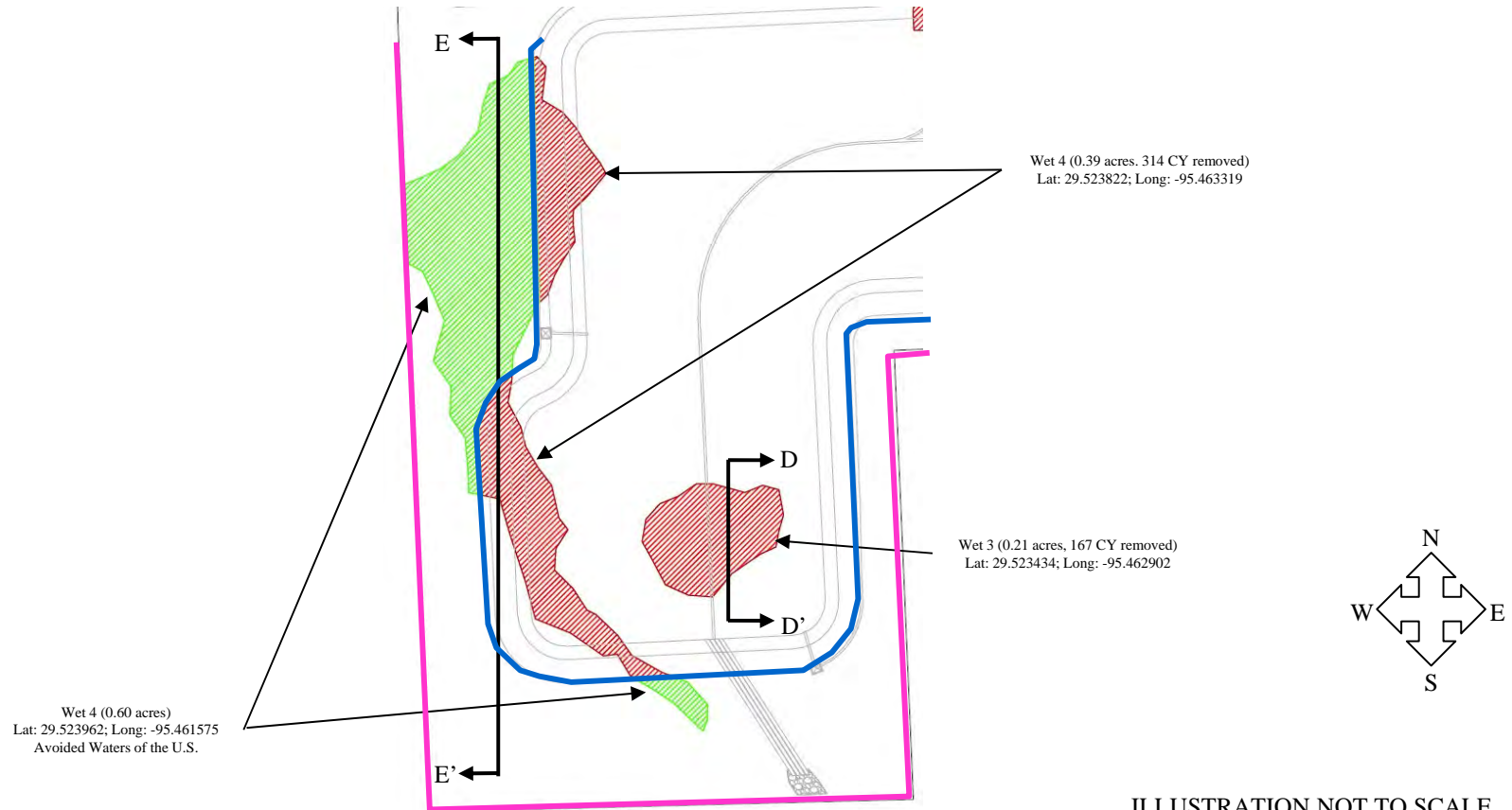

ILLUSTRATION NOT TO SCALE

Prepared by:



Date: 5/13/2022

OVERALL PLAN VIEW OF D-D' to E-E'

Fort Bend County West Sycamore Road Expansion

Prepared for:

Fort Bend County Engineering



Project No: 2346.02

Drawn By: JG

File: Permit Drawings

Page 10 of 14

CROSS-SECTION VIEW D – D'

LEGEND	
	Project Boundary
	Impacted Waters of the U.S. 0.21 acre (167 CY removed) – Wet 3
	Existing Uplands

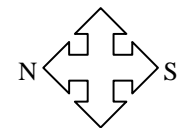
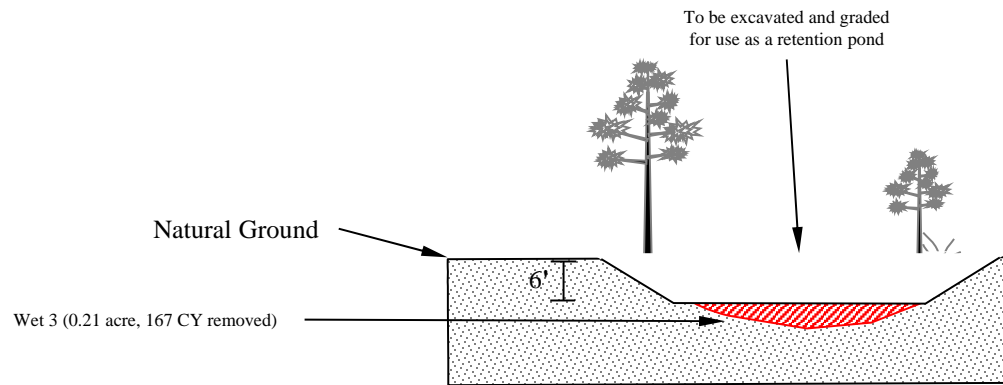
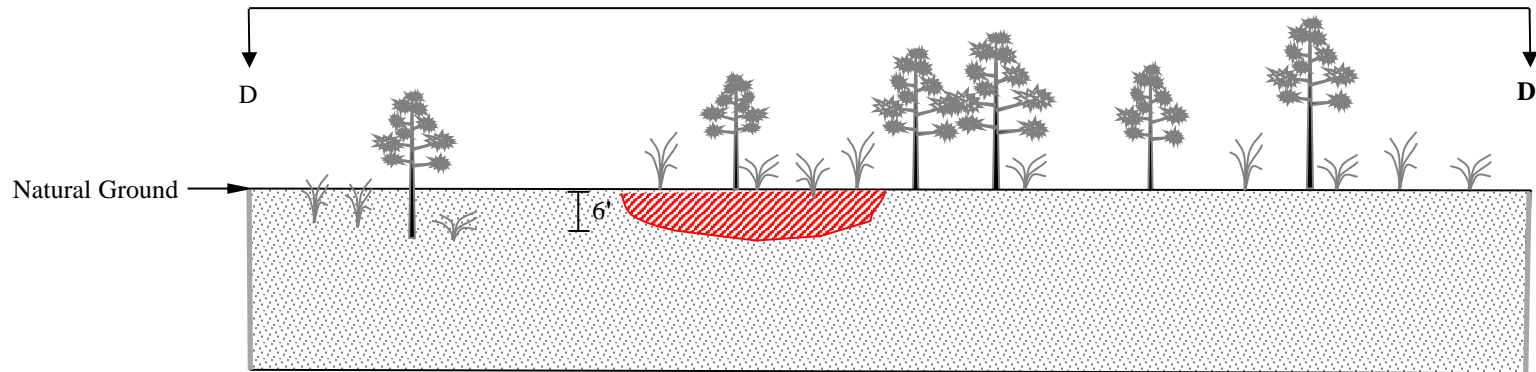







ILLUSTRATION NOT TO SCALE

<p>Prepared by:</p>  <p>Date: 5/13/2022</p>	<p>CROSS-SECTION VIEW OF D - D' WET 3 Fort Bend County West Sycamore Road Expansion</p>	<p>Prepared for:</p> <p style="text-align: center;">Fort Bend County Engineering</p> <table border="1" style="width: 100%;"> <tr> <td data-bbox="1159 1455 1423 1487">Project No: 2346.02</td> <td data-bbox="1423 1455 1654 1487">Drawn By: JG</td> <td data-bbox="1654 1455 1948 1487">File: Permit Drawings</td> </tr> </table>		Project No: 2346.02	Drawn By: JG	File: Permit Drawings
Project No: 2346.02	Drawn By: JG	File: Permit Drawings				

Page 11 of 14

CROSS-SECTION VIEW E - E'

LEGEND	
	Project Boundary
	Impacted Waters of the U.S. 0.39 acre (314 CY removed) – Wet 4
	Avoided Vegetated Waters of the U.S. 0.59 acre – Wet 4
	Existing Uplands

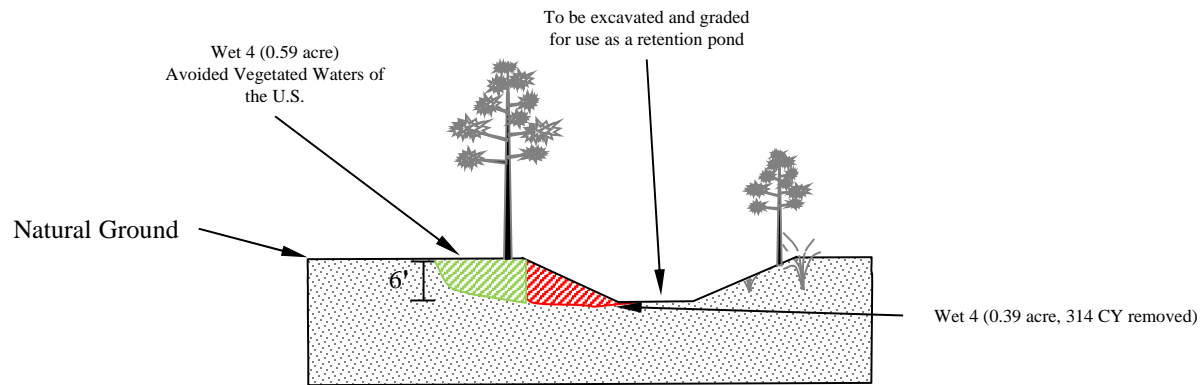
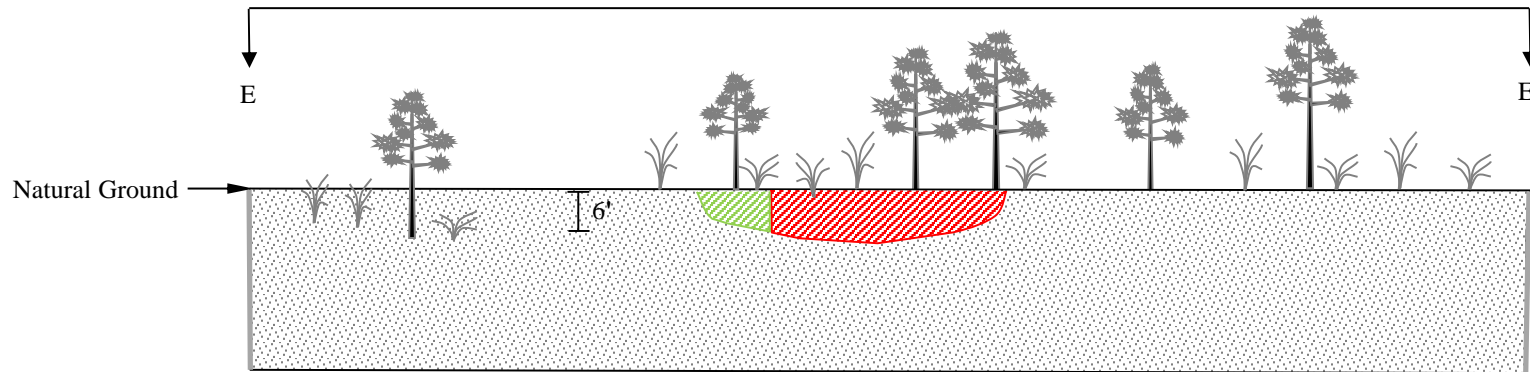







ILLUSTRATION NOT TO SCALE

<p>Prepared by:</p>  <p>Date: 5/13/2022</p>	<p>CROSS-SECTION VIEW OF E - E'</p> <p>WET 4</p> <p>Fort Bend County</p> <p>West Sycamore Road Expansion</p>	<p>Prepared for:</p> <p style="text-align: center;">Fort Bend County Engineering</p> <table border="1" style="width: 100%;"> <tr> <td data-bbox="1159 1453 1423 1490">Project No: 2346.02</td> <td data-bbox="1423 1453 1654 1490">Drawn By: JG</td> <td colspan="2" data-bbox="1654 1453 1948 1490">File: Permit Drawings</td> </tr> </table>			Project No: 2346.02	Drawn By: JG	File: Permit Drawings	
Project No: 2346.02	Drawn By: JG	File: Permit Drawings						

Page 12 of 14

PROFILE VIEW E1 – E1'

LEGEND	
	Project Boundary
	Impacted Waters of the U.S. 0.39 acre (314 CY removed) – Wet 4
	Avoided Vegetated Waters of the U.S. 0.59 acre – Wet 4
	Existing Uplands

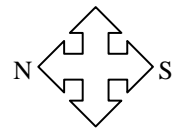
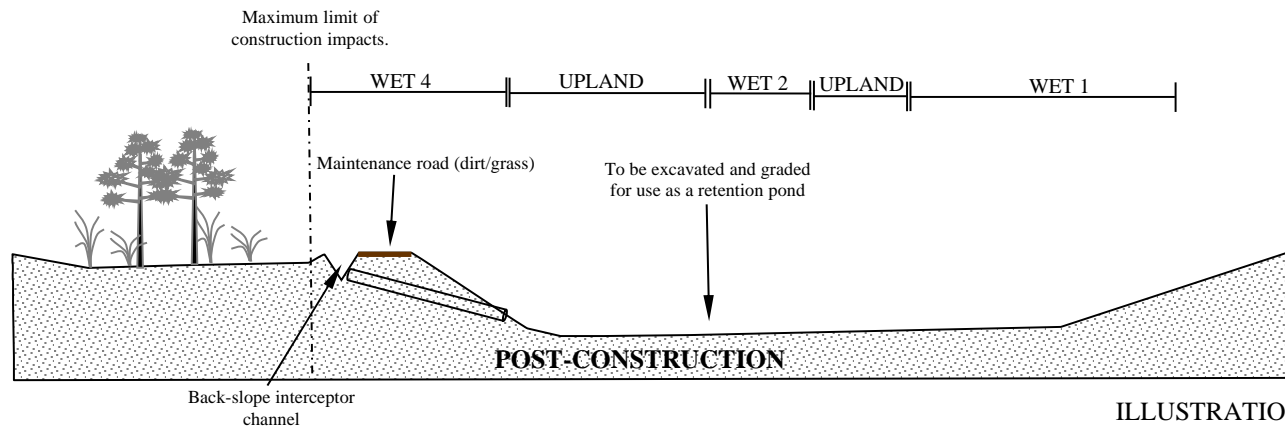
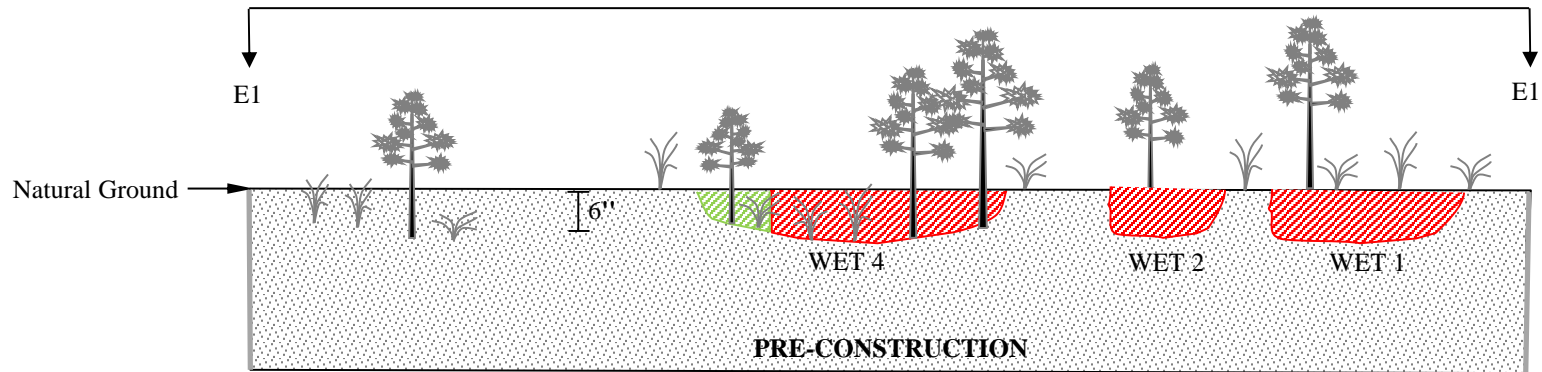

ILLUSTRATION NOT TO SCALE

<p>Prepared by:</p>  <p>Date: 5/13/2022</p>	<p>PROFILE VIEW OF E1 – E1'</p> <p>Fort Bend County</p> <p>West Sycamore Road Expansion</p>	<p>Prepared for:</p> <p style="text-align: center;">Fort Bend County Engineering</p> <table border="1" style="width: 100%;"> <tr> <td data-bbox="1159 1458 1423 1490">Project No: 2346.02</td> <td data-bbox="1423 1458 1654 1490">Drawn By: JG</td> <td data-bbox="1654 1458 1948 1490">File: Permit Drawings</td> </tr> </table>		Project No: 2346.02	Drawn By: JG	File: Permit Drawings
Project No: 2346.02	Drawn By: JG	File: Permit Drawings				

Page 13 of 14

DETAIL KEY

- Survey Boundary
- Planned Retention Pond
- Pavement Limits

DETAIL PLAN VIEW of CROSS-SECTION F

LEGEND

- Total Impacted Non-Vegetated Waters of the U.S.
0.03 acres
- Proposed Road Features

Trib 1 (0.030 acres)
 Lat: 29.524906; Long: -95.465439
 To be routed through a culvert.

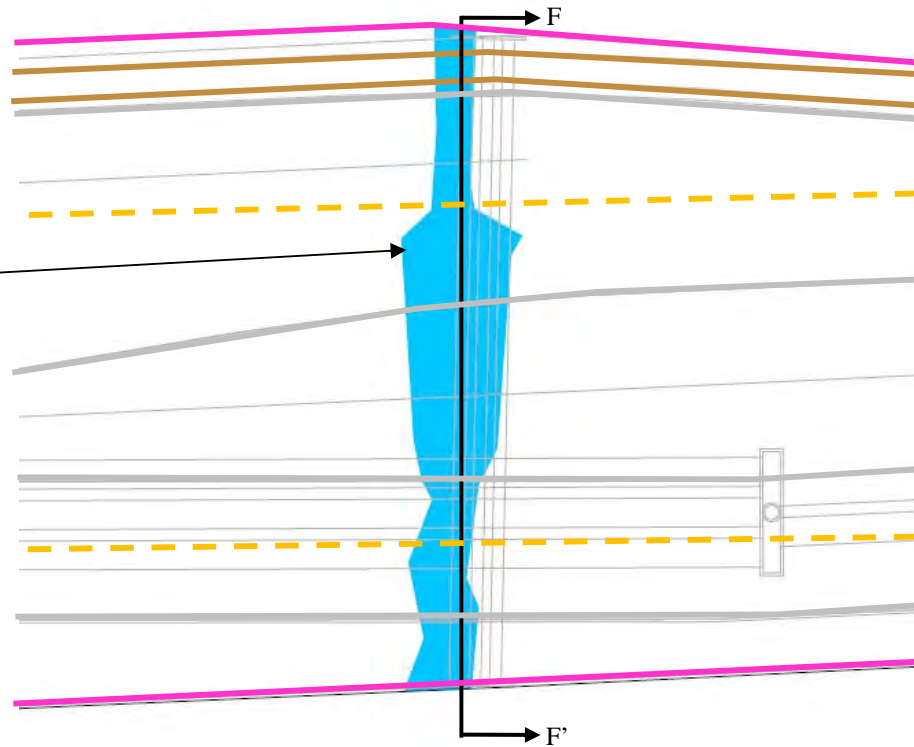

ILLUSTRATION NOT TO SCALE

Prepared by:



Date: 5/13/2022

OVERALL PLAN VIEW OF F-F'

Fort Bend County
West Sycamore Road Expansion

Prepared for:

Fort Bend County Engineering



Project No: 2346.02

Drawn By: JG

File: Permit Drawings

Page 14 of 14

CROSS-SECTION VIEW F – F'

LEGEND	
	Project Boundary
	Total Impacted Non-Vegetated Waters of the U.S. 0.03 acres
	Existing Uplands

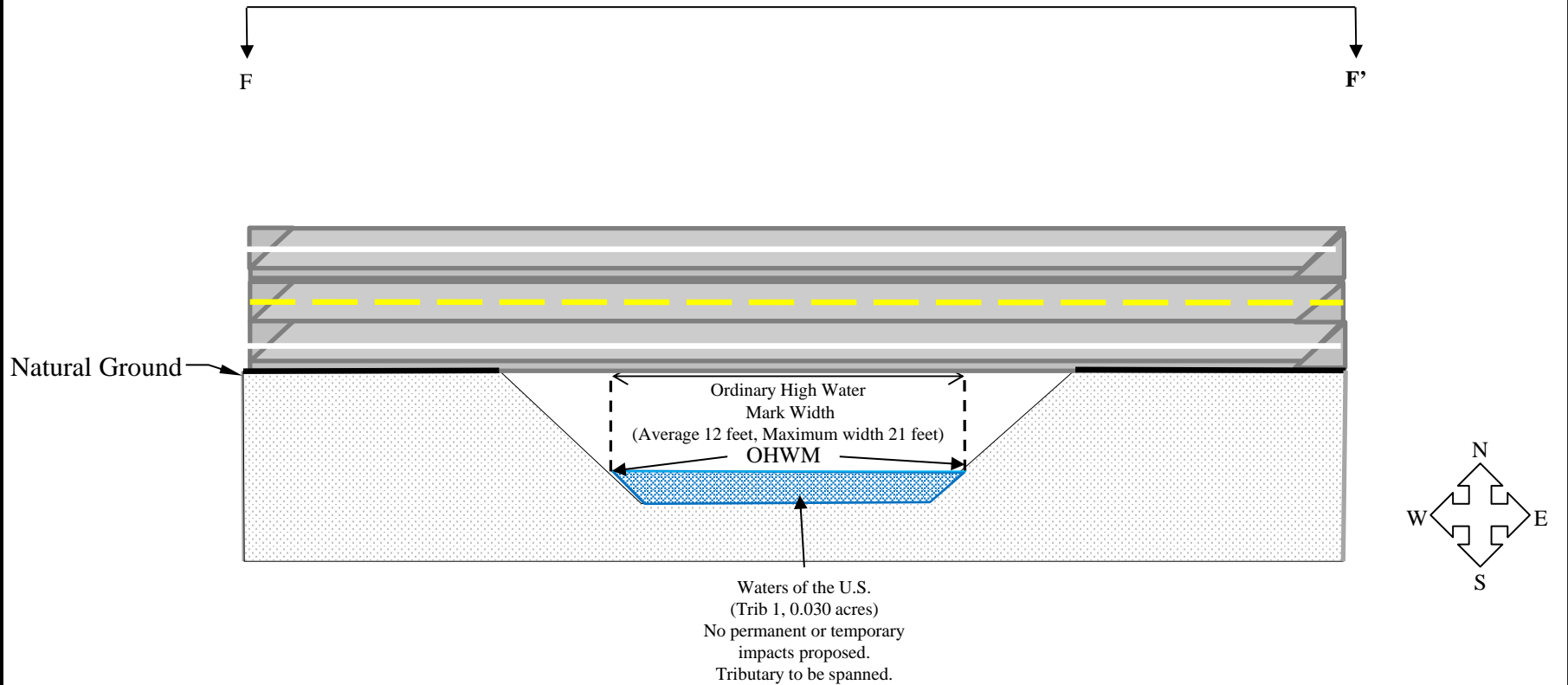



ILLUSTRATION NOT TO SCALE

Prepared by:  Date: 5/13/2022	CROSS-SECTION VIEW OF F - F' TRIB 1 Fort Bend County West Sycamore Road Expansion	Prepared for: Fort Bend County Engineering		
		Project No: 2346.02	Drawn By: JG	File: Permit Drawings