

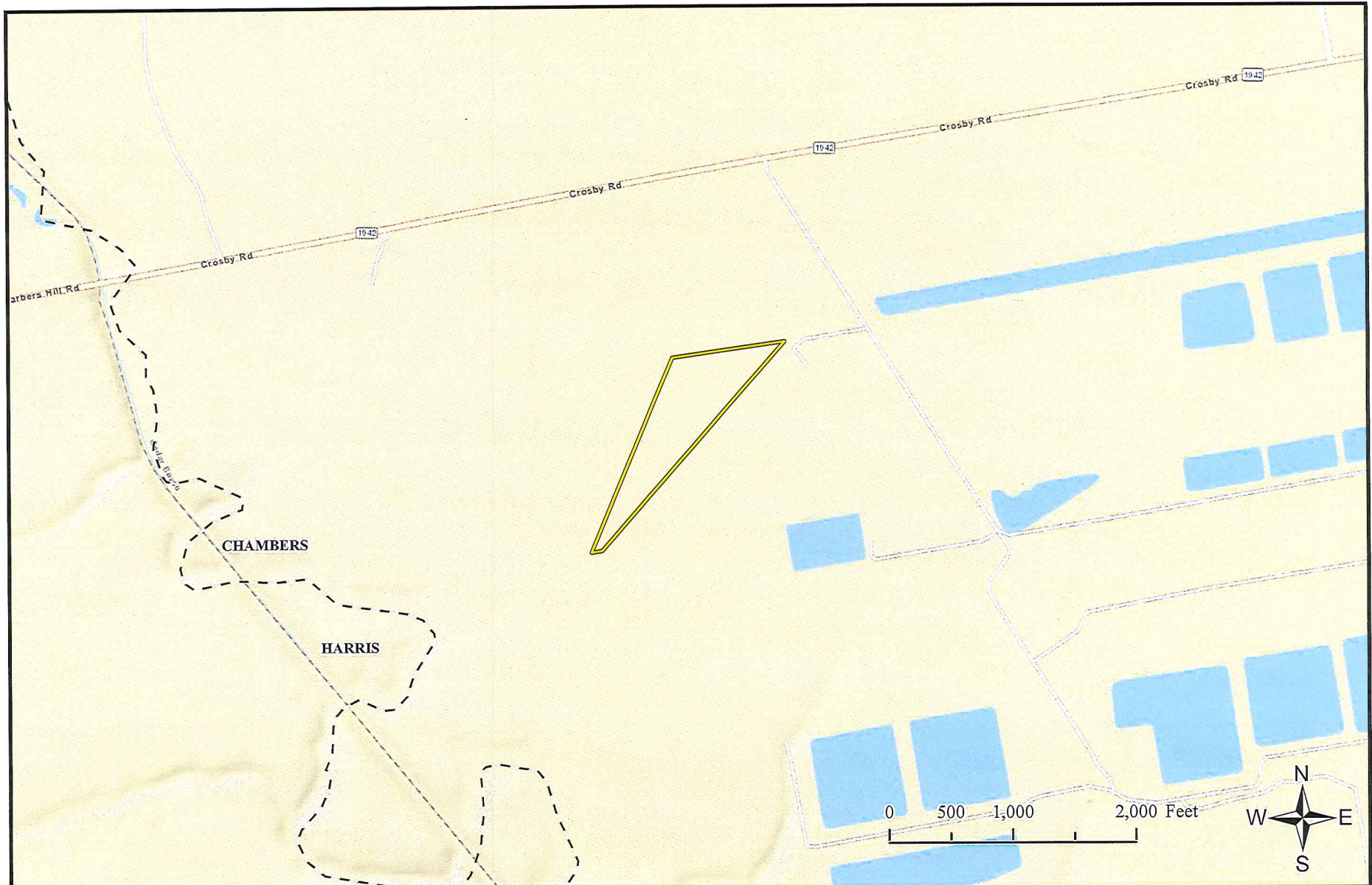



<ul style="list-style-type: none"> Project Location County Boundary 	<ul style="list-style-type: none"> Highway Road Railroad 	<p>Prepared For:</p> <p>Prepared By:</p>	<p>Figure 1. Vicinity Map FRAC VII Project Chambers County, Texas</p>									
<p>Projection: NAD 1983 UTM Zone 15N Source: ESRI World Street Map</p>		<table border="1" style="width: 100%; border-collapse: collapse;"> <tr> <td style="width: 25%;">Project No.: 2214</td> <td style="width: 25%;">Drawn by: AN</td> <td style="width: 25%;">Date Drawn: 6/11/2018</td> <td style="width: 25%;">Scale: 1 inch = 5 miles</td> </tr> <tr> <td colspan="4">File: Q:\...2214 ETC - FRAC VI & FRAC VII...Fig_1_0_Vicinity_Map.mxd</td> </tr> </table>			Project No.: 2214	Drawn by: AN	Date Drawn: 6/11/2018	Scale: 1 inch = 5 miles	File: Q:\...2214 ETC - FRAC VI & FRAC VII...Fig_1_0_Vicinity_Map.mxd			
Project No.: 2214	Drawn by: AN	Date Drawn: 6/11/2018	Scale: 1 inch = 5 miles									
File: Q:\...2214 ETC - FRAC VI & FRAC VII...Fig_1_0_Vicinity_Map.mxd												



 Project Boundary (16.86 ac)  County Boundary
 Road

Prepared For: 
 Prepared By: 

Figure 2. Location Map
FRAC VII Project
Chambers County, Texas

Project No.: 2214	Drawn by: AN	Date Drawn: 6/11/2018	Scale: 1 inch = 1,100 feet
File: Q:\...2214 ETC - FRAC VI & FRAC VII...Fig_2_0_Location_Map.mxd			

Projection: NAD 1983 UTM Zone 15N Source: ESRI World Street Map

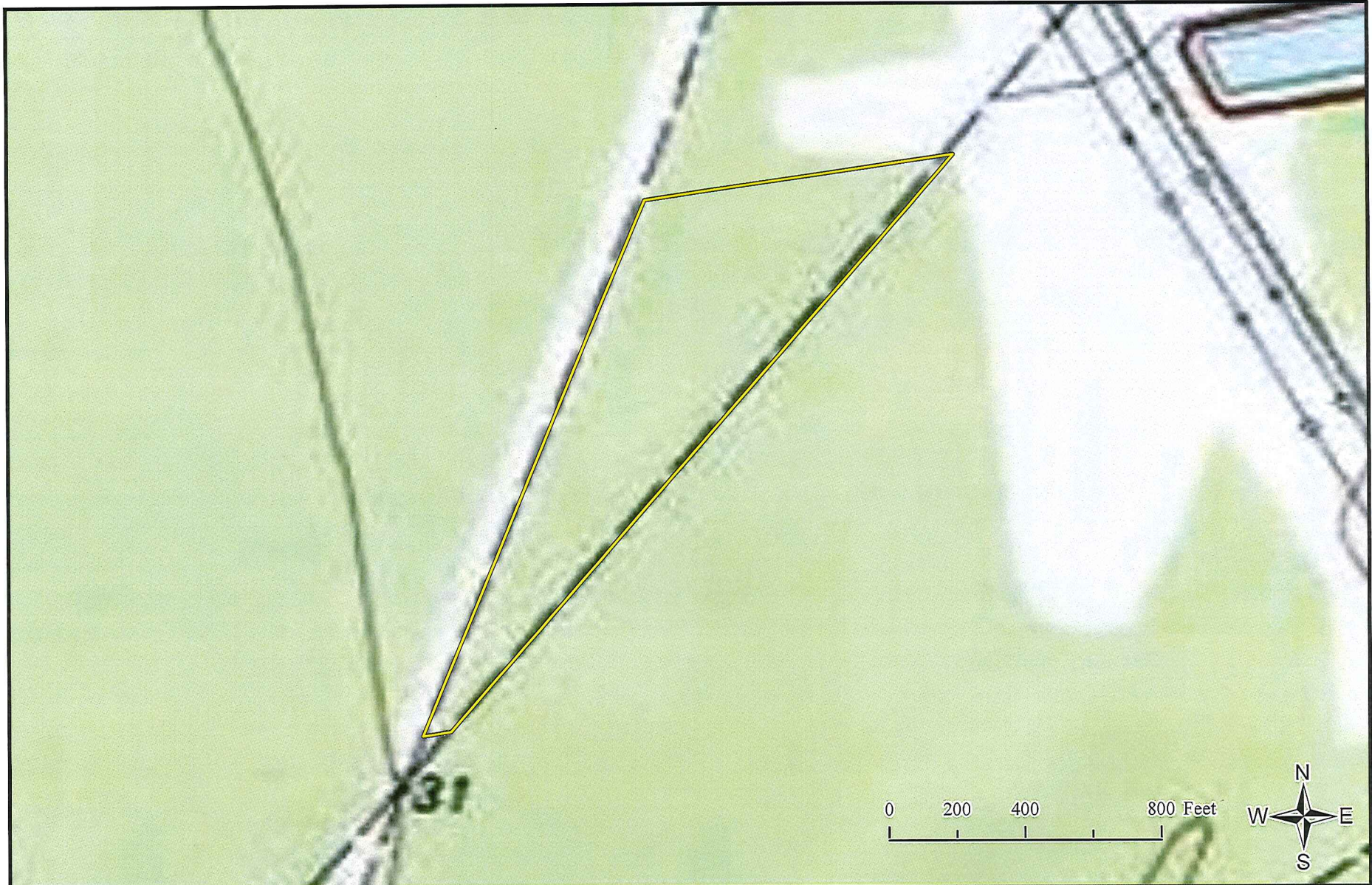

 Project Boundary



Prepared For:

Prepared By:

Figure 3. Topographic Map
FRAC VII Project
Chambers County, Texas

Project No.: 2214	Drawn by: AN	Date Drawn: 6/11/2018	Scale: 1 inch = 400 feet
File: Q:\...2214 ETC - FRAC VI & FRAC VII...Fig_3_0_Topo_Map.mxd			

Projection: NAD 1983 UTM Zone 15N Source: USGS Topo



3 2018

AUG 8 2018

Page 1 of 6

OVERALL PLAN VIEW

LEGEND

-  Fractionator VII Project Boundary
16.86 acre tract
-  Total Impacted Waters of the U.S.- 16.58 acres
(13,374 CY)

Wet 2 (16.58 acres, 13,374 CY)

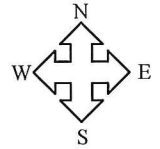
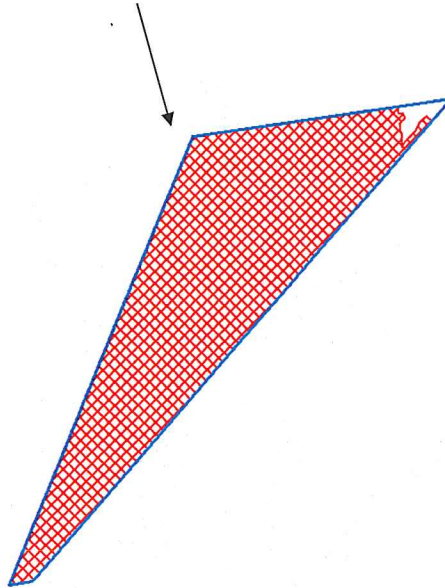

ILLUSTRATION NOT TO SCALE

Prepared by:



Date: 5/01/2017

OVERALL PLAN VIEW OF FRACTIONATOR VII PROJECT

Prepared for:

Lone Star NGL Mont Belvieu, L.P.

Project No: 2214



Drawn By: JWO

File: Permit Drawings

Page 2 of 6

OVERALL PLAN VIEW

LEGEND

-  Fractionator VII – 16.86 acre tract
-  Total Impacted Waters of the U.S.- 16.58 acres (13,374 CY)
-  Proposed Detention Pond

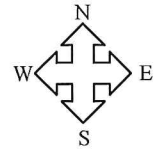
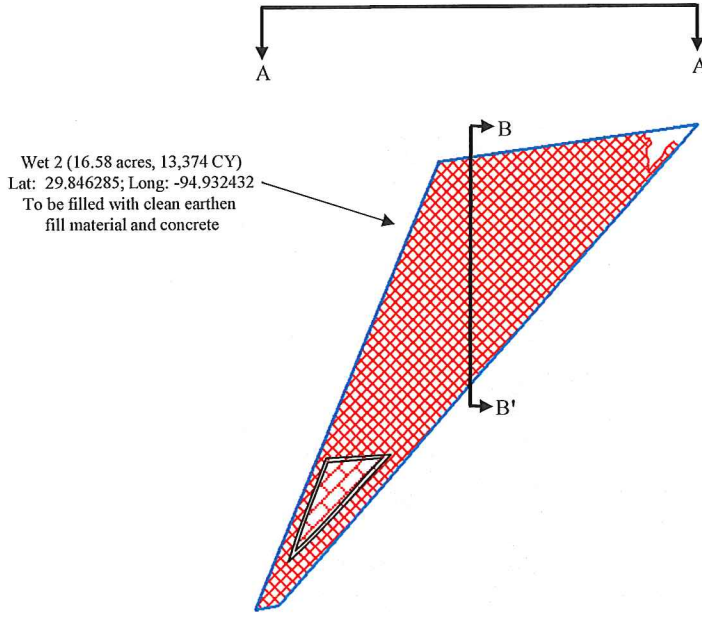





ILLUSTRATION NOT TO SCALE

Prepared by:  Date: 5/01/2017	OVERALL PLAN VIEW OF FRACTIONATOR VII PROJECT A-A' to B-B'	Prepared for: Lone Star NGL Mont Belvieu, L.P.
		<div style="width: 30%;">Project No: 2214</div> <div style="width: 30%;">Drawn By: JWO</div> <div style="width: 30%;">File: Permit Drawings</div>

Page 3 of 6

OVERALL PLAN VIEW

LEGEND

-  Fractionator VII – 49.66 acre tracts
-  Total Impacted Waters of the U.S.- 16.58 acres (13,374 CY)
-  Proposed Detention Pond

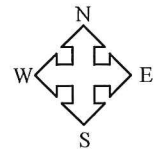
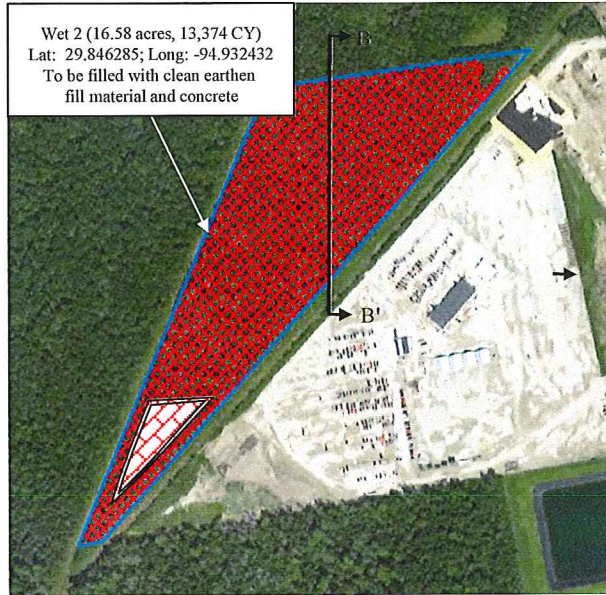

ILLUSTRATION NOT TO SCALE

Prepared by:

Date: 5/01/2017



**OVERALL PLAN VIEW OF
FRACTIONATOR VII PROJECT
A-A' to B-B'**

Prepared for: Lone Star NGL Mont Belvieu, L.P.		
Project No: 2214	Drawn By: JWO	File: Permit Drawings

Page 4 of 6

PROFILE VIEW A – A'

LEGEND

-  Project Boundary
-  Impacted Waters of the U.S.- 16.58 acres (13,374 CY)
-  Existing Uplands

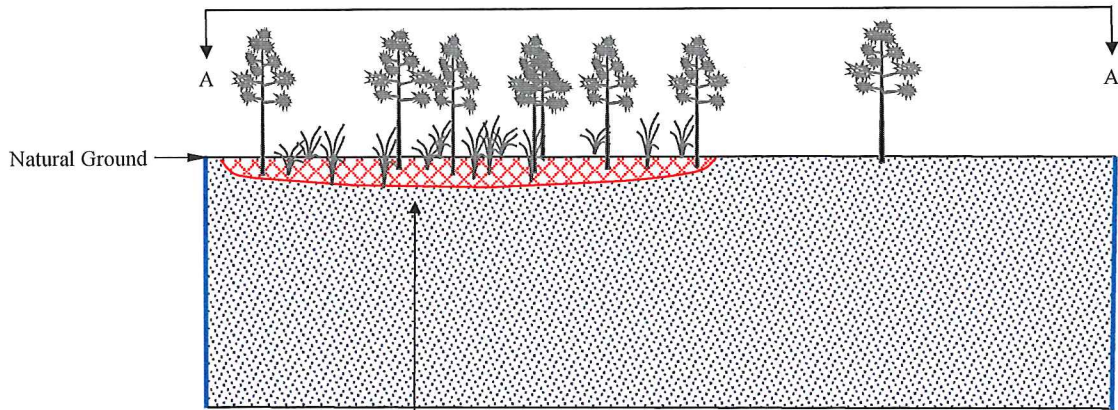

Wet 2 (16.58 acres, 13,374 CY)
Lat: 29.846285; Long: -94.932432
To be filled with clean earthen
fill material and concrete

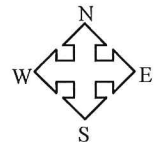

ILLUSTRATION NOT TO SCALE

Prepared by:

Date: 5/01/2017

**OVERALL PROFILE VIEW
A – A' OF
FRACTIONATOR VII PROJECT**

Prepared for:
Lone Star NGL Mont Belvieu, L.P.



Project No: 2214

Drawn By: JWO

File: Permit Drawings

Page 5 of 6

EXISTING CROSS-SECTION VIEW B – B'

LEGEND	
	Project Boundary
	Impacted Waters of the U.S. 16.58 acres (13,374 CY) – Wet 2
	Existing Uplands

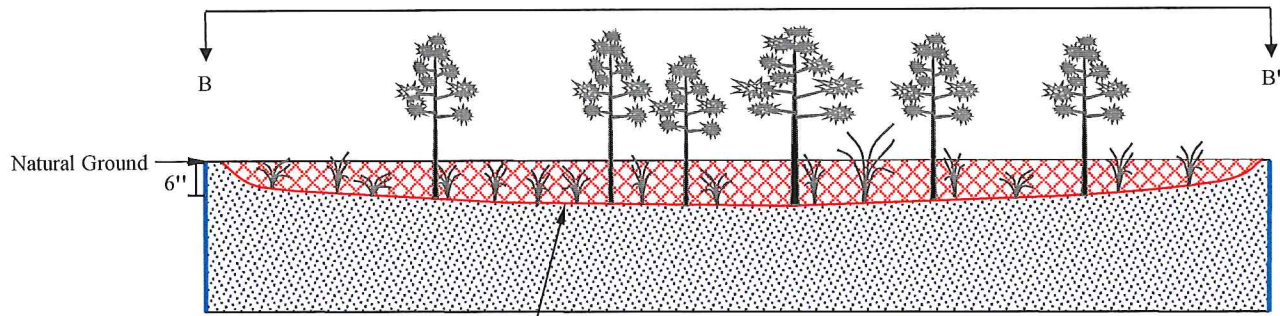



Wet 2 (16.58 acres, 13,374 CY)
Lat: 29.846285; Long: -94.932432
to be filled with clean earthen fill material and concrete

ILLUSTRATION NOT TO SCALE

Prepared by:  Date: 5/01/2017	CROSS-SECTION VIEW B – B' OF FRACTIONATOR VII PROJECT WET 2	Prepared for: Lone Star NGL Mont Belvieu, L.P.		
		Project No: 2214	Drawn By: JWO	File: Permit Drawings

Page 6 of 6

PROPOSED CROSS-SECTION VIEW B – B'

LEGEND	
	Project Boundary
	Impacted Waters of the U.S. 16.58 acres (13,374 CY) – Wet 2
	Existing Uplands

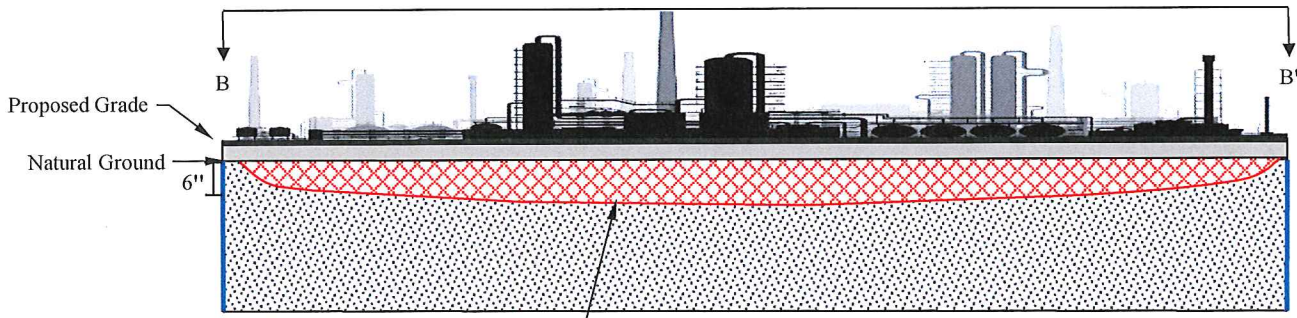

Wet 2 (16.58 acres, 13,374 CY)
Lat: 29.846285; Long: -94.932432
to be filled with clean earthen fill material and concrete

ILLUSTRATION NOT TO SCALE

Prepared by:  Date: 5/01/2017	CROSS-SECTION VIEW B – B' OF FRACTIONATOR VII PROJECT WET 2	Prepared for: Lone Star NGL Mont Belvieu, L.P.		
		Project No: 2214	Drawn By: JWO	File: Permit Drawings