

★ Project Location
 County Boundary
 Highway
 Road
 Railroad

Projection: NAD 1983 UTM Zone 15N

Prepared For:



Prepared By:



Source: ESRI World Street Map

Figure 1. Vicinity Map
FRAC VI Project
Chambers County, Texas

Project No.: 2214	Drawn by: AN	Date Drawn: 6/11/2018	Scale: 1 inch = 5 miles
File: Q:\...\2214 ETC - FRAC VI & FRAC VII...\Fig_1_0_Vicinity_Map.mxd			

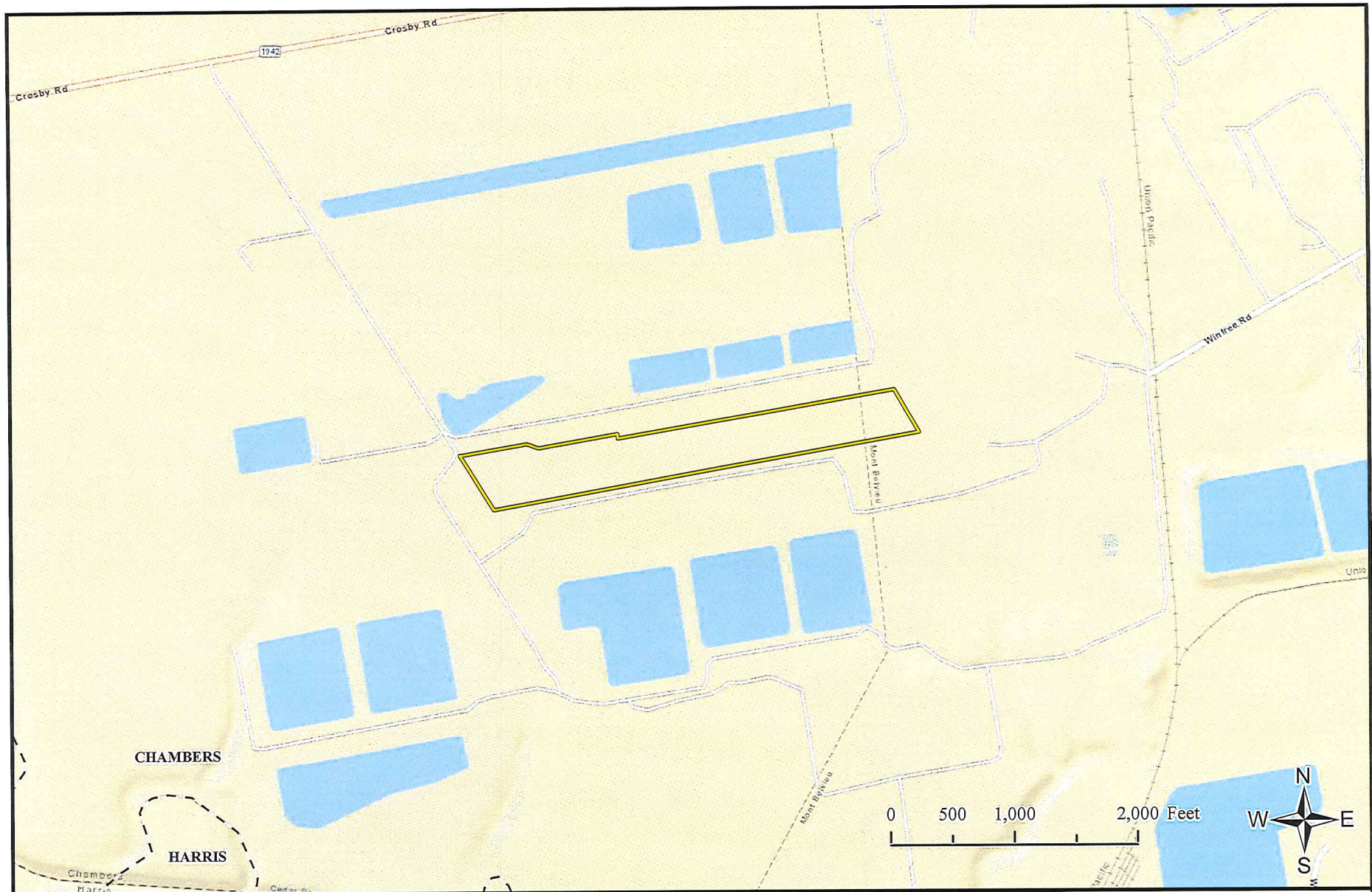

Project Boundary (32.80 ac)
 - - County Boundary
 Road

Prepared For: 
 Prepared By: 

Figure 2. Location Map
FRAC VI Project
Chambers County, Texas

Project No.: 2214	Drawn by: AN	Date Drawn: 6/11/2018	Scale: 1 inch = 1,100 feet
File: Q:\...2214 ETC - FRAC VI & FRAC VII...Fig_2_0_Location_Map.mxd			

Projection: NAD 1983 UTM Zone 15N Source: ESRI World Street Map

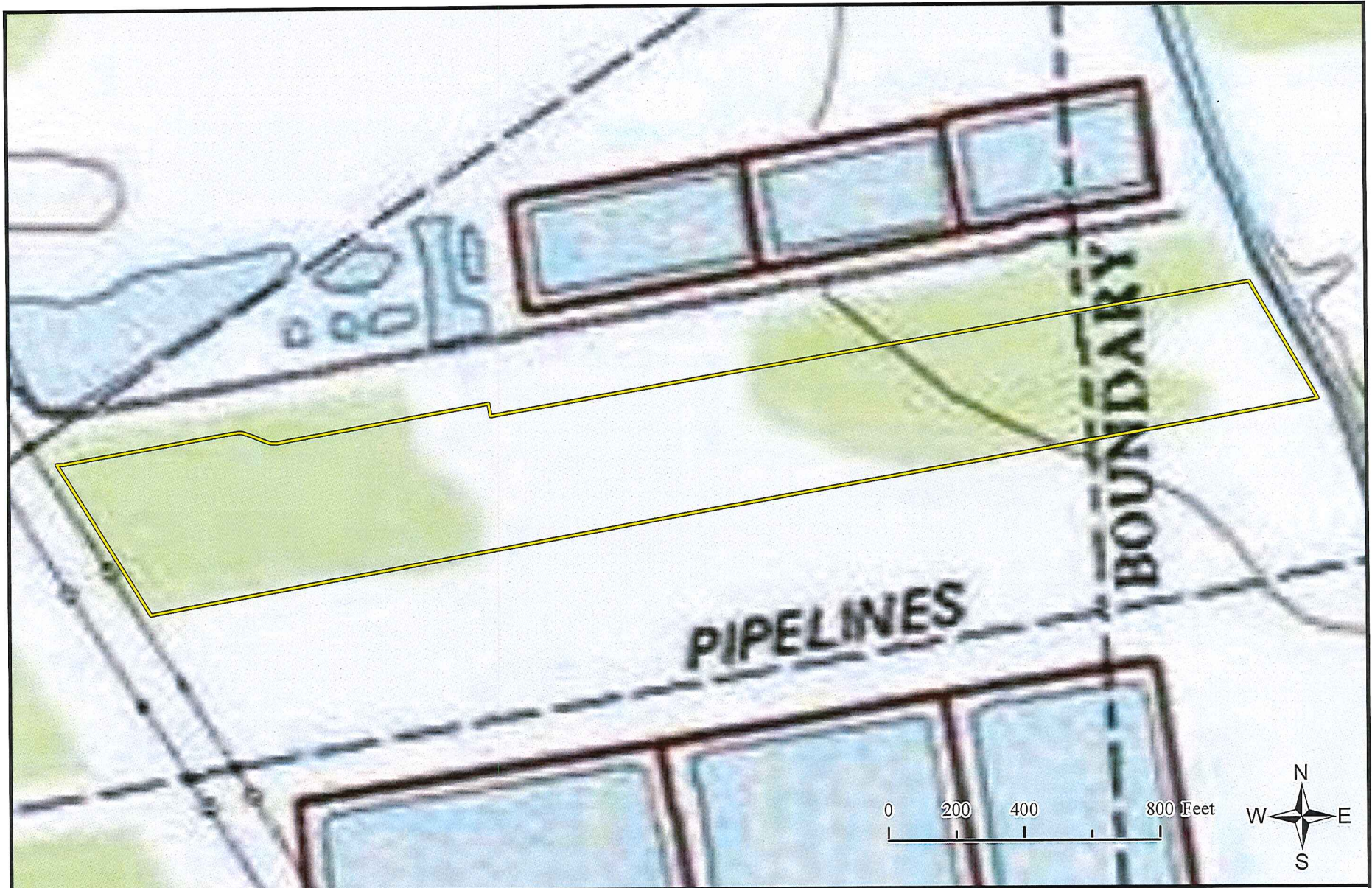

 Project Boundary

Prepared For: 
Prepared By: 

Figure 3. Topographic Map

FRAC VI Project
Chambers County, Texas

Project No.: 2214	Drawn by: AN	Date Drawn: 6/11/2018	Scale: 1 inch = 400 feet
File: Q:\...2214 ETC - FRAC VI & FRAC VIII...Fig_3_0_Topo_Map.mxd			

Projection: NAD 1983 UTM Zone 15N Source: USGS Topo

Page 1 of 12

OVERALL PLAN VIEW

LEGEND

- Fractionator VI Project Boundary
32.80 acre tract
- Total Impacted Waters of the U.S. - 9.02 acres
(7,277 CY)

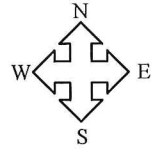
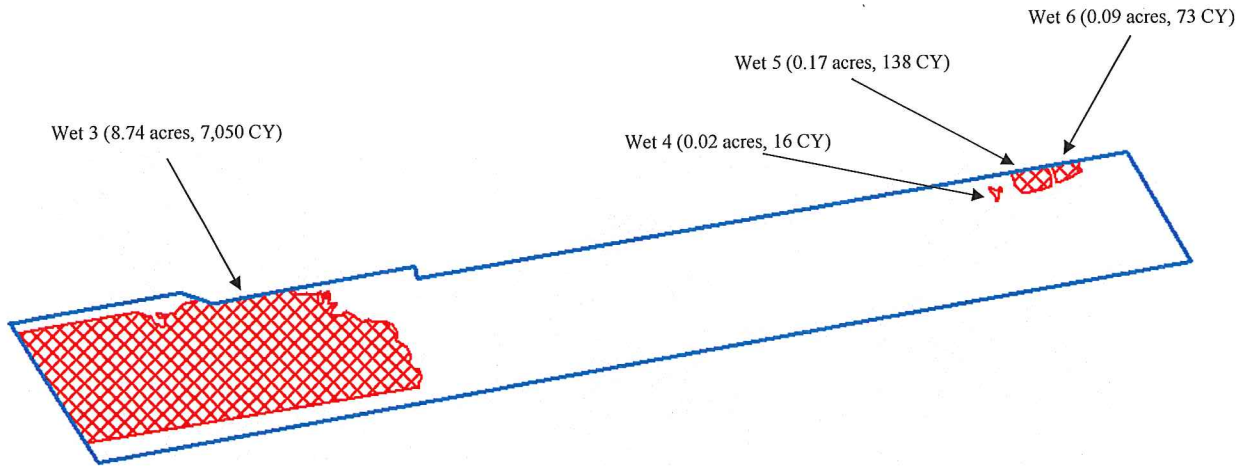

ILLUSTRATION NOT TO SCALE

Prepared by: Date: 5/01/2017	OVERALL PLAN VIEW OF FRACTIONATOR VI PROJECT	Prepared for: Lone Star NGL Mont Belvieu, L.P.
		<div style="width: 30%;">Project No: 2214</div> <div style="width: 30%;">Drawn By: JWO</div> <div style="width: 30%;">File: Permit Drawings</div>

Page 2 of 12

OVERALL PLAN VIEW

LEGEND

- Fractionator VI – 32.80 acre tract
- Impacted Waters of the U.S.- 9.02 acres (7,276 CY)

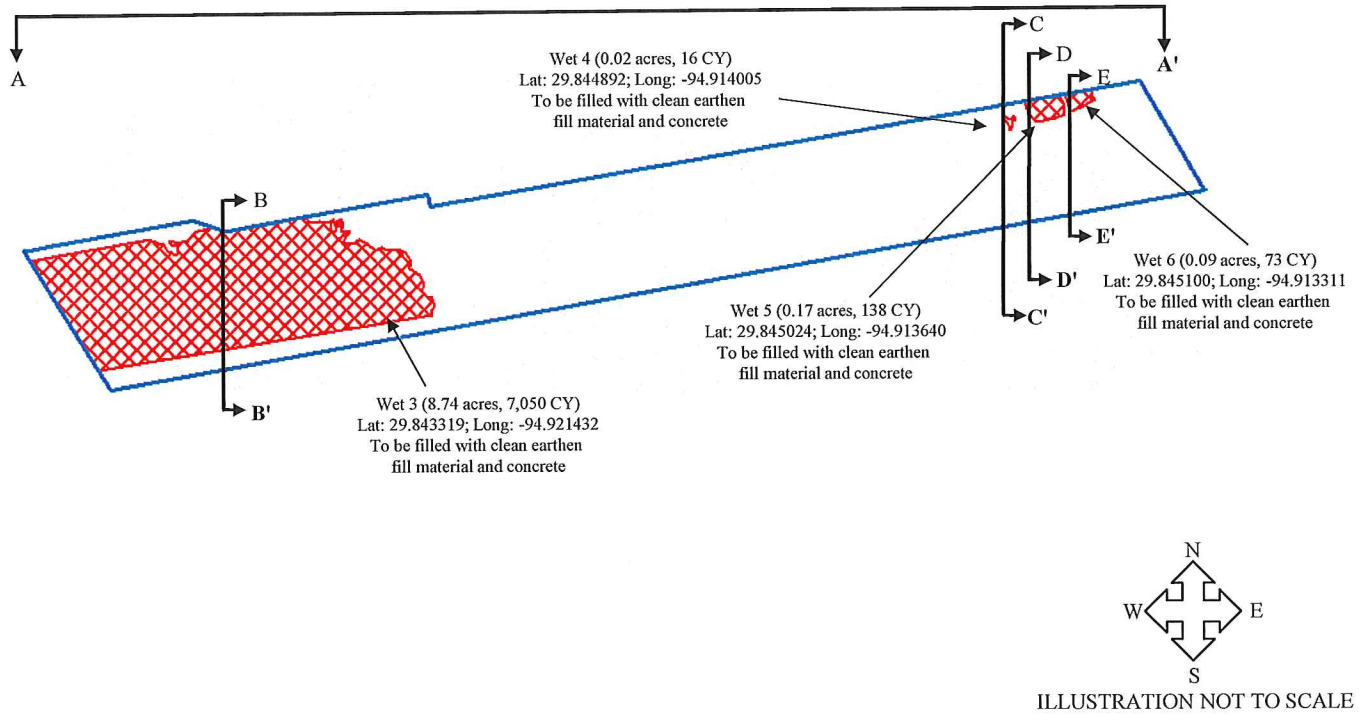



Prepared by: Date: 5/01/2017	OVERALL PLAN VIEW OF FRACTIONATOR VI PROJECT A-A' to E-E'	Prepared for: Lone Star NGL Mont Belvieu, L.P.
		<div style="width: 30%;">Project No: 2214</div> <div style="width: 30%;">Drawn By: JWO</div> <div style="width: 30%;">File: Permit Drawings</div>

Page 3 of 12

OVERALL PLAN VIEW

LEGEND

-  Fractionator VI – 32.80 acre tracts
-  Total Impacted Waters of the U.S.- 9.02 acres (7,276 CY)
-  Approximate Parking Lot

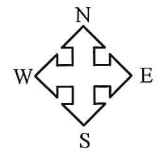
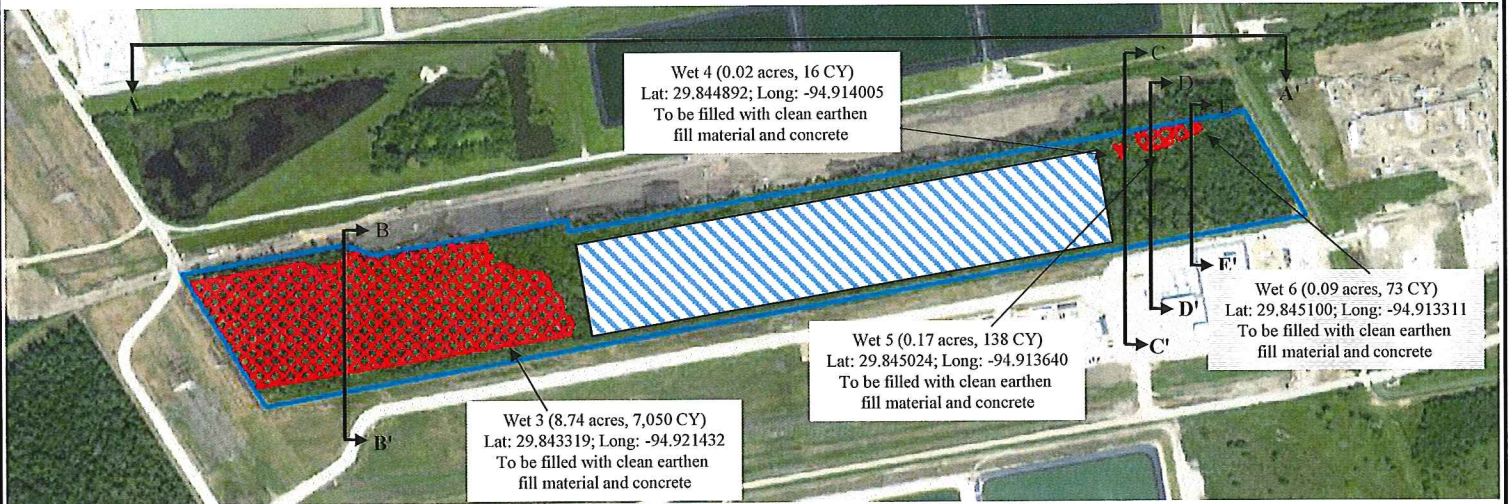





ILLUSTRATION NOT TO SCALE

Prepared by:  Date: 5/01/2017	OVERALL PLAN VIEW OF FRACTIONATOR VI PROJECT A-A' to E-E'	Prepared for: Lone Star NGL Mont Belvieu, L.P. <hr/> Project No: 2214 Drawn By: JWO File: Permit Drawings	
---	--	--	--

Page 4 of 12

EXISTING PROFILE VIEW A – A'

LEGEND	
	Project Boundary
	Impacted Waters of the U.S. 9.02 acres (7,276 CY)
	Existing Uplands

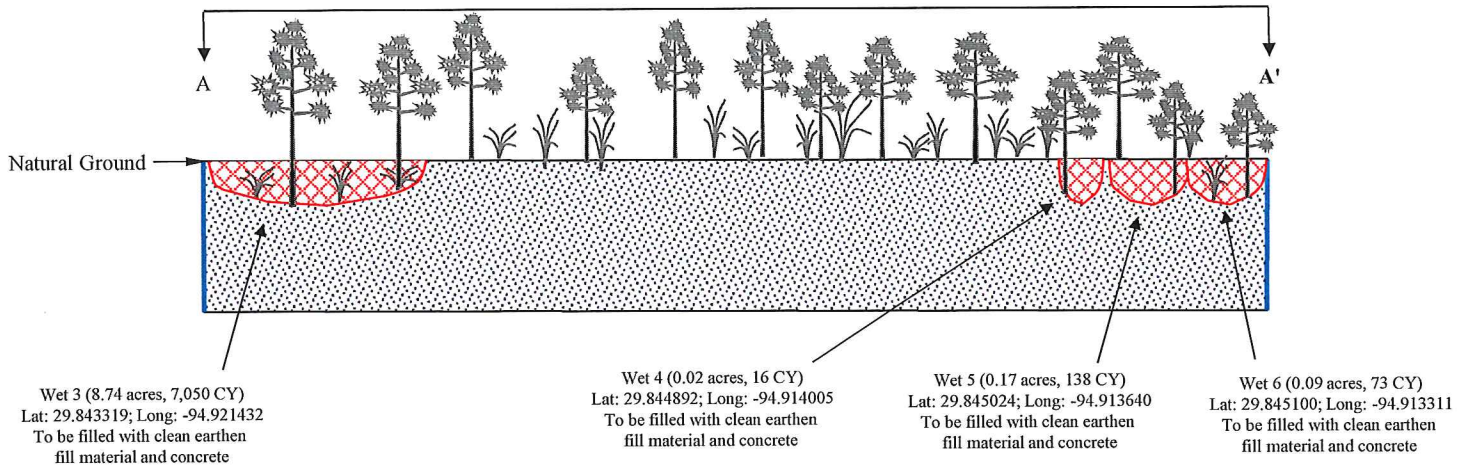





ILLUSTRATION NOT TO SCALE

Prepared by:  Date: 5/01/2017	PROFILE VIEW A – A' OF FRACTIONATOR VI PROJECT	Prepared for: Lone Star NGL Mont Belvieu, L.P.		
		Project No: 2214	Drawn By: JWO	File: Permit Drawings

Page 5 of 12

EXISTING CROSS-SECTION VIEW B – B'

LEGEND	
	Project Boundary
	Impacted Waters of the U.S. 8.74 acres (7,050 CY) – Wet 3
	Existing Uplands

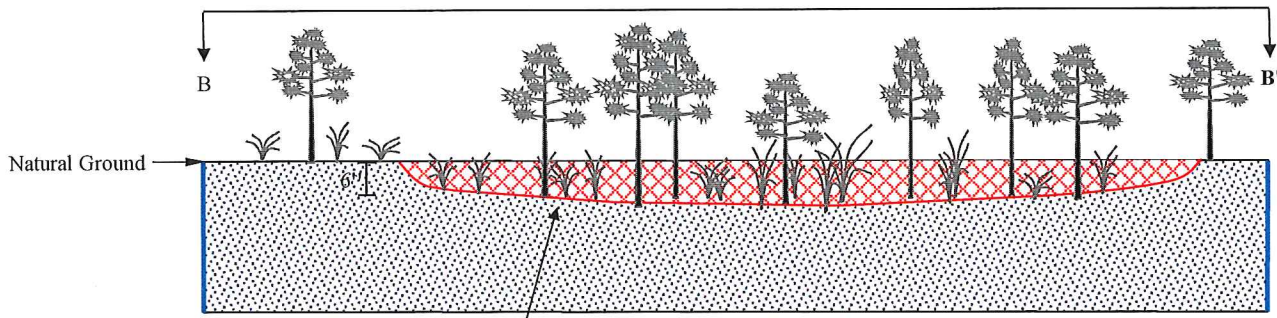



Wet 3 (8.74 acres, 7,050 CY)
Lat: 29.843319; Long: -94.921432
To be filled with clean earthen
fill material and concrete

ILLUSTRATION NOT TO SCALE

Prepared by:  Date: 5/01/2017	CROSS-SECTION VIEW B – B' OF FRACTIONATOR VI PROJECT WET 3	Prepared for: Lone Star NGL Mont Belvieu, L.P.		
		Project No: 2214	Drawn By: JWO	File: Permit Drawings

Page 6 of 12

PROPOSED CROSS-SECTION VIEW B – B'

LEGEND	
	Project Boundary
	Impacted Waters of the U.S. 8.74 acres (7,050 CY) – Wet 3
	Existing Uplands

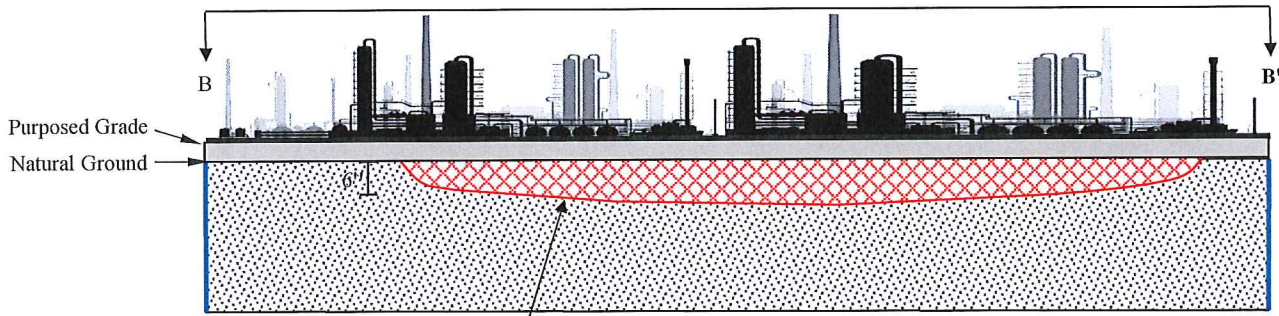



Wet 3 (8.74 acres, 7,050 CY)
Lat: 29.843319; Long: -94.921432
To be filled with clean earthen
fill material and concrete

ILLUSTRATION NOT TO SCALE

Prepared by:  Date: 5/01/2017	CROSS-SECTION VIEW B – B' OF FRACTIONATOR VI PROJECT WET 3	Prepared for: <p style="text-align: center;">Lone Star NGL Mont Belvieu, L.P.</p> <table border="1" style="width: 100%; border-collapse: collapse;"> <tr> <td style="width: 33%;">Project No: 2214</td> <td style="width: 33%;">Drawn By: JWO</td> <td style="width: 33%;">File: Permit Drawings</td> </tr> </table>	Project No: 2214	Drawn By: JWO	File: Permit Drawings
Project No: 2214	Drawn By: JWO	File: Permit Drawings			

Page 7 of 12

EXISTING CROSS-SECTION VIEW C – C'

LEGEND	
	Project Boundary
	Impacted Waters of the U.S. 0.02 acres (16 CY) – Wet 4
	Existing Uplands

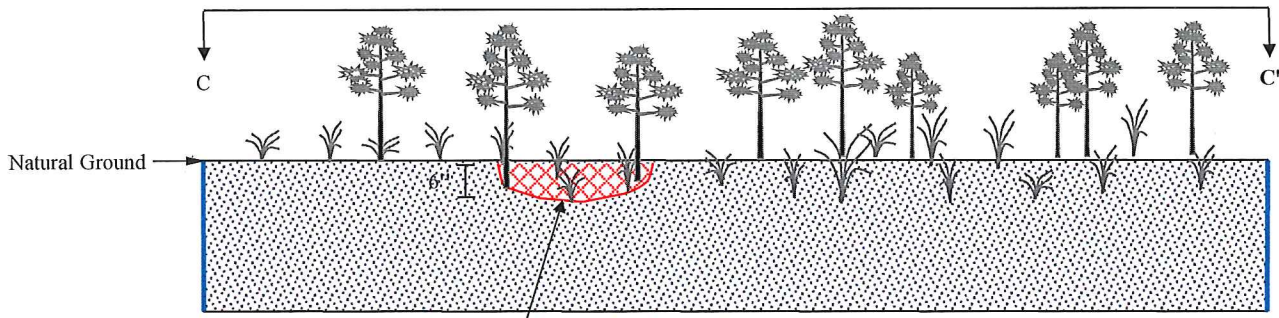



Wet 4 (0.02 acres, 16 CY)
Lat: 29.844892; Long: -94.914005
To be filled with clean earthen
fill material and concrete

ILLUSTRATION NOT TO SCALE

Prepared by:  Date: 5/01/2017	CROSS-SECTION VIEW C – C' OF FRACTIONATOR VI PROJECT WET 4	Prepared for: Lone Star NGL Mont Belvieu, L.P.		
		Project No: 2214	Drawn By: JWO	File: Permit Drawings

Page 8 of 12

PROPOSED CROSS-SECTION VIEW C – C'

LEGEND	
	Project Boundary
	Impacted Waters of the U.S. 0.02 acres (16 CY) – Wet 4
	Existing Uplands

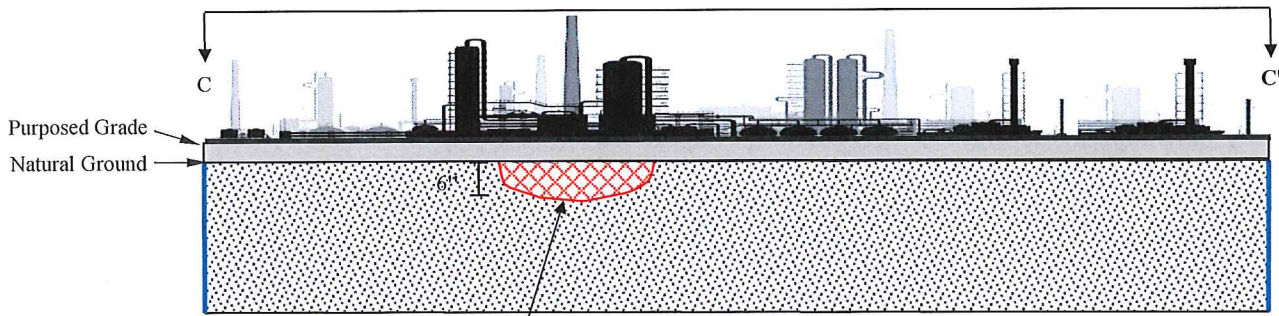



Wet 4 (0.02 acres, 16 CY)
Lat: 29.844892; Long: -94.914005
To be filled with clean earthen
fill material and concrete

ILLUSTRATION NOT TO SCALE

Prepared by:  Date: 5/01/2017	CROSS-SECTION VIEW C – C' OF FRACTIONATOR VI PROJECT WET 4	Prepared for: Lone Star NGL Mont Belvieu, L.P.		
		Project No: 2214	Drawn By: JWO	File: Permit Drawings

Page 9 of 12

EXISTING CROSS-SECTION VIEW D – D'

LEGEND	
	Project Boundary
	Impacted Waters of the U.S. 0.17 acres (138 CY) – Wet 5
	Existing Uplands

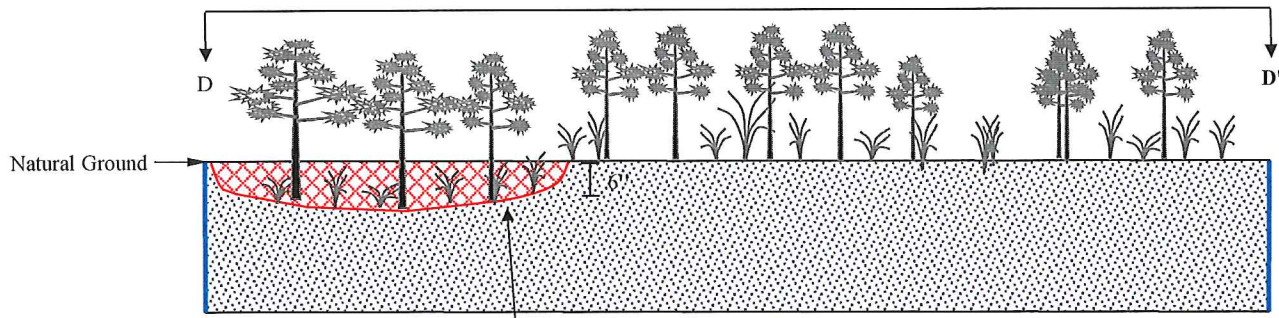



Wet 5 (0.17 acres, 138 CY)
Lat: 29.845024; Long: -94.913640
To be filled with clean earthen
fill material and concrete

ILLUSTRATION NOT TO SCALE

Prepared by:  Date: 5/01/2017	CROSS-SECTION VIEW D – D' OF FRACTIONATOR VI PROJECT WET 5	Prepared for: Lone Star NGL Mont Belvieu, L.P.		
		Project No: 2214	Drawn By: JWO	File: Permit Drawings

Page 10 of 12

PROPOSED CROSS-SECTION VIEW D – D'

LEGEND	
	Project Boundary
	Impacted Waters of the U.S. 0.17 acres (138 CY) – Wet 5
	Existing Uplands

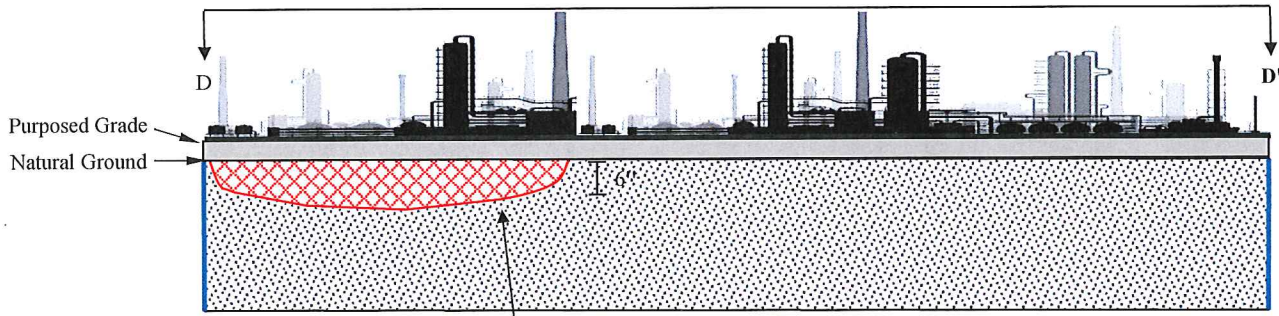



Wet 5 (0.17 acres, 138 CY)
Lat: 29.845024; Long: -94.913640
To be filled with clean earthen
fill material and concrete

ILLUSTRATION NOT TO SCALE

Prepared by:  Date: 5/01/2017	CROSS-SECTION VIEW D – D' OF FRACTIONATOR VI PROJECT WET 5	Prepared for: Lone Star NGL Mont Belvieu, L.P.		
		Project No: 2214	Drawn By: JWO	File: Permit Drawings

Page 11 of 12

EXISTING CROSS-SECTION VIEW E – E'

LEGEND	
	Project Boundary
	Impacted Waters of the U.S. 0.09 acres (73 CY) – Wet 6
	Existing Uplands

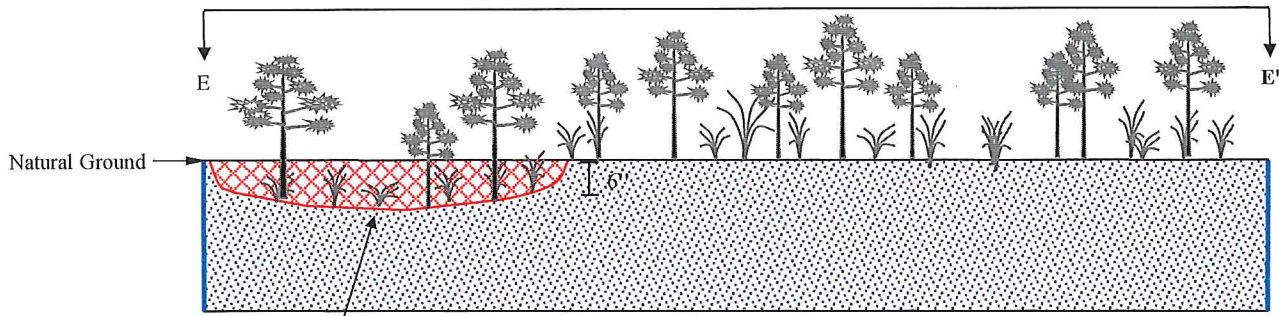



Wet 6 (0.09 acres, 73 CY)
Lat: 29.845100; Long: -94.913311
To be filled with clean earthen
fill material and concrete

ILLUSTRATION NOT TO SCALE

Prepared by:  Date: 5/01/2017	CROSS-SECTION VIEW E – E' OF FRACTIONATOR VI PROJECT WET 6	Prepared for: Lone Star NGL Mont Belvieu, L.P.		
		Project No: 2214	Drawn By: JWO	File: Permit Drawings

Page 12 of 12

PROPOSED CROSS-SECTION VIEW E – E'

LEGEND	
	Project Boundary
	Impacted Waters of the U.S. 0.09 acres (73 CY) – Wet 6
	Existing Uplands

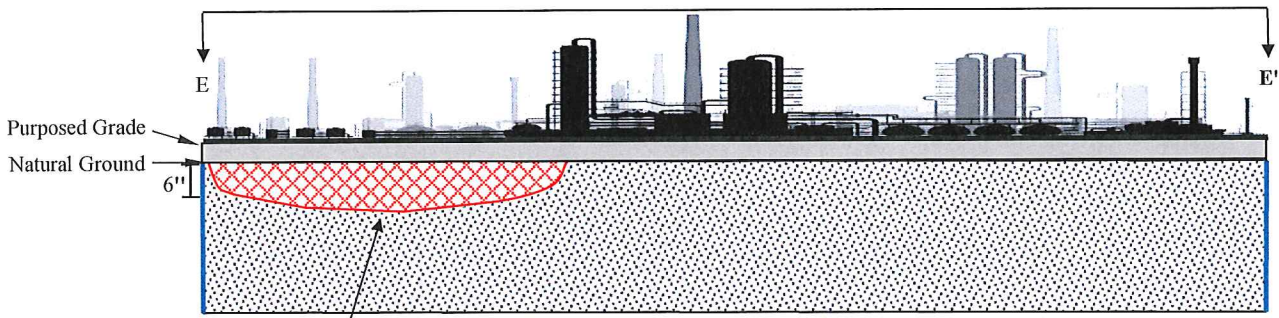

Wet 6 (0.09 acres, 73 CY)
Lat: 29.845100; Long: -94.913311
To be filled with clean earthen
fill material and concrete

ILLUSTRATION NOT TO SCALE

Prepared by:  Date: 5/01/2017	CROSS-SECTION VIEW E – E' OF FRACTIONATOR VI & VII PROJECT WET 6	Prepared for: Lone Star NGL Mont Belvieu, L.P.		
		Project No: 2214	Drawn By: JWO	File: Permit Drawings