









#### WATERBODY IMPACTS

	TEMPORARY IMPACT
	PERMANENT IMPACT
	NO IMPACT

#### SURFACE AREAS

	PROPOSED ROADS
	PROPOSED PONDS
	PROPOSED LAYDOWN AREA

#### IMPACTS AND AVOIDANCE OF AQUATIC RESOURCES BY WATERBODY

WATERBODY#	TOTAL ACREAGE	PERMANENT IMPACTS	TEMPORARY IMPACTS	NO IMPACTS	FILL (CU YARDS)	FIGURE 6-#	WATERBODY TYPE
WET01	0.741	0.313	0.000	0.428	1436.19	5	PEM
WET02	14.325	12.660	0.000	1.665	107097.00	3,5	PEM
WET03	10.431	2.414	0.000	8.017	5351.80	2,3,5	PFO
WET04	0.179	0.179	0.000	0.000	1786.84	5	PFO
WET05	1.505	0.000	0.000	1.505	-	4	PFO
WET06	21.162	20.933	0.000	0.229	142443.61	3,4,5	PFO
WET07	1.375	1.375	0.000	0.000	14305.25	5	PSS
WET08	31.684	13.691	3.077	14.916	64729.01	5,6,7,8	PEM
WET18	0.800	0.000	0.000	0.800	-	13	PFO
WET19	0.559	0.000	0.000	0.559	-	13	PEM
WET20	0.192	0.000	0.000	0.192	-	13	PFO
WET21	0.033	0.000	0.013	0.020	-	7	PEM
WET22	0.364	0.000	0.000	0.364	-	3,13	PFO
WET23	0.063	0.063	0.000	0.000	710.81	5	PEM
WET24	0.075	0.020	0.010	0.045	116.82	7	PEM
DRG02	0.309	0.117	0.000	0.192	1172.67	2,5	DRAINAGE
DRG03	0.446	0.203	0.000	0.243	2086.21	2,5	DRAINAGE
CAN06	1.230	0.046	0.000	1.184	0.004	2,3,4	CANAL
CAN08	0.009	0.005	0.003	0.001	30.41	7	CANAL
CAN13	0.072	0.00	0.000	0.072	-	13	CANAL
OW01	0.290	0.290	0.000	0.000	2863.78	5	OPEN WATER
ST12	0.793	0.000	0.000	0.793	-	13	OPEN WATER

#### SUMMARY OF IMPACTS AND AVOIDANCE OF AQUATIC RESOURCES BY WATERBODY TYPE

WATERBODY TYPE	TOTAL ACREAGE	PERMANENT IMPACTS	TEMPORARY IMPACTS	NO IMPACTS	FILL (CU YARDS)
PEM	47.480	26.747	3.100	17.633	174089.83
PFO	34.633	23.526	0.000	11.107	149582.25
PSS	1.375	1.375	0.000	0.000	14305.25
DRAINAGE	0.755	0.320	0.000	0.435	3258.88
CANAL	1.311	0.051	0.003	1.257	30.41
OPEN WATER	1.083	0.290	0.000	0.793	2863.78

USACE PERMIT SUBMITTAL

LEGEND AND NOTES

FIGURE 6

COUNTY: JEFFERSON  
STATE: TEXAS

PURPOSE: PERMIT APPLICATION  
DATE: 08-13-2024 REV. 1

DATUM:  
H: (NAD 83)  
V: (NAVD 88)

PREPARED: AGP  
REVIEWED: GJ  
APPROVED: DJP

PROJECT NO. A13107.099

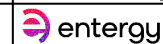



LEGEND POWER STATION

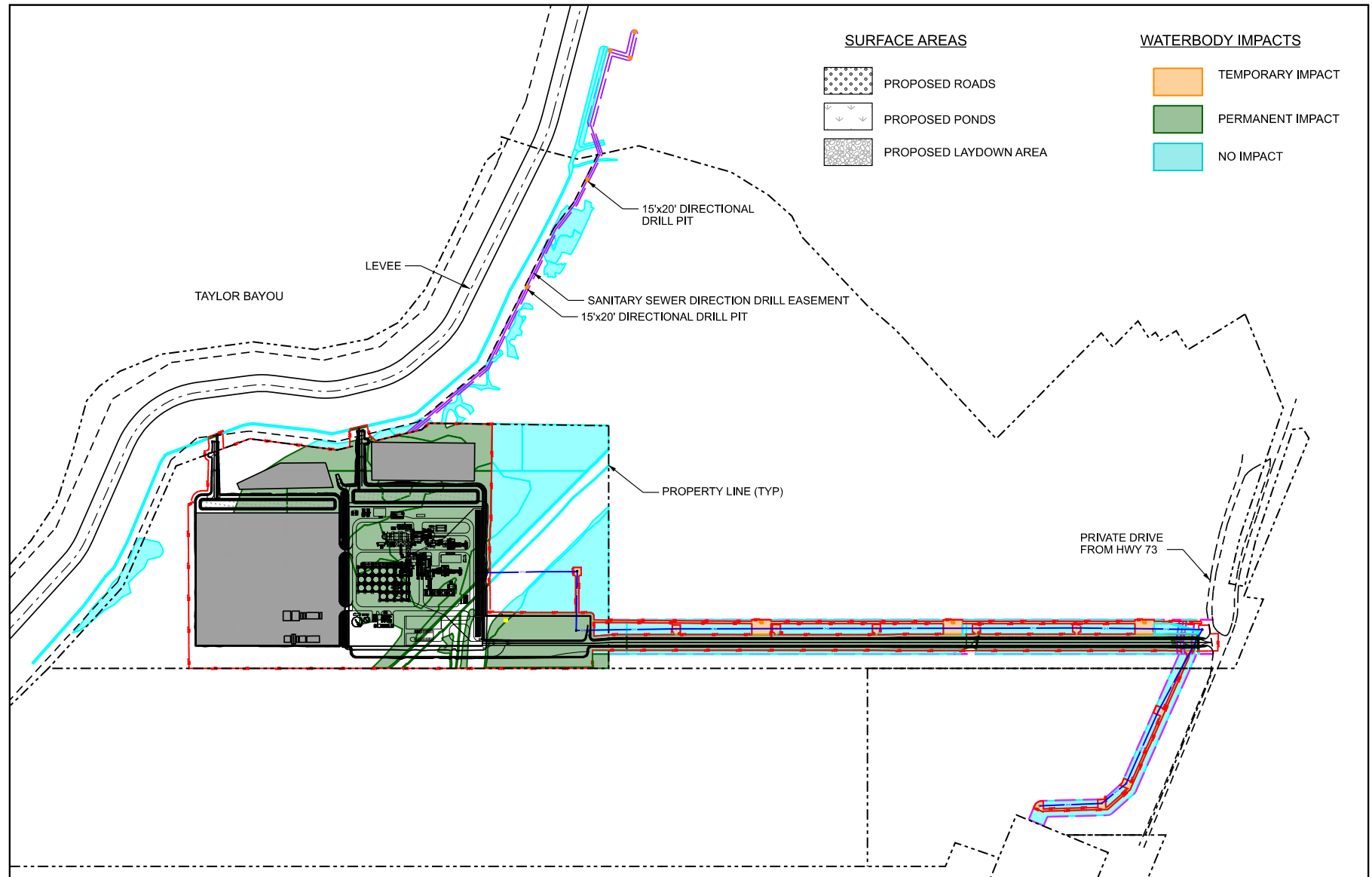





**SURFACE AREAS**

-  PROPOSED ROADS
-  PROPOSED PONDS
-  PROPOSED LAYDOWN AREA

**WATERBODY IMPACTS**

-  TEMPORARY IMPACT
-  PERMANENT IMPACT
-  NO IMPACT

USACE PERMIT SUBMITTAL

OVERALL PROJECT PLAN

FIGURE 6-1

SCALE IN FEET

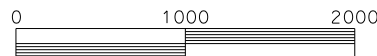

COUNTY: JEFFERSON  
STATE: TEXAS

PURPOSE: PERMIT APPLICATION  
DATE: 08-13-2024 REV. 1

DATUM:  
H: (NAD 83)  
V: (NAVD 88)

PREPARED: AGP  
REVIEWED: GJ  
APPROVED: DJP

PROJECT NO. A13107.099

**Sargent & Lundy**  
SARGENT & LUNDY  
55 EAST MONROE STREET  
CHICAGO, ILLINOIS 60603-5170  
CERTIFICATION OF AUTHORIZATION NO. 6938

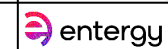

LEGEND POWER STATION



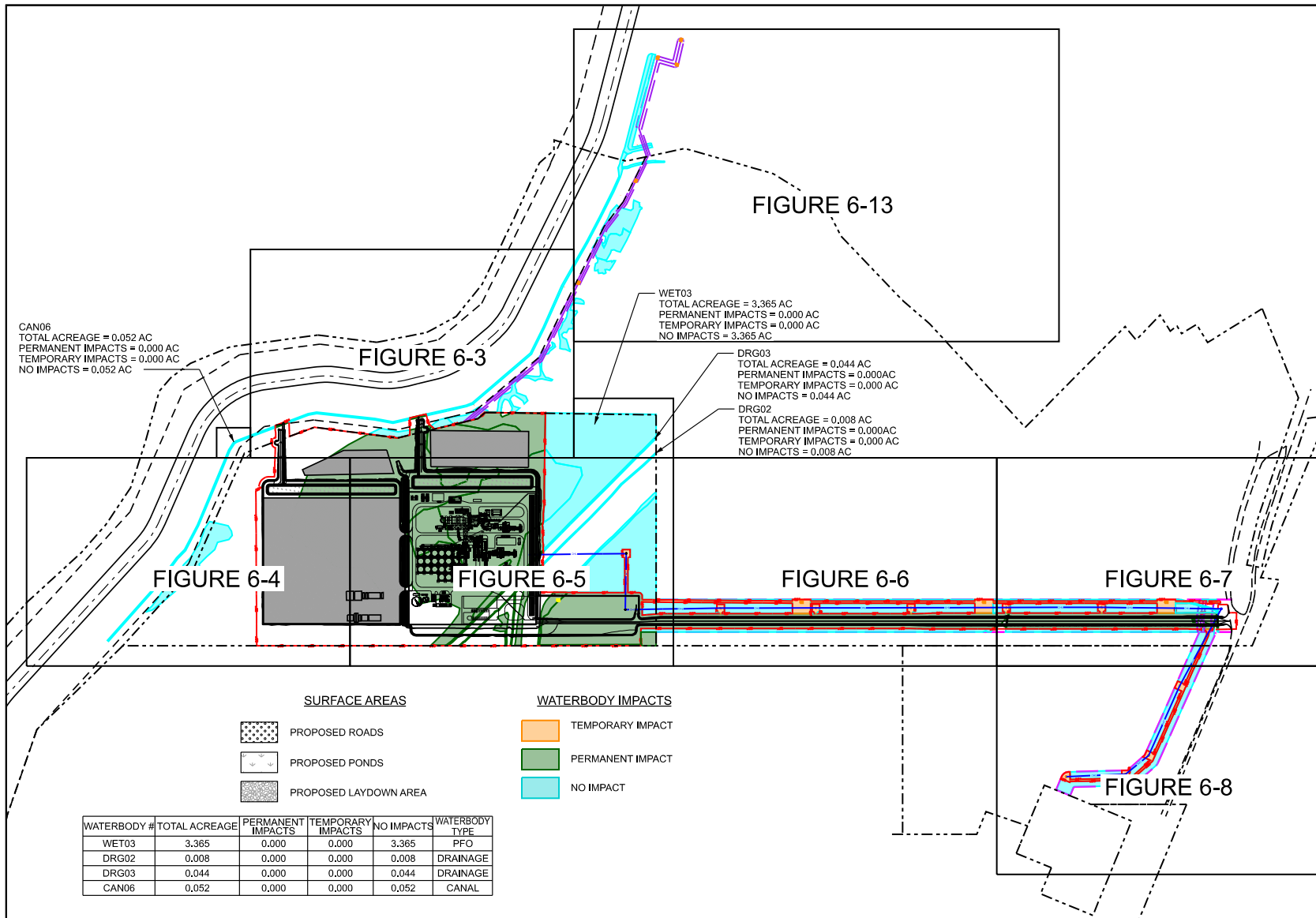

USACE PERMIT SUBMITTAL

KEY PLAN

FIGURE 6-2

SCALE IN FEET

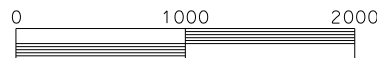

COUNTY: JEFFERSON  
STATE: TEXAS

PURPOSE: PERMIT APPLICATION  
DATE: 08-13-2024 REV. 1

DATUM:  
H: (NAD 83)  
V: (NAVD 88)

PREPARED: AGP  
REVIEWED: GJ  
APPROVED: DJP

PROJECT NO. A13107.099



LEGEND POWER STATION



WATERBODY #	TOTAL ACREAGE	PERMANENT IMPACTS	TEMPORARY IMPACTS	NO IMPACTS	WATERBODY TYPE
WET02	3.127	2.957	0.000	0.170	PEM
WET03	3.674	1.647	0.000	2.027	PFO
WET06	2.168	1.939	0.000	0.229	PFO
WET22	0.311	0.000	0.000	0.311	PFO
CAN06	0.610	0.046	0.000	0.564	CANAL

# SURFACE AREAS

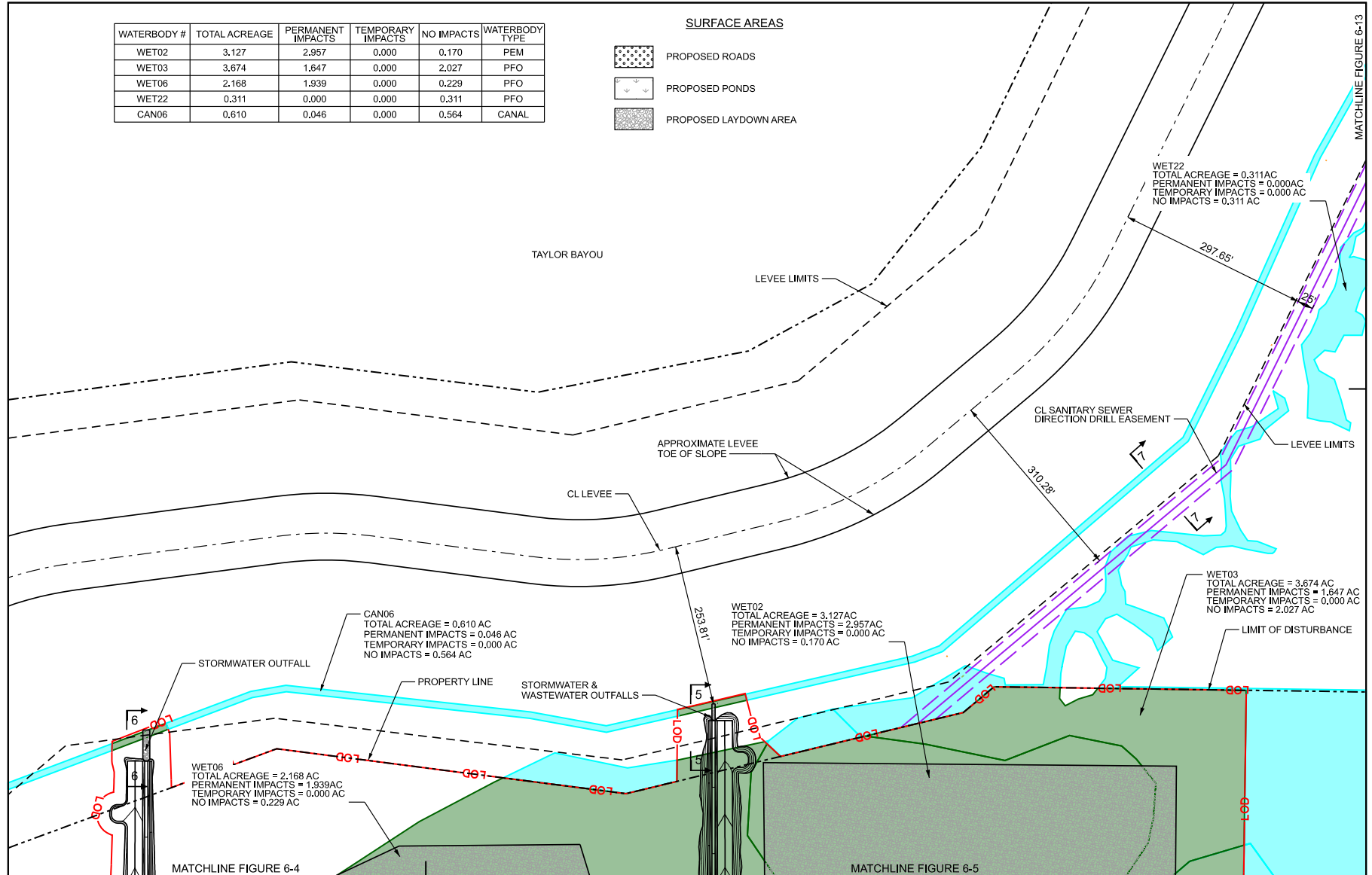
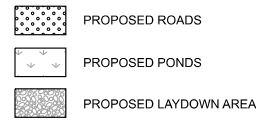

**NO WATERBODY IMPACT**

**TEMPORARY WATERBODY IMPACT**

**PERMANENT WATERBODY IMPACT**

**—LOD— LIMIT OF DISTURBANCE**

NOTE:  
WETLANDS ON EACH PAGE REPRESENT ACRES ON THAT PAGE, AND ARE NOT TOTALS. FOR WATERBODY TOTALS, SEE TABLE ON FIGURE 6.

**USACE PERMIT SUBMITTAL**

**LAYDOWN AREA**

**FIGURE 6-3**

SCALE IN FEET

0 200 400

**NORTH**

COUNTY: JEFFERSON  
STATE: TEXAS

PURPOSE: PERMIT APPLICATION  
DATE: 08-13-2024 REV. 1

DATUM:  
H: (NAD 83)  
V: (NAVD 88)

PREPARED: AGP  
REVIEWED: GJ  
APPROVED: DJP

PROJECT NO. A13107.099

**Sargent & Lundy**

SARGENT & LUNDY  
55 EAST MONROE STREET  
CHICAGO, ILLINOIS 60601-5700  
CERTIFICATION OF AUTHORIZATION NO. 6838

**entergy**

**LEGEND POWER STATION**



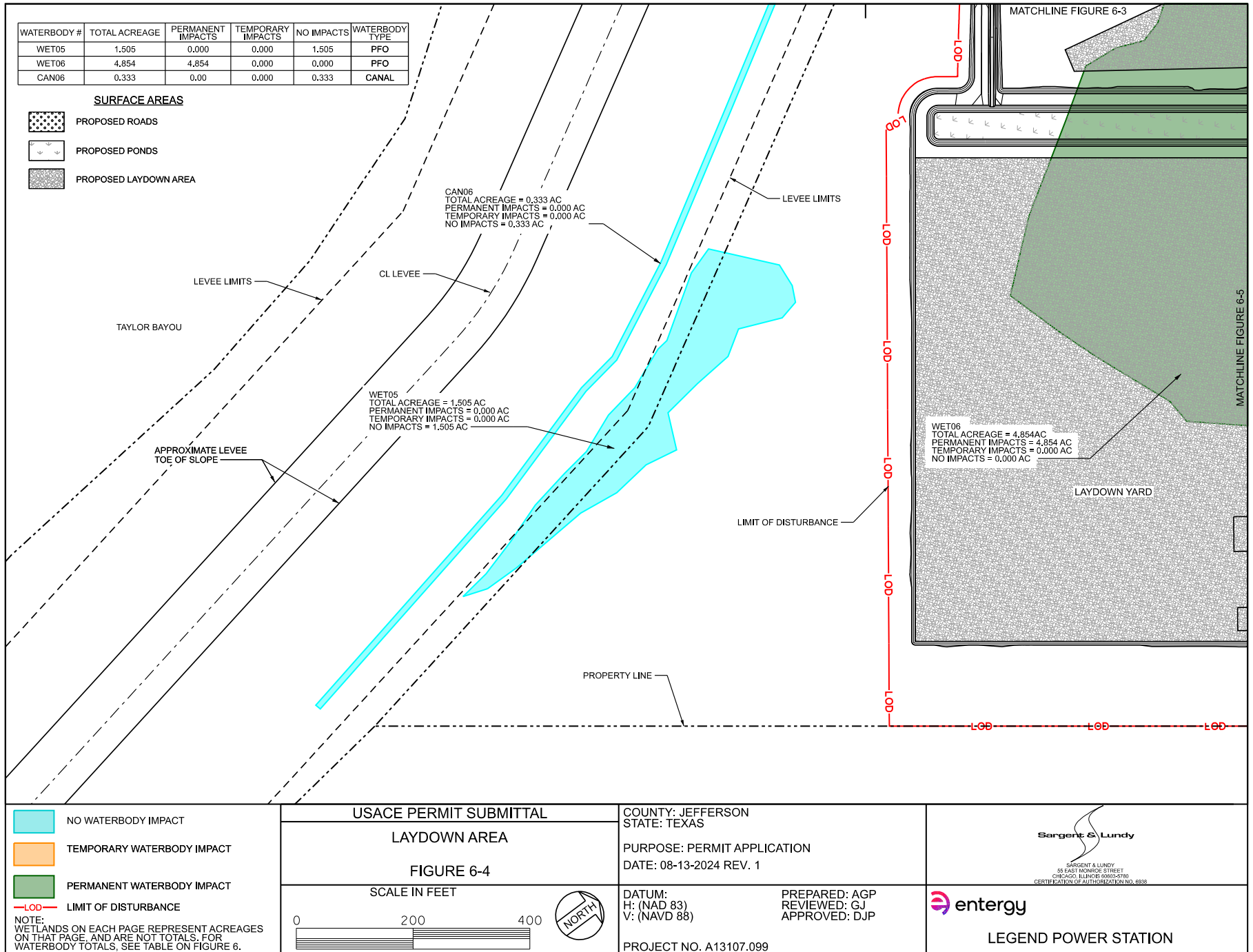



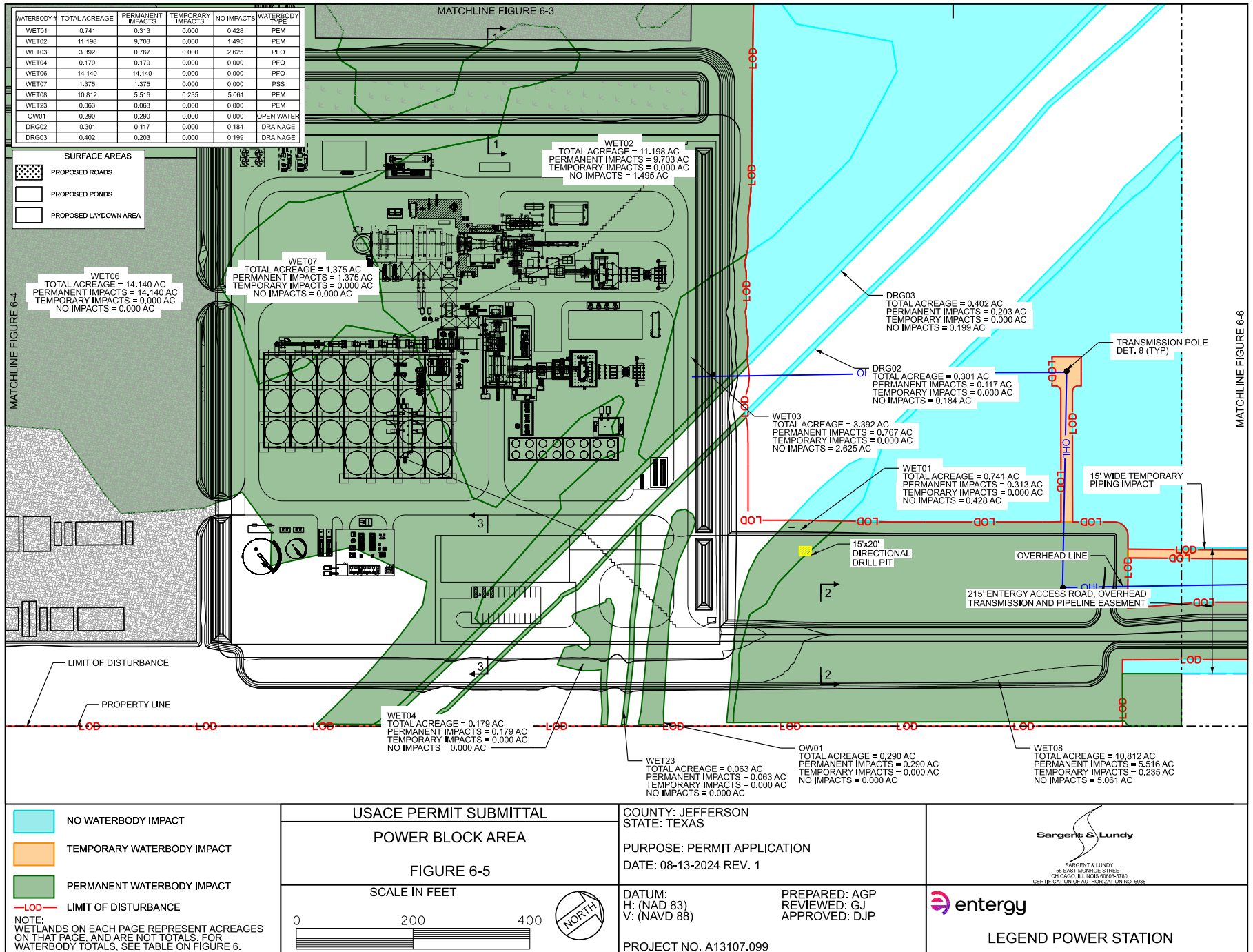



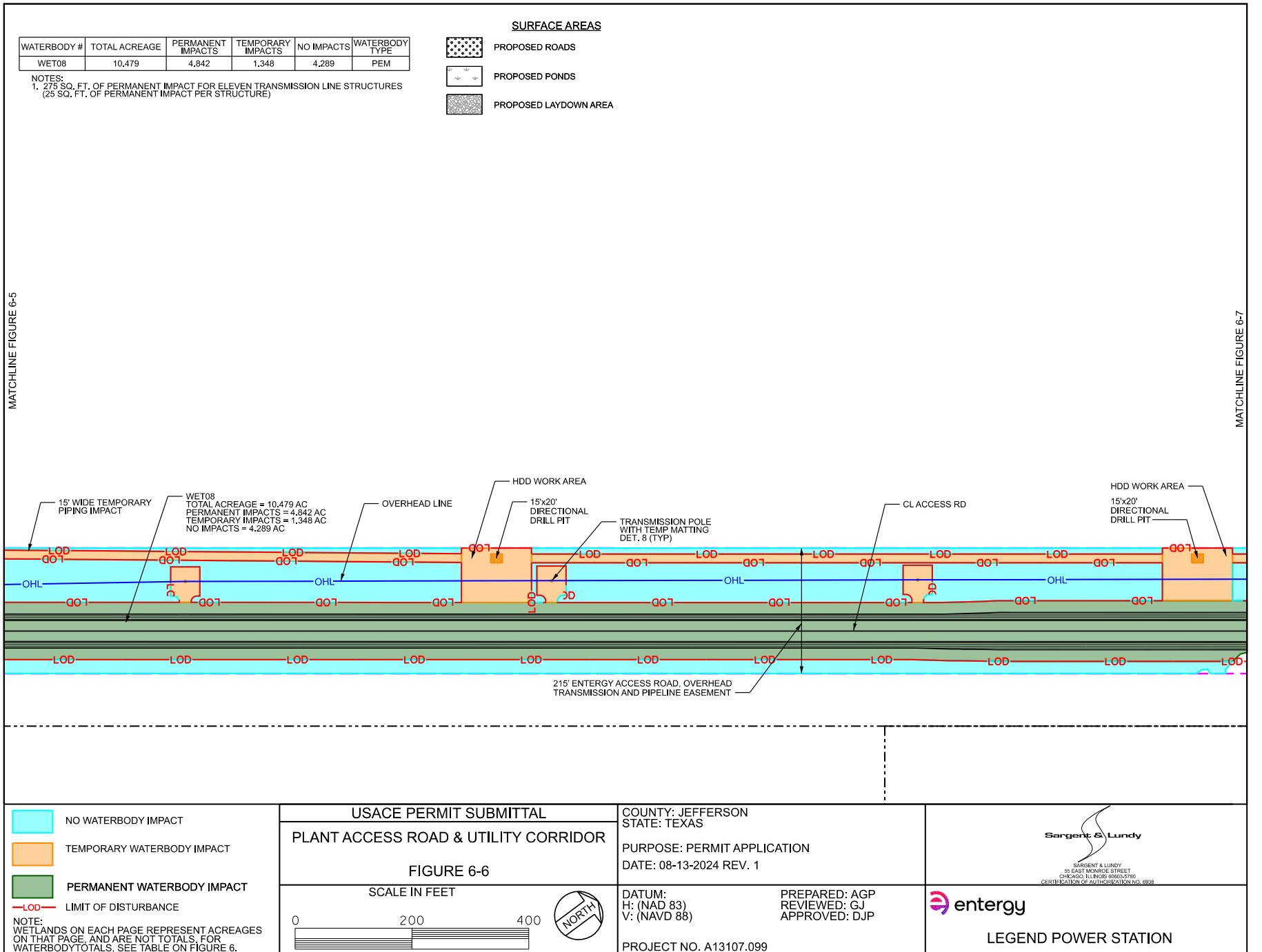



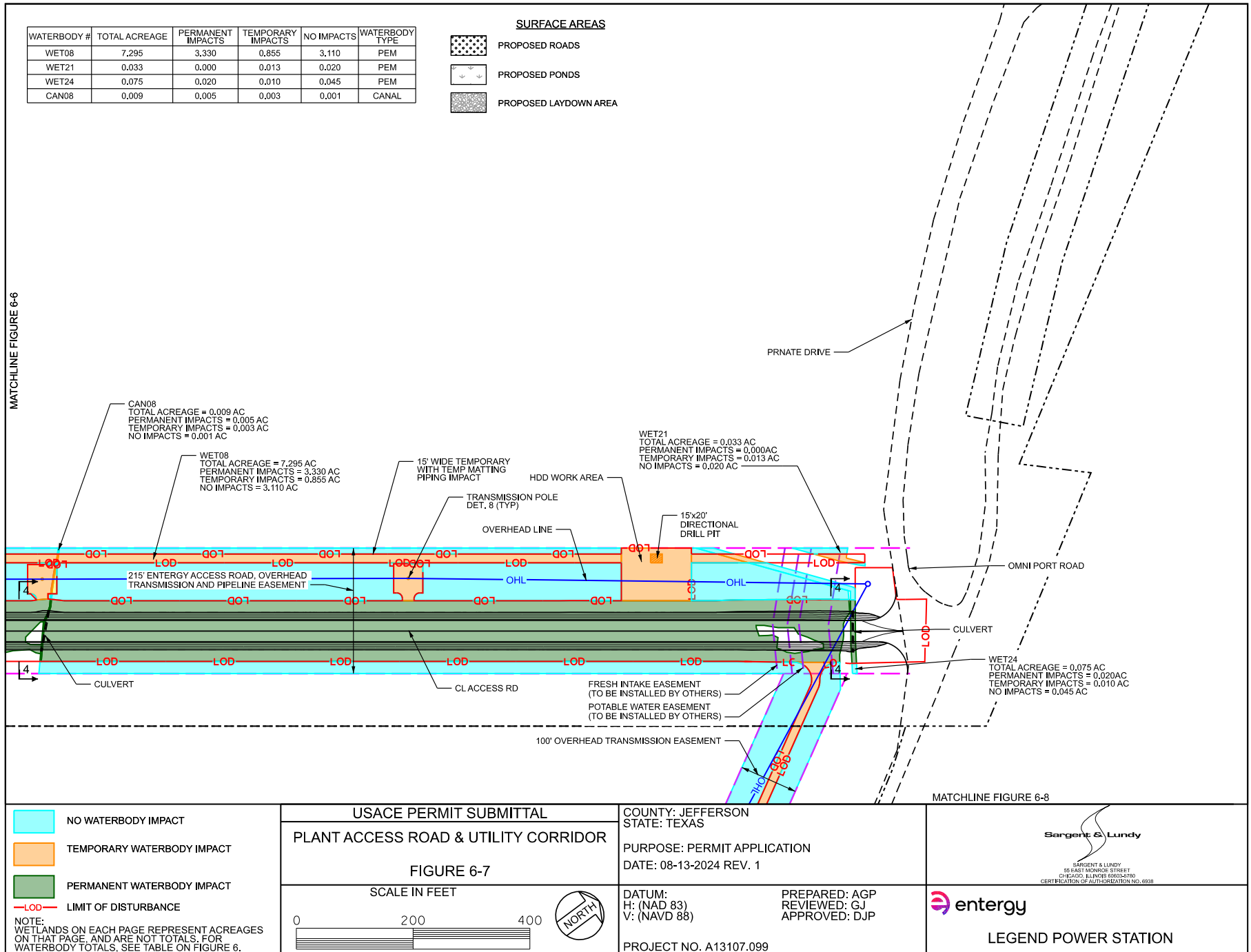







MATCHLINE FIGURE 6-7

WATERBODY #	TOTAL ACREAGE	PERMANENT IMPACTS	TEMPORARY IMPACTS	NO IMPACTS	WATERBODY TYPE
WET08	3.098	0.003	0.639	2.456	PEM

**SURFACE AREAS**

-  PROPOSED ROADS
-  PROPOSED PONDS
-  PROPOSED LAYDOWN AREA

OVERHEAD LINE  
100' OVERHEAD TRANSMISSION EASEMENT

WET08  
TOTAL ACREAGE = 3.098 AC  
PERMANENT IMPACTS = 0.003 AC  
TEMPORARY IMPACTS = 0.639 AC  
NO IMPACTS = 2.456 AC

EXISTING LEGEND 230KV SUBSTATION

 NO WATERBODY IMPACT

 TEMPORARY WATERBODY IMPACT

 PERMANENT WATERBODY IMPACT

 LIMIT OF DISTURBANCE

NOTE:  
WETLANDS ON EACH PAGE REPRESENT ACRES ON THAT PAGE, AND ARE NOT TOTALS. FOR WATERBODY TOTALS, SEE TABLE ON FIGURE 6.

**USACE PERMIT SUBMITTAL  
PLANT ACCESS ROAD &  
OVERHEAD TRANSMISSION EASEMENT**

**FIGURE 6-8**

SCALE IN FEET

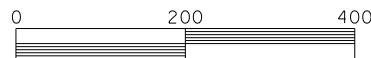

COUNTY: JEFFERSON  
STATE: TEXAS  
PURPOSE: PERMIT APPLICATION  
DATE: 08-13-2024 REV. 1

DATUM:  
H: (NAD 83)  
V: (NAVD 88)  
PREPARED: AGP  
REVIEWED: GJ  
APPROVED: DJP  
PROJECT NO. A13107.099

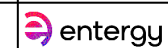

**LEGEND POWER STATION**



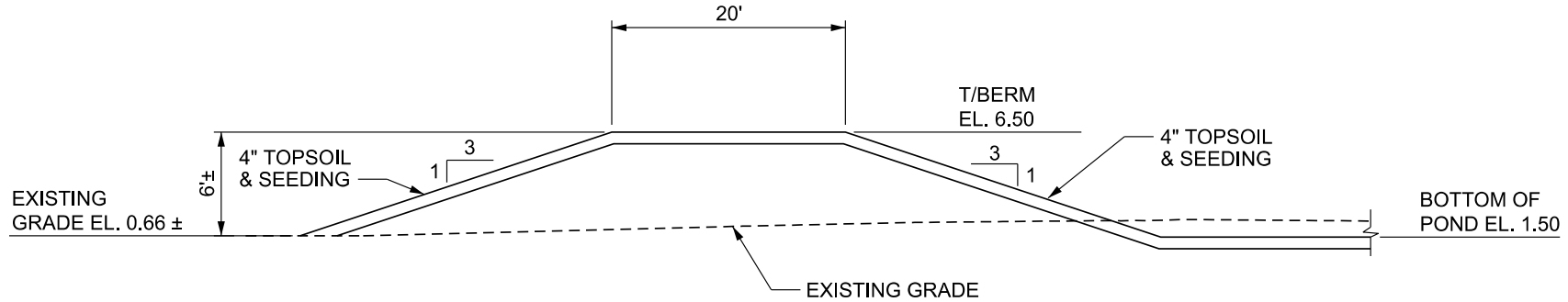

**POWERBLOCK POND AREA**  
**SECTION 1**  
(FIGURE 6-5)

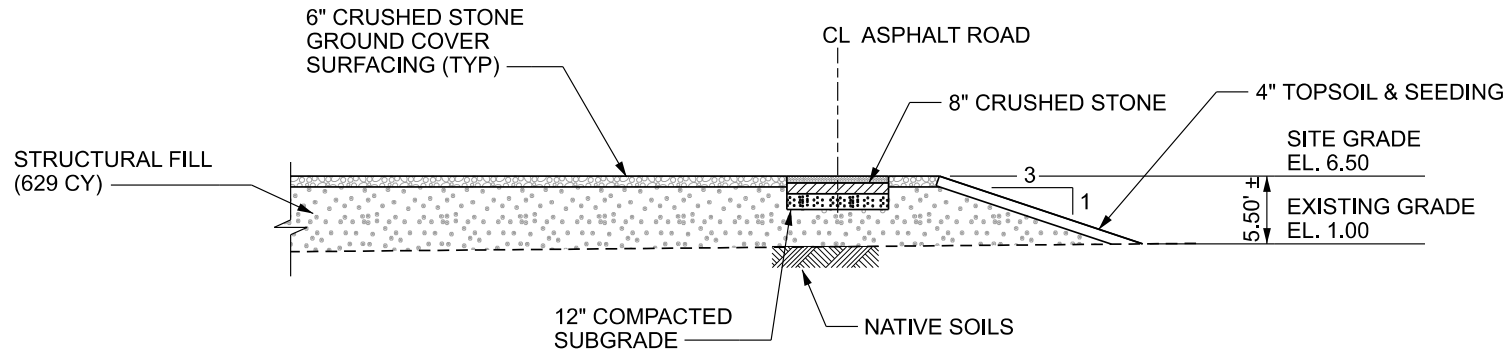

**POWERBLOCK ROADWAY**  
**SECTION 2**  
(FIGURE 6-5)

NOTES:  
1. SEE TABLE ON FIGURE 6 FOR QUANTITIES.

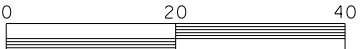
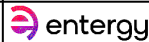
	USACE PERMIT SUBMITTAL	COUNTY: JEFFERSON STATE: TEXAS  PURPOSE: PERMIT APPLICATION DATE: 08-13-2024 REV. 1	
	LAYDOWN AREA SECTIONS FIGURE 6-9		
	SCALE IN FEET 	DATUM: H: (NAD 83) V: (NAVD 88)  PREPARED: AGP REVIEWED: GJ APPROVED: DJP  PROJECT NO. A13107.099	  LEGEND POWER STATION



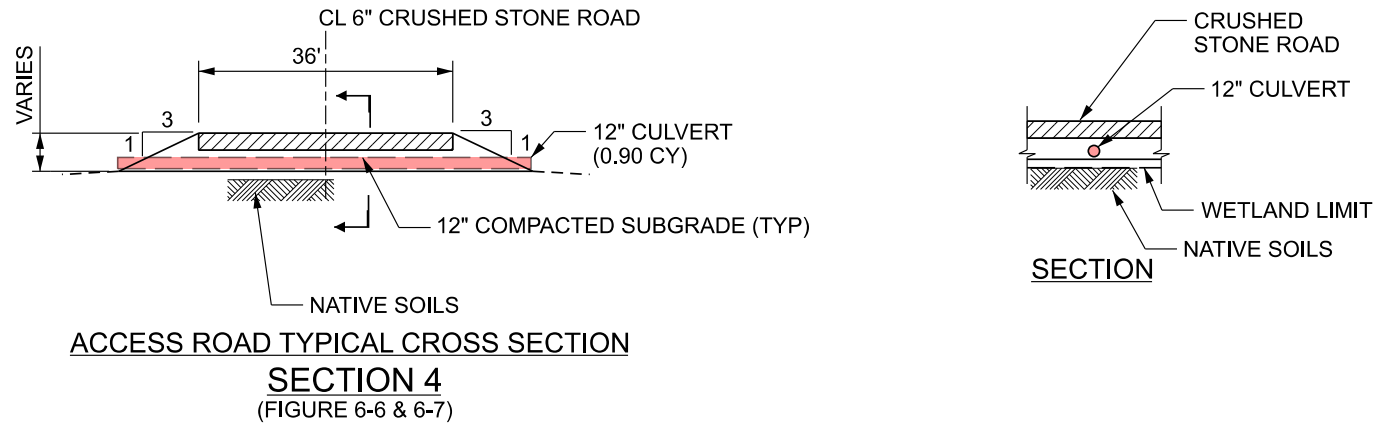
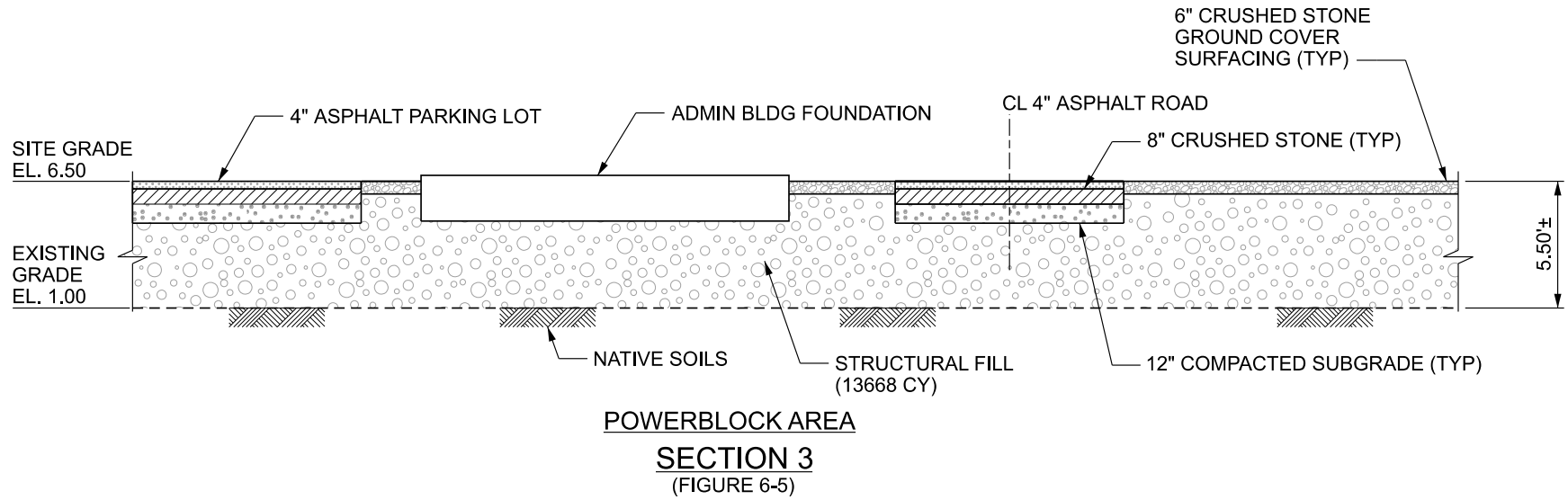

NOTES:

1. SEE TABLE ON FIGURE 6 FOR QUANTITIES.

	USACE PERMIT SUBMITTAL	COUNTY: JEFFERSON STATE: TEXAS  PURPOSE: PERMIT APPLICATION DATE: 08-13-2024 REV. 1	 <small>SARGENT &amp; LUNDY 55 EAST MONROE STREET CHICAGO, ILLINOIS 60603-5700 CERTIFICATION OF AUTHORIZATION NO. 6938</small>
	PLANT AREA SECTIONS FIGURE 6-10		
	SCALE IN FEET 	DATUM: H: (NAD 83) V: (NAVD 88)  PREPARED: AGP REVIEWED: GJ APPROVED: DJP  PROJECT NO. A13107.099	 LEGEND POWER STATION



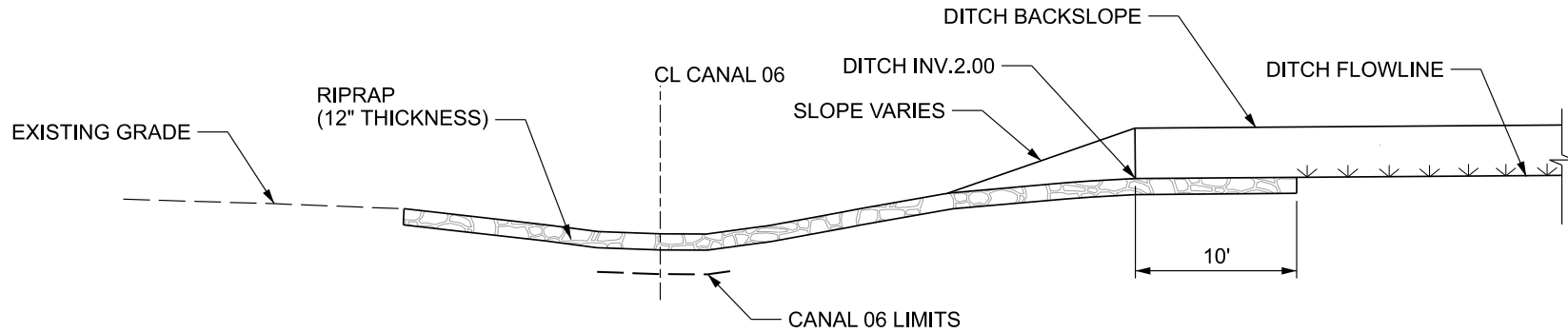

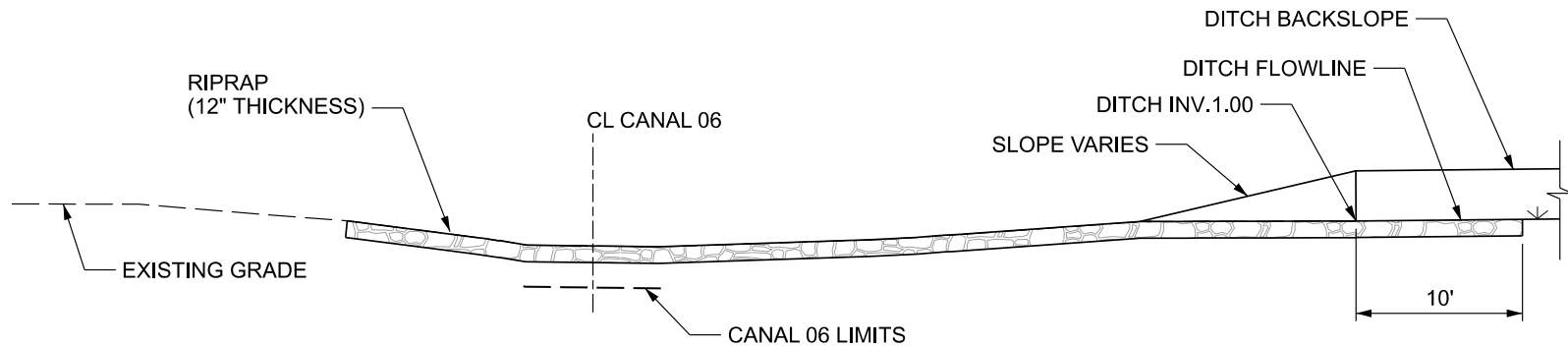

**POWERBLOCK DITCH OUTFALL**  
**SECTION 5**  
(FIGURE 6-3)

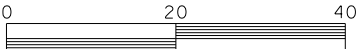

**LAYDOWN DITCH OUTFALL**  
**SECTION 6**  
(FIGURE 6-3)

NOTES:  
1. SEE TABLE ON FIGURE 6 FOR QUANTITIES.

	USACE PERMIT SUBMITTAL	COUNTY: JEFFERSON STATE: TEXAS  PURPOSE: PERMIT APPLICATION DATE: 08-13-2024 REV. 1	 <small>SARGENT &amp; LUNDY 55 EAST MONROE STREET CHICAGO, ILLINOIS 60601-1000 CERTIFICATION OF AUTHORIZATION NO. 6938</small>
	PLANT AREA SECTIONS FIGURE 6-11		
	SCALE IN FEET 	DATUM: H: (NAD 83) V: (NAVD 88)  PREPARED: AGP REVIEWED: GJ APPROVED: DJP  PROJECT NO. A13107.099	 <b>LEGEND POWER STATION</b>



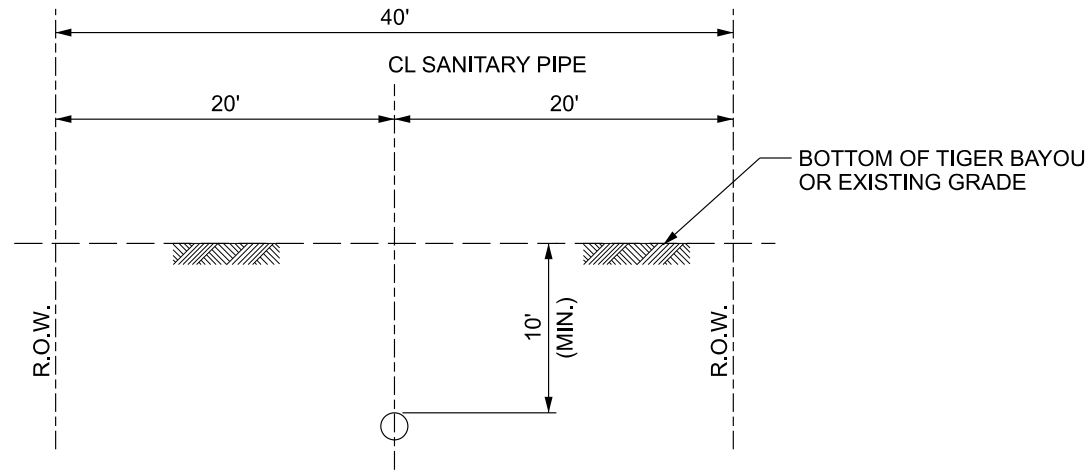

**SANITARY PIPE SECTION**  
**SECTION 7**  
(FIGURE 6-3)

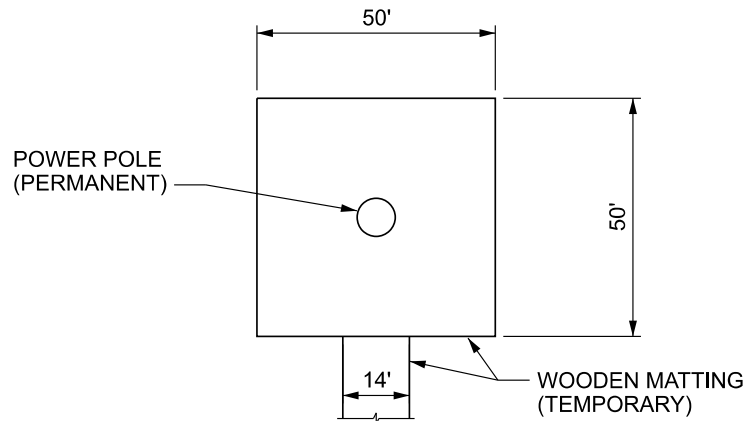

**POWER POLE PLAN**

**DETAIL 8**  
(FIGURE 6-5, 6-6, 6-7, 6-8)

NOTES:  
1. SEE TABLE ON FIGURE 6 FOR QUANTITIES.

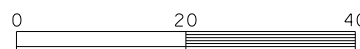
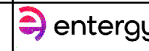
	USACE PERMIT SUBMITTAL	COUNTY: JEFFERSON STATE: TEXAS  PURPOSE: PERMIT APPLICATION DATE: 08-13-2024 REV. 1	 <small>SARGENT &amp; LUNDY 55 EAST MONROE STREET CHICAGO, ILLINOIS 60601-1700 CERTIFICATION OF AUTHORIZATION NO. 6938</small>
	PLANT AREA SECTIONS FIGURE 6-12		
	SCALE IN FEET 	DATUM: H: (NAD 83) V: (NAVD 88)  PREPARED: AGP REVIEWED: GJ APPROVED: DJP  PROJECT NO. A13107.099	 <b>LEGEND POWER STATION</b>



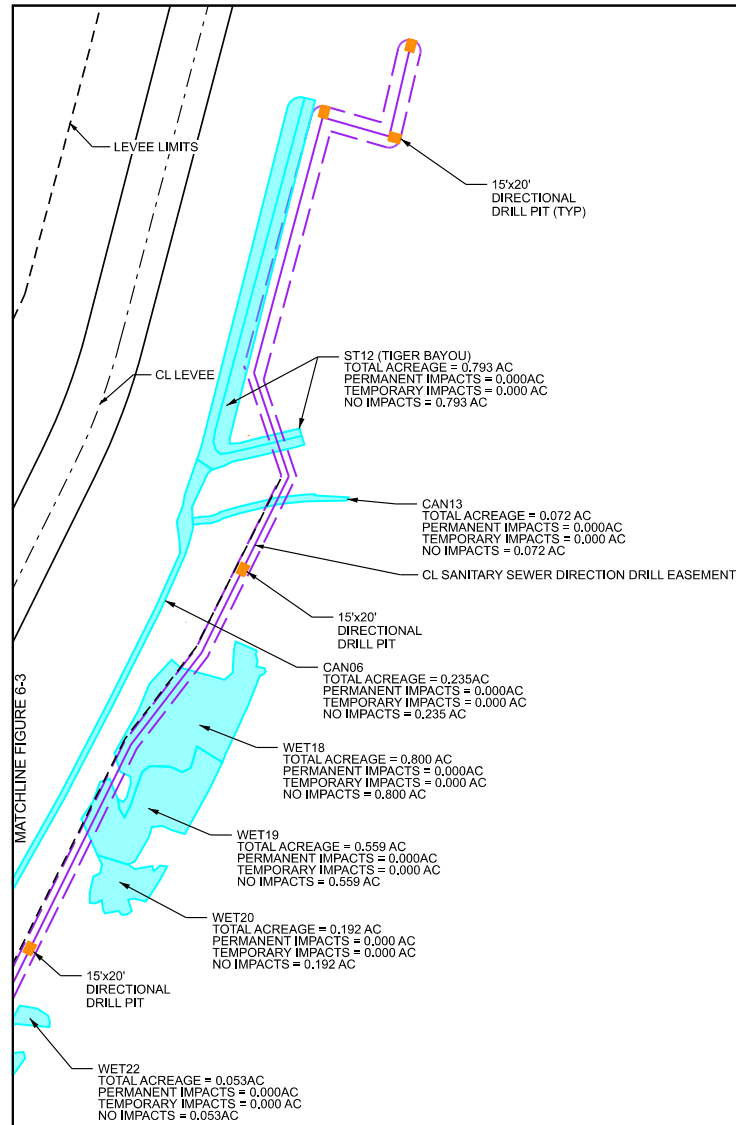

WATERBODY #	TOTAL ACREAGE	PERMANENT IMPACTS	TEMPORARY IMPACTS	NO IMPACTS	WATERBODY TYPE
WET18	0.800	0.000	0.000	0.800	PFO
WET19	0.559	0.000	0.000	0.559	PEM
WET20	0.192	0.000	0.000	0.192	PFO
WET22	0.053	0.000	0.000	0.053	PFO
CAN06	0.235	0.000	0.000	0.235	CANAL
CAN13	0.072	0.000	0.000	0.072	CANAL
ST12	0.793	0.000	0.000	0.793	OPEN WATER

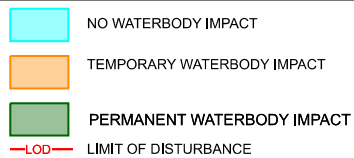
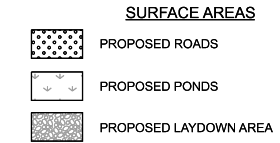

NOTE:  
WETLANDS ON EACH PAGE REPRESENT ACRES ON THAT PAGE, AND ARE NOT TOTALS. FOR WATERBODY TOTALS, SEE TABLE ON FIGURE 6.

**USACE PERMIT SUBMITTAL**  
**SANITARY SEWER DIRECTION**  
**DRILL EASEMENT**  
**FIGURE 6-13**

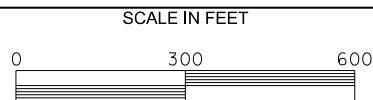

COUNTY: JEFFERSON  
STATE: TEXAS

PURPOSE: PERMIT APPLICATION  
DATE: 08-13-2024 REV. 1

DATUM:  
H: (NAD 83)  
V: (NAVD 88)

PREPARED: AGP  
REVIEWED: GJ  
APPROVED: DJP

PROJECT NO. A13107.099

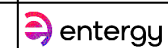

LEGEND POWER STATION